

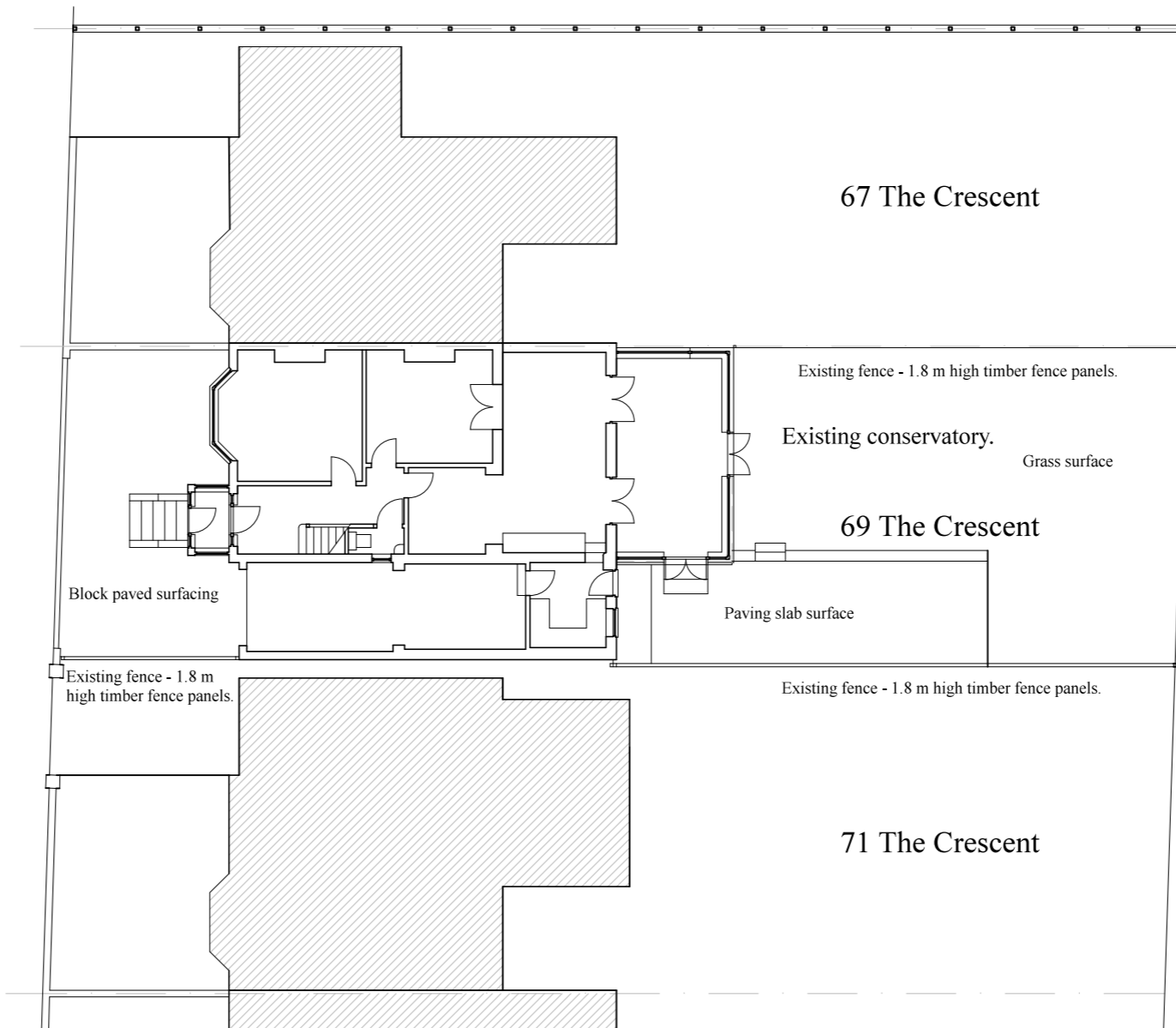

Existing 215mm thick face brick front boundary wall approximately 550mm high.

The Crescent



Existing site plan

scale 1:200



Anthony David Design Consultants
Foxfield, Lovington, Castle Cary, Somerset. BA7 7PX
T: +44 1963 240724 M: +44 7803 132338 E: anthony.david27@btinternet.com

Project:

Proposed replacement of conservatory with garden room at 69 The Crescent, Henleaze, Bristol BS9 4 RU

Existing site plan - 1.200.

Scale: 1:200 at A3

Drg. No:

Date: 18 December 2023

GP/23.5