

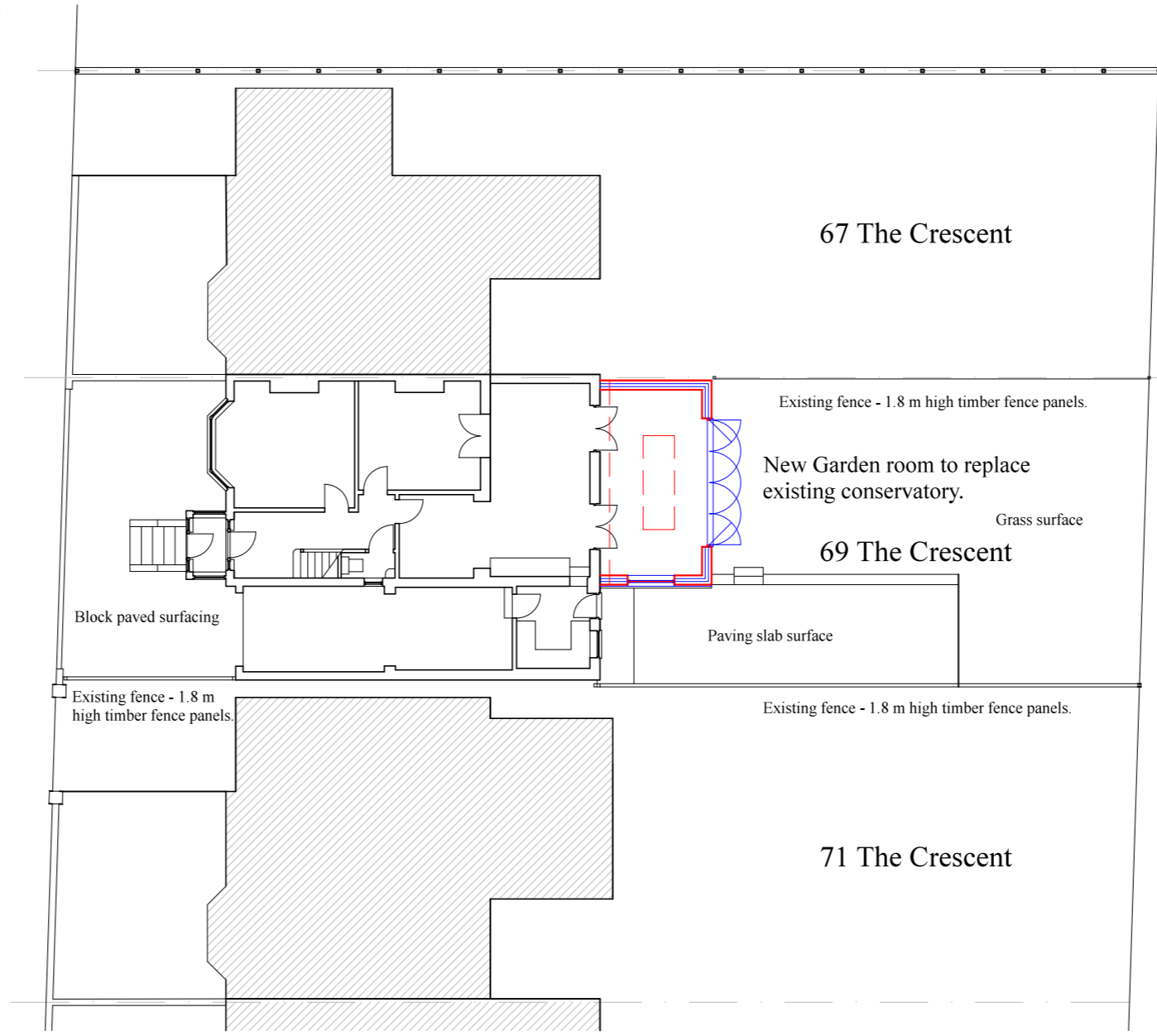

Existing 215mm thick face brick front boundary wall approximately 550mm high.

The Crescent



### Proposed site plan

scale 1:200



<i>Anthony David Design Consultants</i> Foxfield, Lovington, Castle Cary, Somerset. BA7 7PX <small>T: +44 1963 240724 M: +44 7803 132338 E: anthony.david27@btinternet.com</small>	
Project: Proposed replacement of conservatory with garden room at 69 The Crescent, Henleaze, Bristol BS9 4 RU	
Proposed site plan - 1.200.	
Scale: 1:200 at A3	Drg. No:
Date: 18 December 2023	GP/23.6