

NORTH

Legend

- Site Boundary
- Existing Property
- Proposed Extension

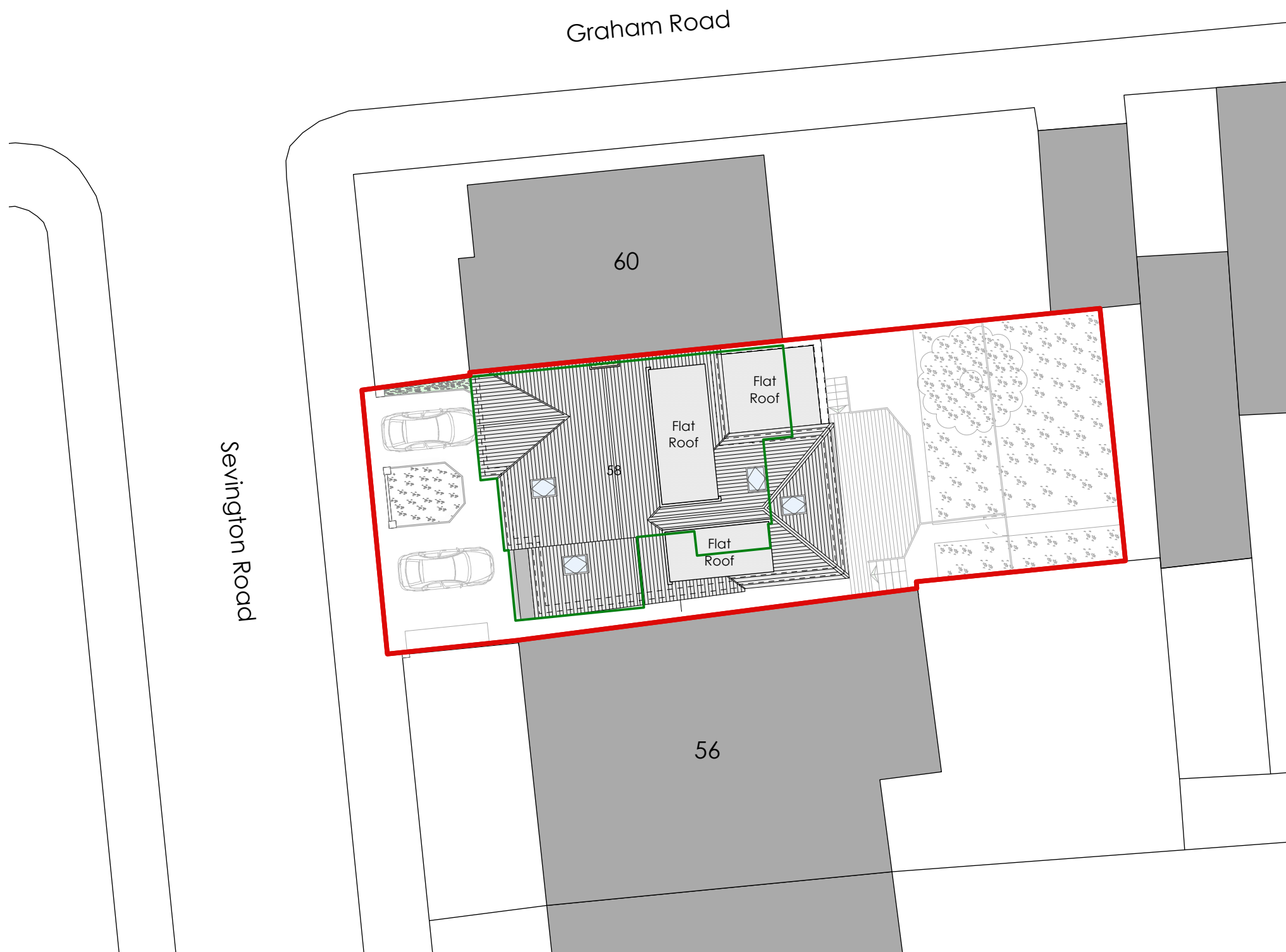

1 Site Layout Plan
Scale: 1:200

FOR PLANNING

- THIS DRAWING HAS BEEN PREPARED SOLELY FOR THE PURPOSES OF MAKING A PLANNING APPLICATION.
 - IT DOES NOT PERTAIN TO SHOW CONSTRUCTION INFORMATION FOR THE PURPOSE OF TENDERING OR BUILDING NOR DOES IT PERTAIN TO SHOW ALL INFORMATION REQUIRED FOR COMPLIANCE WITH BUILDING REGULATIONS.
 - EXCEPT FOR THE PURPOSES OF PLANNING PERMISSION, DO NOT SCALE FROM DRAWING.

C01	Issue for Planning	POS	15/11/2022
Rev:	Description:	Drawn:	Date:

interiors architecture technology CHARTERED PRACTICE No. 5 St. John's Lane, London EC1M 4BH T +44(0)20 7404 7771 E info@healycornelius.com	Drawing Title: Site Layout Plan	
	Client: Mr. David Fahimian	Scale: 1:200 @ A3
Job Title: No. 58 Sevington Road, London NW4 3RX	Date: 20 Oct. 2022	Drawn: POS
Drawing Number: 22721-HCD-ZZ-ZZ-DR-A-0002		Status: A1 Rev: C01
RIBA Stage: 3 SC		© healycornelius design 2022