

- SURVEY INFORMATION
- CONCEPT DESIGN
- DEVELOPED DESIGN
- TENDER DRAWING
- CONTRACT DRAWING
- CONSTRUCTION ISSUE

Dimensions given on this drawing are to be verified on site, and any discrepancy reported to the architect. This drawing is the property of Courtingtons and copyright is reserved by the architect. This drawing is issued on the understanding that it shall not be copied, reproduced, retained or disclosed to any unauthorised person, wholly or in part without the written consent of the architect. DO NOT SCALE FROM THIS DRAWING!

drawing issued from:
COURTINGONS, The Stables, Hardwick Business Park, Banbury, Oxfordshire.
 OX16 2AF. t: +44[0]1295 254545

revisions:

project:
THE POTTERY,
 UPPER ODDINGTON

drawing title:
BLOCK PLAN
 [Plan].

scale: 1:500@A3 *date:* 27/11/2023
drawn: jh *checked:* jct

drawing number:
S952-A-02

COURTINGONS
Architecture & Landscape

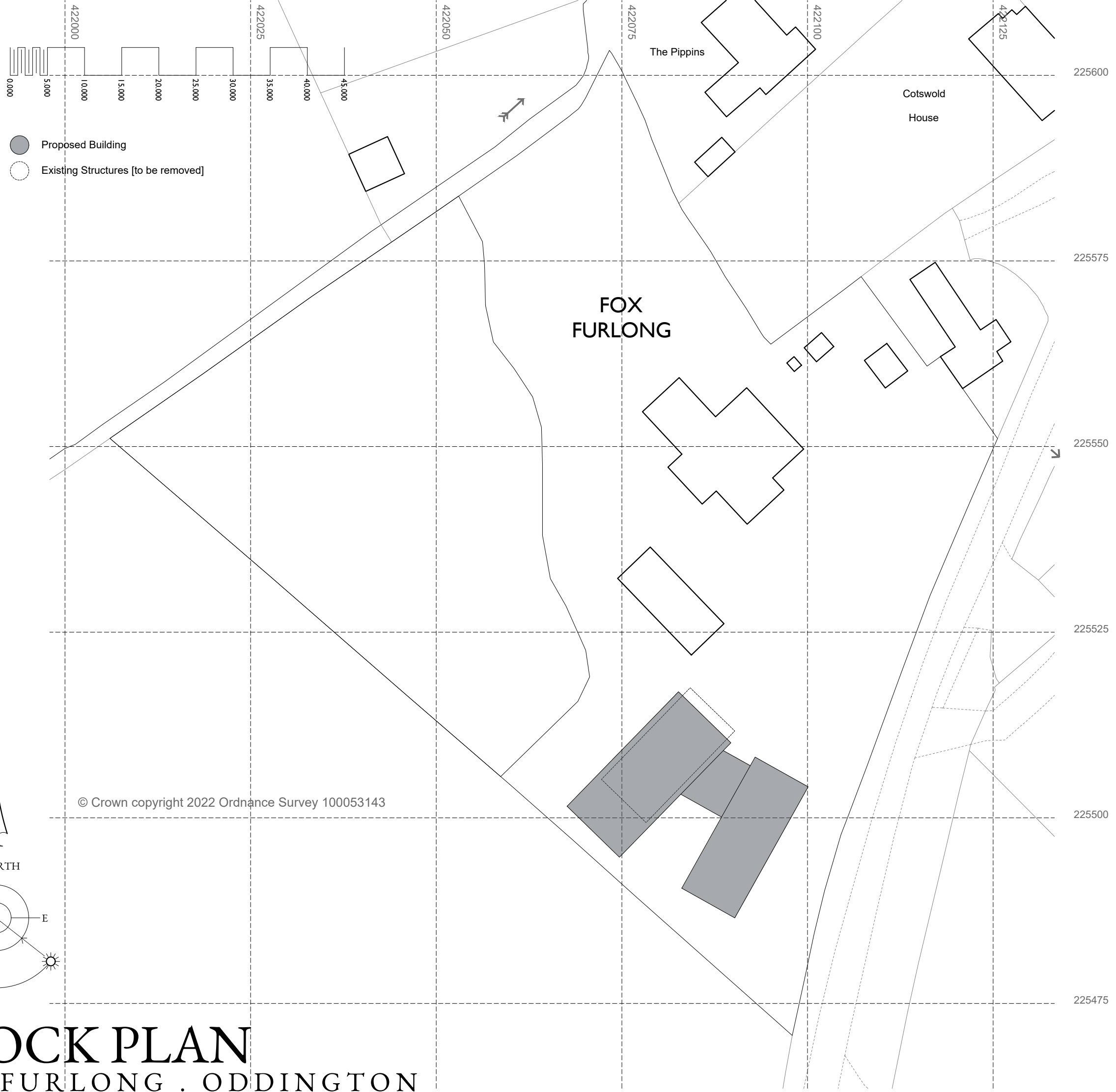
- Proposed Building
- Existing Structures [to be removed]

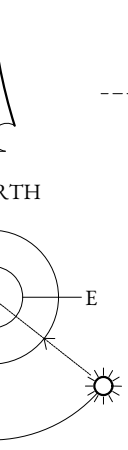
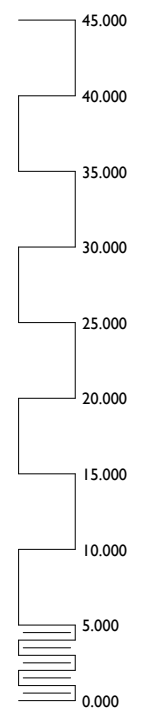

© Crown copyright 2022 Ordnance Survey 100053143

BLOCK PLAN

FOX FURLONG . ODDINGTON