

455225N

455225N

455200N

455200N

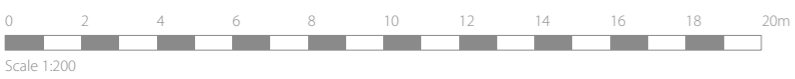
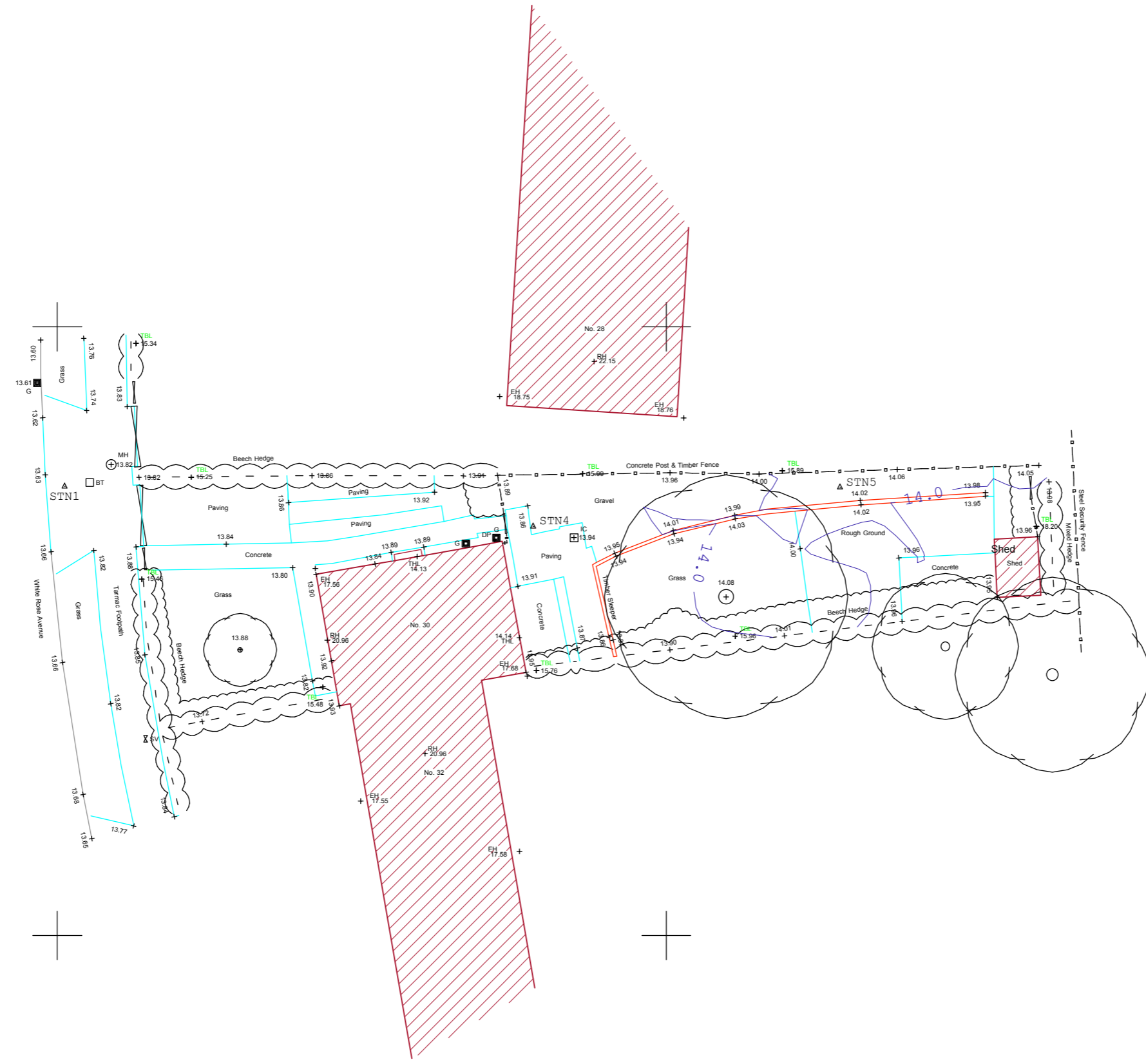

<p>Notes</p>	<p>Revision</p>	<p>Ric Blenkharn BA Hons Dipl Arch FRIBA FRSA ARCHITECT The Reading Room Welburn York YO60 7EE ric@ricblenkharn.com 07711144943</p>	<p>Client Alison Littler and Nic Franklin-Woolley 30 White Rose Avenue New Earswick York YO32 4AG</p>	<p>Drawing Existing Site Survey by Oakwood Land Surveys</p>
		<p>Please do not scale from this drawing</p>	<p>Scale 1:200 at A3</p>	<p>Date 21 12 2023</p>
			<p>Drawing No NE 03</p>	<p>Revision -</p>