

1 Proposed Retail & Storage Floor Plan
1 : 200

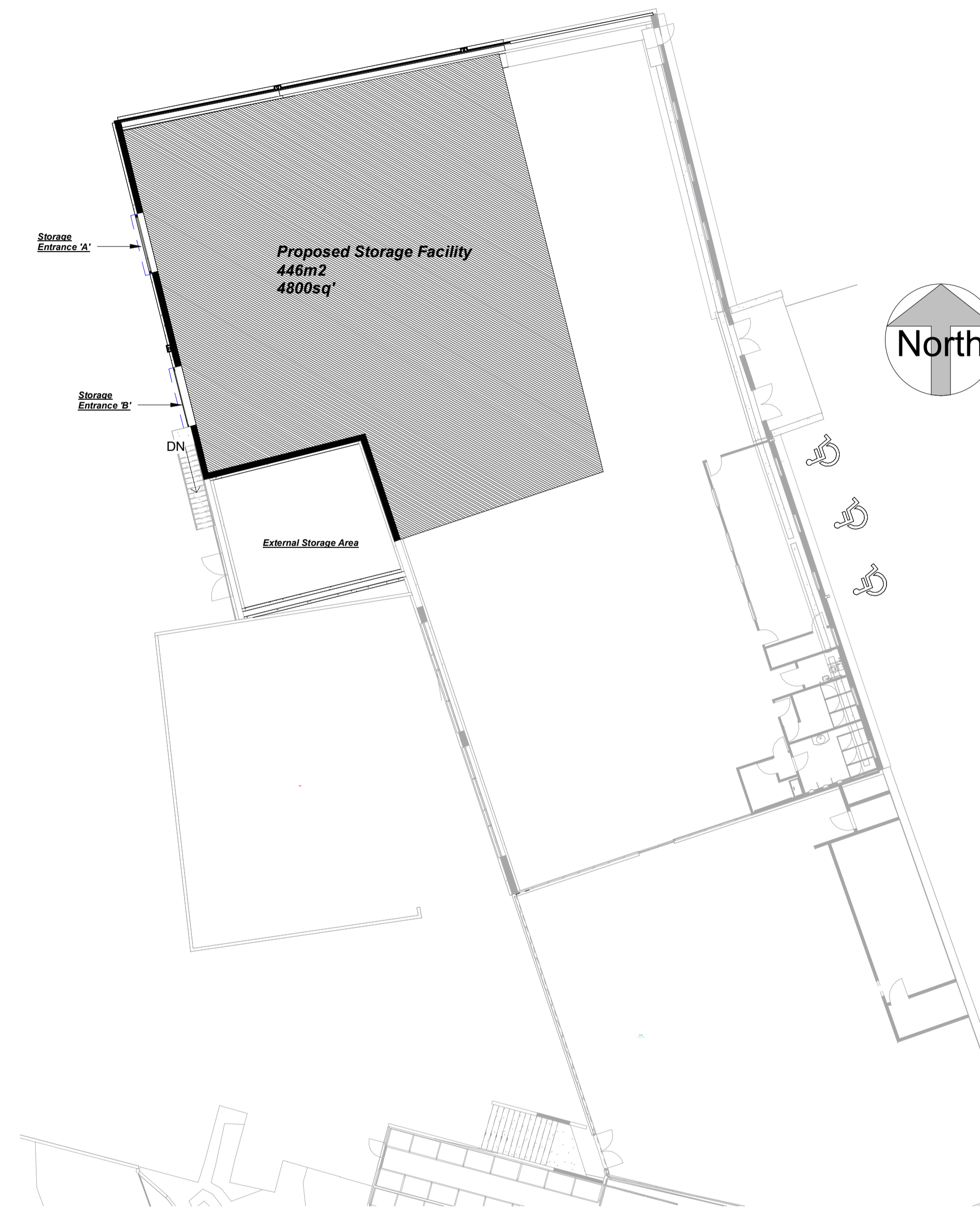

2 Proposed New Storage Facility Beneath Retail
1 : 200

CDM REGULATIONS

The owner must abide by the Construction Design and Management Regulations 2015 which relate to building works. All building works must now be notifiable and it is the client's responsibility to appoint a Planning Supervisor on all projects that require compliance with the CDM Regulations.

MATERIALS AND WORKMANSHIP

All works are to be carried out in a workmanlike manner. All materials and workmanship must comply with Regulation 7 of the Building Regulations, all relevant British Standards, European Standards, Agreement Certificates, Product Certification of Schemes (Kite Marks) etc. Products conforming to a European technical standard or harmonised European product should have a CE marking.

This drawing is the copyright of The Residential Design Studio. Contractors are required to check ALL dimensions. All work to be carried out using figured dimensions only. Do not scale off this drawing for construction purposes. This drawing is for the use of town planning and Building Regulations only and does not represent full working drawings unless otherwise clearly stated.

Rev	Description	Date

The Residential Design Studio

 Mia Casa, North Pool Rd, Illogan,
 Redruth, Cornwall TR15 3JQ
 Tel: 01326 312723
Planning Application

PROJECT
 Demolition of existing portal framed storage building, offices and outside seating area and construction of new storage facility, retail space and extra restaurant area with formation of new access road to side

TITLE
 Proposed Retail & Storage Floor Plans

CLIENT
 Mr M. Hassall Carnon Downs Garden
 Center, Quenchwell Road, Carnon Downs,
 Truro, TR3 6LN

DRAWN BY SDA	CHECKED BY SDA	DATE Nov 23
SCALE (@ A1) 1 : 200		PROJECT NUMBER 3435

DRAWING NUMBER 3435-A1-PL11	REV
---------------------------------------	-----