

Contractors responsibility to check all site dimensions & levels prior to commencing works.  
 Contractor to comply in all respects with current building regulations & guidelines whether specified on this drawing or not.  
 The drawing must be read & checked against any other specialist drawings provided by the company or by consultants.  
 This drawing and the works depicted are the copyright of the company & may not be replicated without written permission.

**PHOTOGRAPH LOCATION PLANS @ 1:500**

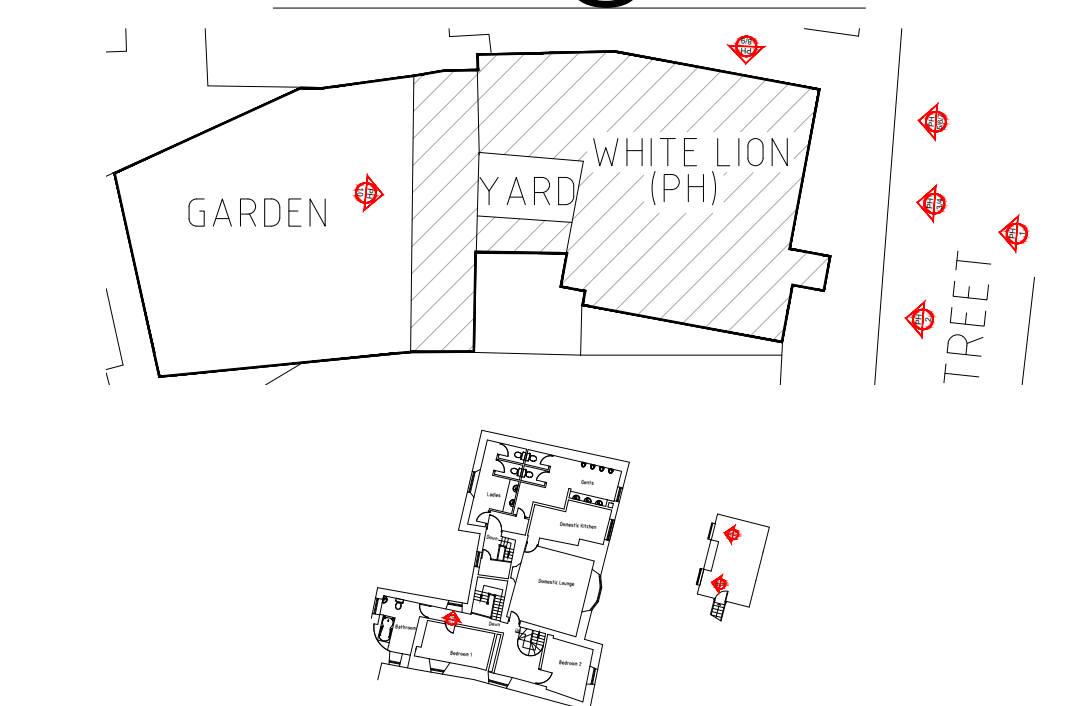

PHOTOGRAPH 8



PHOTOGRAPH 9



PHOTOGRAPH 10

PHOTOGRAPH 8: IMAGE OF THE LADIES TOILET WINDOW WITH ROTTEN MULLION

PHOTOGRAPH 9: IMAGE OF WINDOW 8/9 AND THE ROTTEN FRAMES

PHOTOGRAPH 10: IMAGE OF THE MAIN SKYLIGHT COVERED UP DUE TO IT LEAKING AND THE DEBRIS ON THE FLAT ROOF

PHOTOGRAPH 11: IMAGE FROM THE DORMER WINDOW TO SHOW EXTENT OF DEBRIS AND THE COVERED UP SKYLIGHT

PHOTOGRAPH 12: IMAGE OF THE CURRENT DORMER WINDOW FROM THE INSIDE THAT SHOWS THE EXTENT OF DEBRIS AND THE COVERED UP SKYLIGHT

PHOTOGRAPH 13: IMAGE OF THE OTHER CURRENT DORMER WINDOW FROM THE INSIDE

PLEASE REFER TO THE PROPOSED GROUND, FIRST AND SECOND FLOOR, PROPOSED ELEVATIONS, PROPOSED ROOF PLAN AND PHOTOGRAPH LOCATION PLAN AND SUPPORTING IMAGES PART 1



PHOTOGRAPH 11



PHOTOGRAPH 12

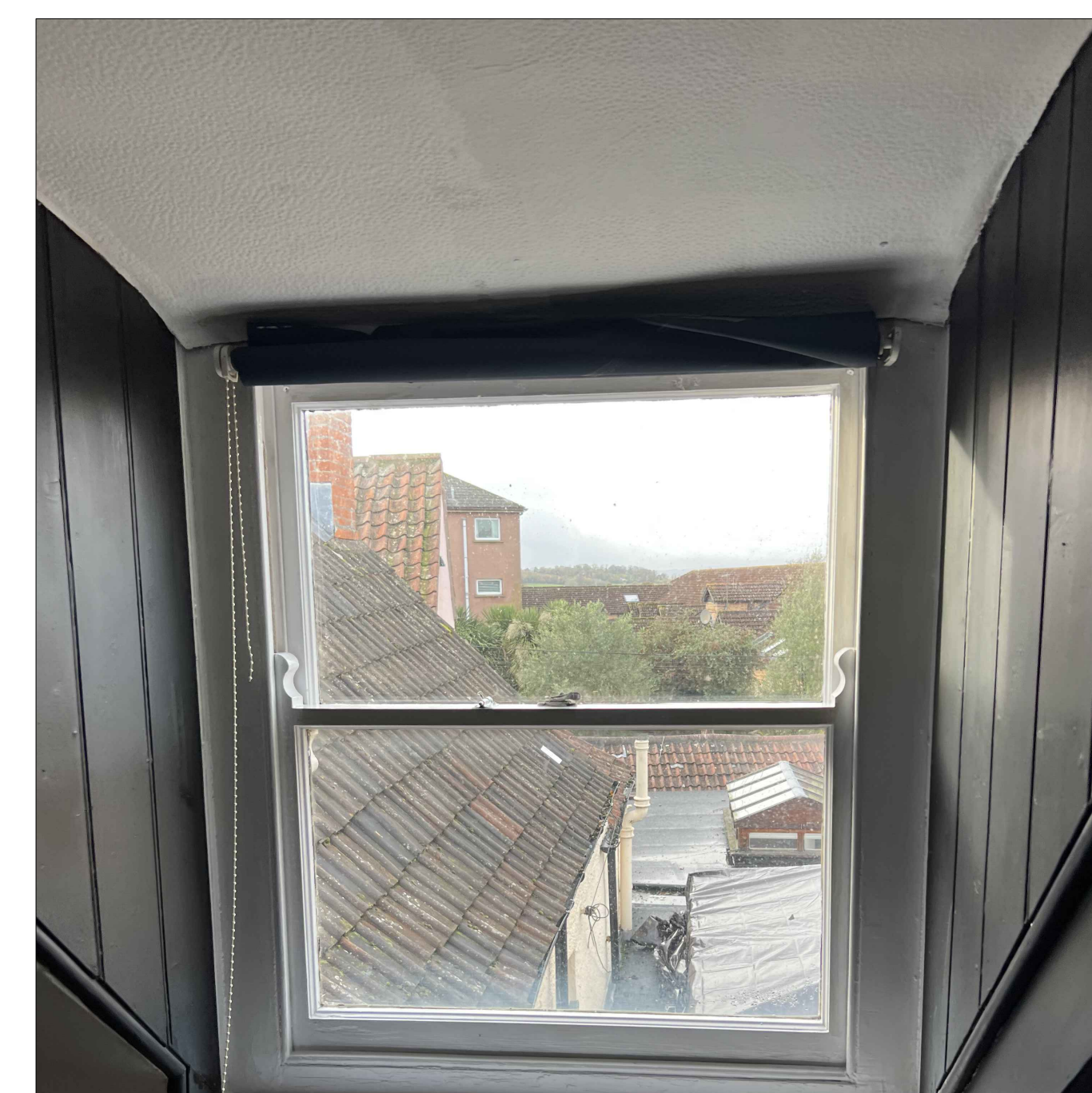

PHOTOGRAPH 13

| REV   | DETAILS         | BY                                      |
|---|-----------------|---|
| <br><b>MARSTON'S</b> |                 |   |
| PROJECT<br>White Lion<br>10 High Street, Thornbury, Bristol, BS35 2AQ                                     |                 |   |
| TITLE<br>Photograph Location Plan and Supporting Images Part 2  |                 |   |
| SCALE<br>AS STATED @ A0   |                 | DATE<br>DEC 2023                        |
| DRAWN BY<br>AF  | CHECKED BY<br>- | DRAWING No.<br>04/12/91814/PH/LP/S/1/P2 |
|   |                 | REV<br>-                                |
| MARSTON'S PLC ST JOHNS HOUSE ST JOHNS SQUARE<br>WOLVERHAMPTON WV2 4BH TEL:01902 907250                    |                 |   |