

Contractors responsibility to check all site dimensions & levels prior to commencing works.
 Contractor to comply in all respects with current building regulations & guidelines whether specified on this drawing or not.
 The drawing must be read & checked against any other specialist drawings provided by the company or by consultants.
 This drawing and the works depicted are the copyright of the company & may not be replicated without written permission.

PHOTOGRAPH LOCATION PLANS @ 1:500

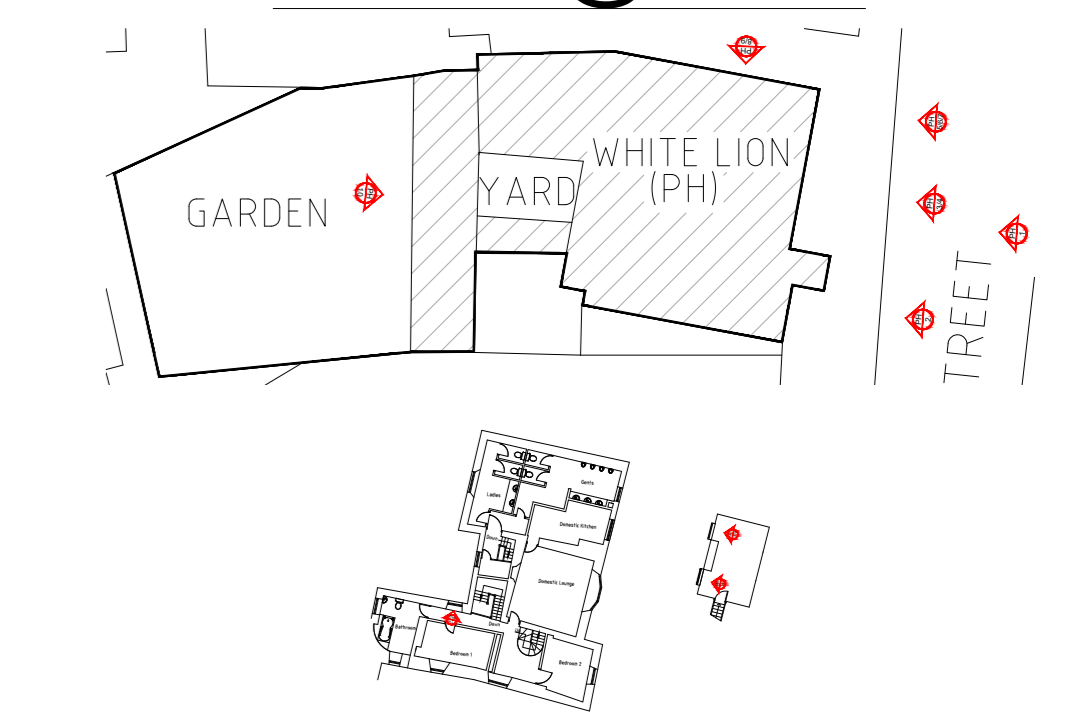

PHOTOGRAPH 1



PHOTOGRAPH 2



PHOTOGRAPH 3

PHOTOGRAPH 1: IMAGE OF THE FRONT ELEVATION OF THE WHITE LION

PHOTOGRAPH 2: IMAGE OF WINDOW 1 SHOWING THE DAMAGES TO THE FRAME AND SILL AS WELL AS CRACKED RENDER

PHOTOGRAPH 3: IMAGE OF WINDOW 2 SHOWING THE BUBBLED SILL AND DAMAGE TO THE RENDER

PHOTOGRAPH 4: IMAGE OF WINDOW 4 SHOWING THE ROTTEN FRAME/SILL AND PEELING PAINT

PHOTOGRAPH 5: IMAGE OF WINDOW 3 SHOWING THE PEELING FINISH STRIP, CRACKED RENDER AND ROTTED PANEL DOOR

PHOTOGRAPH 6: IMAGE OF WINDOW 5/6 SHOWING CRACKED GLASS AND ROTTING FRAME/SILLS

PHOTOGRAPH 7: IMAGE SHOWING THE SIDE ELEVATION NEAREST TO NEIGHBORING BUILDING WHERE THERE IS DAMAGE TO RENDER DUE TO LEAKING GUTTER

PLEASE REFER TO THE PROPOSED GROUND, FIRST AND SECOND FLOOR, PROPOSED ELEVATIONS AND PROPOSED ROOF PLAN



PHOTOGRAPH 4



PHOTOGRAPH 5



PHOTOGRAPH 6



PHOTOGRAPH 7

REV	DETAILS	BY
 MARSTON'S		
PROJECT White Lion 10 High Street, Thornbury, Bristol, BS35 2AQ		
TITLE Photograph Location Plan and Supporting Images Part 1		
SCALE AS STATED @ A0		DATE DEC 2023
DRAWN BY AF	CHECKED BY -	DRAWING No. 04/12/91814/PH/LP/S/I/P1
		REV -
MARSTON'S PLC ST JOHNS HOUSE ST JOHNS SQUARE WOLVERHAMPTON WV2 4BH TEL:01902 907250		