

EXISTING SITE LAYOUT 1:250 at A1

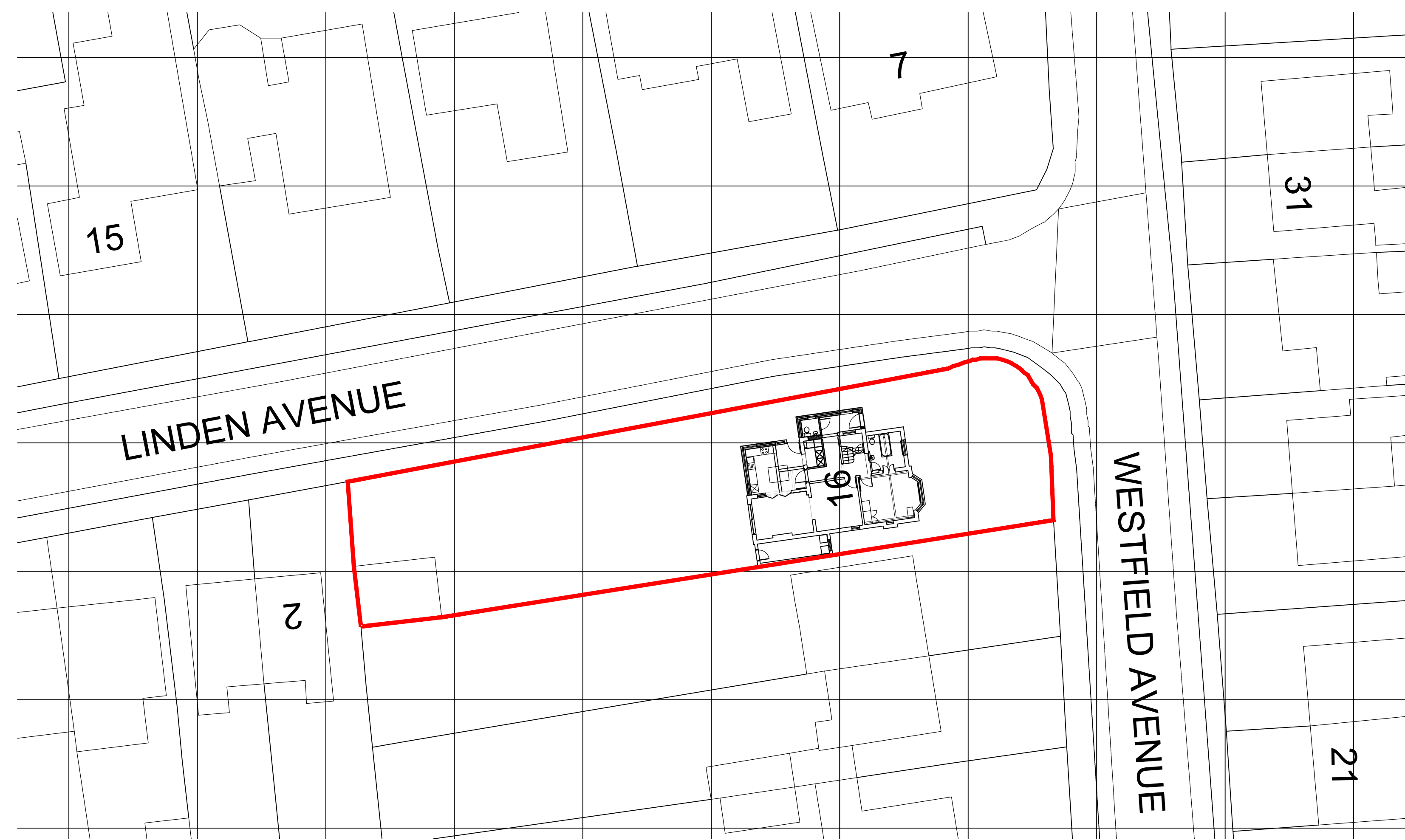

PROPOSED SITE LAYOUT 1:250 at A1

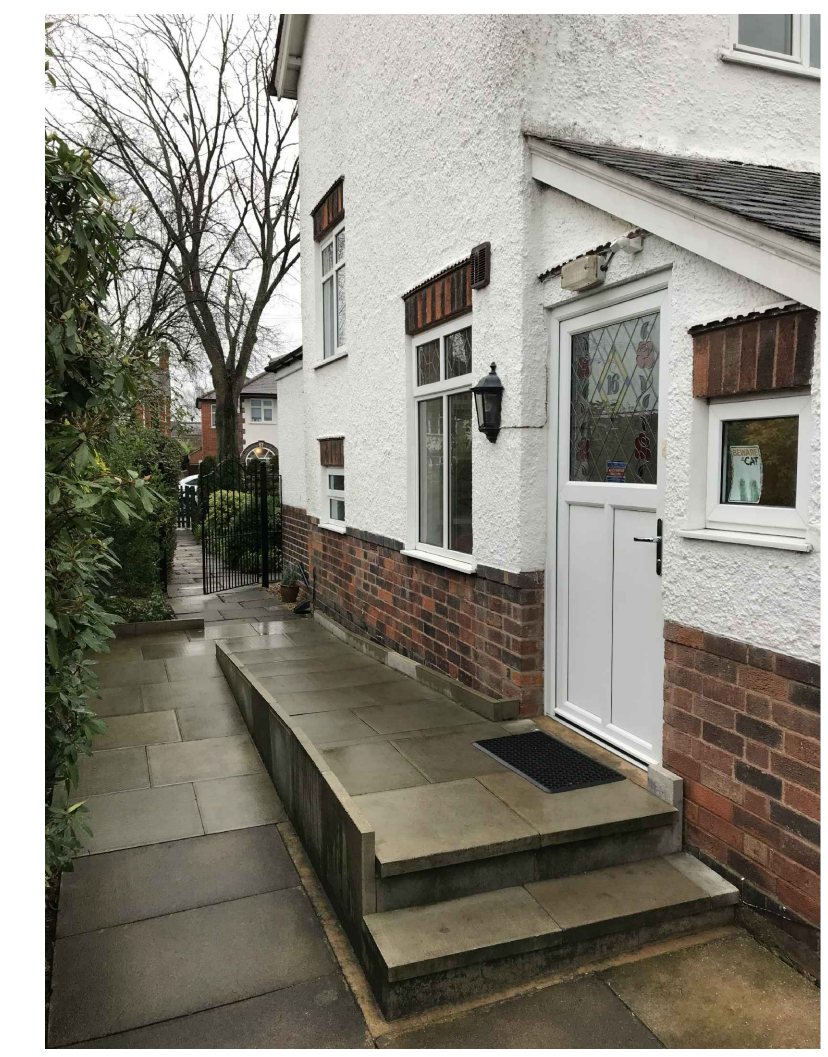

PHOTOS OF EXISTING DWELLING

NOTES:
 — REDLINE DENOTES PLANNING SITE BOUNDARY

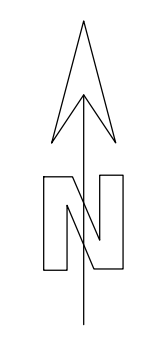
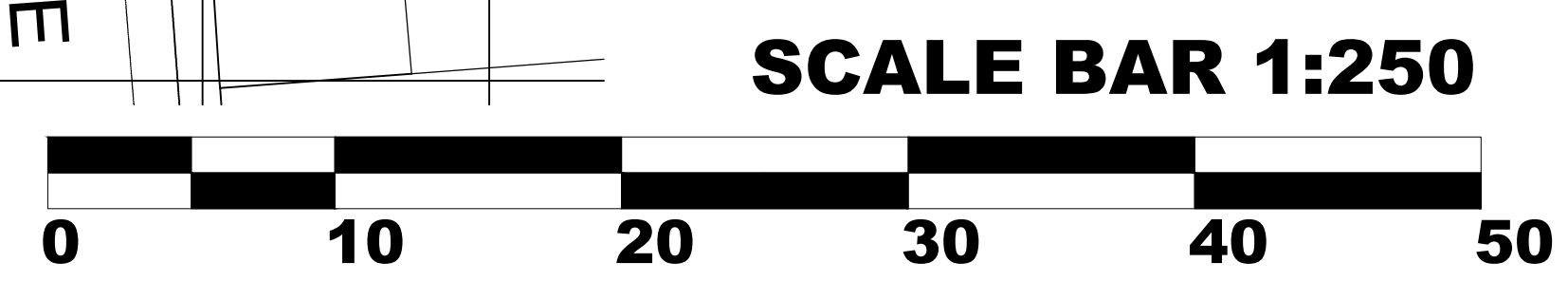

PROJECT:	Paul Baylis 16 Westfield Avenue Countesthorpe		
STATUS:	Planning		
DRAWING TITLE:	Existing and Proposed Site Layouts		
DATE:	10/09/2023	DRAWN BY:	JT
SCALE:	1:250 AT A1	CHECKED BY:	JT
DRAWING NO:	Westfield Avenue - PL10	REVISION:	A