

KEY, nts

- Approximate service routes of heating pipes within suspended timber floors
- Approximate service routes of heating pipes within new solid floor construction
- Schematic indication of above floor foul drainage connections
- Schematic indication of below / in floor foul drainage connections
- Approximate position of service riser locations

WHEN CONSIDERING ROUTES FOR SERVICES THE FOLLOWING PRINCIPALS WILL BE ADOPTED

- re-using of existing services' routes where possible
- routing through voids under floors or above ceilings where possible
- sharing common routes with other services
- consideration is to be given to allowing spare capacity in (new) service routes for future works to avoid future disruption
- routing pipework, controls or cabling through buildings in ways reducing the impact on historic fabric recognising that this may not result in the shortest or the most direct
- carrying out the minimum amount of work that would disturb existing fabric and, where this is necessary, re-using as much as possible of the existing fabric as is appropriate and practical
- avoiding new destructive chasing or cutting a groove into a surface to install cables or pipes
- ensuring services will not cover up, damage or interrupt views of important building features and surfaces or create dirt traps or staining patterns from heat and air movement.

HOLES, RECESSES AND CHASES IN MASONRY

Locations: To maintain integrity of strength, stability and sound resistance of construction. Not to pass through any historic features or dressed stone including reveals, surrounds, cills and thresholds.
 Sizes: Minimum needed to accommodate services.
 - Vertical chases: No deeper than one third of single leaf thickness, excluding finishes.
 - Horizontal or raking chases: No longer than 1 m. No deeper than one sixth of the single leaf thickness, excluding finishes.

NOTCHES AND HOLES IN TIMBER TO MAINTAIN ARE TO BE MINIMISED AND UNDERTAKEN IN SUCH A WAY AS TO PRESERVE THEIR INTEGRITY

General: Avoid if possible.
 Sizes: Minimum needed to accommodate services.
 Position: Not to be located near knots or other defects.
 Notches and holes in same joist: Minimum 100 mm apart horizontally. Notches in joists: Locate at top. Form by sawing down to a drilled hole.
 - Depth (maximum): 0.125 x joist depth.
 - Distance from supports: Between 0.07 and 0.25 x span.
 Holes in joists: To be located on neutral axis.
 - Diameter (maximum): 0.25 x joist depth.
 - Centres (minimum): 3 x diameter of largest hole.
 - Distance from supports: Between 0.25 and 0.4 of span.

Table of revisions. WIP denotes 'work in progress'

Rev	Ch ID	Description	Date
A	Ch-02	First Issue	22/12/2023

This documents and its design content is copyright ©. It shall be read in conjunction with all other associated project information including models, specifications, schedules and related consultants documents. Do not scale from documents unless for planning purposes. All dimensions to be checked on site. Immediately report any discrepancies, error or omissions on this document to the Originator. If in doubt ASK. Limitations on the use of information in this drawing is described in our terms of appointment.



Project: The Old Vicarage, Woodbury Salterton. EX5 1PG
 for D Wright & M Wright

Proposed Plumbing Strategy

Drawing number: 2342 5601	Revision: A
-------------------------------------	-----------------------

For use up to and not beyond RIBA stage:

3 Spatial Co-ordination

Drawing scale(s) 1:150 @ A3	originator mr	checked mr
--------------------------------	------------------	---------------

file: /Volumes/01 Project (2014<)/2023 Projects/2342 Old Vicarage, Woodbury Salterton/04 Design Data/2342-hmad-M5-A-Stage 3 proposals.pln

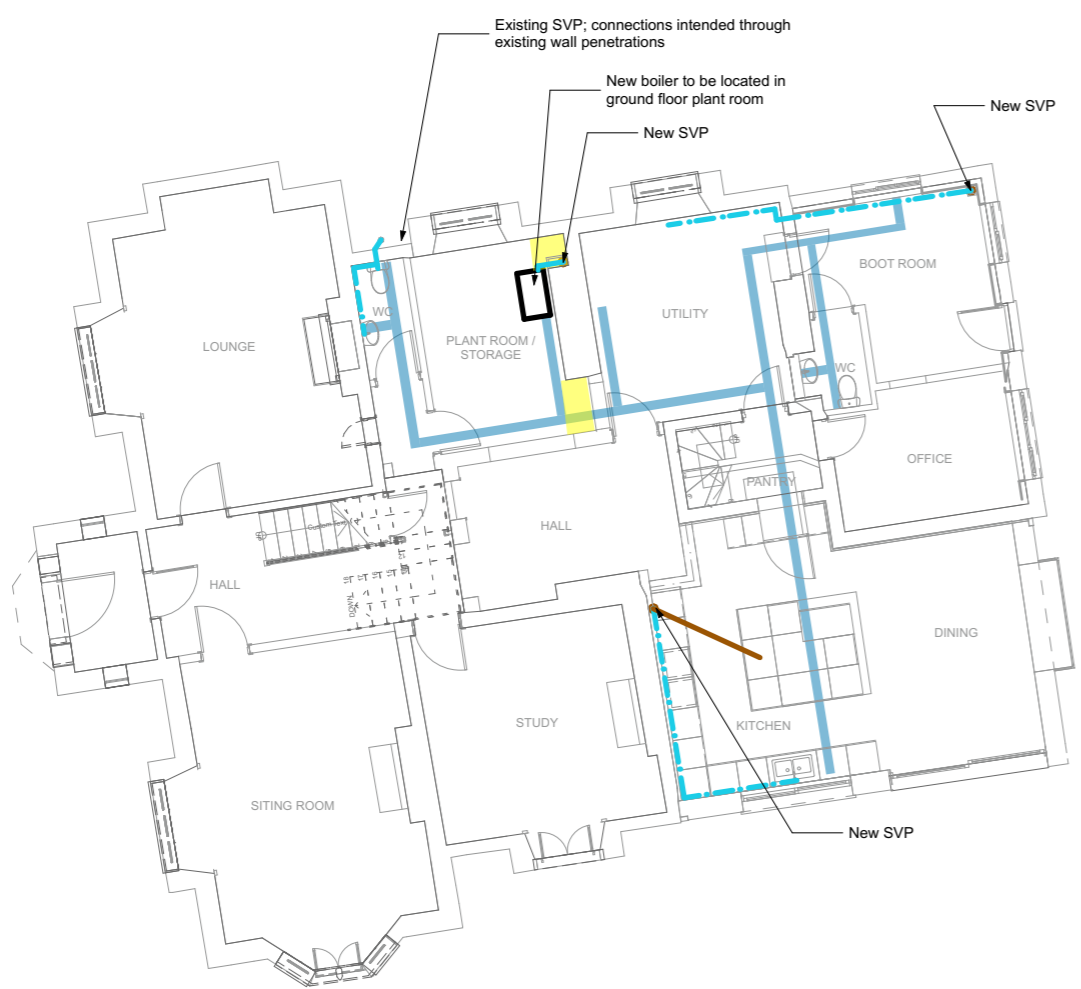

0. Ground Floor 1:150

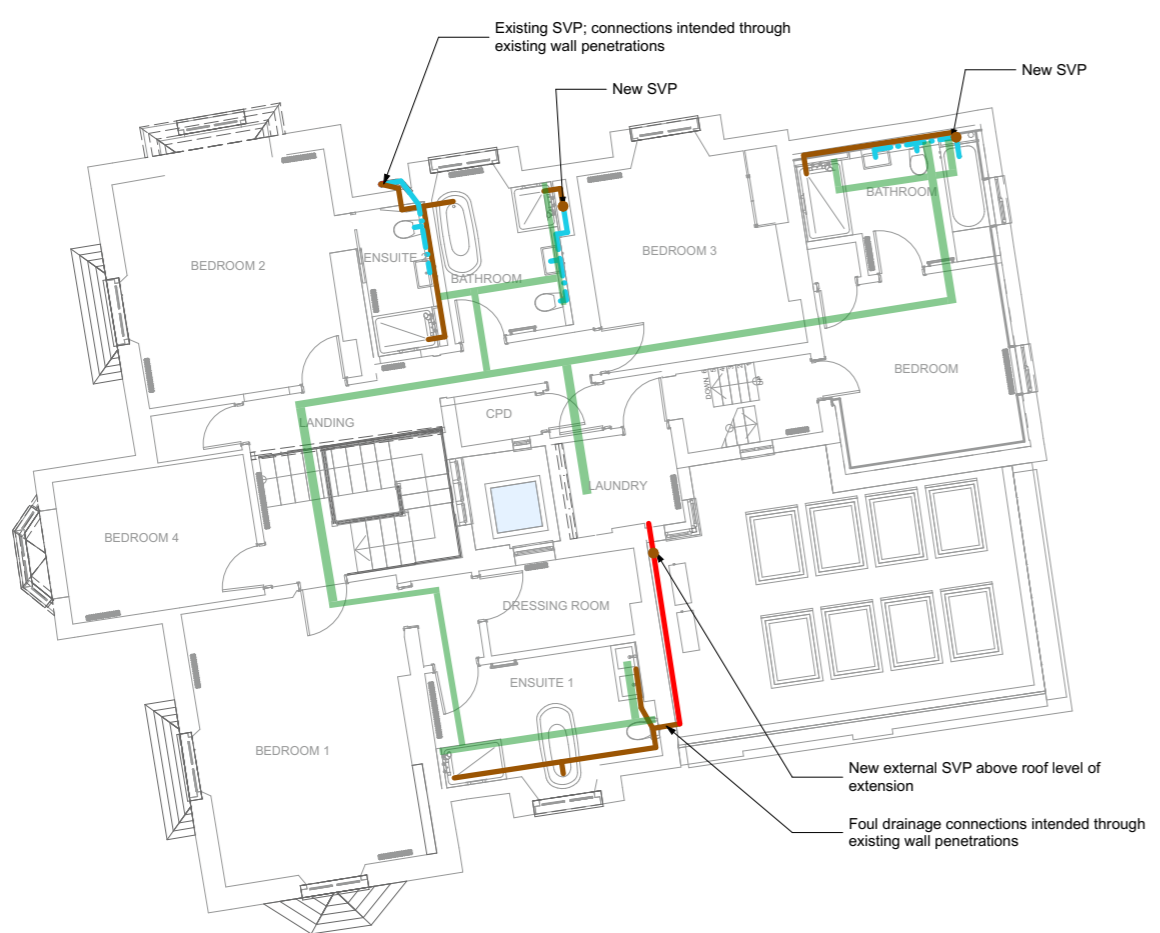

1. First Floor 1:150