

NOTES

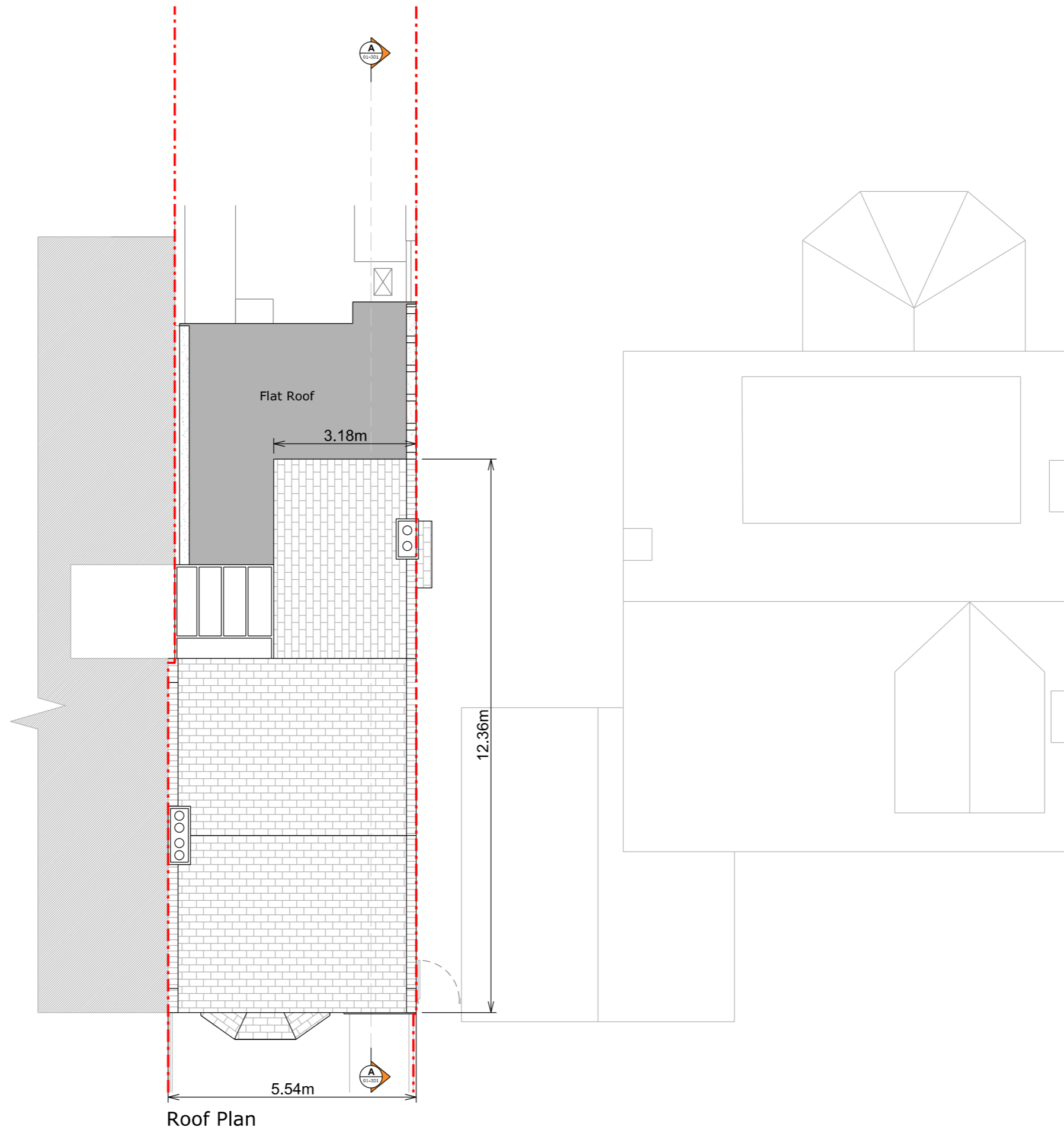

REV	DATE	DESCRIPTION
A	26-12-2023	Planning

STATUS

Planning

CLIENT

Nathalie Mendes & Lionel Healing

PROJECT

30 Denman Road, London SE15 5NP

DRAWING DESCRIPTION

Exsting Roof Plan

LOCAL AUTHORITY

Southwark Council

DRAWN BY

HD

CHECKED BY

NS

SCALE

1:100

SHEET SIZE

A3

DATE

26-12-2023

REVISION

A

DRAWING NO.

1236 - 01 - 103

SCALE BAR

