

Site Address:

32 Hunsdon Road, Oxford, OX4 4JE

PLANNING

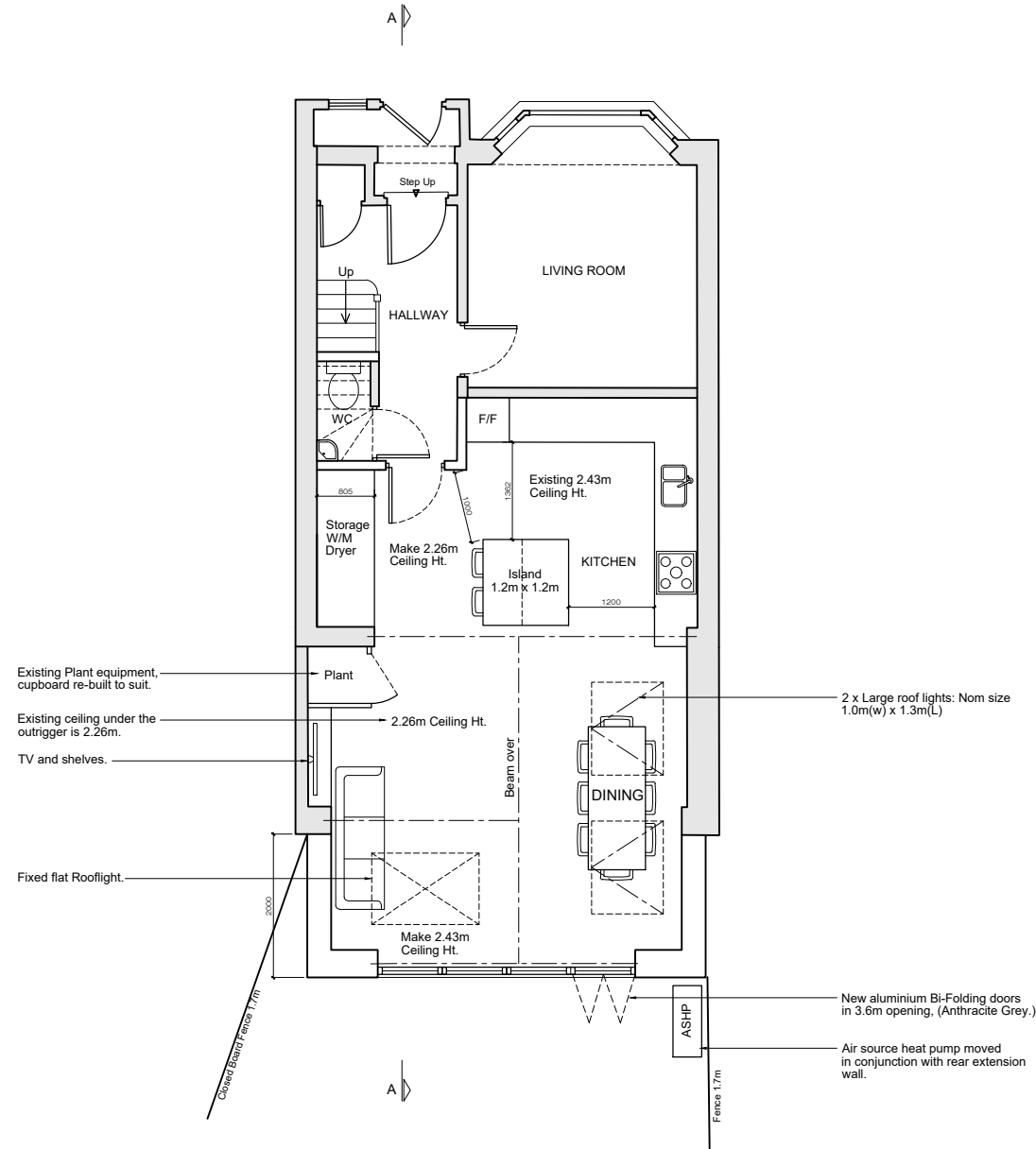

GROUND FLOOR - PROPOSED

Rev	Date	Description	Drn By
-	-	-	-
-	-	-	-
-	-	-	-

NOTES

1. This drawing is copyright of: Cherwell Design & Build Ltd. Reproduction is only to take place with our written authority.
2. These Plans are subject to 'Planning and Building Regulation Approval' or any other statute in law before building commences.
3. Any structural work where mentioned on the drawing is subject to a qualified structural and civil engineer calculations before building work commences.
4. All drawings marked preliminary or planning are not to be built or manufactured from.
5. If any discrepancies are found in the drawings these are to be brought to the attention of Cherwell D & B for rectification.
6. Boundary line indicative only. Exact location must be determined on site before building work commences.

Drawing Title:

Proposed Ground Floor

Project & Drawing Number:

Drawing Number.32HR_D-04

Rev:

/

Scale:

1:100

Sheet size:

A3

Date:

OCT'23

41 Hended St,
Oxford
OX4 2 EE
contact@cherwelldesign
build.co.uk
www.cherwelldesign
build.co.uk

