

Copyright Reserved
 The Contractor shall verify and be responsible for all dimensions. DO NOT scale the drawing - any errors or omissions shall be reported to Stantec without delay.
 The Copyrights to all designs and drawings are the property of Stantec. Reproduction or use for any purpose other than that authorized by Stantec is forbidden.

Notes
 UTILITIES NOTE: The position of any existing public or private sewers, utility services, plant or apparatus shown on this drawing is believed to be correct, but no warranty to this is expressed or implied. Other such plant or apparatus may also be present but not shown. The Contractor is therefore advised to undertake their own investigation where the presence of any existing sewers, services, plant or apparatus may affect their operations.

VEHICLE PROFILE:

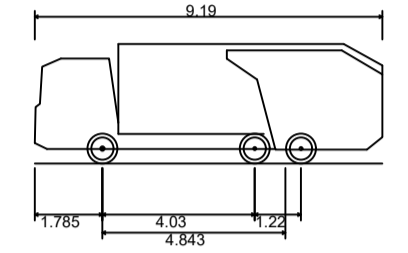

Oxford City 9.19m	9.190m
Overall Length	2.250m
Overall Width	3.162m
Overall Body Height	0.367m
Min Body Ground Clearance	2.250m
Track Width	4.00s
Lock to lock time	7.800m
Kerb to Kerb Turning Radius	

KEY:

— SITE BOUNDARY

P05 UPDATED MASTERPLAN	MH	EF	2023.12.20
P04 UPDATED MASTERPLAN	ML	EF	2023.11.15
P03 UPDATED MASTERPLAN	BS	EF	2023.02.02
P02 UPDATE TRACKING	BS	EF	2023.01.30
P01 ISSUE FOR ARCHITECT REVIEW	MH	EF	26/09/22
Issued/Revision	By	Appd	YYYY.MM.DD
	MH	EF	2022.09.23
	Dwn.	Dsgn.	Chkd.

Issue Status

FOR INFORMATION

This document is suitable only for the purpose noted above.
 Use of this document for any other purpose is not permitted.

Client/Project Logo

Client/Project
THE OXFORD SCIENCE PARK

PLOT 23 - 26, THE OXFORD SCIENCE PARK

Title
**VEHICLE SWEEP PATH ANALYSIS
 OXFORD CITY COUNCIL
 REFUSE VEHICLE (9.2m)**

Project No.	332110755	Scale	1:500
Revision	P05	Drawing No.	33211/5500/SK003

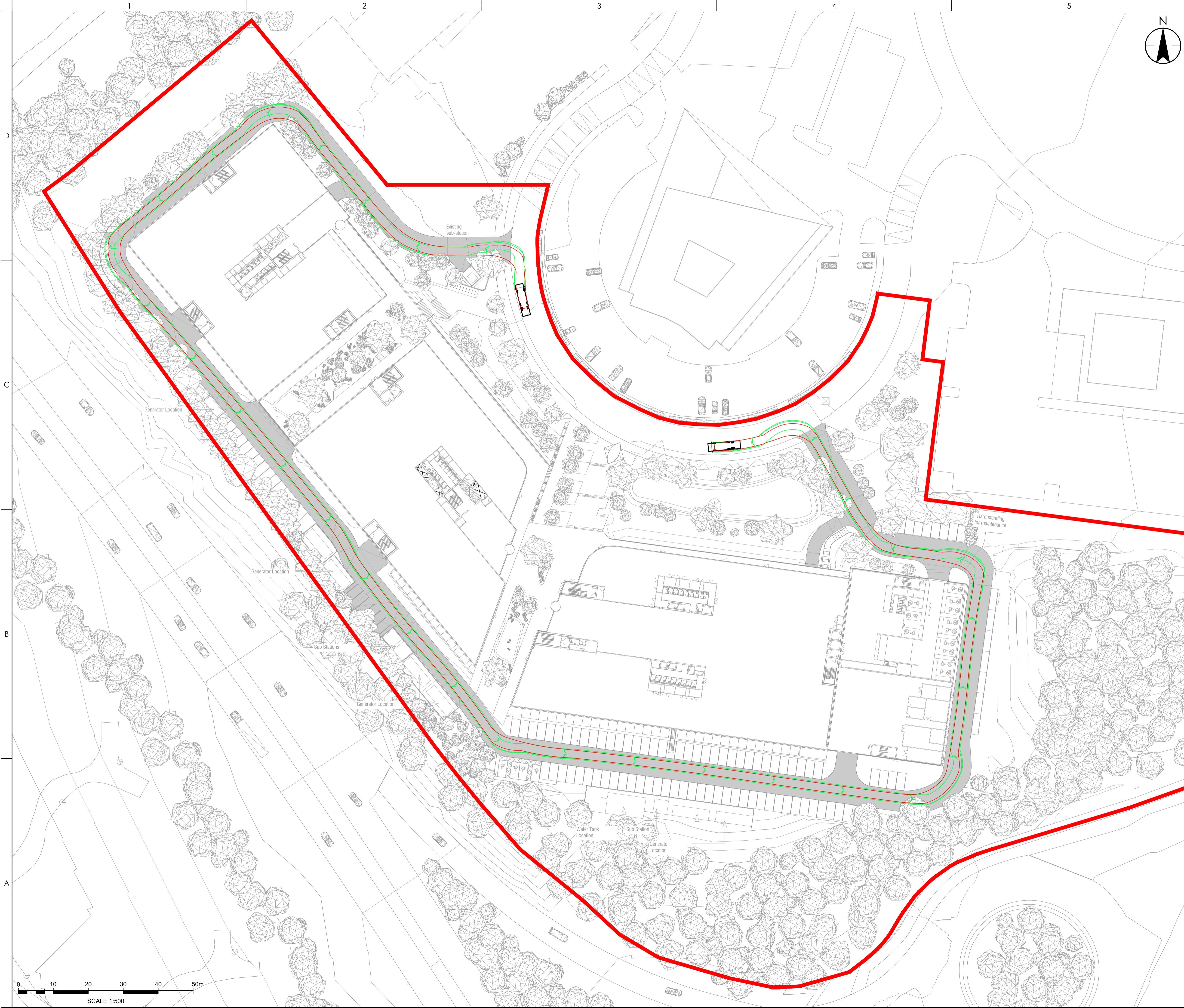

P:\0000\33211\332110755\1\01_Plan\01_Plan.dwg
 PLOT 23 - 26, THE OXFORD SCIENCE PARK
 DATE: 2023/12/20 15:20:28
 BY: M.H.
 CHECKED: M.H.
 APPROVED: M.H.
 PLOT 23 - 26, THE OXFORD SCIENCE PARK
 DATE: 2023/12/20 15:20:28
 BY: M.H.
 CHECKED: M.H.
 APPROVED: M.H.