

**DECORATIVE WALL FINISHES KEY**

Supply & install by Main contractor

**1 PAINTED T&G PANELLING**  
18mm MDF Tongue & Groove panels, applied directly to the existing wall finish, ensure any fixing points/ joints are sanded & filled prior to decoration.

**3 TILED FIREPLACE**  
Wall tiles to be installed:  
Supplier: Nick Firth Tiles Ltd - 0114 2619111  
Product: 300 x 70 Classic Verde  
Grout: Mapei Keracolor FF Tile Grout (Manhattan 2000)  
Refer to associated detail provided at tender stage.

**5 COCKTAIL BACKFITTING TILES**  
Supplier: Nick Firth  
Tel: 0114 261 9111  
Ref: Luxe 240 x 60mm  
Colour: Blanco  
Mortar Colour: Dove Grey

**6 COFFEE MODULE WALL TILES (FROM BACKFITTING TOP TO CEILING)**  
Wall tiles to be installed from top of vanity unit to ceiling:  
Supplier: Nick Firth Tiles  
Product: Luxe 240x60  
Finish: 75% Green and 25% Black  
Grout: Mapei Light Grey

**8 VAINTY UNIT WALL TILES (FROM VAINTY TO CEILING)**  
Wall tiles to be installed from top of vanity unit to ceiling:  
Supplier: Nick Firth Tiles  
Product: Luxe 240x60 Blue  
Grout: Mapei Light Grey

**9 TOILET CERAMIC WALL TILES (UP TO DADO)**  
Wall tiles to be install from floor up to dado to areas indicated:  
Supplier: Nick Firth Tiles Tel: 0114 261 9111  
Product: 600x300 Storm Beige Grout: Grey

**10 MOSAIC WALL TILES (FULL HEIGHT)**  
Mosaic wall tiles to be installed full height from floor to ceiling:  
Supplier: Porcel Ceram Tel: 01924 366365  
Grout: Cream to match tile  
Product: Ontario 50 x 50mm Mosaic Tile

**11 GREY SANICLAD (FULL HEIGHT)**  
Hygienic grey saniclad for use in wet areas visible to guests.

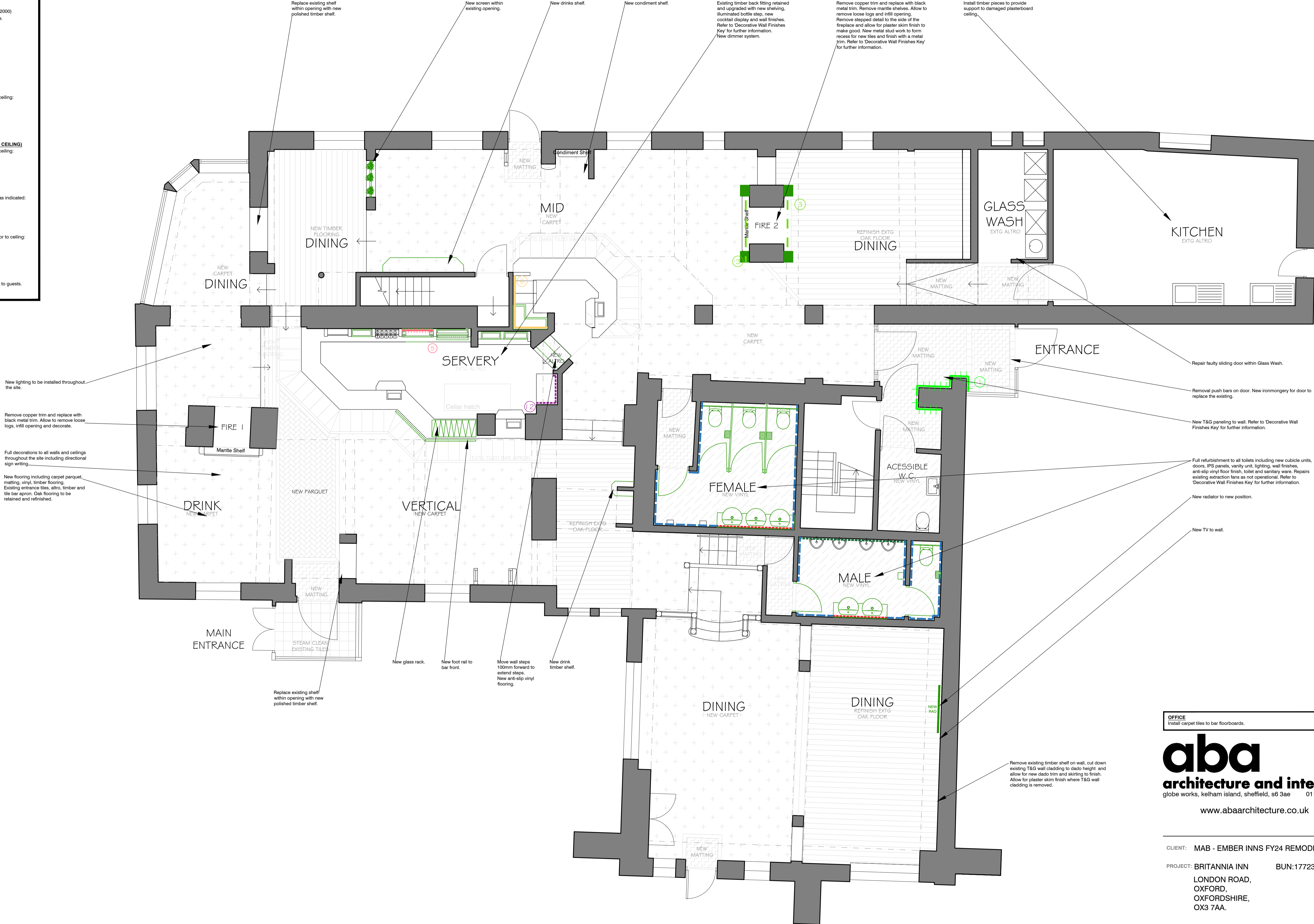

**OFFICE**  
Install carpet tiles to bar floorboards.



CLIENT: MAB - EMBER INNS FY24 REMODEL

PROJECT: BRITANNIA INN BUN:177237  
LONDON ROAD,  
OXFORD,  
OXFORDSHIRE,  
OX3 7AA.

TITLE: PROPOSED GROUND FLOOR LAYOUT

INITIALS: HB DATE: SEPT 23 SCALE: 1:50 (A1)

NUMBER: 2536-204 REV: --- STATUS: PLANNING / LB

