

**PLEASE NOTE:**  
 Critical dimensions to be checked on site. If less than 1m from boundary then new windows and doors on first floor will be non-compliant with fire regulations being in close proximity to the boundary. All openings would need to be fixed shut require a 30 minute fire specification. All windows on this elevation would need fixing shut and 30 minute fire resistant to the window frames. In the instance of the utility the door would need to be fixed shut and the door would need an increased specification if remained.

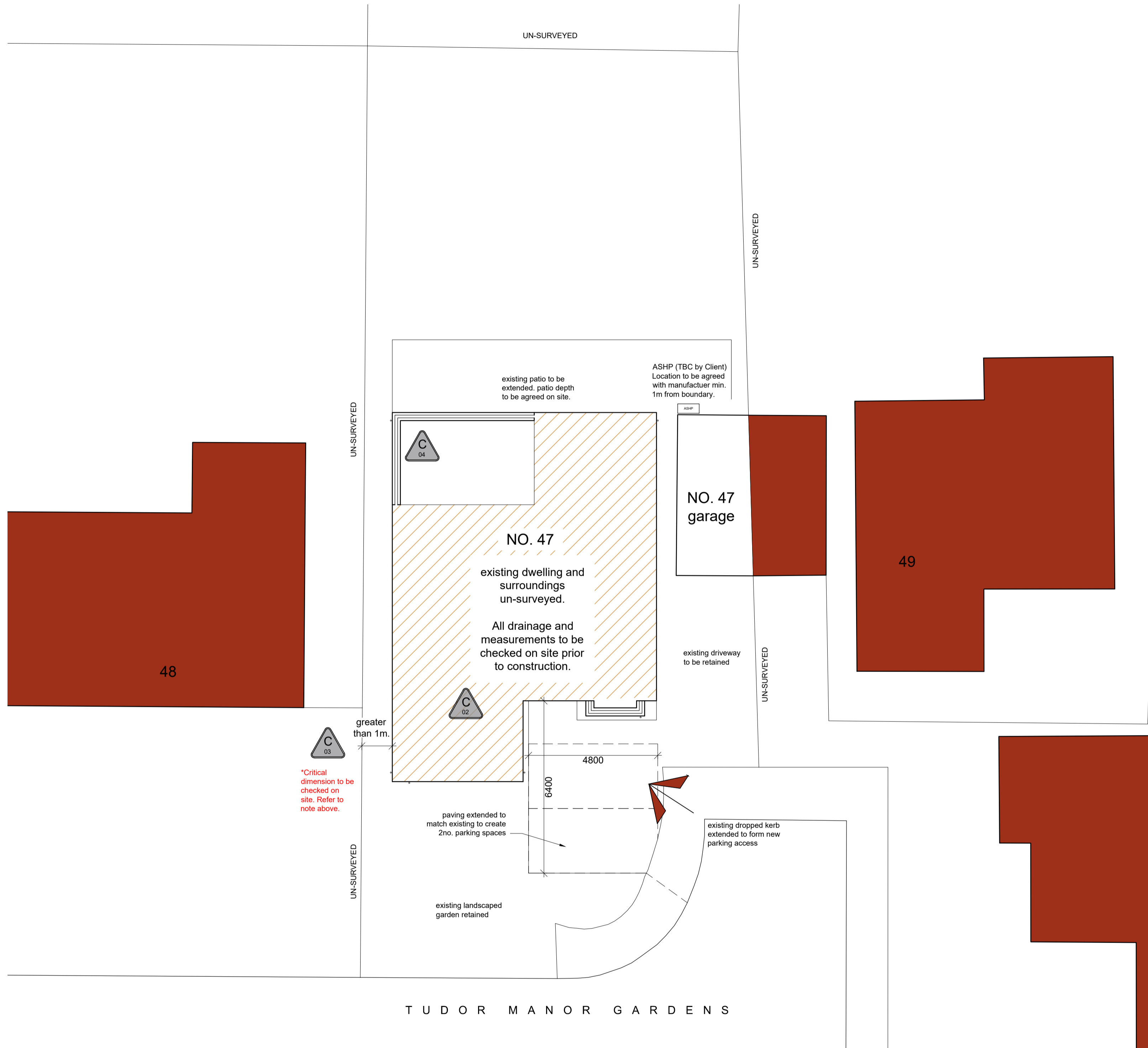

Site Plan  
 Scale: 1:100

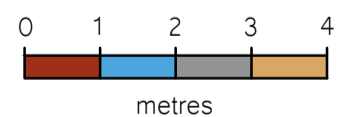

Site Plan Key

- Indicates proposed site access
- Indicates existing dwelling (unsurveyed)
- indicates new construction
- Indicates adjacent dwellings (unsurveyed)
- ASHP (TBC by Client)  
Location to be confirmed by manufacturer. Min. 1m away from boundary.

**EXISTING DRAINAGE**  
 All existing drainage is to be investigated and checked on site prior to making any connections. connections to be agreed with building control officer on site.



Location Plan  
 Scale: 1:100

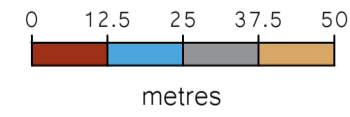

- General Notes**
1. This drawing shall not be scaled, figured dimensions only to be used.
  2. All dimensions are shown in 'mm' unless otherwise stated.
  3. The contractor, sub-contractors and suppliers must verify all dimensions on site prior to the commencement of any work.
  4. This drawing is to be read in conjunction with all relevant engineers and specialist sub-contractors drawings and specifications.
  5. Any discrepancies are to be brought to the designers attention.
- Existing building un-surveyed. All dimensions to be checked on site prior to construction.
  - All dimensions within brickwork are to brick openings / courses.
  - All kitchens are shown indicatively and are to be detailed separately in conjunction with Client's Kitchen Designer.
  - Electrical positions and sizes are indicative only and are to be designed by the Client's Mechanical & Electrical Contractor ensuring sensible furniture layouts can be achieved.
  - All structural elements are to be designed by the Client's Structural Engineer, including movement joints.
  - Drainage is to be investigated and confirmed on site.

**SITE RISK NOTIFICATION KEY**

|     |   |
|-----|---|
| C01 | Demolition of Part of Existing Building |
| C02 | Un-Surveyed Site                        |
| C03 | Close Adjacent Boundary                 |

Status  
**PRELIMINARY**

**SWANN EDWARDS ARCHITECTURE**  
 Swann Edwards Architecture Limited, Swann Edwards Architecture, Black Barn, Fen Road, Guyhirn, Watford, Cambs. PE13 4AA  
 t 01945 450694 e info@swannedwards.co.uk w www.swannedwards.co.uk

|   |                                       |                                      |
|---|---------------------------------------|--------------------------------------|
| Job Title<br>Proposed Residential Dwelling<br>47 Tudor Manor Gardens<br>Watford<br>for Ms. L. Swaby | Date<br>October<br>2023               | Drawn by<br>AL<br>Checked by<br>GL   |
| Drawing Title<br>Building Regulations<br>Site Plan  | Job No.<br>SE-2033<br>Dwg No.<br>1100 | Sheet Size<br>A1<br>Revision<br>PP01 |