

Cross Section.

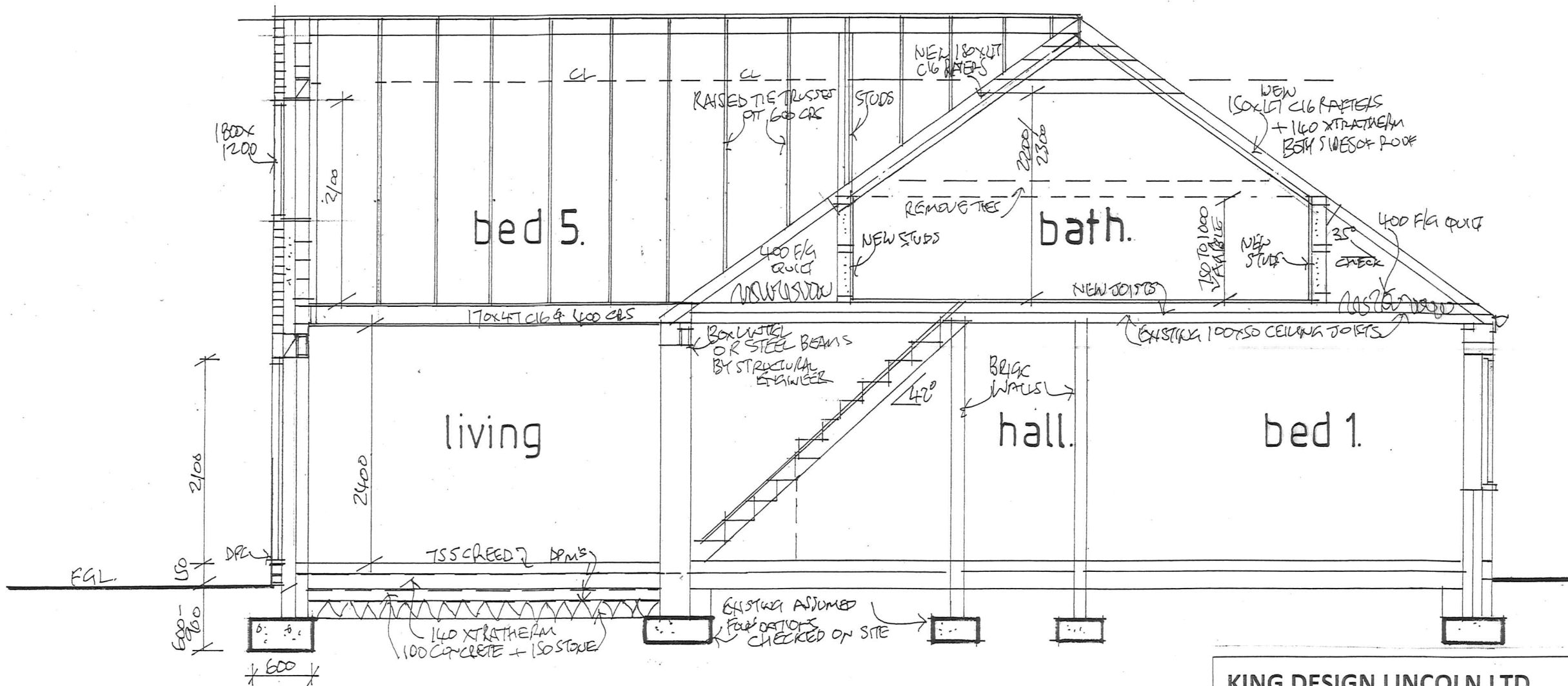

KING DESIGN LINCOLN LTD. HEIGHINGTON LINCOLN	
PROPOSED REAR EXTENSION AND LOFT CONVERSION TO DWELLING. location 7 SUNBEAM AVENUE, NORH HYKEHAM LINCOLN.	
owner MR. + MRS. M. PEEL.	
drawing title PROPOSED CROSS SECTION.	
scale 1:50.	drawing no. MP/0312/2023./A