

LOCATION
PLAN

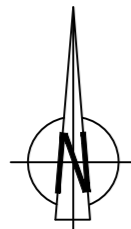

EXISTING
SITE LAYOUT

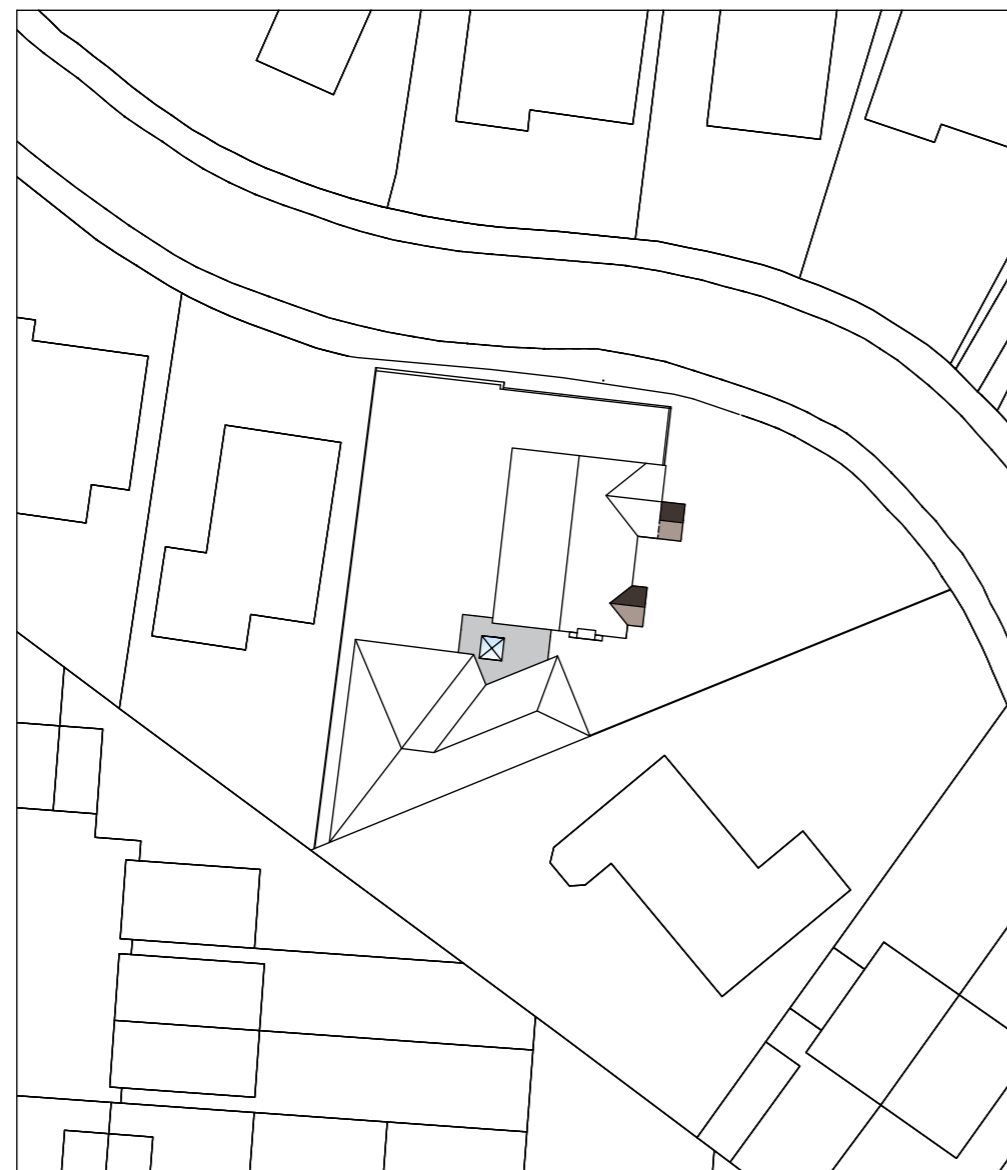

PROPOSED
SITE LAYOUT



Greetwell Place - 2 Limekiln Way - Greetwell Road - Lincoln - LN2 4US

Project: PROPOSED EXTENSIONS, ALTERATIONS TO DWELLING AND ALTERATIONS TO EXISTING BOUNDARY TREATMENTS
45, Hebden Moor Way, North Hykeham, Lincoln.

Client: Ms. M. Walters.

Scale @ A2:
1:500 / 1:1250

Date:
Dec.23

Dwg No:
105/23/03

Plan: SITE DETAILS

Revised: