

Co-ordinate table			
Station	Easting	Northing	Level
1	561805.094	194176.794	82.923
2	561742.435	194176.436	83.086
4	561755.996	194156.730	83.409
5	561755.774	194154.352	83.330
6	561747.359	194145.263	83.345
61	561746.776	194136.166	83.336

All levels related to Ordnance Survey active GPS network, of survey station J. Value 83.441m

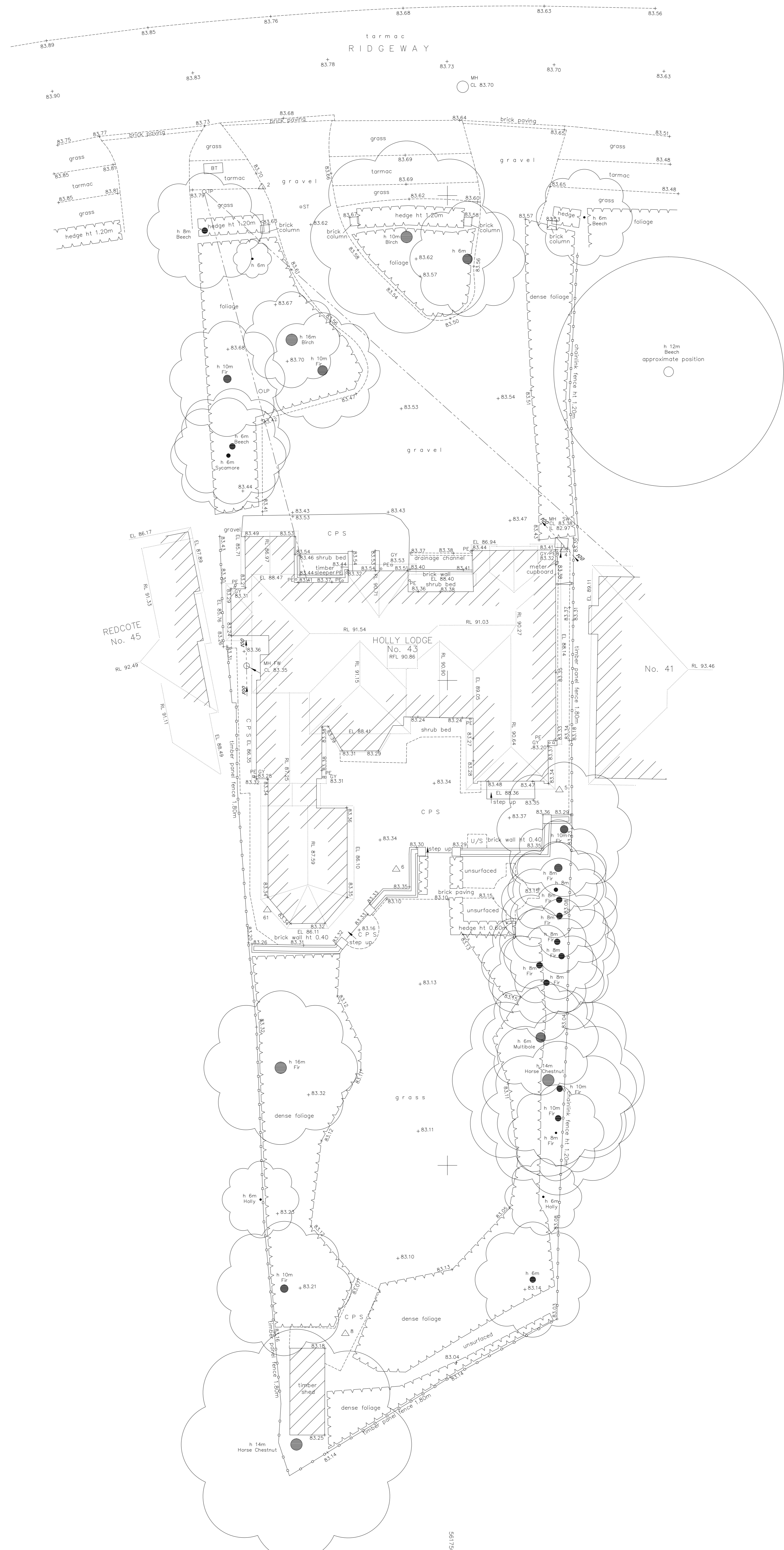

DISCLAIMERS
This survey is related to OSGB36(15) coordinate system by GPS 'rapid static' methods. No scale factor has been applied to the survey information. All horizontal distances taken from this drawing are ground distances.

Every effort has been made to confirm tree species on site, yet it is advised to confirm these details with an arborist before proceeding with any design.

Every effort has been made to confirm drainage run, type and size on site, yet it is advised to check these details against statutory authority records before proceeding with any design.

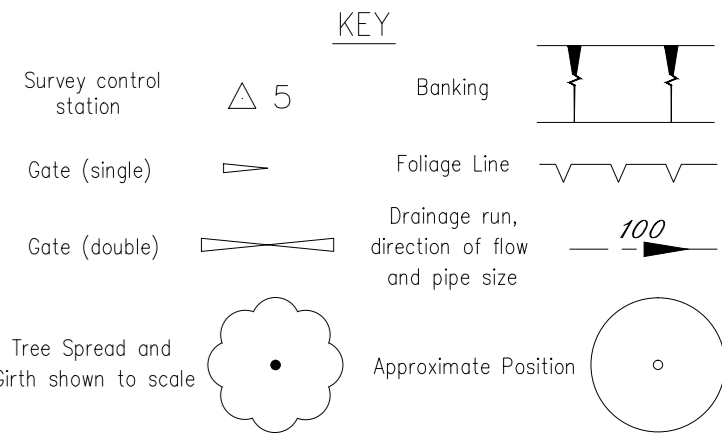

Client
MALCOLM DENMARK

Project
**HOLLY LODGE
43 RIDGWAY
HUTTON MOUNT CR13 2LJ**

Title
TOPOGRAPHICAL SURVEY

Drawing Number
T318-338-1

Revision	Description	Date

Scale 1:100@A0 **Sheet** 1 of 1

Drawn by	Checked by	Date of Survey
AJB	GK	July 2019

Tel 01438 841300
enquiries@terrainsurveys.co.uk
www.terrainsurveys.co.uk

Accreditations

CHAS
Certificate Number 7198
501902

Constructionline
gold member

Approved Contractor
CHAS.co.uk

