

Tree Work Schedule

No.	Species	Works	Category
T05	Decider Cedar	Plans to achieve 2m clearance of the existing building and proposed mansard roof. This will be achieved by pruning of lary order branches only. Branches growing at 2m above ground level and higher will remain attached.	A2
T06	Decider Cedar	Plans to achieve 2m clearance of the existing building and proposed mansard roof. This will be achieved by pruning of lary order branches only. Branches growing at 2m above ground level and higher will remain attached.	A2

All tree work is to be undertaken in accordance with British Standard BS 3998:2010 Tree Work - Recommendations. All stumps are to be removed and the site is to be left as found. Care is to be taken of the ground around retained trees to make sure that it does not become compacted as a result of heavy machinery operations. No equipment or vehicles such as timber forklifts, tractors, excavators or cranes shall be parked or driven beneath the crowns of any retained trees, to prevent subsequent compaction and root death.

Canopy Spread Sections

T05 southern canopy spread sections by height:	T06 southern canopy spread sections by height:
5.5m	5.7m
7m	7.5m
8.5m	8.8m
12m	10m
	13.7m

Protective Fencing

To be erected prior to the commencement of all works on site, and retained in place throughout construction.
 Detail Specification: To comprise either 2.4m wooden site hoarding; or 2.3m high scaffolding framework comprising of vertical and horizontal framework, well braced to resist impacts, with uprights to be spaced at a maximum of 3.0m intervals and driven into the ground by a minimum of 600mm. On the standard and chain welded mesh panels are to be securely fixed to each other with at least two scaffold clamps and to the scaffold framework with wire.
 Secondary Specification: To comprise of 2m tall welded mesh panels on rubber or concrete feet. Panels are to be joined together using a minimum of two anti-lantern couplers, installed so that they can only be removed from inside the fence. The panels should be supported on the inner side by stabilizer struts, which should be attached to a base plate and secured with ground pins.
 All weather notices should be erected at regular intervals on the weld mesh panels with words such as "Construction exclusion zone - Keep Out".

Tree Protection Area KEEP OUT

DO NOT CROSS PLANNING ACT 1990
 TREES ENCLOSED BY THIS FENCE ARE PROTECTED BY PLANNING CONDITIONS AND THE USE OF THIS FENCE MAY LEAD TO PENALTIES FOR BREACH OF A TREE PROTECTION ORDER.
 ANY INCURSION INTO THE PROTECTED AREA MUST BE WITH THE WRITTEN PERMISSION OF THE LOCAL PLANNING AUTHORITY.

Ground boarding

New temporary ground protection should be capable of supporting any traffic entering or using the site without being disturbed or causing compaction of underlying soil.
 Note: The ground protection might comprise one of the following:
 a) for pedestrian movements only, a single thickness of scaffold boards placed either on top of a driven scaffold frame, or to form a suspended walkway, or on top of a compression-resistant layer (e.g. 100mm depth of crushed stone), laid onto a geotextile membrane;
 b) for pedestrian-operated plant up to a gross weight of 2t, proprietary inter-locked ground protection boards placed on top of a compression-resistant layer (e.g. 150mm depth of crushed stone), laid onto a geotextile membrane;
 c) for wheeled or tracked construction traffic, exceeding 2t gross weight, an alternative system (e.g. proprietary system or pre-cast reinforced concrete slabs) to an engineering specification designed in conjunction with arboricultural advice, to accommodate the likely loading to which it will be subjected.
 For situations other than those described in a) or b), the ground boarding is to be designed by a suitably qualified person to an engineering specification in conjunction with arboricultural advice, to be able to support the expected loading to be placed upon it.
 In all cases, the objective of the ground boarding is to avoid compaction of the soil beneath, so that tree root function remains unimpacted.

Construction exclusion zone

A construction exclusion zone (CEZ) is a designated area where there is to be no construction activity whatsoever. Access to the area for construction personnel or machinery is strictly prohibited and there is no scope for materials or waste storage etc.



Unit 3, Well House Barrs, Chester, CH4 0DH
<https://arbtech.co.uk>, 01244 661170

Project: Marian Court, Robin Hood Lane, Sutton, SM1 2SB
 Client: M&D Properties Investment Ltd

Drawing: Tree Protection Plan
 Based on: 000MA-A-03-101

Drawing No: Arbtech TPP 01
 Date: Dec 2023
 Scale: 1:50 @ A0
 Drawn: EK

Key:

Tree No.	T01	Tree Category	Category 'A' trees	Trunk	Category 'C' trees
RPA	Category 'A' trees	Category 'B' trees	Category 'C' trees	Category 'D' trees	Category 'E' trees
Category 'F' trees	Category 'G' trees	Category 'H' trees	Category 'I' trees	Category 'J' trees	Category 'K' trees
Existing Site (Type)	Proposed Site	Proposed Ground Boarding	Proposed Protective Fencing	Proposed Arboricultural Supervision	Proposed Construction Exclusion Zone
Proposed Arboricultural Supervision	Proposed Construction Exclusion Zone	Proposed Construction Exclusion Zone	Proposed Construction Exclusion Zone	Proposed Construction Exclusion Zone	Proposed Construction Exclusion Zone

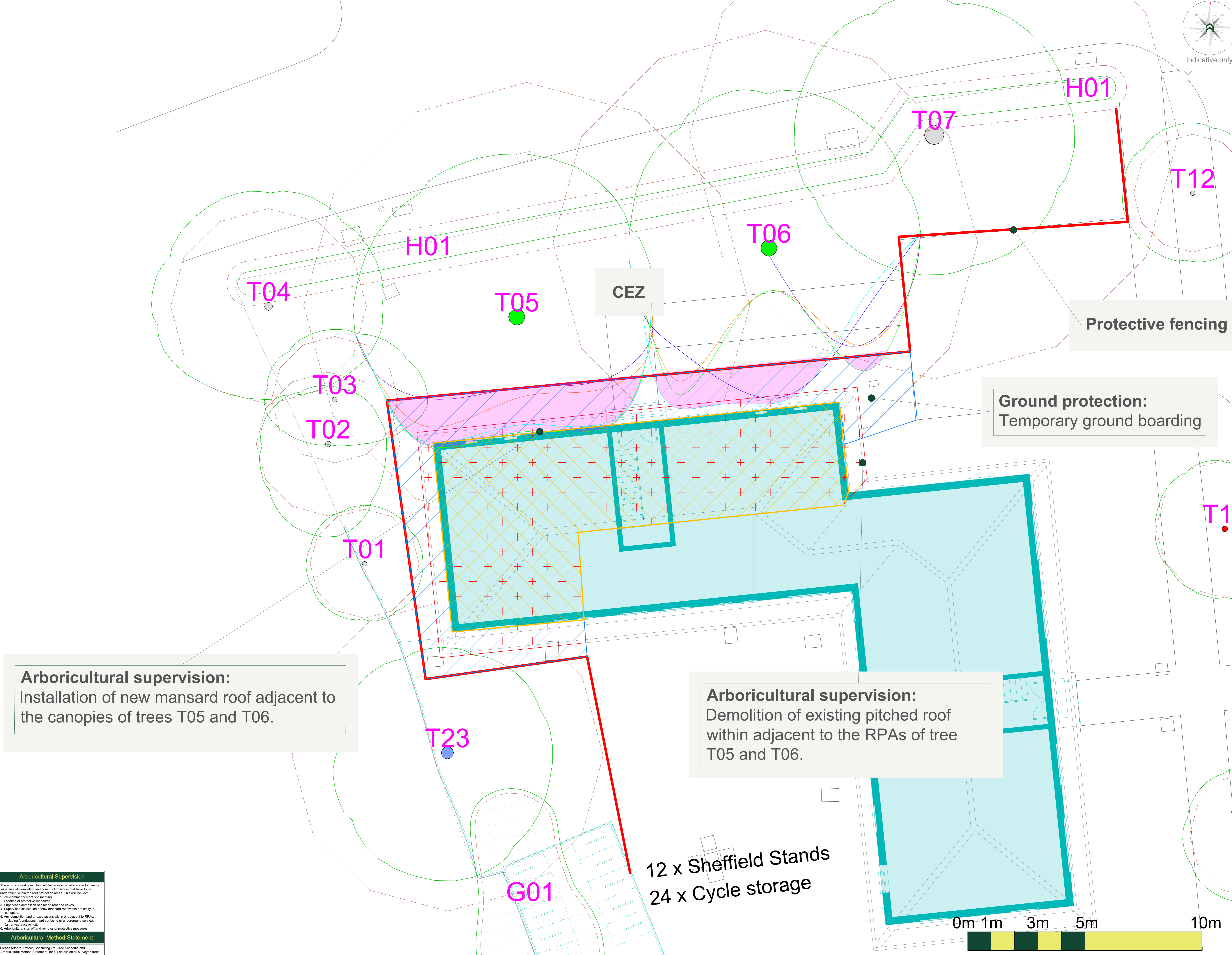

Arboricultural supervision:
 Installation of new mansard roof adjacent to the canopies of trees T05 and T06.

Arboricultural supervision:
 Demolition of existing pitched roof within adjacent to the RPAs of tree T05 and T06.

12 x Sheffield Stands
 24 x Cycle storage



Arboricultural Supervision
 The arboricultural consultant will be required to attend site to directly supervise all demolition and construction works that have to be undertaken within the root protection areas. This will include:
 1. Pre-commencement site meeting
 2. Location of protective measures
 3. Supervised demolition of pitched roof and awnings
 4. Supervised installation of new mansard roof within proximity to canopies
 5. Any demolition and/or excavations within or adjacent to RPAs, including foundations, hard surfacing or underground services (a non-exhaustive list)
 6. Arboricultural sign off and removal of protective measures.

Arboricultural Method Statement
 Please refer to Arbtech Consulting Ltd Tree Schedule and Arboricultural Method Statement, for full details on all surveyed trees and how all aspects of the development may be implemented without detriment to retained trees.