

INSPECTIONS REQUIRED BY THE HIGHWAYS INSPECTOR

The contractor shall give advance notice to Suffolk county council to allow the inspector proper inspection and checking of the works at the following designated stages:

- 1) Prior to start of works a photographic record of existing highway condition adjacent to development to be agreed and recorded
- 2) Start of the works
- 3) Before back filling any trenches under new highway
- 4) Completion of formation
- 5) Completion of sub-base
- 6) Arrival and planting of trees
- 7) Laying of base
- 8) Laying of binder course
- 9) Laying of surface course
- 10) All damage to existing highway resulting from construction traffic to be repaired before the inspector will be recommend works for interim/adoption

No street light shall be installed until its final position has been agreed with the street lighting engineer

CDM REGULATIONS HEALTH AND SAFETY INFORMATION FOR THE LIFETIME OF THE DEVELOPMENT

The hazards noted are in addition to the normal hazards and risks faced by a competent contractor when dealing with the type of works detailed on this drawing.

CONSTRUCTION RISKS:

1. Confined spaces entry and hazardous waste materials / gas.
2. Deep manholes / excavations
3. Contractor to locate services prior to excavating.
4. Asbestos may be present.
5. Drainage connection requires deep excavation temp works required.
6. Existing drains to be protected and bridged over where required.
7. Works adjacent to busy road and river. Watercourse / ditch levels may rise rapidly following prolonged periods of rainfall.
8. Soft ground during construction works particularly in wet weather.

MAINTENANCE/CLEANING RISKS:

1. Pavement deformations to be monitored to ensure that designed pavement falls are maintained. If significant deformation is allowed to propagate then localised flooding could occur.
2. Silt traps, drainage channels, permeable pavements and inspection chambers require the standard periodic inspection regime and cleaning routine to ensure continued performance and reduce the risk of flooding.
3. Works adjacent to Watercourse / ditch. Watercourse / ditch levels will vary during heavy rainfall events.
4. Potential for soft spots within existing ground after heavy rainfall.
5. Dust and noise impacts on local community.
6. Existing live services and utilities.
7. Deep manholes / excavations - appropriate entry equipment required.
8. Soft ground during construction works particularly in wet weather.

DEMOLITION / ADAPTION RISKS:

1. Apparatus located in landscaped areas has not been designed to support heavy vehicle loading.
2. The surface water drainage apparatus has been designed to accommodate the designed catchment area. no additional areas of hardstanding can be connection into the system without risk of localised flooding on site.
3. Hazardous waste materials / dust and debris released into the air.
4. Deep manholes / excavations - appropriate entry equipment required.
5. Works adjacent to river. Watercourse / ditch levels will vary during heavy rainfall events.
6. Unknown ground conditions during / after heavy rainfall.
7. Soft ground during construction works particularly in wet weather.

PRELIMINARY DRAWING:

This drawing is for preliminary purposes only and must not be read as a construction issue. The design is not fixed and design changes are likely.

Rev	Date	Description	By	Check
P1	28.07.23	Preliminary	JS	JRS

Copyright: The copyright of this drawing is vested in Schema Engineering Ltd. To be read in conjunction with all other project related drawings, reports and surveys etc. It shall not be used without permission by anyone for any purpose. Do not scale this drawing electronically or manually. Work to figured dimensions only. All dimensions are in metres unless stated otherwise. Do not turn on layers that have been turned off. Do not thaw layers that have been frozen.

Client	Cockledge Building Contractors		
Project	Barret's Lane, Needham Market Suffolk IP68DL		
Title	Section 38 Plan General Arrangement		
Scale @ A1	1:300	Status	Preliminary



Date	July 2023	Job Number	0304	By	JS	Checked By	JRS
-------------	-----------	-------------------	------	-----------	----	-------------------	-----

Drawing No.	C450	Revision	P1
--------------------	------	-----------------	----

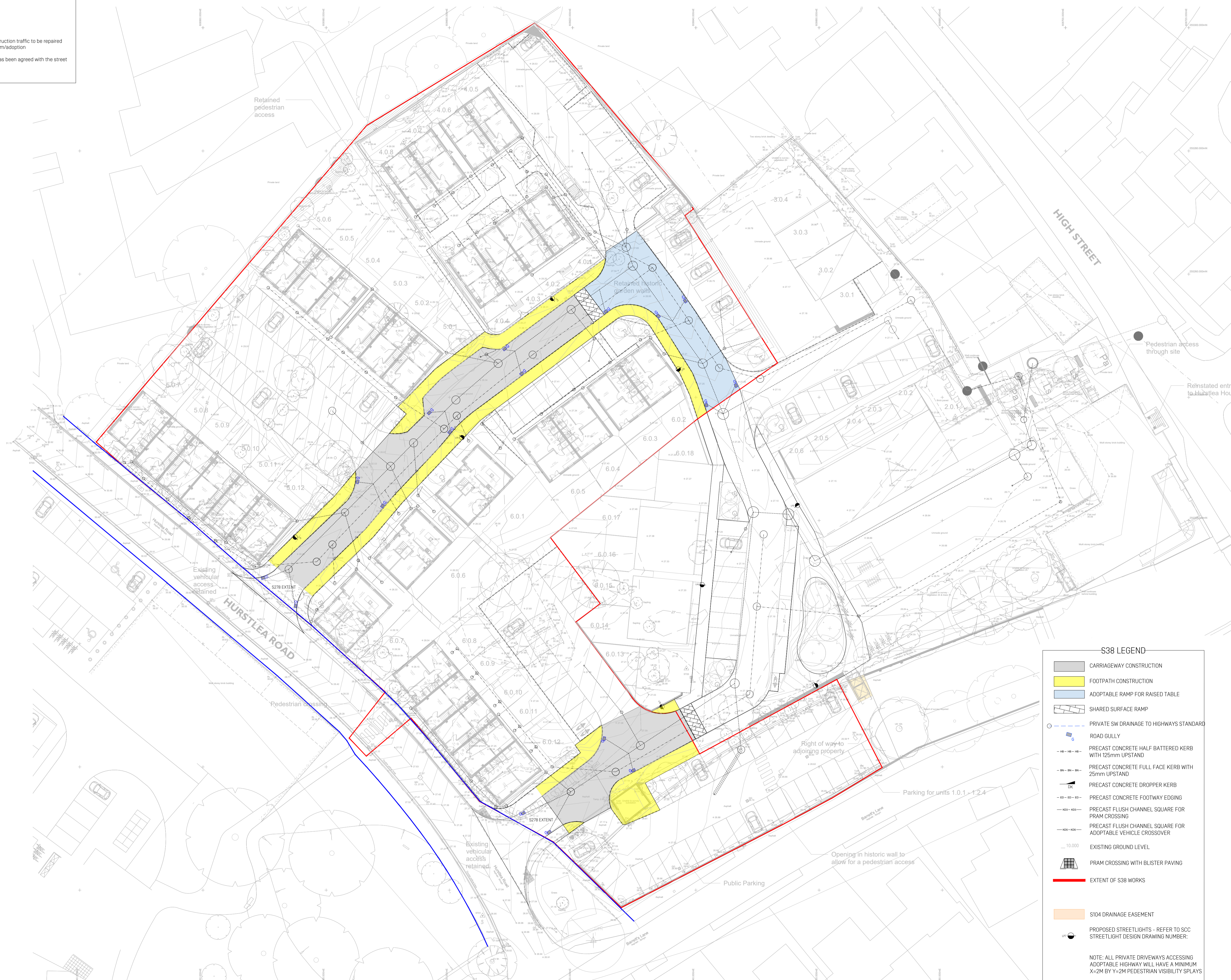

S38 LEGEND

- CARRIAGEWAY CONSTRUCTION
- FOOTPATH CONSTRUCTION
- ADOPTABLE RAMP FOR RAISED TABLE
- SHARED SURFACE RAMP
- ROAD GULLY
- PRIVATE SW DRAINAGE TO HIGHWAYS STANDARD
- PRECAST CONCRETE HALF BATTERED KERB WITH 125mm UPSTAND
- PRECAST CONCRETE FULL FACE KERB WITH 25mm UPSTAND
- PRECAST CONCRETE DROPPER KERB
- PRECAST CONCRETE FOOTWAY EDGING
- PRECAST FLUSH CHANNEL SQUARE FOR PRAM CROSSING
- PRECAST FLUSH CHANNEL SQUARE FOR ADOPTABLE VEHICLE CROSSOVER
- EXISTING GROUND LEVEL
- PRAM CROSSING WITH BLISTER PAVING
- S104 DRAINAGE EASEMENT
- PROPOSED STREETLIGHTS - REFER TO SCC STREETLIGHT DESIGN DRAWING NUMBER:

NOTE: ALL PRIVATE DRIVEWAYS ACCESSING ADOPTABLE HIGHWAY WILL HAVE A MINIMUM X=2M BY Y=2M PEDESTRIAN VISIBILITY SPLAYS