

TYPICAL DETAIL FOR PROTECTION TO PIPES IN CLOSE PROXIMITY OF FOUNDATIONS WHERE PIPE TRENCH IS LOWER THAN ADJACENT FOUNDATIONS
(not to scale)

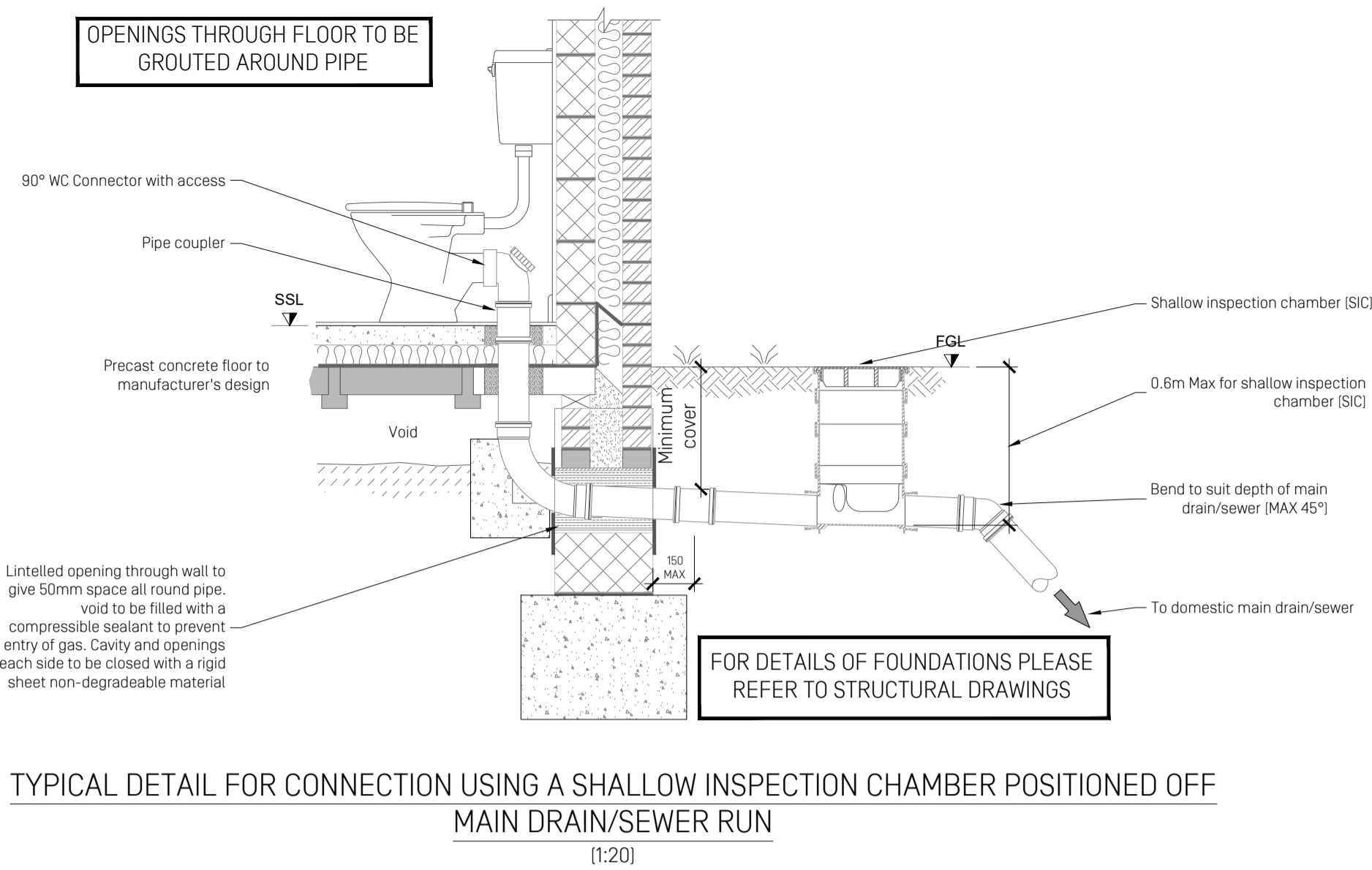

TYPICAL DETAIL FOR CONNECTION USING A SHALLOW INSPECTION CHAMBER POSITIONED OFF MAIN DRAIN/SEWER RUN
(1:20)

DETAIL SHOWS CONNECTION TO WC, BUT SIMILAR DETAIL FOR CONNECTION TO SOIL VENT PIPES, STUB STACK PIPES, WASTE WATER ETC

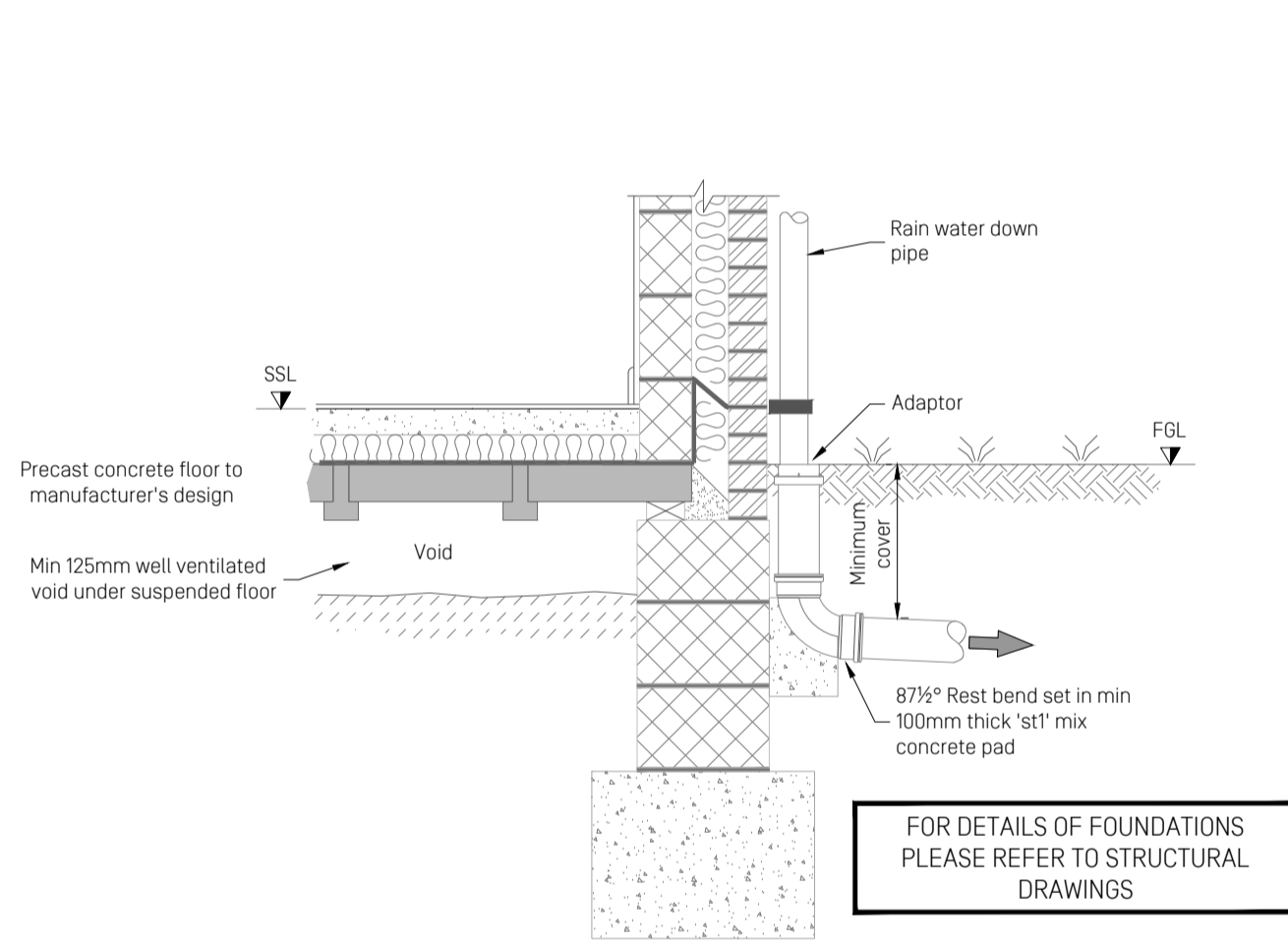

TYPICAL DETAIL FOR CONNECTION TO EXTERNAL RAIN WATER PIPE
(1:20)

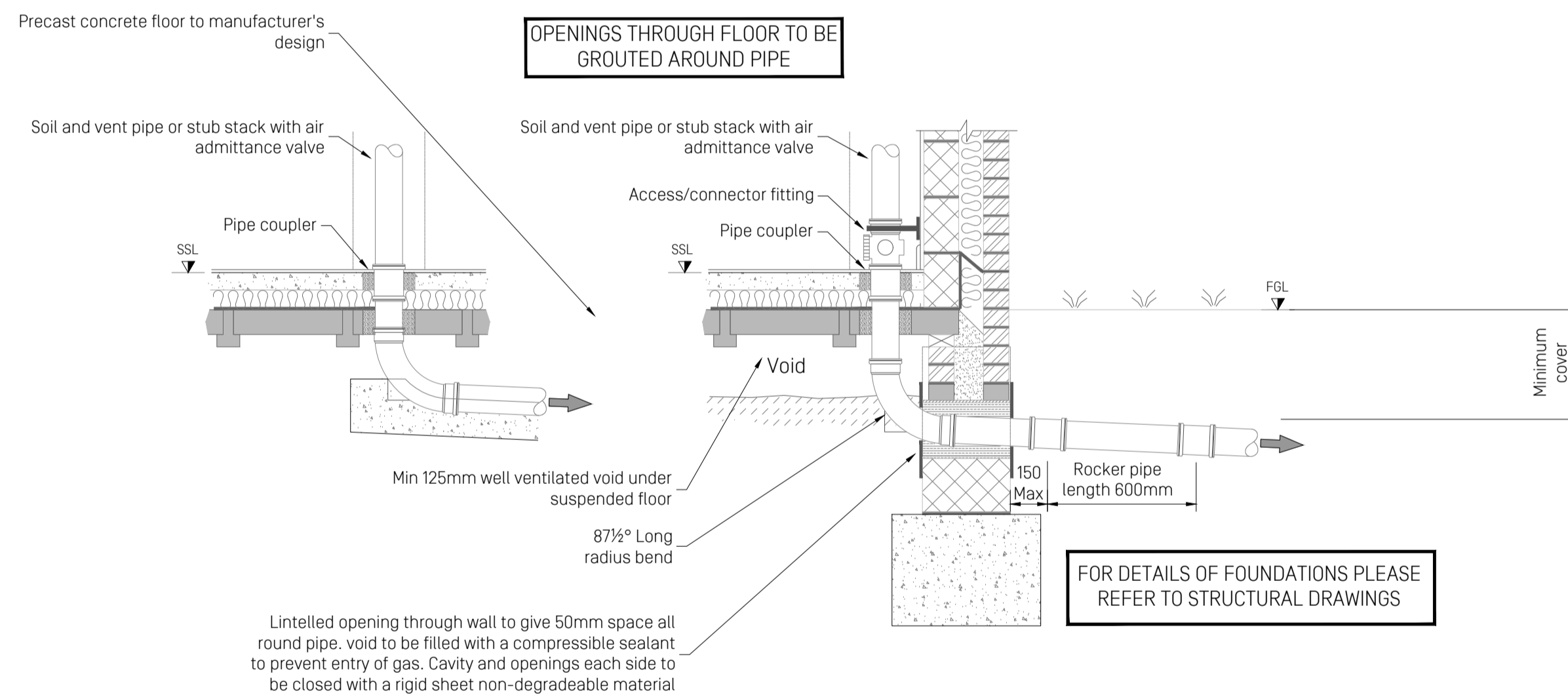

TYPICAL DETAIL FOR CONNECTION TO INTERNAL SOIL AND VENT PIPES AND PIPE RUNNING UNDER FLOOR SLAB
(1:20)

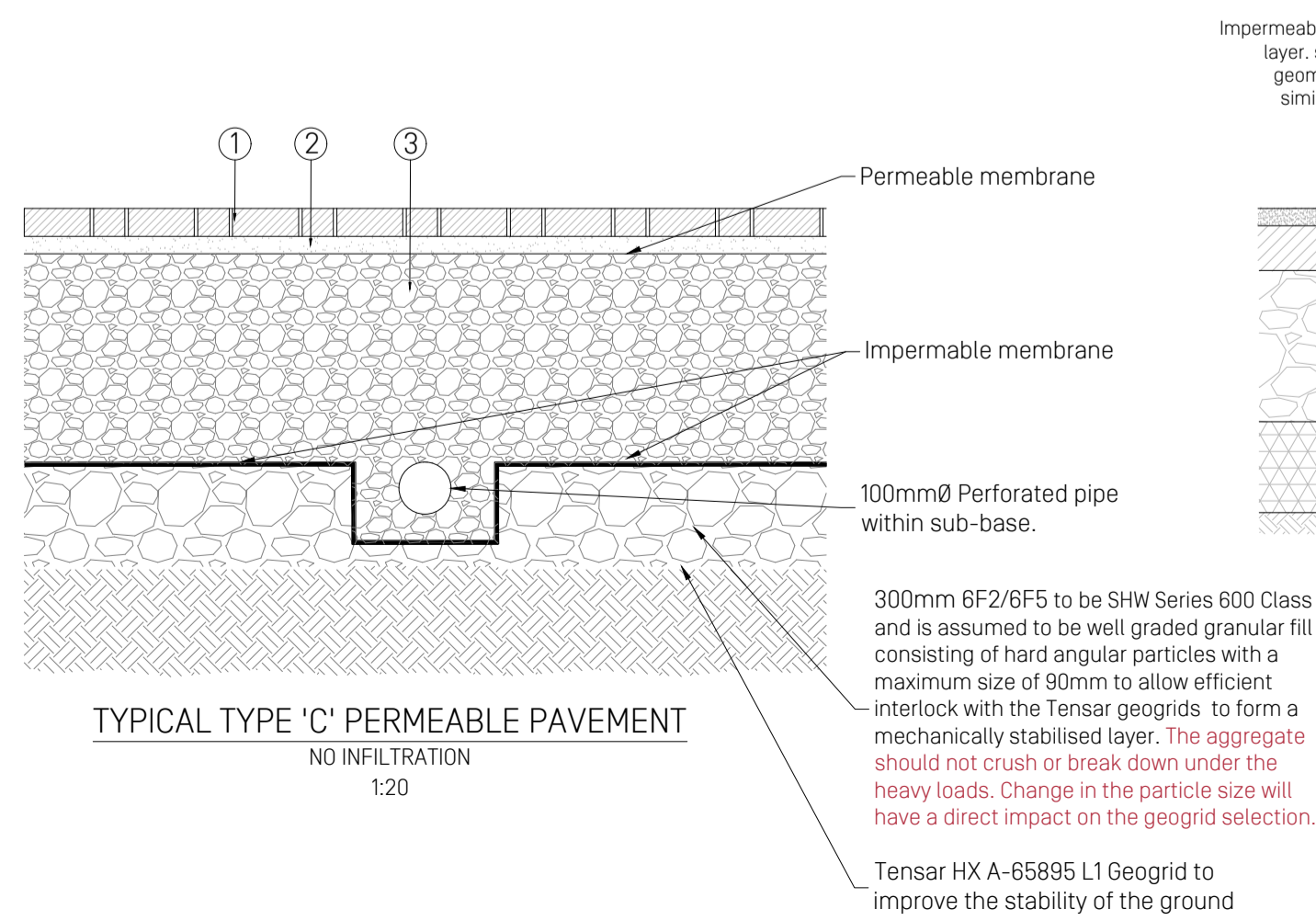

TYPICAL TYPE 'C' PERMEABLE PAVEMENT
NO INFILTRATION
1:20

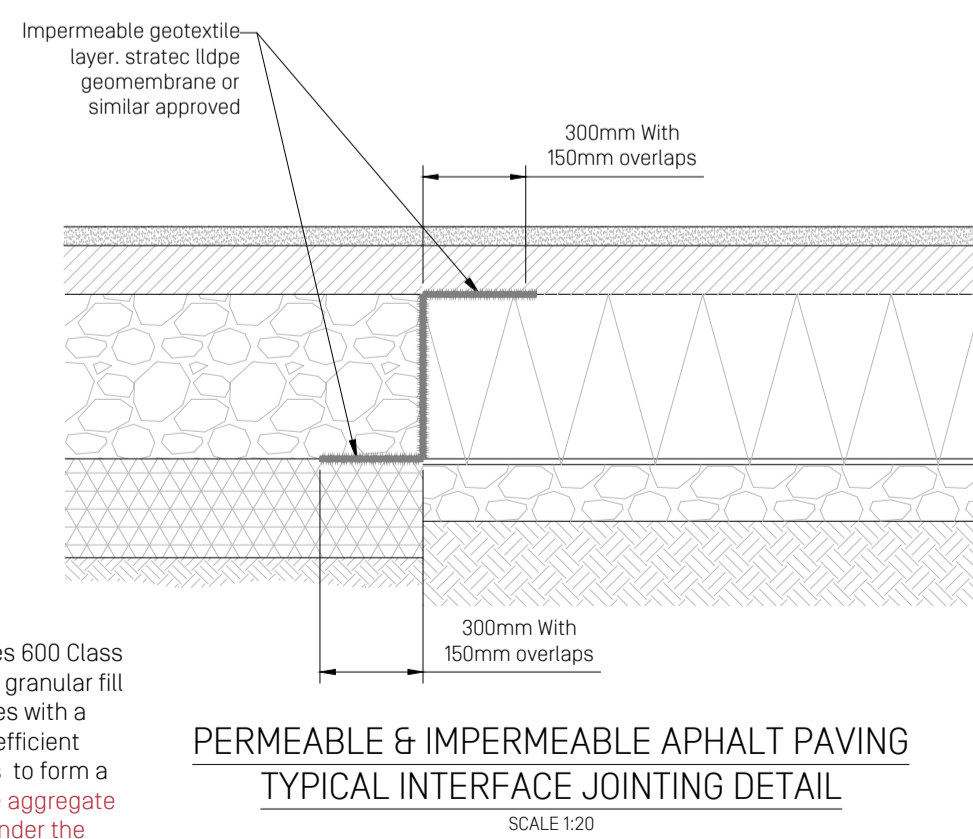

PERMEABLE & IMPERMEABLE ASPHALT PAVING TYPICAL INTERFACE JOINTING DETAIL
SCALE 1:20

PAVEMENT CONSTRUCTION SPECIFICATION			
	LAYER	SPECIFICATION	COMPACTED THICKNESS (mm)
IMPERMEABLE ASPHALT PAVEMENT	1	SURFACE COURSE 80mm Thick block paving to architects specification	80
	2	BASE COURSE 50mm Clean sharp sand	50
	3	TYPE 4/20 COARSE GRADED AGGREGATES TO BSEN 13242:2002 WITH AN IMPERMEABLE MEMBRANE AT THE BASE.	430
	4	6F2/6F5 to SHW Series 600 Class, max size of 90mm	300
	5	Tensor HX A-65895 L1 Geogrid	300

PI	28/07/23	Preliminary Issue	RB	JRS
Rev	Date	Description	By	Check

Copyright: The copyright of this drawing is vested in Schema Engineering Ltd. To be read in conjunction with all other project related drawings, reports and surveys etc. It shall not be used without permission by anyone for any purpose. Do not scale this drawing electronically or manually. Work to figured dimensions only. All dimensions are in metres unless stated otherwise. Do not turn on layers that have been turned off. Do not thaw layers that have been frozen.

Client	Cocksedge Building Constructors		
Project	Barrett's Lane, Needham Market Suffolk IP6 8DL		
Title	Private Construction Details Sheet 2		
Scale @ A1	AS SHOWN	Status	Preliminary



Date	Job Number	By	Checked By
July 2023	0304	RB	JRS

Drawing No.	Revision
C431	P1

PRELIMINARY DRAWING:
This drawing is for preliminary purposes only and must not be read as a construction issue. The design is not fixed and design changes are likely.