

1 BED Two person
58 GRENOBLE GARDENS

GROUND FLOOR GROSS AREA	AREA	Min Required
LIVING/KITCHEN/DINING	30.9m²	25m²
STORAGE	2.0m²	2.0m²
BEDROOM 1:	14.6m²	12.0m²

TOP FLOOR MAISONNETTE
3 BED 4 person
58A GRENOBLE GARDENS

GROUND FLOOR GROSS AREA	AREA	Min Required
LIVING/KITCHEN/DINING	27.10m²	23m²
STORAGE	3m²	2.5m²
BEDROOM 1:	11.6m²	8.5m²
BEDROOM 2:	12.4m²	12m²
BEDROOM 3:	9.3m²	9m²

The following combined floor areas for living / kitchen / dining space should be met:

Designated level of occupancy	Minimum combined floor area of living, dining and kitchen spaces (sq m)
2 person	23
3 person	25
4 person	27
5 person	29
6 person	31

Table 1 - Minimum gross internal floor areas and storage (m²)

Number of bedrooms(2)	Number of bed spaces (persons)	1 storey dwellings	2 storey dwellings	3 storey dwellings	Built-in storage
1b	2	28 (207)*	65	90	1.0
2b	3	41	72	95	2.0
3b	4	54	84	95	2.5
4b	5	67	97	103	3.0
5b	6	80	110	112	3.5
6b	7	93	123	121	4.0

Table 1 - Minimum gross internal floor areas and storage (m²)

Number of bedrooms(2)	Number of bed spaces (persons)	1 storey dwellings	2 storey dwellings	3 storey dwellings	Built-in storage
1b	2	28 (207)*	65	90	1.0
2b	3	41	72	95	2.0
3b	4	54	84	95	2.5
4b	5	67	97	103	3.0
5b	6	80	110	112	3.5
6b	7	93	123	121	4.0

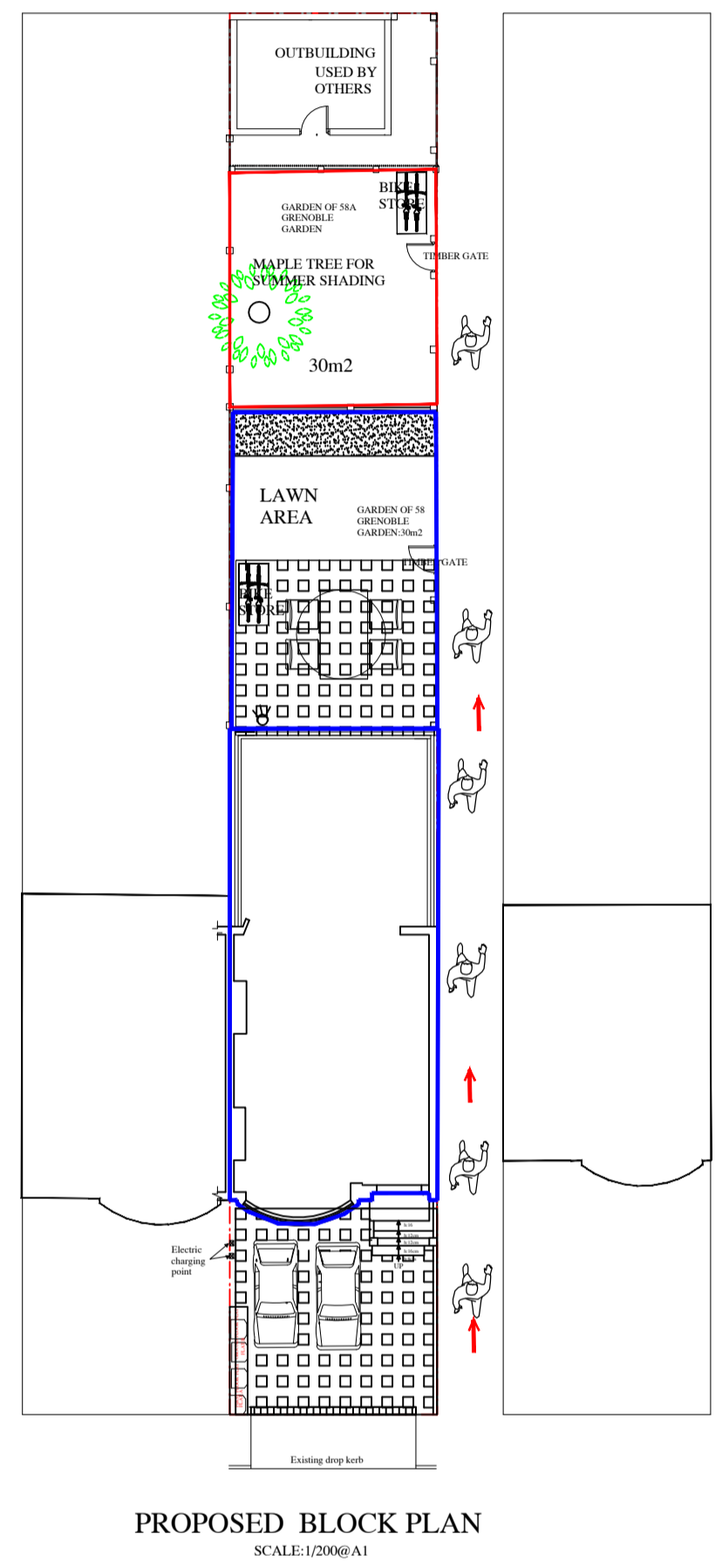

HEALTH AND SAFETY GENERALLY: All works to be carried out in accordance with the Health and Safety Act and other Regulations that are providing Health & Safety requirements in force at the time of the works.

PICTURE OF SAFE CYCLE STORAGE

LEGEND:

- Red outline: DENOTES COVERED BUILDING AREA OF 58A GRENOBLE GARDENS TOTAL: 30M2
- Blue outline: DENOTES COVERED BUILDING AREA OF 58 GRENOBLE GARDENS TOTAL: 30M2
- Grid pattern: DENOTES REAR PERMEABLE PAVING AREA TOTAL: 44.50M2
- Stippled pattern: DENOTES ATTENUATION BOX, FILLED WITH sand or PEA SHINGLE 2m²
- Symbol: DENOTES ELECTRIC CHARGING POINT
- Symbol: Min 120L WATERBUTT FITTED WITH OVERFLOW DEVICE DIRECTLY ONTO PLANT BORDER
- Symbol: EXTERNAL LIGHTING: Dedicated Energy Efficient Fitting: *Security light fittings are designed for energy efficiency and are adequately controlled such that: 1) A maximum voltage of 150V, 2) Movement detecting control devices (PIr) Daylight cut off sensor
- Symbol: Grill for surface water
- Symbol: REAR BOUNDARY TREATMENT: Lap Fence Panel 1.5m x 1.8m

TOTAL FOOT PRINT OF LAND IS: 227m²
PERMEABLE SURFACE: 114.4m²
half area of the LAND: 113.5 < PERMEABLE AREA

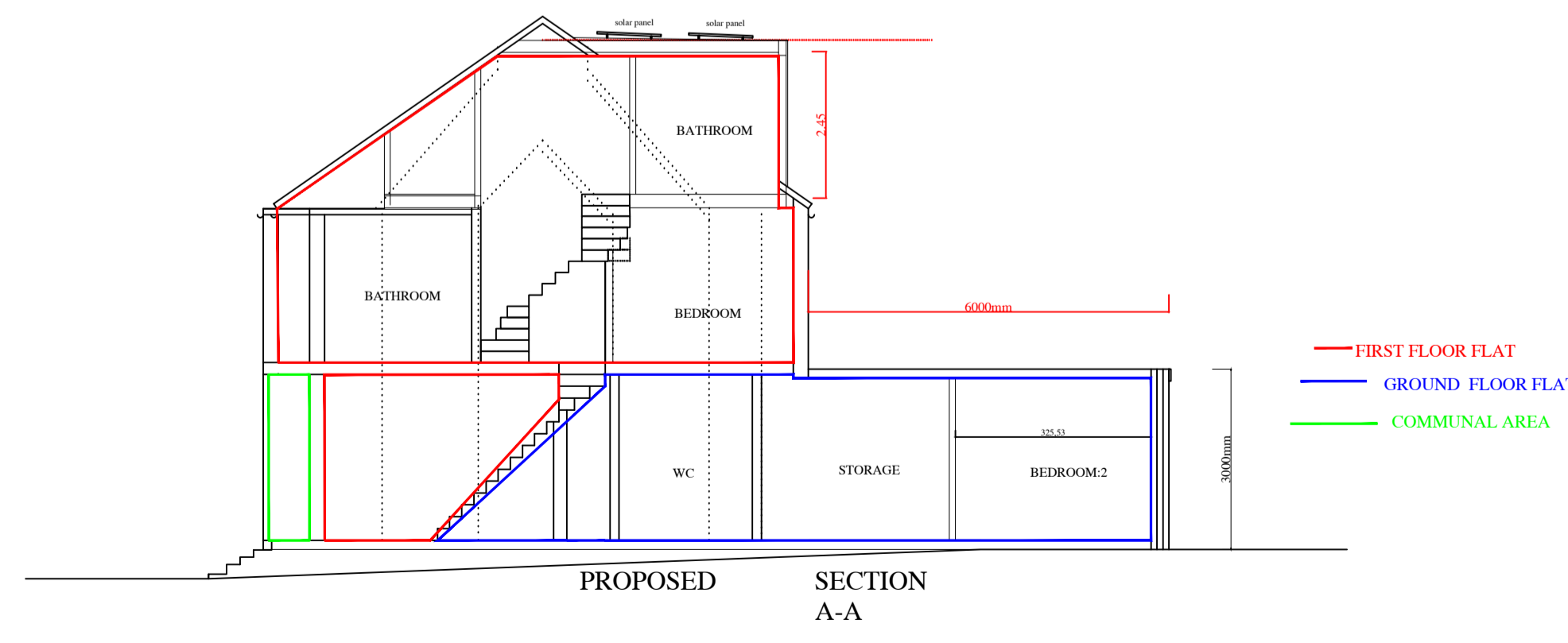

no	revision	date	control

project: 58 GRENOBLE GARDENS LONDON N13 6JG

drawing title: PROPOSED BLOCK PLAN PROPOSED ROOF PLAN PROPOSED FLOOR PLAN PROPOSED ELEVATIONS

scale: 1/100@A1 - 1/200@A1

date: DEC '23

drw.no: SAD-05-PL04

ERK
Structural & Design Consultants

North: EA Address: 189 Layer Road, N9 9PN Tel: 07791965691
Bsc: C.Eng