

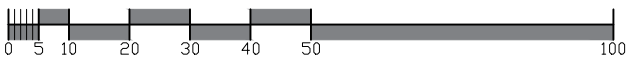

Ordnance Survey, (c) Crown Copyright 2021. All rights reserved. Licence number 100022432

| REV | DATE | DESCRIPTION | INITIAL | CHECKED |
|-----------------|------|-------------|---------|---------|
| PLANNING | | | | |

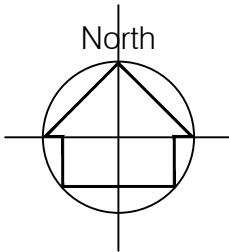

© This drawing is copyright.
It is sent to you in confidence and must not be reproduced or disclosed to third parties without our prior permission.

Do not scale from this drawing, other than for Local Authority Planning purposes.

This drawing is to be read in conjunction with all relevant consultants, specialist manufacturers drawings and specifications.

Any discrepancies in dimensions or details on or between these drawings should be drawn to our attention.

All dimensions are in millimetres unless noted otherwise.



harding rose architects

| | | | |
|---------|-------------------------------------|-------------|----------|
| CLIENT | MR T MAZHAR | | |
| PROJECT | 23 Bentham Avenue, Woking, GU21 5LF | | |
| TITLE | Location Plan | | |
| SCALE | 1:1250@A4 | DATE | 02.01.24 |
| DRAWN | HB | PROJECT NO. | 20.873 |
| | | | L.101 - |