

Solid ground floor.
All solid masonry walls at ground floor level.
14no. risers.
Tread=220mm
Rise=170mm
Ground-first floor ceiling=5209mm

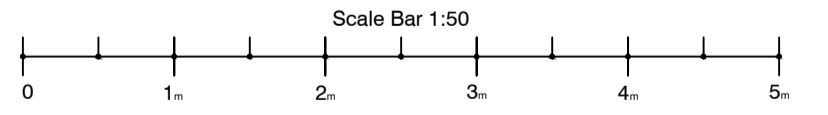
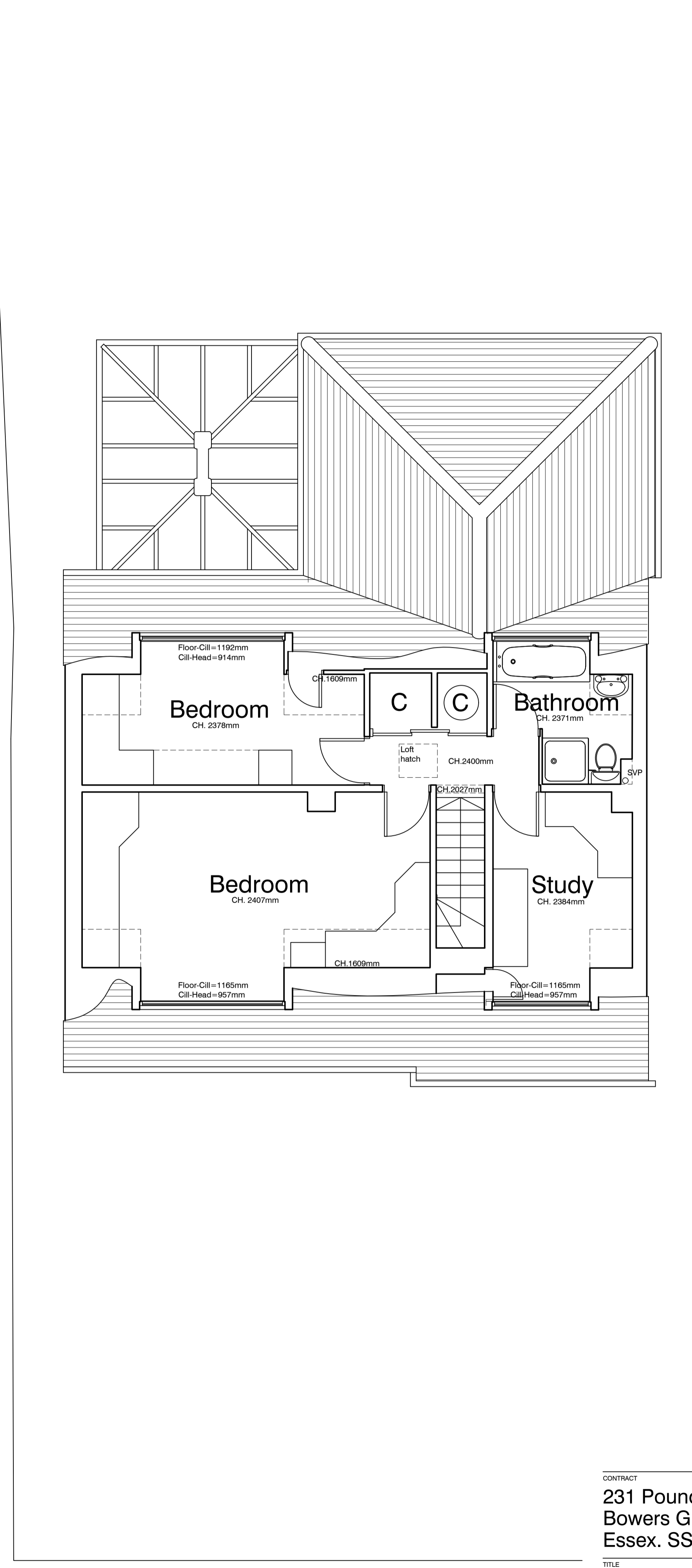

CONTRACT	231 Pound Lane Bowers Gifford, Basildon Essex. SS13 2LB.	SCALE	1:50.
DATE	November 2023.	DRAWN	C.J.
TITLE	Existing Floor Plans.	CHECKED	
DRAWING No	23233_001.	REVISION	