



Planting Schedule

Number	Species	Height	Pot Size	Specification	Density
1	Acer campestre	14-16cm	RB	Extra Heavy Standard	
5	Amelanchier lamarckii	10-12cm	RB	Multi-Stemmed	
4	Betula pendula	14-16cm	RB	Extra Heavy Standard	
1	Prunus avium	14-16cm	RB	Extra Heavy Standard	
1	Quercus robur	14-16cm	RB	Extra Heavy Standard	
1	Sorbus aucuparia	14-16cm	RB	Extra Heavy Standard	
Total	33				

Number	Species	Height	Pot Size	Specification	Density
124	Bergenia cordifolia	20-30cm	3L	C	6/m ²
14	Choisya ternata	40-60cm	5L	C	4/m ²
23	Choisya ternata 'White Dazzler'	40-60cm	3L	C	4/m ²
235	Geranium macrorrhizum 'Ingwersen's variety'	30-40cm	3L	C	6/m ²
73	Hebe buxifolia	30-40cm	3L	C	4/m ²
109	Hydrangea arborescens 'Annabelle'	40-60cm	3L	C	3/m ²
51	Lonicera pileata 'Maygreen'	40-60cm	3L	C	4/m ²
68	Potentilla fruticosa 'Red Ace'	30-40cm	3L	C	4/m ²
62	Viburnum davidii	40-60cm	3L	C	4/m ²
14	Viburnum opulus	60-80cm	5L	C	3/m ²
56	Viburnum tinus	60-80cm	5L	C	3/m ²
Total	887				

Number	Species	Height	Specification	Percentage Contribution
54	Acer campestre	60-80cm	B	10%
54	Corylus avellana	60-80cm	B	10%
14	Crataegus monogyna	40-60cm	B	40%
27	Ilex aquifolium	40-60cm	B	5%
81	Prunus spinosa	40-60cm	B	15%
54	Rosa canina	60-80cm	B	10%
54	Sambucus nigra	60-80cm	B	10%
Total	538			100%

Note: Hedge planting to be established in double staggered row, 300mm between rows, plants equally spaced with 6no. plants per linear metre.

Tree planting to be double staked using 75mm diameter pointed softwood stakes treated with Tanalith E Class 4.0. Stakes to be driven into ground 150mm below finished soil level and be 600mm above ground. Trees to be secured to stakes using adjustable rubber tree ties.

GreenBlue Urban ReRoot 1000 root barrier system within 6M of all service locations installed in compliance with manufacturers installation instructions.

GreenBlue Urban Root Rain urban irrigation system RRURB1.

1 x 1 x 1m tree pit backfilled firstly with site won subsoil [700mm] and then site won or imported topsoil [300mm]. Topsoil to BS3882 thoroughly mixed with Melcourt Topgrov Planting Compost in ratio 2:1 as specified. Include for Enmag slow release fertiliser at 100gms per pit, and backfill in 150mm layers firming in before next layer is added. Break up bottom of pit 200mm deep and sides where root barrier is not installed.

Typical section through tree pit / hedge / shrub planting / grass. Scale 1:25

Planting Specification

All work and materials shall be in accordance with current British Standards components and to Code of Practice.

SITE CLEARANCE

- a - Remove general builders rubble, litter and any stones greater than 75mm in size from the areas to be planted. Such materials are to be collected and taken to the Contractors tip or disposed of to site as directed.

EARTHWORKS

Planting Areas

- a - Approved topsoil, both site won and imported, shall be led onto site and spread evenly on the approved formation to give a finished depth of 150mm for grassed areas, 450mm for shrub planted areas and 1000mm depth for tree pits. All topsoil to be placed on a minimum of 300mm depth of subsoil.
- b - Finished levels of topsoil in grassed areas to be 25mm above adjoining paving. Finished level of topsoil in shrub beds to be 50mm lower than adjacent edge to allow planting of bark mulch.
- c - Supply and spread approved fertiliser such as SAI Enmag or similar standard at the rate of 70g/m² to be worked into top 200mm.

CULTIVATIONS AND PLANTING

Planting Areas

- a - Shrub beds shall be cultivated prior to planting to produce a medium tith and all weeds, stones and other debris arising from this work are to be collected and removed from site.
- b - Spread approved tree and shrub planting compost over the planting beds at a rate of 20 litres/m² and work into the top 200mm.
- c - Shrubs to be sited in locations, numbers and densities shown in the planting schedule and on the soft landscape drawings. Shrubs to be placed to achieve an even spacing and matching of shapes. All shrubs are to be planted at the depth at which they have previously been growing, allowing for soil settlement after planting.
- d - Surfaces of shrub planting areas shall be left clean and neat with a raked surface between the planting during and on completion of planting.
- e - Immediately after planting all containerised plants shall be watered with 5 litres of water per plant.
- f - All grass edges to be cut vertically with an edging into a or an even smooth radius. Edges to be left neat and tidy with ground on shrub side meeting cut face at an even gradient. All cuttings to be removed from site.
- g - A 50mm layer of matured conifer bark to be spread over planting areas and tops of tree pits, at least 75% of which shall exceed 60mm particle size and shall contain a minimum of wood particles, the bark is to be pest, disease and weed free.

Tree Planting - Planting Pits

- a - Excavate tree pits as follows:-
Standard / Feathered trees - 1000 x 1000 x 1000mm
Semi-Mature trees - 1500 x 1500 x 1000mm
- b - Loosen base to a further depth of 200mm and scarify sides. Dispose of unsuitable excavated material off site to approved tip.
- c - Trees to be double staked with stakes positioned parallel to the adjacent kerb line or paving. Tree stakes to be pressure treated, minimum diameter 55mm and pointed at one end. Stakes to be driven into the pit before planting to a minimum depth of 300mm below the base of the pit - or services, or within 2.0m of roads/parking areas are to have root barriers installed.

a minimum depth of 300mm below the base of the pit - or services, or within 2.0m of roads/parking areas are to have root barriers installed.

- d - Trees to be planted in pit to a depth and orientation related to the original growing position in the nursery and backfilled with the excavated topsoil mixed with approved tree and shrub planting compost in the following amounts:-
Feathered trees - 60 litres/tree
Standard trees - 95 litres/tree
Heavy standard trees - 120 litres/tree
Semi-mature trees - 150 litres/tree

Grass Seeding

- a - Areas for seeding to have topsoil depths of min. 150mm apart from windflower areas where seed should be sown directly onto subsoil.
- b - One month prior to sowing, areas shall be harrowed to a depth of 100mm followed by chain harrowing to a depth of 50mm to produce a fine tith. Finished surfaces to be rolled with a Cambridge roller.
- c - All weeds, stones and other debris arising from this work shall be collected and removed from site to the Contractors tip.
- d - All grassed and broad-leaved plants which emerge between cultivations and seeding shall only be treated with an approved translocated herbicide before sowing.

Minor Grading

- a - Finished levels of amenity grass areas to be 25mm above adjoining paving or kerb. Levels to be arranged to give gentle falls for drainage purposes.
- b - New areas to be marked to adjoining solid areas.

Final Cultivations

- a - The surface for seeding should be 25mm deep and free from weeds and stones.

Sowing Grass Seed Mixes

- a - Germinal Seeds Ref: 'A22 Low Maintenance' sown at recommended rate of 50g/m², or similar approved.

Procedure

- a - The Contractor shall purchase fresh grass seed each season throughout the contract period. The grass seed shall be made up of certified seeds under EEC regulations. The seed shall have a certified germination of not less than 10% and a certificate of purity of not less than 90%. Total weed seed and other crop seeds content shall not be more than 1%. Seeds shall be obtained at least 21 days before sowing.
- b - The Contractor shall be required to submit certificates for all deliveries of grass seed stating the seed source, mixture percentage, percentage purity and germination.

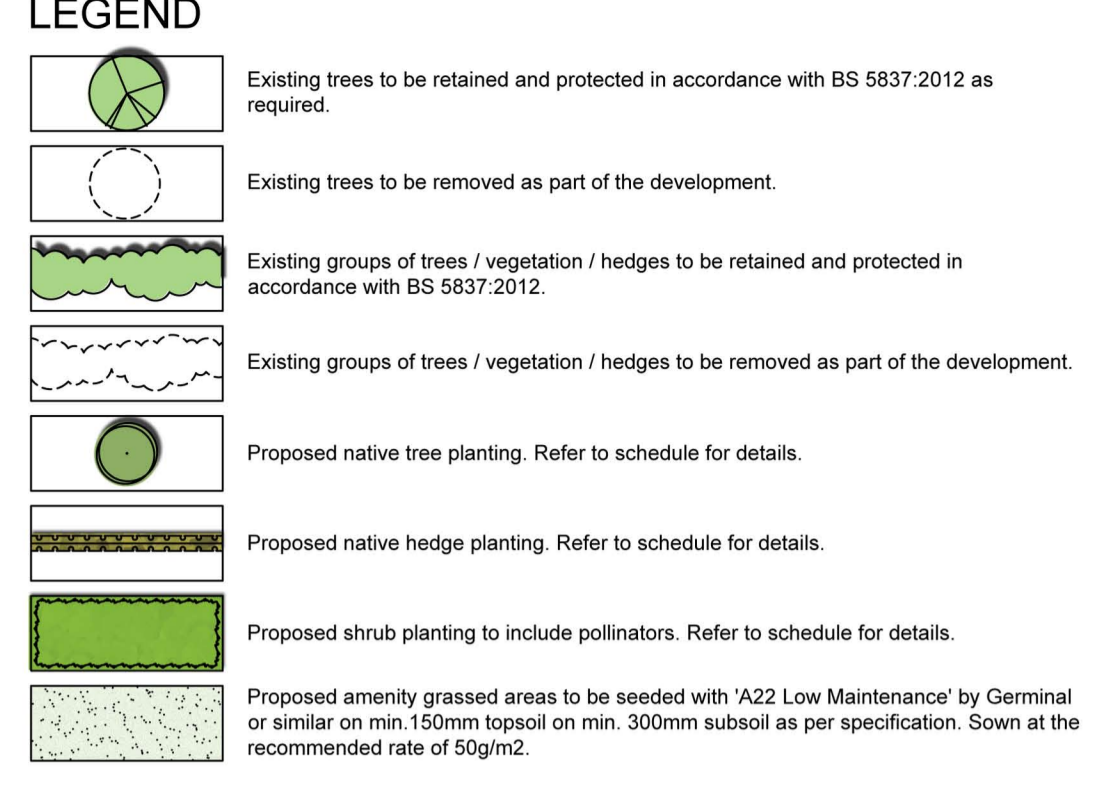

Notes about birds breeding season and tree removal:
It is recommended that vegetation which needs to be removed is done prior to the bird breeding season. [1st March to 31st August]. If this is not possible within this period, the vegetation removal should be carried out under the supervision of an Ecologist.

If birds are found to be breeding in the vegetation which needs to be removed then vegetation removal in the area surrounding the nest must be delayed until the eggs have hatched and the young birds have left the nest.

Rabbit Protection
All hedge planting to be fitted with TUBEX STANDARD TREE GUARDS or SHRUBSHELTERS according to plant type. Tubes to be 60cm high or similar approved. Tree/Shrub shelters need to be well anchored using good quality square stakes, inserted into the ground to at least 1/3 of the stake height.

Ensure the stake is below the flared rim at the top of the Shrubshelter. Using the shelters natural strength push it lightly into the ground to remove the gap at the base.

Hedge planted in double staggered row into 450mm topsoil on 400mm subsoil fully relieved by hand or machine to full depth. Topsoil to be mixed with approved planting compost 80 litres per 4sq m worked into top 200mm. Include for Enmag slow release fertilizer at 20 grams per plant. 50mm layer of approved bark mulch to surface.

Shrub planting on 450mm topsoil on subsoil min 400mm deep relieved by hand or machine to full depth with 50mm approved bark mulch to surface.

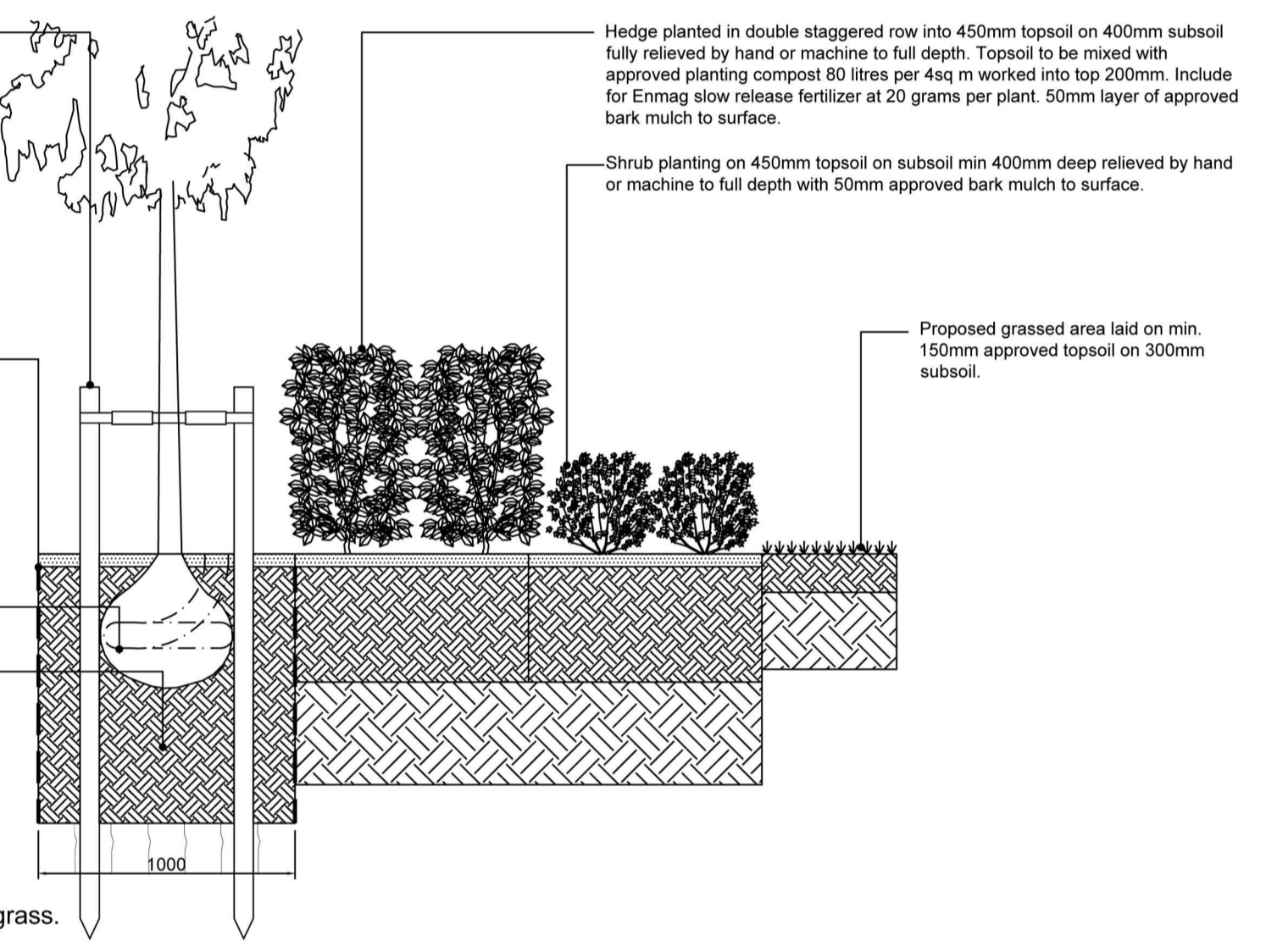

Proposed grassed area laid on min. 150mm approved topsoil on 300mm subsoil.

Defects Liability Period

- a - Any trees, shrubs and grass found to be defective or missing for any reason before practical completion shall be replaced by the Contractor entirely at his own expense.
- b - Thereafter any failures within 12 months of the date of practical completion shall also be replaced to the original specification by the Contractor entirely at his own expense, in the next planting season.
- c - Thereafter any failures within the next 4 years shall also be replaced to the original specification in accordance with the planting conditions.

Weed Control

- a - Keep shrub beds and areas around trees free from annual and perennial weeds by hand weeding. All arisings to be removed from site. Allow 7 no. visits per year.
- b - Apply translocated herbicide to shrub beds using weed wiper. Allow 3 visits a year with dead weed growth removed after each visit.

Mulch

- a - Bark mulch to be reinstated to original depths at the end of each growing season. Allow 1 no. visit per year.

Watering

- a - All planting shall be watered with a low pressure hose during dry spells, within the first year of growth only, at the following rates:-
Feathered/standard trees - 36 litres/tree/visit
Heavy standard trees - 42 litres/tree/visit
Semi-mature trees - 48 litres/tree/visit
Shrubs - 5 litres/plant/visit

Fertiliser

- a - At the end of the establishment period, 30gms of slow release fertiliser to be applied around each plant. Allow 1 no. visit at end of Year 2

Grass Cutting

- a - Areas sown with amenity mix:-
16no. visits between April and October. Grass areas to be cut to a height of c.40mm. In very wet conditions adjust cutting heights to c.60mm. In very wet conditions, all operations involving grass cutting shall cease until conditions allow operations to continue without damaging the surfacing, levels and contours of the ground. Allow for sweeping clean of all paths and roads of grass cuttings at each mowing
- c - IN ALL CASES all arisings are to be removed from site.

Firming In

- a - All plants and tree stakes loosened by planting operations, wind or frost shall be firmed in. Allow 1 no. visit per year.

Litter Collection

- a - Whole site to be kept in a clean and tidy condition throughout the establishment period. Litter to be removed from site. Allow 20 no. visits per year.

REV.	DESCRIPTION	DATE	REV.	DESCRIPTION	DATE	REV.	DESCRIPTION	DATE
REV. A	Updated to reflect revised Architectural and Engineering layouts. JE/DP	10.11.23						
B	Updated to reflect revised Architectural site plan. JE/DP	15.12.23						

IMPORTANT CDM / H&S NOTE
The designers would draw the readers attention to key residual construction health and safety hazards that have not been eliminated from the designs shown on the drawings by the design process. These hazards are identified below: Working on or adjacent to the public highway. Working adjacent to retaining walls / changes in level.
Any construction personnel including operatives intending to construct the designs shown on this drawing should ensure that they have been thoroughly briefed by the principle contractor on all health and safety matters and have sight of: 1. The full designers and contractors hazard risk assessments and risk registers. 2. The developed construction phase health and safety plan. 3. The contractors construction method statements.

PROJECT	DRAWING TITLE	DRAWING No.	SCALE (A1)	DATE	DRAWN	CHKD
New Forge, Oakdale, Caerphilly	Soft Landscape Proposals	1174.01 Rev B	1:200	Apr/23	LH	DP

NEWCASTLE UPON TYNE	CARDIFF
T: 01462 773 951 info@dpla.co.uk	Cardiff / Caerdydd T: 01446 773 951 www.dplandscapearchitecture.co.uk