

This drawing is ONLY intended to be used for the purpose stated and forms part of a series that is to be read in conjunction with details and specifications and where necessary other consultants information.

Deviating from these drawings without consultation and/or agreement with the employer is unacceptable. This drawing is indicative and exact dimensions should be checked and confirmed on site by the nominated contractor or competent person's prior to commencement of demolition or building works, ordering of materials or setting out. Any discrepancies should be reported in advance and in writing to Studio SDA. Where in doubt ASK, and do not proceed with the works in the event of a drawing discrepancy.

Do not scale from this drawing - only work from written and checked dimensions.

For all structural aspects please refer to the client appointed Structural Engineers project information and cross reference all drawings, details and calculations with the architectural drawing prior to commencement of any works.

This drawing is the property of Studio SDA and copyright reserved by them. This drawing is not to be used, copied or disclosed by or to any unauthorised persons without prior written authorisation consent from Studio SDA.

Studio SDA is a trading name of Style Design and Architecture Ltd and holds no responsibility or liability for any works carried out on site.

Status:
FULL PLANNING APPLICATION

Project Information:
Client: Mr & Mrs Mason
Project Title: Stepol Stud
Project Address: Liptrort Farm, Rawlins Lane, Heath Charnock, Chorley, PR7 4DJ
Project Stage: RIBA Stage 3: Spatial Coordination
Date of Drawing: 28/11/23

Drawing Information:
Original Author: SLP
Checked by: DC
Drawing Sheet Size: A1 (594 x 841mm)
Drawing Scale: 1:50
Site Area Hectare: 0.91
Extension Area CIL (m²):
Drawing Title:

Ground Floor Plan as 'Approved' - GRANARY

Project Number: Drawing Number: Revision:
387 3-09-PP

Drawing Registry

| Rev. | Date | Description | Author | Checked |
|------|------|-------------|--------|---------|
| | | | | |

Internal Dimensions (mm):
GROUND FLOOR
Snug - 6700 x 4300
Reception - 5100 x 5500
Living - 5200 x 5500
Dining - 13900 x 4400
Kitchen - 5500 x 5400
Sun - 5500 x 2700
Plant - 3000 x 3000
Utility - 3000 x 4900
W/C - 3000 x 1200
Cloak - 3000 x 1300
FIRST FLOOR
Bed 1 - 6700 x 4300
Master Bedroom - 6500 x 5500 x 2800 x 3000
Bed 2 - 6700 x 4000
Bed 3 - 5300 x 4100
Bed 4 - 4300 x 6700
Office - 6200 x 6800
Internal Dimensions (Square Footage):
Ground Floor - 2838.4
First Floor - 2856.7
Total - 5695.1

'Granary' Ground Floor, as 'Existing'
Scale 1:50

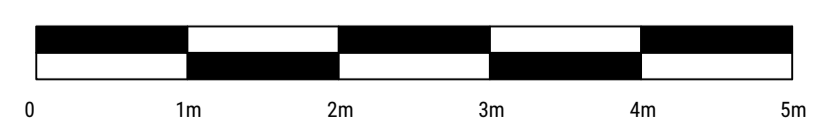
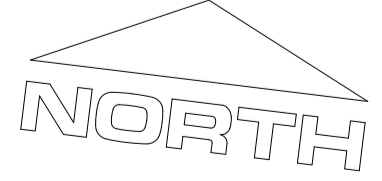
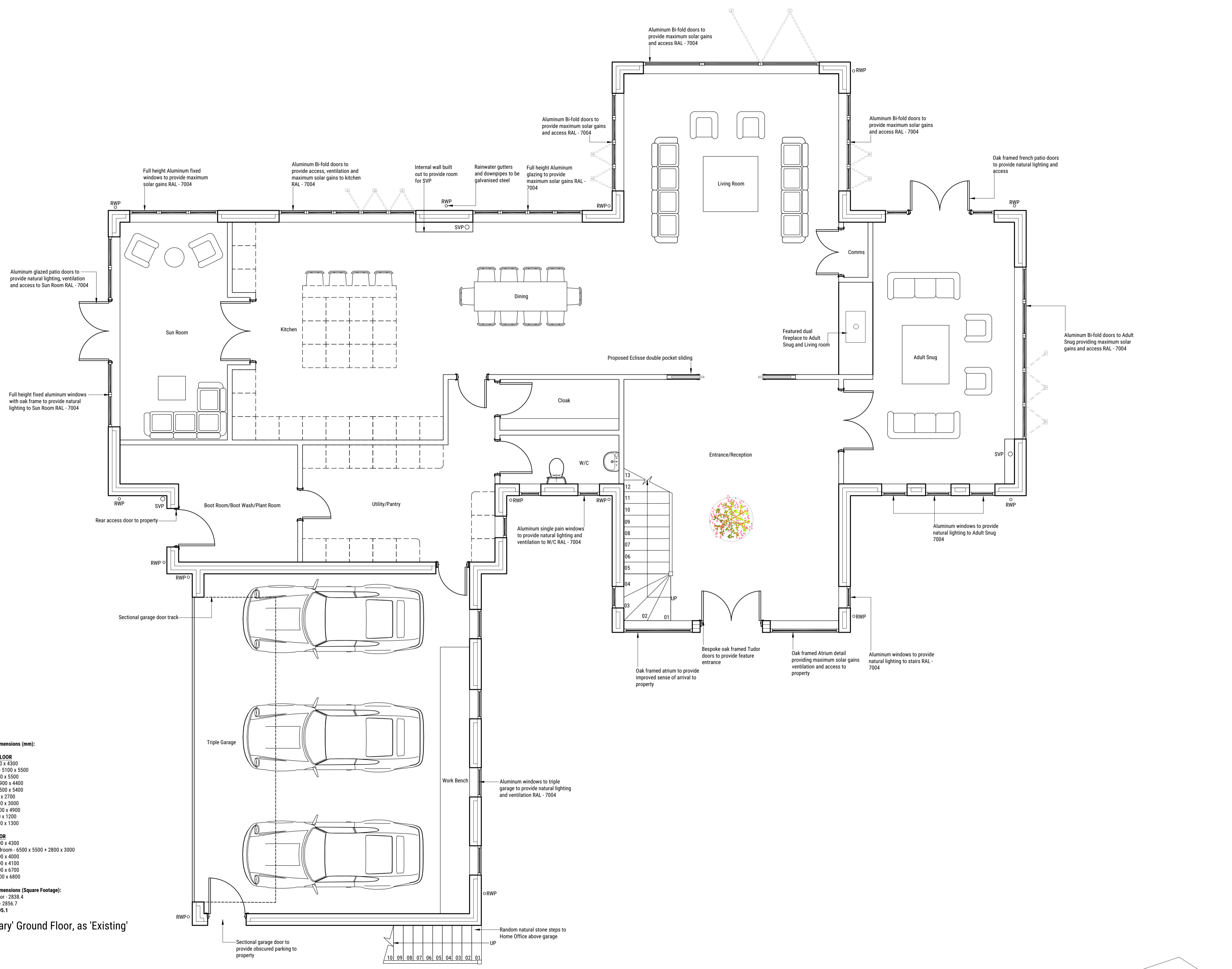

SCALE BAR 1:50



Head Office: Ashley House, 29 Queens Road, Chorley, Lancashire, PR7 1JF
Tel: 01257 461150 | Web: www.studio-sda.co.uk | Email: contact@studio-sda.co.uk
Company Registration: 0371187 VAT Registration: 181 9637 53
Copyright © 2023 Style Design & Architecture Ltd. All Rights Reserved