

This drawing is **ONLY** intended to be used for the purpose stated and forms part of a series that is to be read in conjunction with details and specifications and where necessary other consultants information.

Deviating from these drawings without consultation and/or agreement with the employer is unacceptable. This drawing is indicative and exact dimensions should be checked and confirmed on site by the nominated contractor or competent person's prior to commencement of demolition or building works, ordering of materials or setting out. Any discrepancies should be reported in advance and in writing to Studio SDA. Where in doubt **ASK**, and do not proceed with the works in the event of a drawing discrepancy.

Do not scale from this drawing - only work from written and checked dimensions.

For all structural aspects please refer to the client appointed Structural Engineers project information and cross reference all drawings, details and calculations with the architectural drawing prior to commencement of any works.

This drawing is the property of Studio SDA and copyright reserved by them. This drawing is not to be used, copied or disclosed by or to any unauthorised persons without prior written authorisation consent from Studio SDA.

Studio SDA is a trading name of Style Design and Architecture Ltd and holds no responsibility or liability for any works carried out on site.

Status:
FULL PLANNING APPLICATION

Project Information:
Client: Mr & Mrs Mason
Project Title: Stepol Stud
Project Address: Liptrout Farm, Rawlinson Lane, Heath Charnock, Chorley, PR7 4DJ
Project Stage: RIBA Stage 3: Spatial Coordination
Date of Drawing: 28/11/23

Drawing Information:
Original Author: SLP
Checked by: DC
Drawing Sheet Size: A1 (594 x 841mm)
Drawing Scale: 1:50
Site Area Hectare: 0.91
Extension Area CIL (m²):
Drawing Title:

Ground Floor Plan as 'Proposed' - BARN

Project Number: Drawing Number: Revision:
387 3-06-PP

Drawing Registry

Rev.	Date	Description	Author	Checked

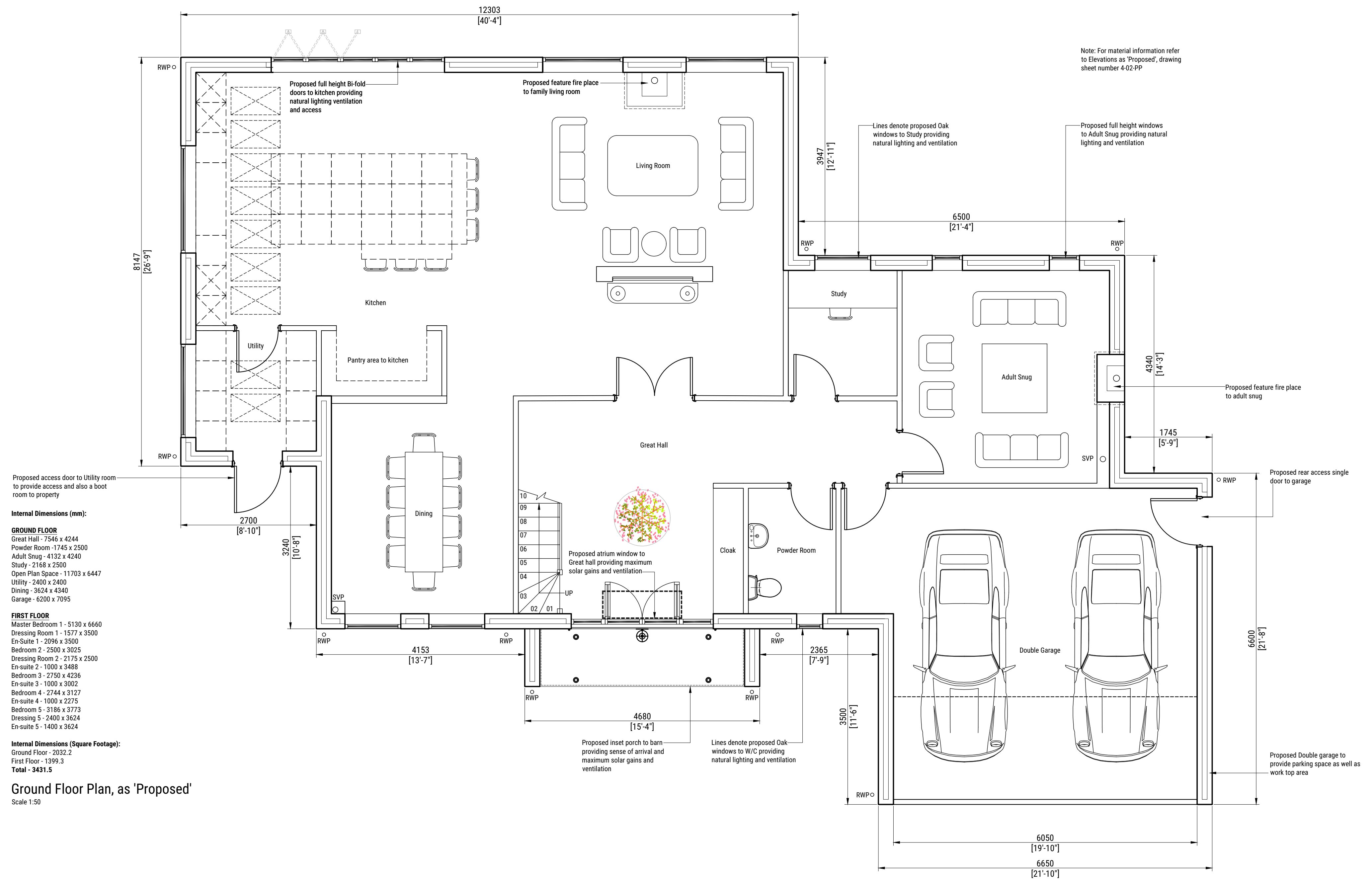

Proposed access door to Utility room to provide access and also a boot room to property

Internal Dimensions (mm):

- GROUND FLOOR**
Great Hall - 7546 x 4244
Powder Room - 1745 x 2500
Adult Snug - 4132 x 4240
Study - 2168 x 2500
Open Plan Space - 11703 x 6447
Utility - 2400 x 2400
Dining - 3624 x 4340
Garage - 6200 x 7095

- FIRST FLOOR**
Master Bedroom 1 - 5130 x 6660
Dressing Room 1 - 1577 x 3500
En-suite 1 - 2096 x 3500
Bedroom 2 - 2500 x 3025
Dressing Room 2 - 2175 x 2500
En-suite 2 - 1000 x 3488
Bedroom 3 - 2750 x 4236
En-suite 3 - 1000 x 3002
Bedroom 4 - 2744 x 3127
En-suite 4 - 1000 x 2275
Bedroom 5 - 3186 x 3773
Dressing 5 - 2400 x 3624
En-suite 5 - 1400 x 3624

Internal Dimensions (Square Footage):
Ground Floor - 2032.2
First Floor - 1399.3
Total - 3431.5

Ground Floor Plan, as 'Proposed'
Scale 1:50

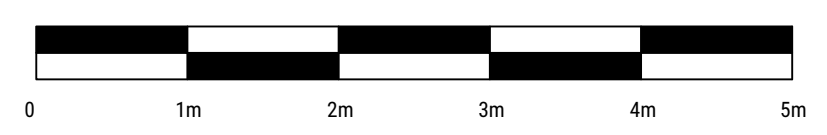
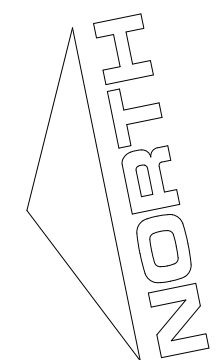

SCALE BAR 1:50



Head Office: Ashley House, 29 Duane Road, Chorley, Lancashire, PR7 1JL
Tel: 01257 481153 | Web: www.studio-sda.co.uk | Email: contact@studio-sda.co.uk
Company Registration: 5331887 | VAT Registration: 181 9637 53
Copyright © 2023 Style Design & Architecture Ltd. All Rights Reserved.