

PLAN 1:50

~~Boundary 1.6m~~
~~Boundary 1.6m~~

PLAN C
ELEVATION WALL

DETAIL
SCALE 1:50

DATE 21 24

DATE 21 24

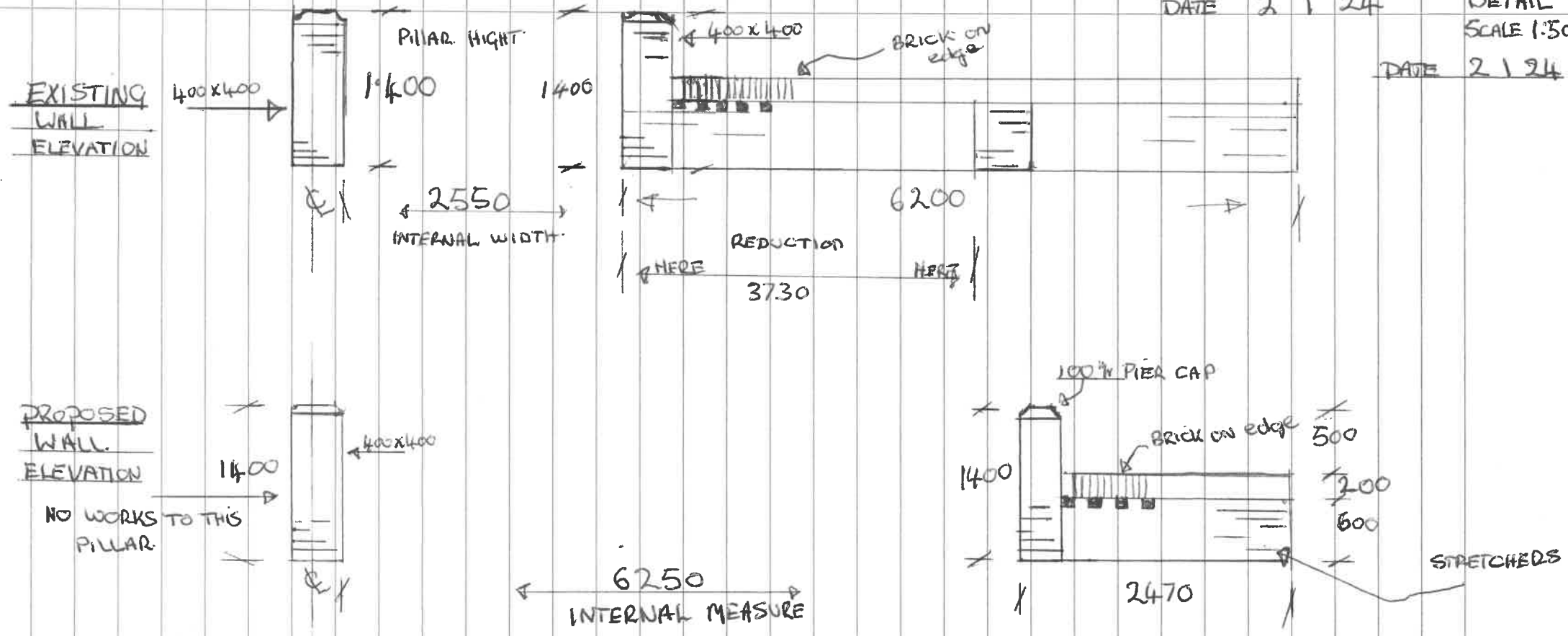

A REDUCTION OF WALL BY 3730 ONLY. LEAVING WALL AND PIER @ 2470

WORKS TO THE WALL SHALL BE CARRIED OUT BY A QUALIFIED BRICKLAYER, ALL BRICKS SHALL BE CLEANED AND RECYCLED, ONLY CONTRASTING MATERIALS ARE TO BE USED INCLUDING CORRECT MIX MORTAR.

D/L (C)

PLAN B
PROPOSED

Scale
1:100

DATE 2124

~~There has been no works done to the —
Hard standing this was covered with soil —
and debris.~~

~~THE GREEN AREA SHOWS THE ANGLE WE —
NEED TO ENTER AND EXIT IN A SAFE MANNER —
THUS NOT CAUSING ANY DANGER TO OTHER ROAD USERS
IT ALSO GIVES A BETTER VIEW AND REACTION —
TIME FOR PEOPLE WITH PUSHCHAIRS, WHEELCHAIRS,
AND MOBILITY SCOOTERS E.C.T.~~

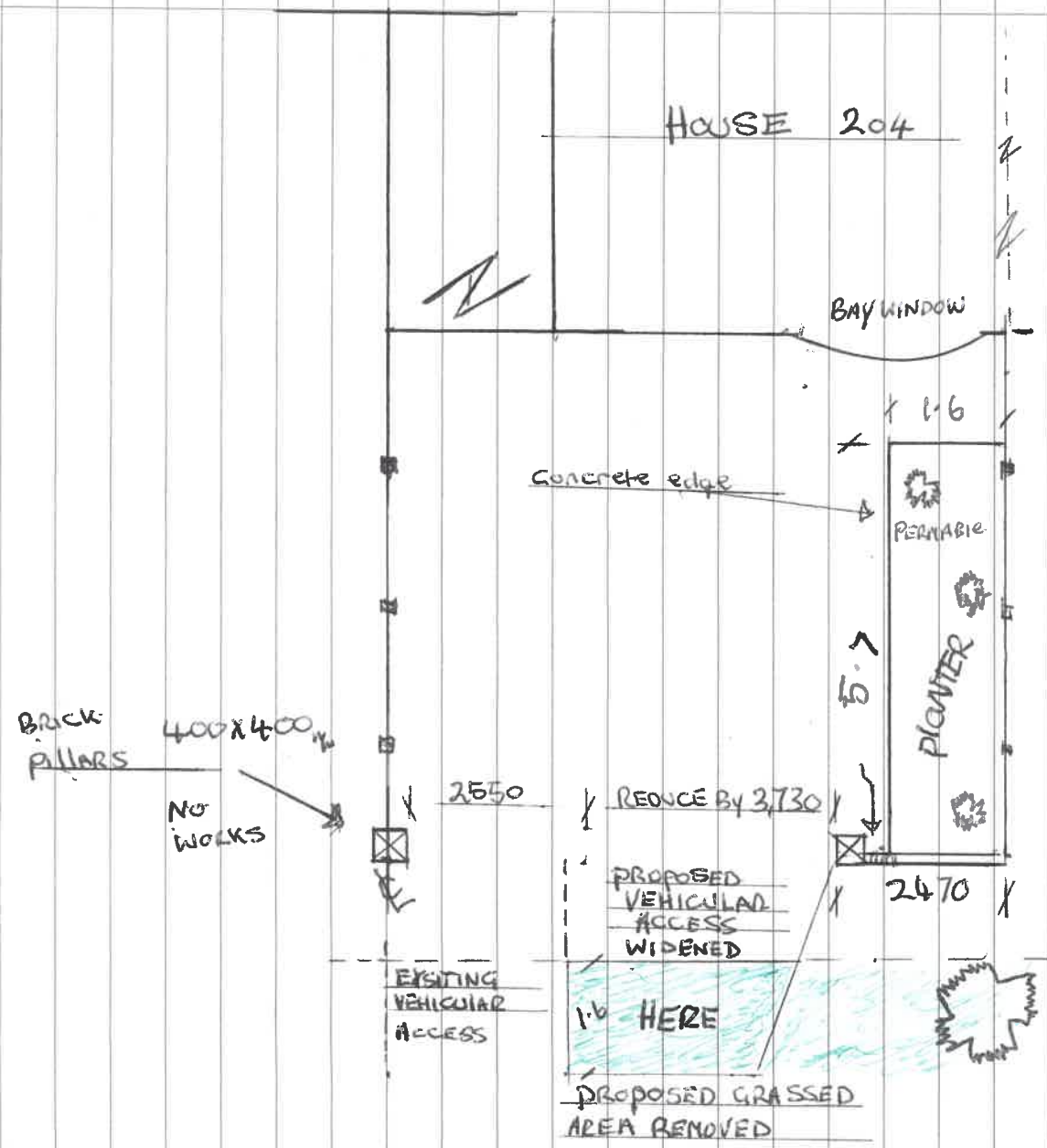

~~DL~~ (B)

HOUSE

204 ANCHORSHOLME LANE EAST FY5 3BP

Plan A
EXISTING

Scale

1:50

DATE DRAWN 2.1.24

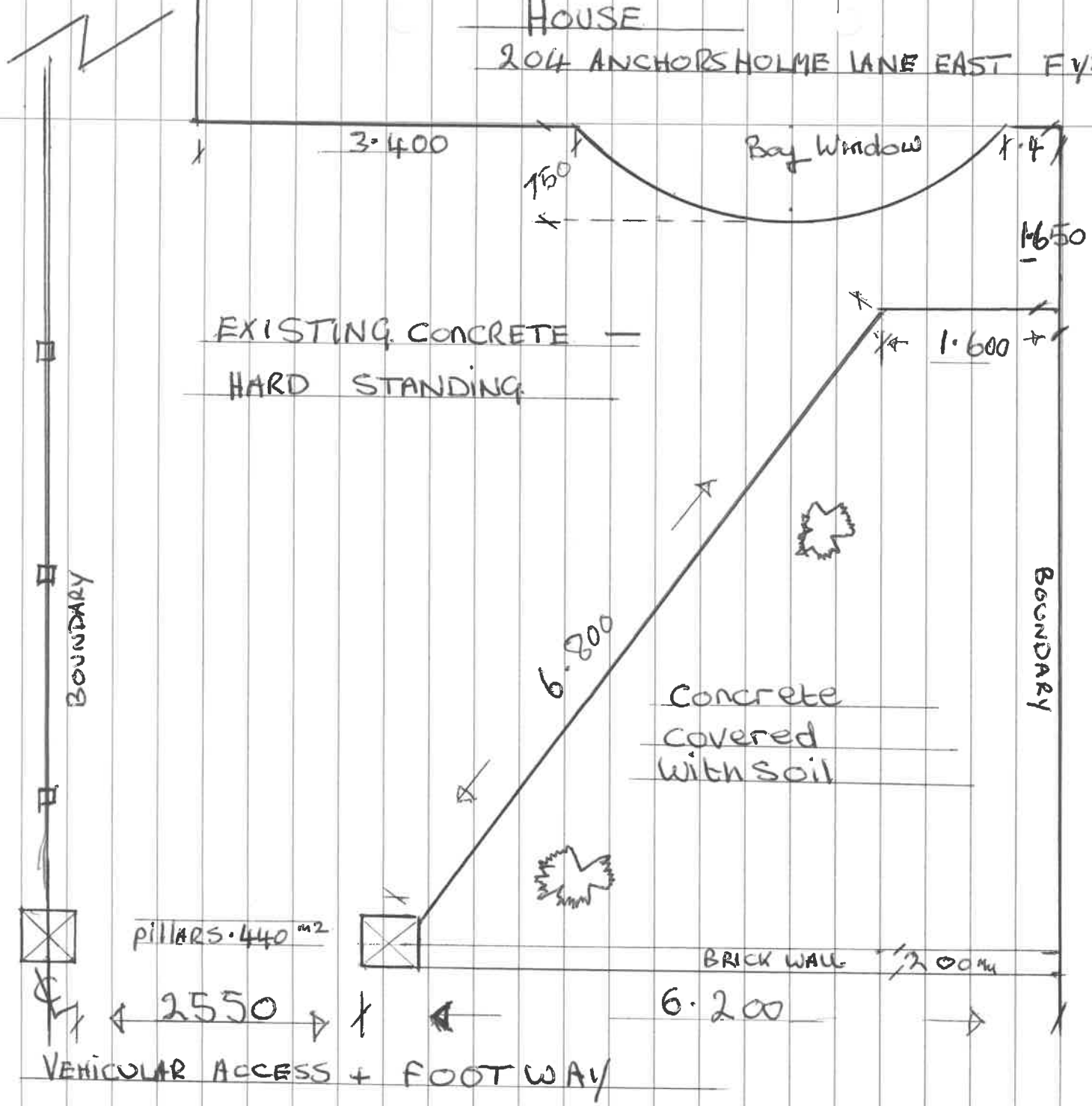

D/L (A)

H.M. LAND REGISTRY

TITLE NUMBER

LA 481488

ORDNANCE SURVEY
PLAN REFERENCE

SD 3242

SECTION D

Scale
1:1250

COUNTY LANCASHIRE

DISTRICT BLACKPOOL

© Crown copyright 1975

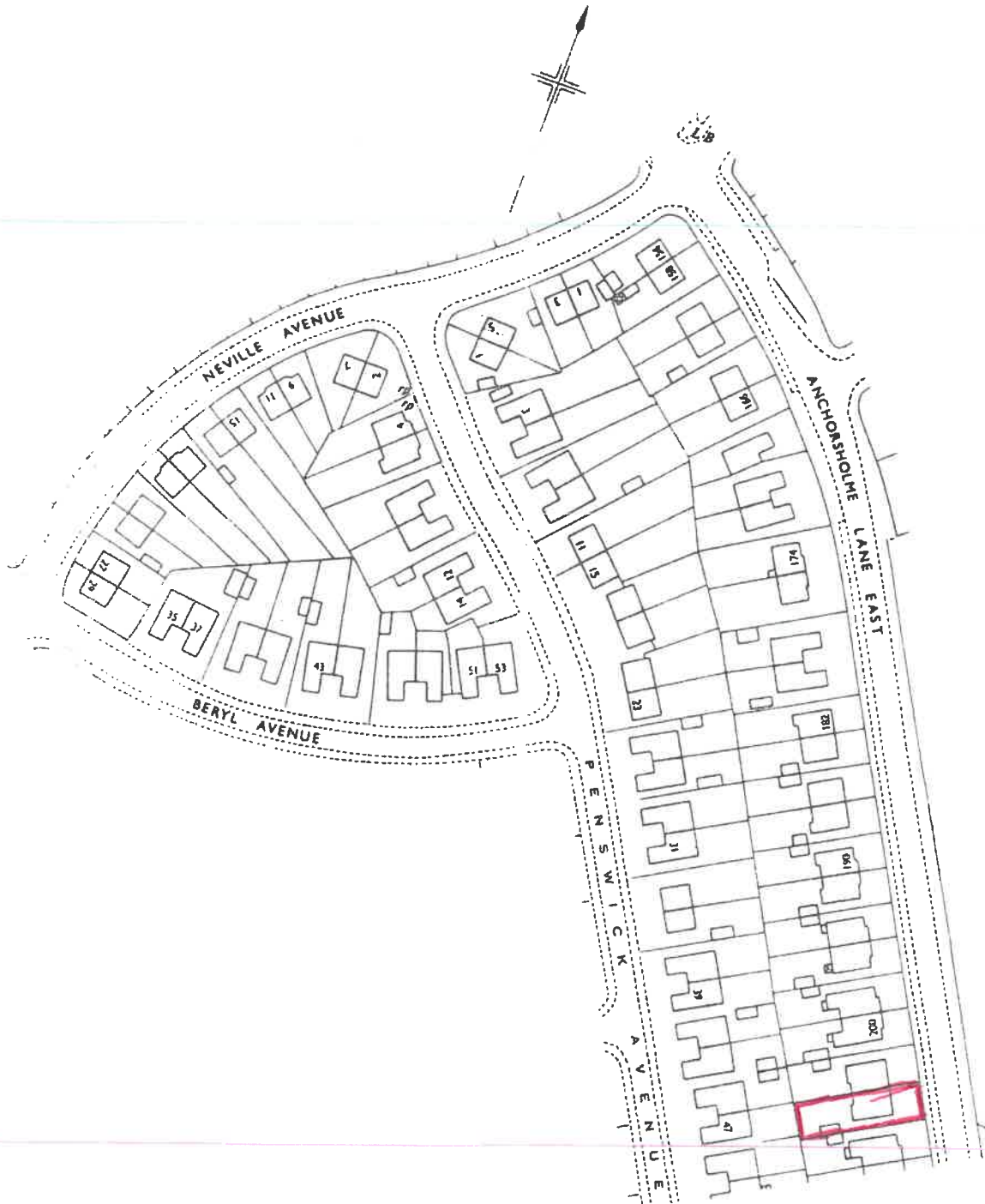

11. Ownership Certificates and Agricultural Land Declaration

One Certificate A, B, C, or D, must be completed with this application form

CERTIFICATE OF OWNERSHIP - CERTIFICATE A

Town and Country Planning (Development Management Procedure) (England) Order 2015 Certificate under Article 14

I certify/The applicant certifies that on the day 21 days before the date of this application nobody except myself/ the applicant was the owner* of any part of the land or building to which the application relates, and that none of the land to which the application relates is, or is part of, an agricultural holding**

NOTE: You should sign Certificate B, C or D, as appropriate, if you are the sole owner of the land or building to which the application relates but the land is, or is part of, an agricultural holding.

* "owner" is a person with a freehold interest or leasehold interest with at least 7 years left to run.

** "agricultural holding" has the meaning given by reference to the definition of "agricultural tenant" in section 65(8) of the Act.

Signed - Applicant:

Or signed - Agent:

Date (DD/MM/YYYY):

CERTIFICATE OF OWNERSHIP - CERTIFICATE B

Town and Country Planning (Development Management Procedure) (England) Order 2015 Certificate under Article 14

I certify/ The applicant certifies that I have/the applicant has given the requisite notice to everyone else (as listed below) who, on the day 21 days before the date of this application, was the owner* and/or agricultural tenant** of any part of the land or building to which this application relates.

* "owner" is a person with a freehold interest or leasehold interest with at least 7 years left to run.

** "agricultural tenant" has the meaning given in section 65(8) of the Town and Country Planning Act 1990

Name of Owner / Agricultural Tenant	Address	Date Notice Served

Signed - Applicant:

Or signed - Agent:

Date (DD/MM/YYYY):