

This document and its contents are copyright of studioEAST. All rights reserved. Any redistribution or reproduction of part or all of the contents in any form is strictly prohibited except with our express written permission.

DO NOT SCALE FOR CONSTRUCTION PURPOSES. ACCURACY OF THIS DRAWING IN PRINT FORM CANNOT BE GUARANTEED.

IF IN DOUBT... ASK!

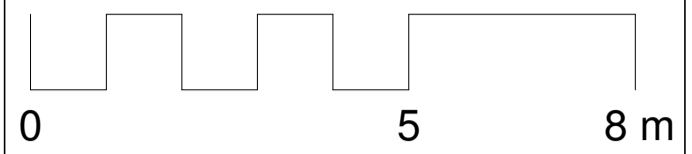

Scale 1:100

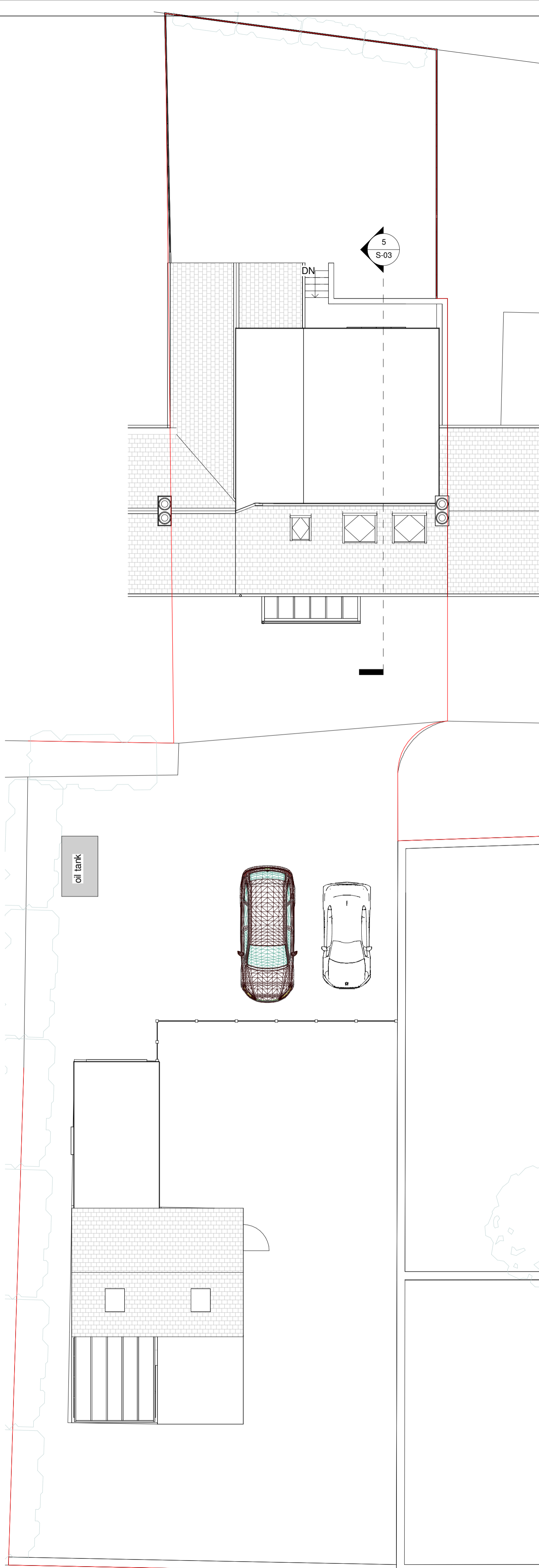
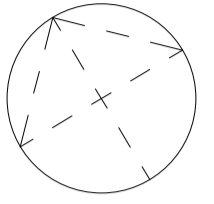

No.	Description	Date
studio EAST		
CLIENT	Mitchell	
S-02		
PROJECT	Alterations & Extension to 3 Balbirnie Cottages, Ruthven, Blairgowrie PH12 8RG	
TITLE	EXISTING SITE PLAN	
SCALE (@A2)	1 : 100	
PROJECT NUMBER	23063	
DATE	Jan 2024	
PURPOSE OF ISSUE	Planning	
DRAWN BY	FSF	

King James VI Business Centre, Friarton Rd, Perth, PH2 8DY
t: 01738 472090 e: hello@studio-east.co.uk