

rev	date	initials	revision	checked
T.0	06/07/22	DM	Coordination Issue.	RD
T.1	24/08/22	DM	Tender Issue.	RD
T.2	03/04/23	MH	Revised topo survey. Building set out to standard brick dimensions following VE	RD
C.0	01/06/23	MH	Construction Issue	RD
C.1	18/07/23	MH	Substation location revised. Swale reduced to SEng info.	RD
C.2	10/08/23	MH	Update to GF Plan. RWP and SVPs relocated	RD
C.3	01/12/23	RD	Western footpath omitted	RD



Site layout based on Kemp Engineering & Surveying topographical survey, 22-1778-001 rev A, dated 06-02-2023.

Easement for drainage connection from adjacent site taken from Report on Title document CL113252.

Key

- · — · Site Boundary
- - - - - Post and Rail Fencing
- - - - - 2.4m high welded mesh flat profile security fencing and gates
- - - - - Vehicle jet wash bay enclosure by specialist

The drawing is copyright. All rights reserved in Chapter 17 of the Copyright, Designs and Patents Act 1988 have generally been assigned, as appropriate, to the author or the copyright owner. Reproduction, distribution or other use without the prior written consent of GFA is prohibited.

Client
Rodenhurst Estates Limited

Project
Site 2
Victoria Business Park
Roche
Cornwall

Title
Site Layout - Proposed Site Plan

Drawing No
21030-GFA-ZZ-XX-DR-A-10003
Rev Drawn Date Scale
C.3 RD 06/07/22 1:750 @ A3

GAUNT FRANCIS Architects
Cardiff & London
23 Womansly Street | Cardiff CF10 1BR | T: 029 2023 3993 | W: Gauntfrancis.co.uk

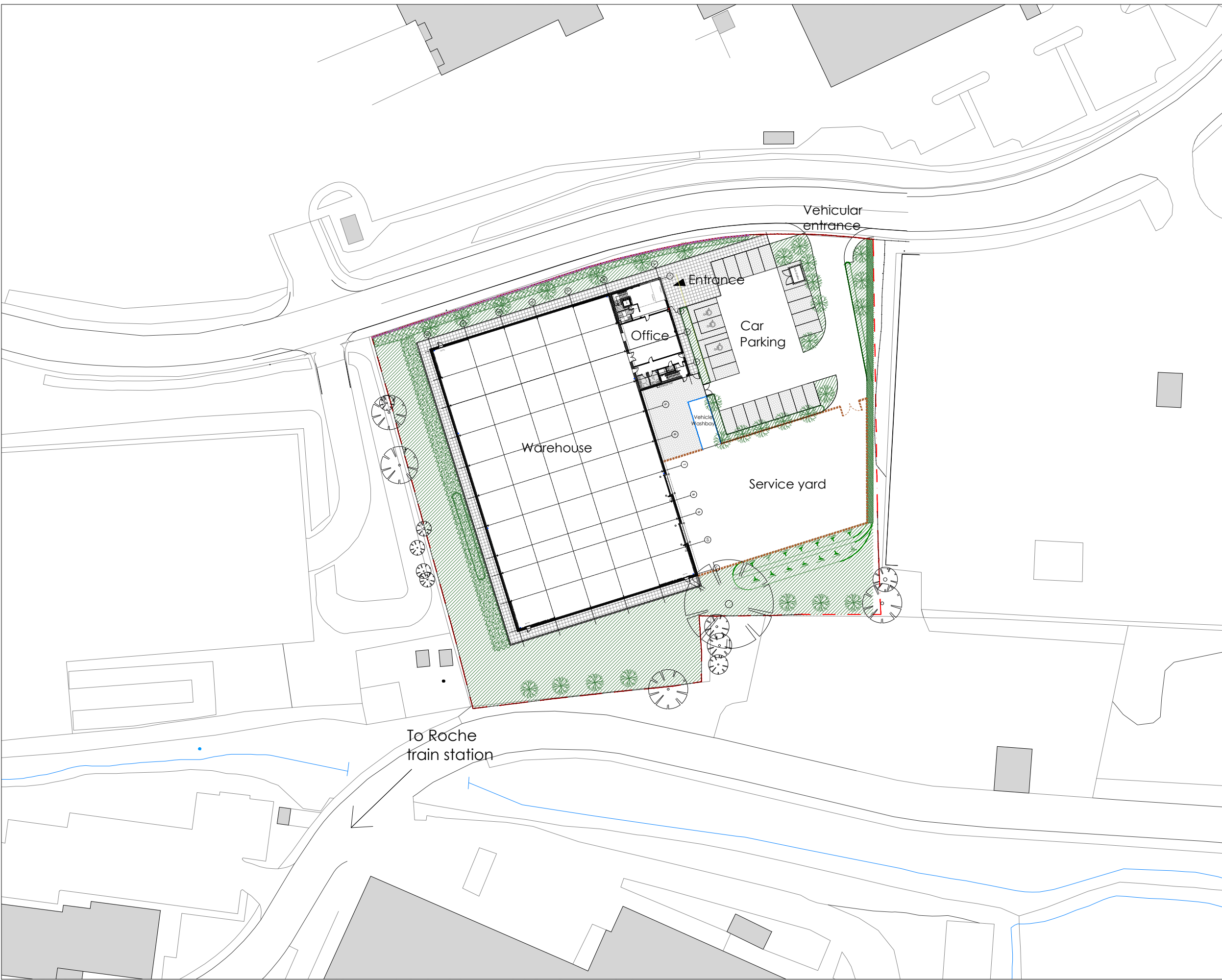

Site Layout - Proposed Site Plan



L:\Projects\21030_Victoria Business Park_Roche_S1_Archi_E_Cornwall\DISIGN\PROGRESS\A_GAUNT\DWG\03_SITE_PLAN.dwg