

Notes :

INFRASTRUCTURE
 Drawings are to be read in conjunction with all relevant specialists' drawings and specifications. Any discrepancies from the information indicated on these drawings shall immediately be brought to the attention of the engineer.
Health & Safety :
 All specific drawing notes are to be read in conjunction with the project 'Information Pack' and 'Site Rules'.
 All drainage design and installation to be carried out in accordance with the following:
 BS EN 12056: Gravity drainage systems inside buildings.
 BS EN 12056: Gravity drainage systems outside buildings.
 BS EN 12056: Sewers for Adoption - Current edition
 BS 8000 Pt-14 - Workmanship on building sites.

DRAINAGE NOTES:
 All pipes to be laid in class 'S' bed in external areas, unless cover is less than 600mm by class 'Z' bedding. If pipework is below an RC slab, Class V/W bedding should be used.
 All FWP/RWPs and gullies are shown indicatively; to be set out by others.

Initial below ground nominal 100mm diameter foul and surface water lateral and pipework 150 respectively (unless stated otherwise). Where necessary, to avoid clashes, lateral connections may be laid to nominal falls and ramp at 45 degrees to manhole invert or pipe junction.
 All drainage pipes to be cast in concrete when passing under foundations, with sleeving or rooker joints.
 All bends in pipework shall be long radius.
 Pipe connections not to inspection chambers shall be via preformed oblique junction swept in the direction of flow, with above ground rodding provided.
 All internal manholes to have double sealed and bolted covers to stop the egress of odours.
 Covers to be recessed for in-fill to suit Architects floor finishes.

DRAINAGE LEGEND	
New FV Drain	
New SW Drain	
DRAINAGE KEY	
RWP	Rainwater Down Pipe
FWP	Foul Waste Pipe
RE	Rodding Eye
	Permeable paving

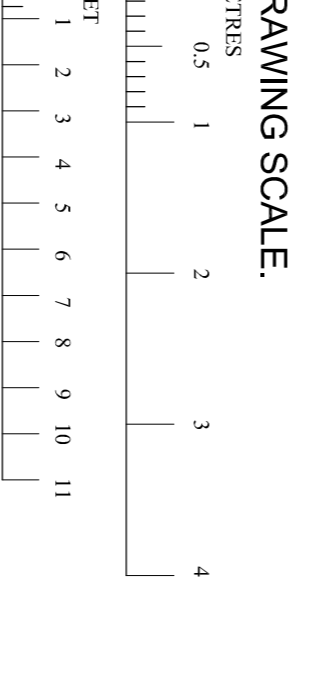

Ver	Date	Drawn	Amendment
1	01/02/24	AJS	Issued for Planning approval

Mrs J. FITZGERALD
 85, HORSHAM AVENUE
 LONDON, N12 9BG
 NEW SINGLE STOREY REAR
 EXTENSION
 EXISTING & PROPOSED
 LAYOUTS
 Status
PLANNING ISSUE

Drawn	A.Sharks
Scales	1:50
Drawing No	1400-01
Ver	1

NO TREES WITHIN 30M OF THE PROPOSED EXTENSION

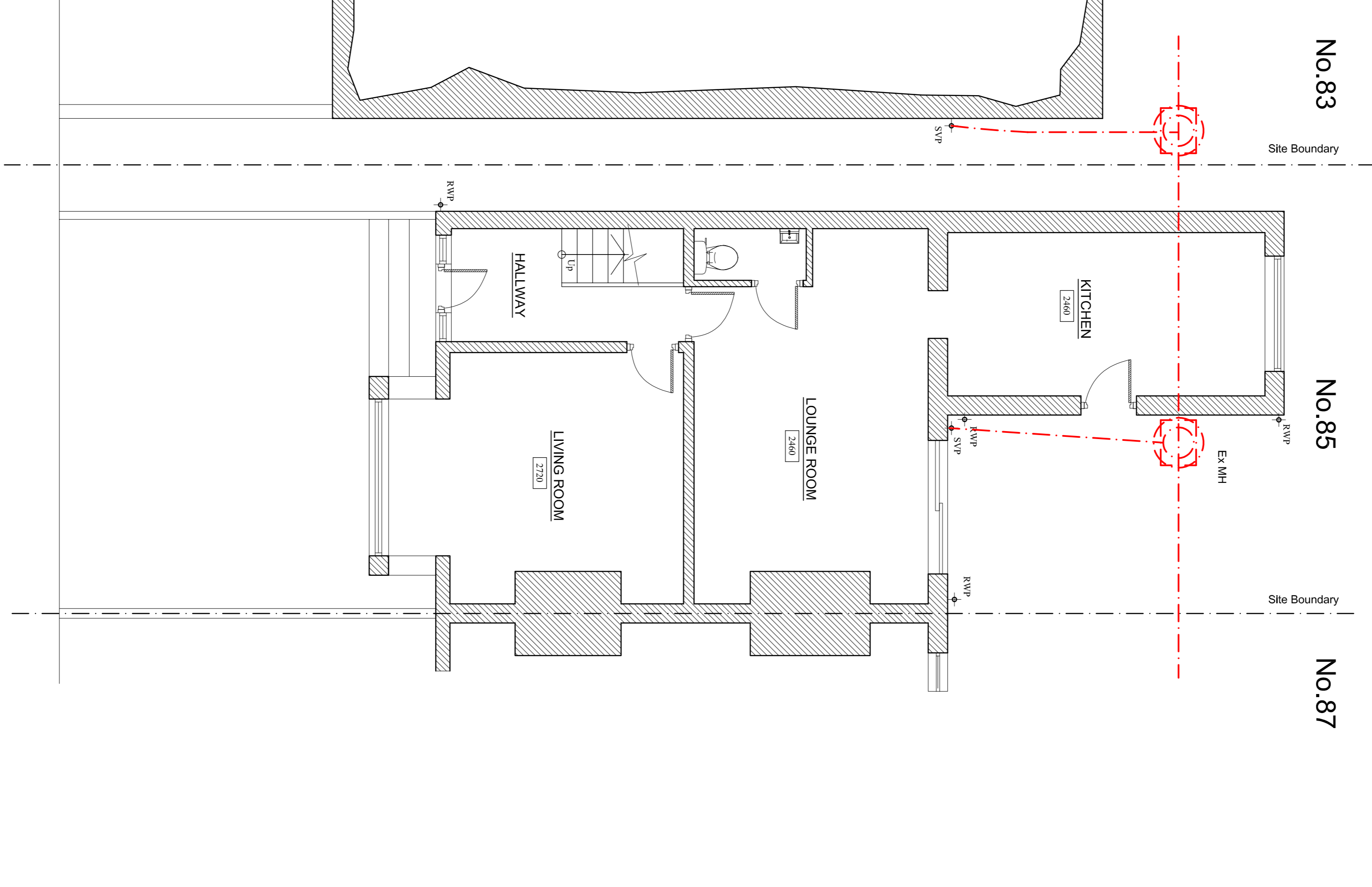
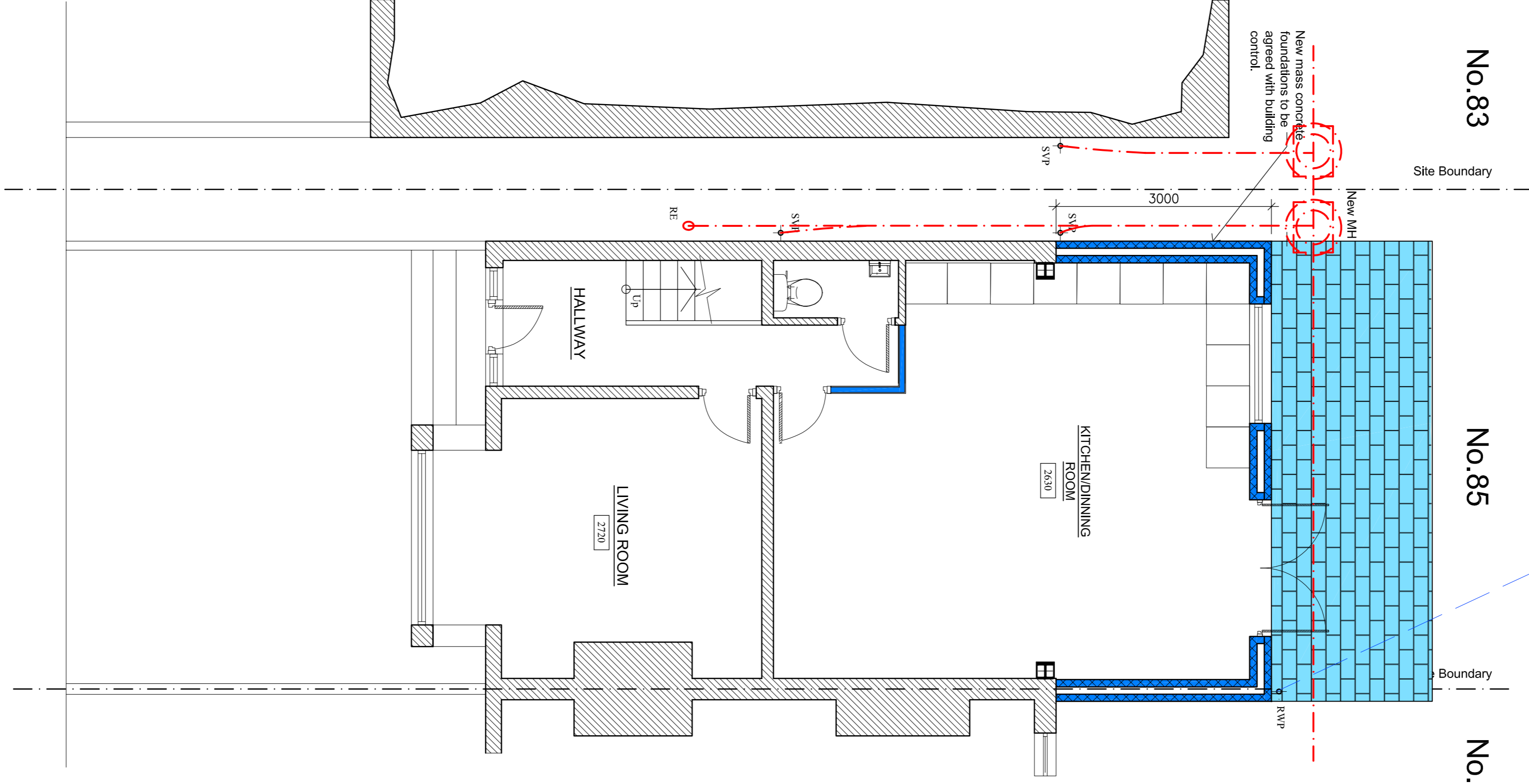

EXISTING GROUND FLOOR PLAN

MAIN HOUSE WALLS (GROUND FLOOR - FIRST FLOOR) - SOLID BRICKWORK CONSTRUCTION 215mm blk
 MAIN HOUSE WALLS (FIRST FLOOR - EAVES) - SOLID BRICKWORK CONSTRUCTION 215mm blk
 MAIN HOUSE WALLS (FIRST FLOOR - EAVES) - SOLID BRICKWORK CONSTRUCTION 215mm blk
 DOORS - UPVC
 WINDOWS - UPVC

PROPOSED GROUND FLOOR PLAN

MAIN HOUSE WALLS (GROUND FLOOR - FIRST FLOOR) - SOLID BRICKWORK CONSTRUCTION 215mm blk
 MAIN HOUSE WALLS (FIRST FLOOR - EAVES) - SOLID BRICKWORK CONSTRUCTION 215mm blk
 MAIN HOUSE WALLS (FIRST FLOOR - EAVES) - SOLID BRICKWORK CONSTRUCTION 215mm blk
 DOORS - UPVC
 WINDOWS - UPVC

ALL NEW ELECTRICAL WORK IS TO BE DESIGNED, INSTALLED, INSPECTED AND TESTED IN ACCORDANCE WITH BS7671 (I.E. WIRING REGULATIONS 18TH EDITION). THE WORKS ARE TO BE UNDERTAKEN BY AN INSTALLER REGISTERED UNDER A SUITABLE ELECTRICAL SELF-CERTIFICATION SCHEME OR ALTERNATIVELY BY A SIMILARLY QUALIFIED PERSON WITH A CERTIFICATE OF COMPLIANCE PRODUCED BY THAT PERSON TO BUILDING CONTROL ON COMPLETION OF THE WORKS.