

DO NOT SCALE FROM THIS DRAWING. ALL DIMENSIONS ARE TO BE CHECKED ON SITE. THIS DRAWING IS TO BE READ IN CONJUNCTION WITH ALL CONSULTANTS INFORMATION.

TAYLORHARE ARCHITECTS IS A LIMITED COMPANY REGISTERED IN ENGLAND AND WALES. NO. 10695684.

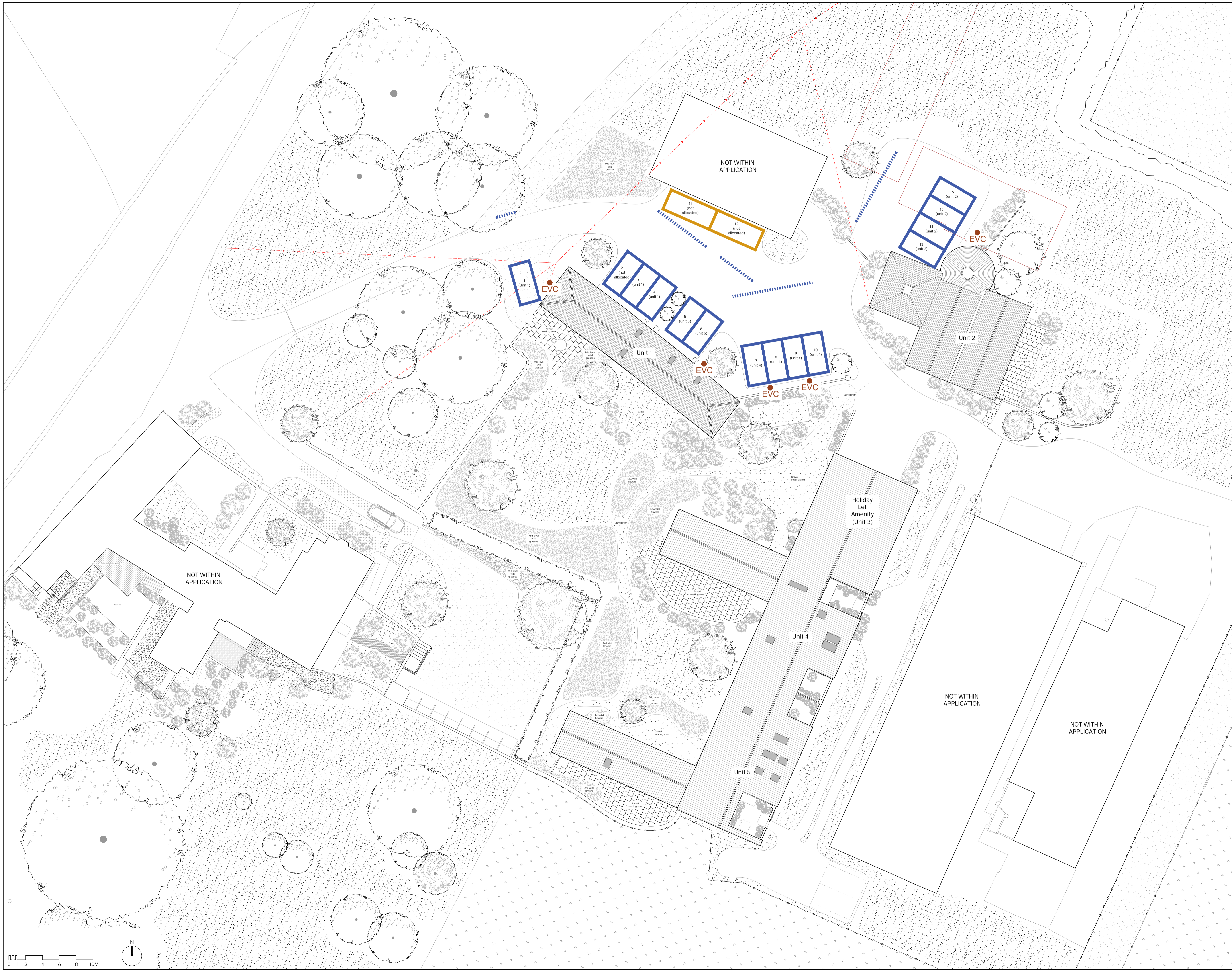

KEY

- EV CHARGING POINT
- GUEST PARKING - BAY (5M offset parallel (5.0M x 2.5M))
- GUEST PARKING - PARALLEL (6M x 2.4M)

GUEST PARKING
Residential Space Standards Shown Below
(reference only)
Per Dwelling
3 Bed - 2 Spaces Required
4 Bed - 3 Spaces Required
VISITOR PARKING
0.2 Spaces/Dwelling
1.0 Spaces Required

REV	DATE	DESCRIPTION



PROJECT:
2203_BFSG
Bramling Court Farmhouse
Mr & Mrs Whitebread

DRAWING TITLE:
Proposed
Site Plan - Parking Plan

SCALE:
1:200 @ A1
DATE DRAWN:
December 2023

DRAWN BY:
O6
CHECKED BY:
13

STATUS:
Planning

DRAWING NUMBER:
2203_3103

REVISION: