

PROPOSED ELEVATION SIDE A  
SCALE 1:100

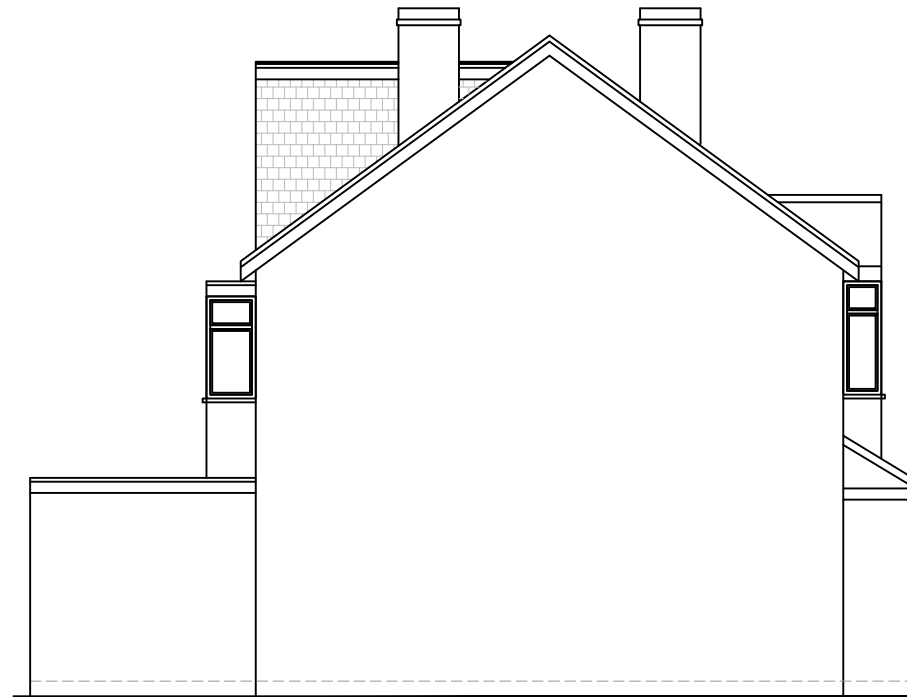

PROPOSED ELEVATION SIDE B  
SCALE 1:100



PROPOSED FRONT ELEVATION  
SCALE 1:100

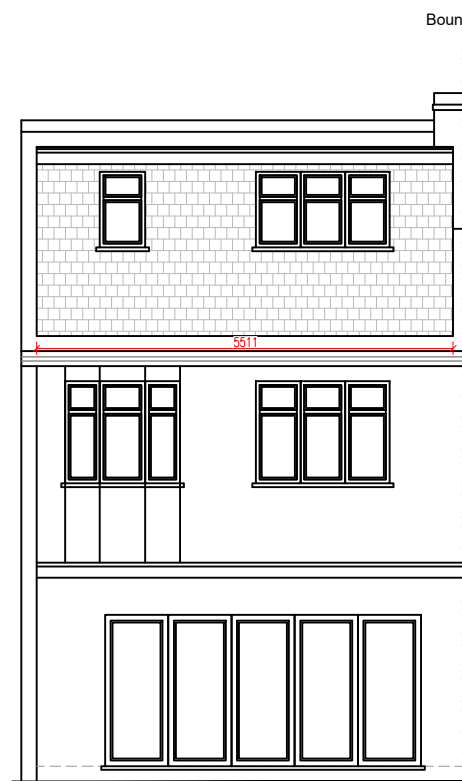

PROPOSED REAR ELEVATION  
SCALE 1:100

① = HIP TO GABLE

$$\frac{7.77 \times 3.05 \times 4.02}{2 \times 3} = \frac{95.26}{6} = 15.87 \text{ m}^3$$

② = DORMER

$$\frac{3.41 \times 2.49 \times 5.51}{2} = \frac{46.78}{2} = 23.39 \text{ m}^3$$

TOTAL VOLUME

$$15.87 + 23.39 = 39.26 \text{ m}^3 < 40 \text{ m}^3$$



www.FastPlansUK.co.uk

Project: Loft Conversion with Dormer to Rear.

Address: 39 TAUNTON CL, SM3 9NG

Scale: 1:100 @ A3

Dwg. no: A06

Drawn by: O.B.S

Date Drawn: 23-DEC-2023

For Drawings Tel: 0208 154 5569

E-mail: plans@FastPlansUK.co.uk