

KENSINGTON GARDENS

KENSINGTON GARDENS

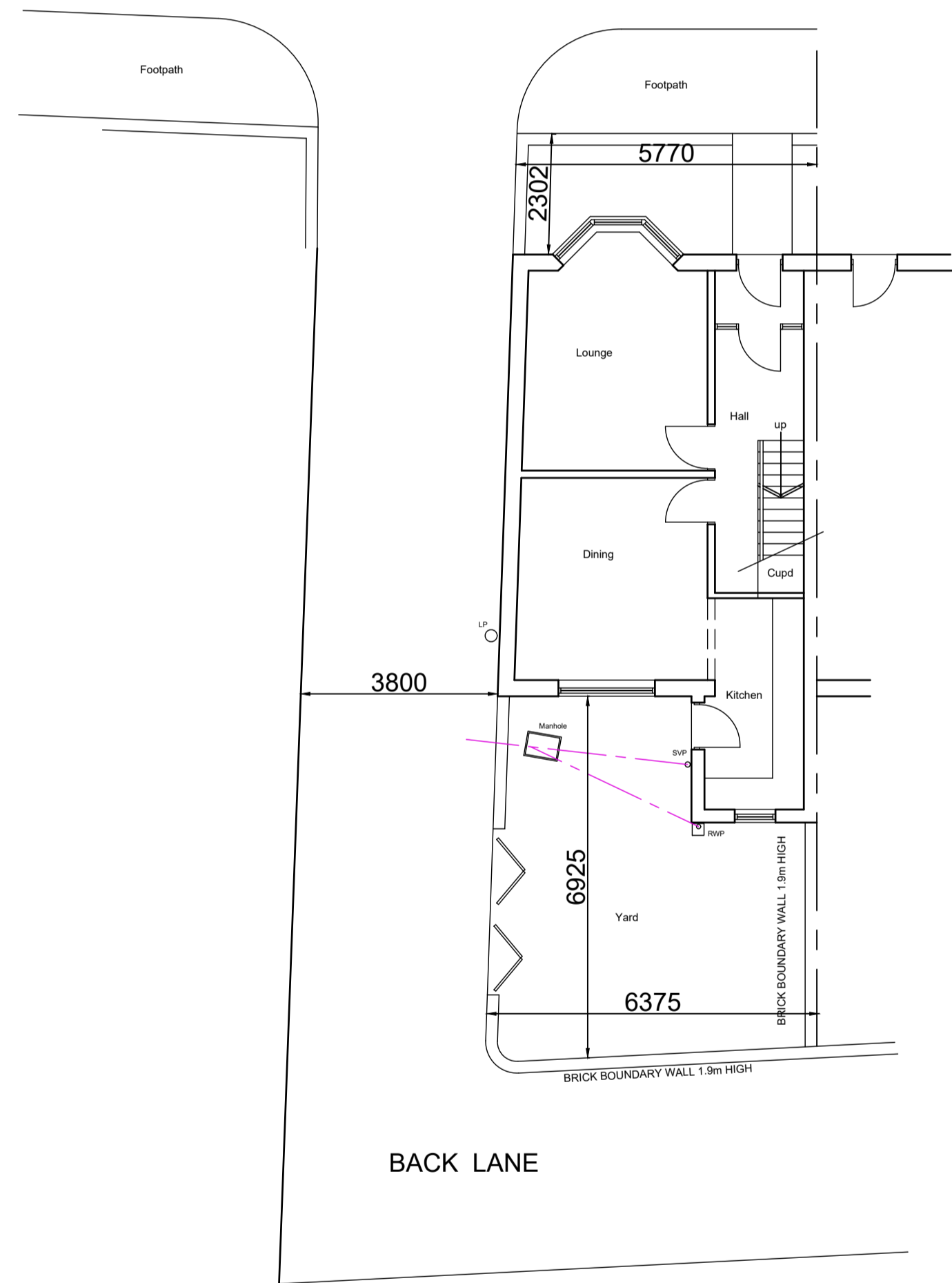

N0 17 KENSINGTON GARDENS

SITE PLAN AS EXISTING



N0 17 KENSINGTON GARDENS

SITE PLAN AS PROPOSED



BELOW GROUND DRAINAGE SYSTEMS
 Below ground drainage pipes will comprise of either 100mm diameter Hepworth vitrified clayware to BS 65 or 100mm diameter PVCU to BS 5481/BS 4660 laid on granular bedding materials to BS 882 Table 4. The selected fill materials should be free from stones larger than 40mm, clay exceeding 100mm, timber, frozen materials or vegetable matter. Where rigid pipework of less than 150mm diameter have less than 300mm of cover or a rigid pipe of 150mm diameter or more has less than 600mm of cover, then these pipes should be suitably encased within 150mm of concrete surround. Where flexible pipework are not located under a highway and have less than 600mm of cover then these pipes should be suitably encased within 150mm of concrete surround. When drainage runs are within 1.000m of any foundation and the level of the drainage trench is below the level of the foundation then that trench should be suitably backfilled with concrete. Any drainage pipe which may penetrate through a building structure below the finished ground level will be protected with a lintol support and a settlement gap of not less than 25mm which incorporates a flexible material to provide necessary protection to the drainage. All gravity drainage will have a minimum fall requirement of 1:40 to provide for self cleansing velocities. All gully systems will be back inlet trapped type unless otherwise stated. Inspection chambers/ manholes up to a maximum depth of 900mm may be a proprietary system of PVCU material otherwise they will be constructed of 150mm thickness concrete base slab 1:2:4 mix with benching formed in 1:2 concrete mortar to 1:12 gradients. all trowelled smooth with appropriate channels, branches and connection bends. The walling of the chamber will be constructed with 215mm thickness Class B engineering brickwork to BS 3921 formed in English Garden wall bond to the required invert. 150mm concrete cover slab with the appropriate haunching forming the cover levels and frame. The inspection chamber cover will be mild steel and medium duty screw down sealed type unless otherwise stated. On completion of the works the entire drainage system will be tested for water tightness to the satisfaction of the local authority building control officer. (APPROVED DOCUMENT H 1991 BUILDING REGULATIONS)

CONTRACTOR TO BE RESPONSIBLE FOR: investigating the existing drainage and establishing the exact run locations in conjunction with the Building Inspector and agreeing in full the final drain runs and connections .

AJDESIGNNCL
 07734342533
 WWW.AJDESIGNNCL.CO.UK

CLIENT
 MR & MRS METCALFE

ADDRESS
 No17 KENSINGTON GARDENS
 NORTH SHIELDS
 NE30 2AL

JOB TITLE
 No17 KENSINGTON GARDENS
 NORTH SHIELDS
 NE30 2AL

EXISTING PROPOSED SITE PLANS

contractor to note
 All dimensions to be checked on site
 Figured dimensions to be taken in preference to scaling
 Any discrepancies to be reported to the Architect immediately

SCALE
 1 : 100

DATE

DWG No
 1034 /03

REV No