

Lift legs fixed to ceiling joist / ties via spreader plate using 12no. 5mmx70mm proprietary screws.

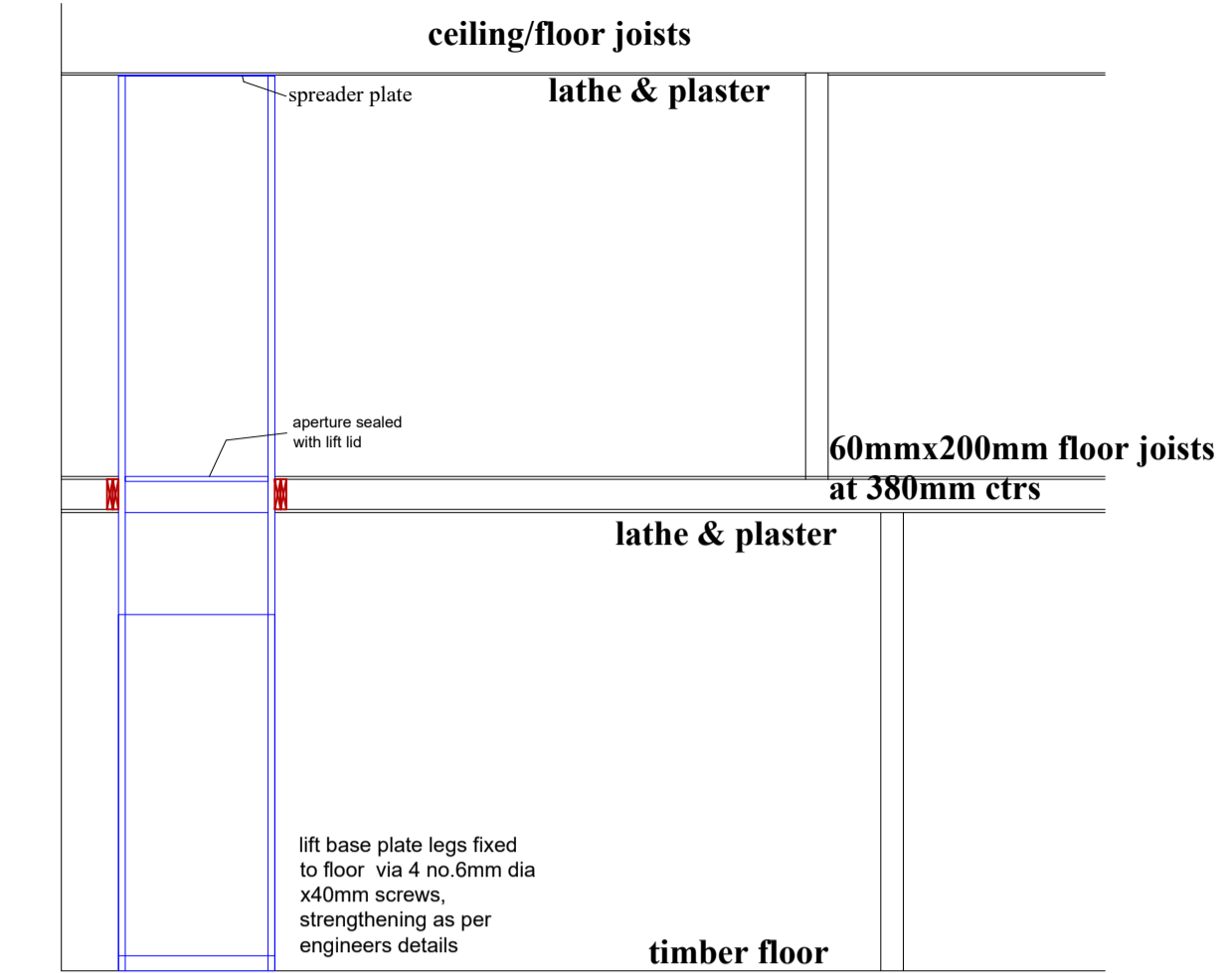

PROPOSED SECTION AA LIFT ON GF

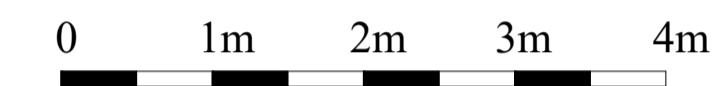

Lift legs fixed to ceiling joist / ties via spreader plate using 12no. 5mmx70mm proprietary screws.

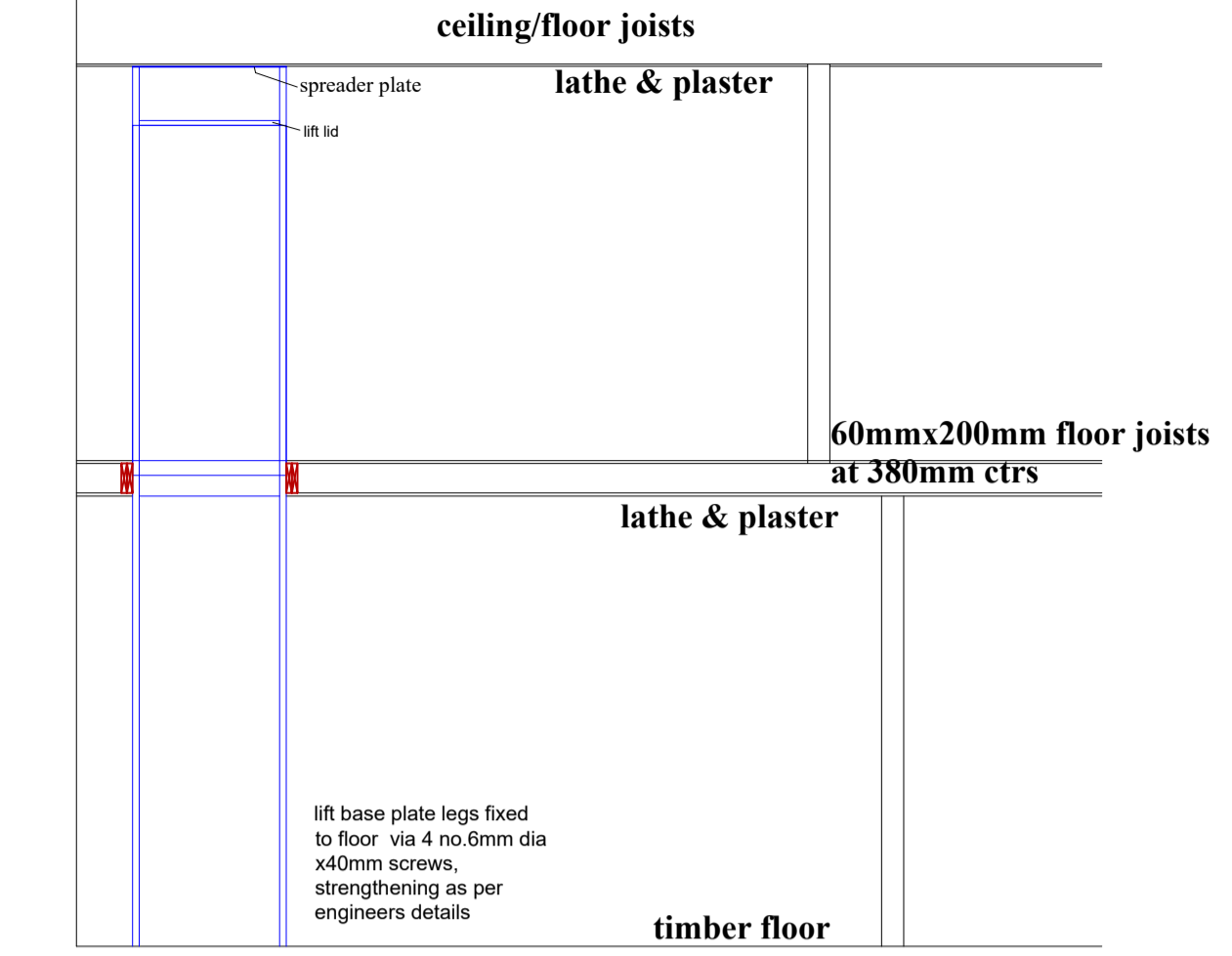

PROPOSED SECTION AA LIFT ON FF

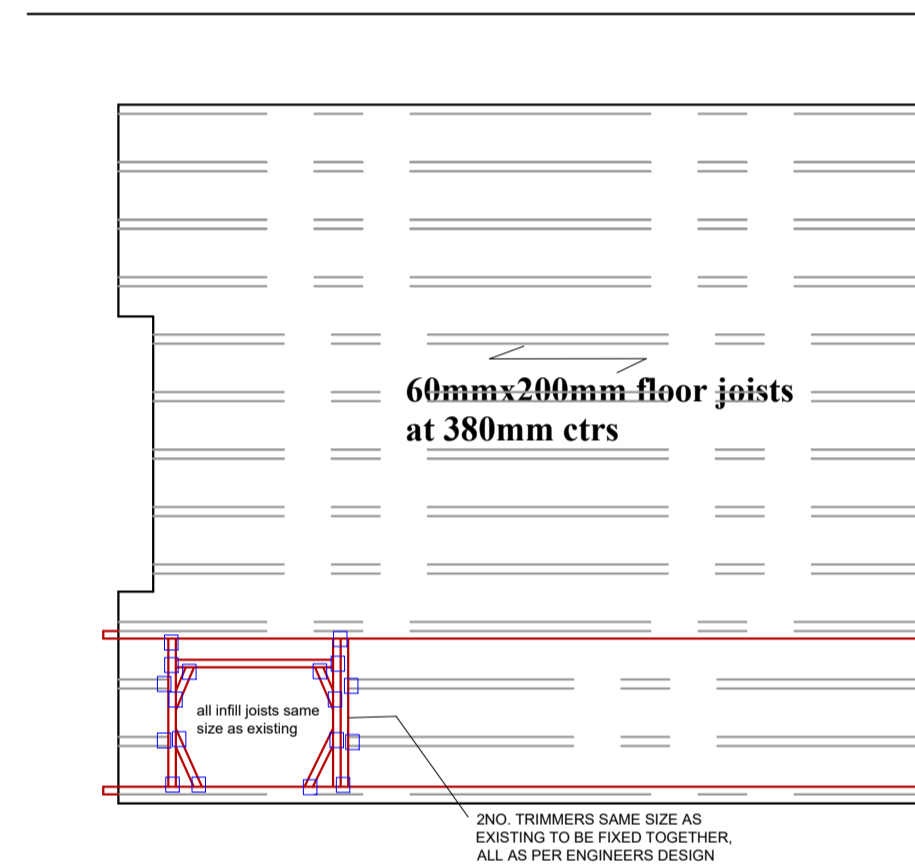
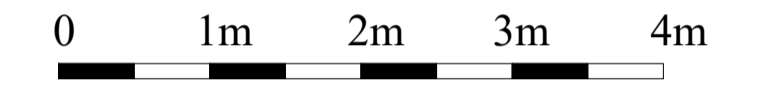

FIRST FLOOR TRIMMING DETAIL

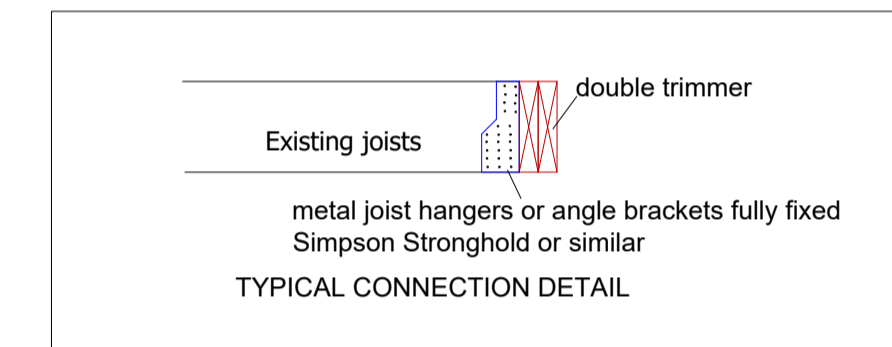
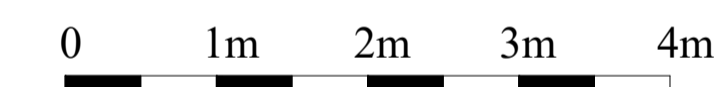

**ELECTRICAL**  
All electrical work- to comply with current IEE regulations and BS 7671 : 2018.  
13amp spur unit dedicated supply RCD protected conforming to BS 7671

**Electrical Fixtures**  
Outlets and controls of electrical fixtures and systems should be positioned at least 350 mm from any internal corner, projecting wall or similar obstruction and, unless the need for a higher location can be demonstrated, not more than 1.2 m above floor level. This would include fixtures such as sockets, switches, fire alarm call points and timer controls or programmers. Within this height range: light switches should be positioned at a height of between 900 mm and 1.1 m above floor level; standard switched or unswitched socket outlets and outlets for other services such as telephone or television should be positioned at least 400mm above floor level. Above an obstruction, such as a worktop, fixtures should be at least 150 mm above the projecting surface. Where socket outlets are concealed, such as to the rear of white goods in a kitchen - separate switching should be provided in an accessible position, to allow appliances to be isolated.

**STILTZ DUO CARRIAGE GUIDE RAILS**  
TO BE FIXED PLUMB AS PER MANUFACTURERS DETAILS. COMMAND STATION IN CAR AND AT BOTH FLOORS WHICH INCLUDE DIRECTION STOP, KEY LOCKING CAR LIGHT AND DOOR OPEN/CLOSE CONTROLS. IN THE EVENT OF POWER FAILURE BATTERY BACK UP SYSTEM ALLOWS OPERATION OF CAR IN DOWNWARD DIRECTION BY NORMAL CONTROLS WITH ALL SAFETY SYSTEM IN OPERATION.

**TRIMMING NOTES FIRST FLOOR**  
APERTURE TRIMMED BY CUTTING OUT EXISTING JOISTS AS REQUIRED. ADDING NEW JOISTS BOLTED TO EXISTING AND TRIMMING JOIST, ALL NEW JOISTS TO MATCH EXISTING AND TO BE INSTALLED AS PER ENGINEERS DETAILS.

General Notes

**PROPOSAL**  
Installation of Siltz Duo-car Lift from Ground floor Lounge to First Floor Bedroom, by forming aperture in floor / ceiling. The reason for lift is to benefit disabled owner to be able to stay in own home independently with the existing support network in place, the Lift can easily be removed and returned to original when no longer required.

No.	Revision/Issue	Date

**ARCHITECTURAL SERVICE**  
237 Baldrigeburn  
Dunfermline  
KY12 9EG  
01383 729243  
07710 797364  
arch\_services@hotmail.com

Project Name and Address  
Siltz Lifts  
Client  
Mr David Quarmby  
61 Royal Hill  
London  
SE10 8RZ