

Arboricultural Assessment

for

**St Michael on The Mount
Parish Hall, Park Lane
Bristol BS2 8BE**

Prepared by

Tim Pursey

MICFor, M.Arbor.A., Dip.Arb.(RFS), Tech.Cert.(Arbor.A.)

Arboricultural Consultant

Tel. 0117 951 1375

1 Stanley Park, Lower Easton

Bristol BS5 6DT

Email info@tree-expert.com

www.timpursey.co.uk

1.0 Date of survey

1.1 July 2023

2.0 Surveyor

2.1 Tim Pursey

3.0 Instructions

3.1 As a result of a planning application, I am instructed to undertake an arboricultural assessment and to prepare a report assessing the impact that the proposed development will have on trees growing at the site.

3.2 The report includes:

- An indication of the constraints placed on the design by the trees on site
- Site plan detailing the existing trees on site – drawing TP 3039/2306/TCP appended
- A schedule indicating the tree survey results
- A Tree Protection Plan drawing TP 3039/2306/TPP

4.0 Report limitations

4.1 All inspections were made from ground level, using binoculars where necessary. Should a more detailed inspection, by climbing or by elevated platform, be required then this will be highlighted within the survey recommendations.

4.2 I have not contacted the local authority to determine the legal status of any trees either on or around the site. If any are subject to legal protection, then prior permission must be obtained from the local authority before undertaking tree works.

4.3 Trees are living, dynamic organisms. Their health and overall condition changes as the trees grow and can be affected by external conditions. For this reason, the condition survey and any recommendations given are valid for a period not exceeding one calendar year from the date of issue of this report.

4.4 The method statement and tree protection plan in this document are provisional and subject to confirmation.

5.0 Proposals

- 5.1 It is proposed to demolish an existing structure and build a new dance hall at the property.
- 5.2 One tree is proposed to be removed to facilitate works.

6.0 Tree survey

- 6.1 See schedule of tree survey results.

7.0 Assessment of Impact

- 7.1 Holly T1 grows on an adjacent property. Its canopy and root protection area do not extend as far as the boundary wall. The wall will remain so the tree will be unaffected by the proposals. No further protective measures will be required.
- 7.2 Ash T2 grows out of the base of a stone boundary wall. It is evidently self-sown with some minor Ash Dieback. The tree is likely to fully succumb to Ash Dieback in time but may be removed before that due to damage, or potential damage, to the stone wall. It is recommended the tree is removed in any case, irrespective of any proposals at the property.
- 7.3 Bristol City Council maintains a tree replacement standard. Within the confines of this standard, removal of trees for development purposes normally attracts a requirement to plant replacement trees. In this instance, the category grading of the Ash tree means that no replacement trees are required in this particular instance.
- 7.4 In conclusion, no specific tree protection measures are required and no replacement trees are required to be planted following completion of works.

8.0 Provisional Method Statement to Mitigate Impact

8.1 Tree Works

Tree T2 will be removed. The stump may be ground out or removed with a machine as preferred.

8.2 Protective Fencing

No protective fencing is necessary or required in this instance.

8.3 Service Installation

There will be no excavation for services within the root protection area of any retained tree. Further advice regarding services may be obtained from the project arboriculturist.

8.4 General

No storage or mixing of cement/concrete will be permitted anywhere within 10 metres of any retained tree. Account will be taken of any slopes in order to avoid the possibility of cement washings running into the rooting areas of retained trees.

8.5 Oil, bitumen or other material likely to be injurious to a tree should not be stacked or discharged within 10 metres of the trunk. Materials generally should not be stacked or discharged within 5 metres of the trunks.

8.6 Arboricultural Supervision

Given the negligible risk of damage to Holly T1 and absence of other trees likely to be affected, no further input from the project arboriculturist is deemed necessary.

8th August 2023

Tim Pursey

Chartered Arboriculturist

Tree Survey

Key:

- Height: Estimated in metres.
- Stem diameter: Measured at 1.5m above ground level.
- Branch spread: Estimated in metres at four cardinal points.
- Height of crown
Clearance: Height in metres (estimated) above adjacent ground level to inform on ground clearance, crown stem ratio and shading.
- Age class: Young tree in first third of its life expectancy
Middle age tree
Mature trees
Over Mature
Veteran
- Category grading: **A/B/C/U** – In accordance with BS 5837:2012 *Trees in relation to design, demolition and construction – Recommendations*.
- Category A – High Quality
Category B – moderate quality
Category C- low quality
Category U – trees for removal
- All surveys and inspections made from ground level unless otherwise stated.

St Michael on The Mount Parish Hall, Park Lane, Bristol BS2 8BE

Tree No.	Species	Height (m)	Stem Dia.(mm)	Crown Radius (m)				Crown Ht. (m)	Age Class	Remaining Contribution	Structural and Physiological Condition	Preliminary Management Recommendations	Retention Category
				N	E	S	W						
T1	Holly	6	315	3.5	3.5	3.5	3.5	2.2	Mat	40+	Normal. Growing in adjacent garden	None	B1 B2
T2	Ash	8	Est 250	3.5	3.5	3	3	2	Mid	<10	Self-sown tree with minor Ash Dieback. Ivy-covered. Tree growing out of base of stone wall	Remove tree and effect repairs as necessary	U

Bibliography

- British Standard 3936-1:1992 Nursery Stock- Specification for Trees and Shrubs
British Standard 3998:2010 Recommendations for Tree Work
British Standard 4428:1989 Code of Practice for General Landscaping Operations
British Standard 5837:2012 Trees in Relation to Design, Demolition and
Construction – Recommendations
- Tree Preservation Orders: A Guide to The Law and Good Practice 2000
- Subsidence of Low-Rise Buildings 2000 Institution of Structural Engineers
Standards-Chapter 4.2 Building Near Trees 2003 National House Building Council
- Guidelines for The Planning, Installation and Maintenance of Utility Services in
Proximity to Trees 1995 National Joint Utilities Group
- Controlling Water Use of Trees to Alleviate Subsidence Risk
2004 Horticulture Link Project 212
- Inspection of Highway Trees Roads 52/75 1975 Department of the Environment Circular
- Forestry Commission Information Notes
Phytophthora Pathogens of Trees: Their Rising Profile in Europe FCIN030 1999
Forests, Carbon and Climate Change: the UK Contribution FCIN048 2003
- Forestry Commission Bulletin Climate Change: Impact on UK Forests FCBU125 2002
- Essential Soil Science 2003 Ashman, M.R. & Puri, G.
Visual Amenity Valuation of Trees and Woodlands
2003 Helliwell, D.R.
- The Hillier Manual of Trees and Shrubs 2004 Hillier, J. & Coombes, A.
The Arboriculturalist's Companion 1990 James, N.D.G.
Collins Tree Guide 2004 Johnson, O. & More, D.
Habitat Management for Invertebrates 2001 Kirby, P.
Dead Wood Matters: The Ecology and Conservation of Saproxylic Invertebrates in Britain
1992 Kirby, K.J. & Drake, C.M.
- Physiology of Woody Plants 1979 Kramer, P.J. & Kozlowski, T.T.
Hazards from Trees: A General Guide 2000 Lonsdale, D.
Principles of Tree Hazard Assessment and Management
2001 Lonsdale, D.
- The Body Language of Trees 2003 Mattheck, C. & Breloer, H
Trees of Britain and Northern Europe 1978 Mitchell, A.
Fungal Strategies of Wood Decay in Trees 2004 Schwarze, F., Engels, J, Mattheck, C.
Modern Arboriculture 2003 Shigo, A.L.
Diagnosis of Ill-Health in Trees 2000 Strouts, R.G. & Winter, T.G.
Soil Types: A Field Identification Guide 1989 Trudgill, S.
Manual of Wood Decays in Trees 2003 Weber, K. & Mattheck, C.
Reducing Infrastructure Damage by Tree Roots
2003 Costello L.R. & Jones K.S.

Tree Roots in the Built Environment 2006 Roberts, Jackson, Smith
Publications from Arboricultural Advisory and Information Service
APN1 Driveways Close to Trees Patch, D. & Dobson, M.
APN12 Through the Trees to Development Patch, D.
ARIN 130/95/ARB Tree Root Systems Dobson, M.

Existing site overgrown with Elder,
Bramble, small saplings etc.
Hut covered with Virginia Creeper

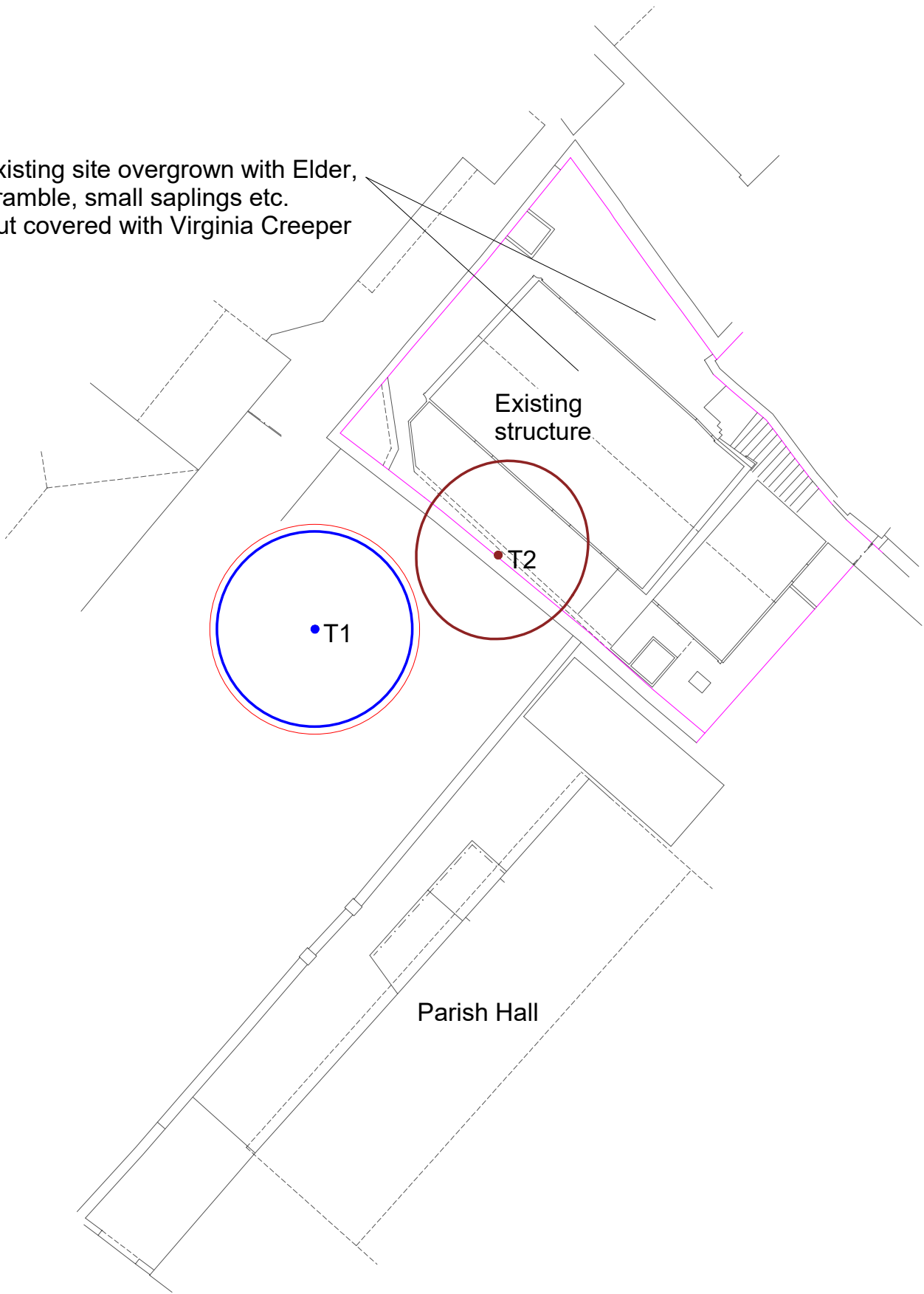

- Category U trees
- Category B trees
- Root protection area

Tim Pursey
Arboricultural Consultant
1 Stanley Park, Lower Easton, Bristol BS5 6DT
Tel 0117 951 1375 Email info@tree-expert.com



TITLE
**Tree Constraints Plan
St Michael's Parish Hall**

SIZE A4	CAGE CODE	DWG NO TP 3039/2306/TCP	REV
SCALE 1:200	8th Aug 2023	SHEET	

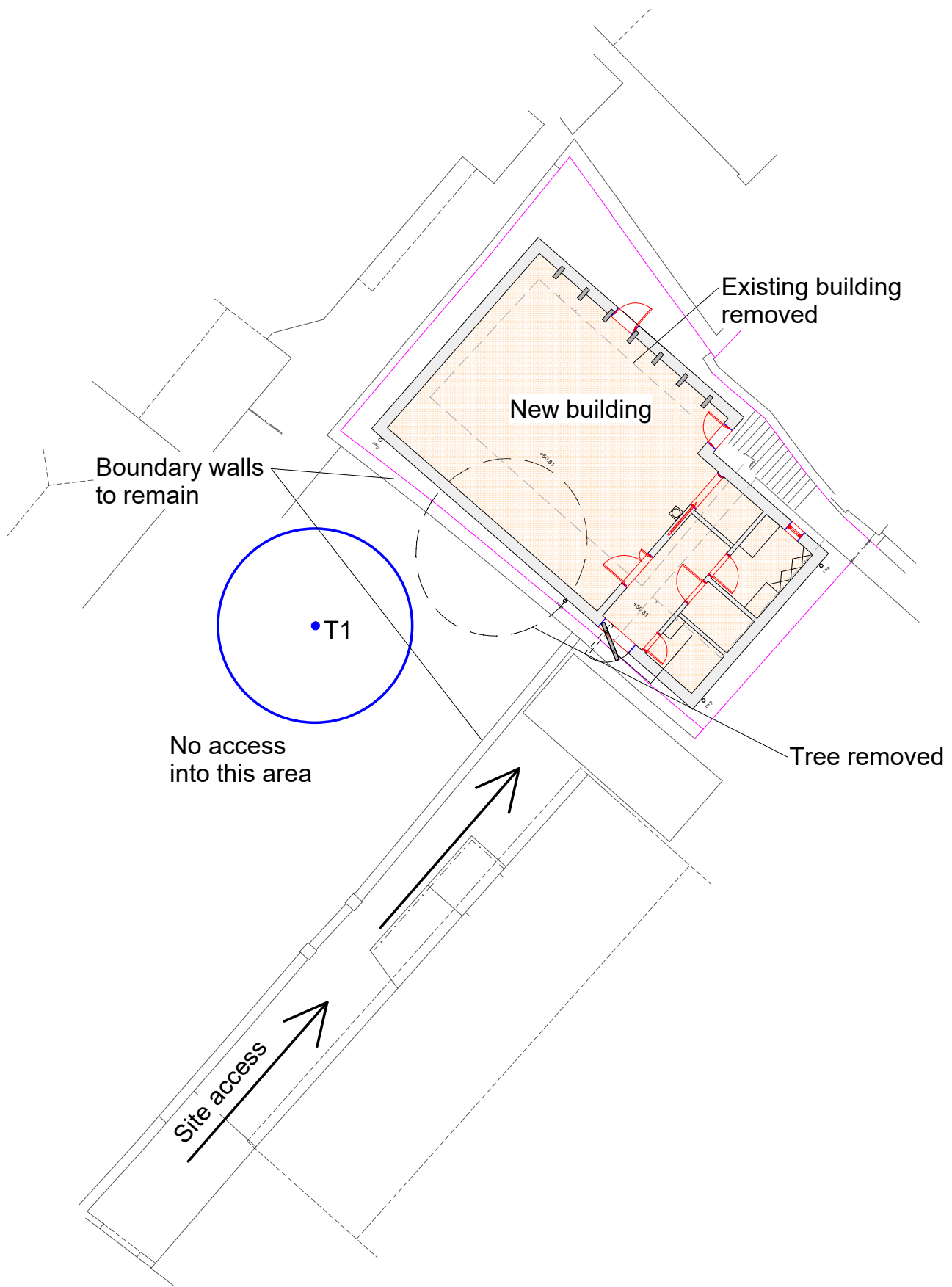

Tim Pursey
 Arboricultural Consultant
 1 Stanley Park, Lower Easton, Bristol BS5 6DT
 Tel 0117 951 1375 Email info@tree-expert.com



TITLE
Tree Protection Plan
St Michael's Parish Hall

SIZE	CAGE CODE	DWG NO	REV
A4		TP 3039/2306/TPP	

SCALE	1:200	8th Aug 2023	SHEET
-------	-------	--------------	-------