

This drawing is solely for the purposes of obtaining planning and building warrant approval. The drawing may be suitable for constructional purposes but it may be necessary to augment/and or amend this information for this purpose. No liability will be accepted for any omission on this drawing should the drawing be used for constructional purposes.

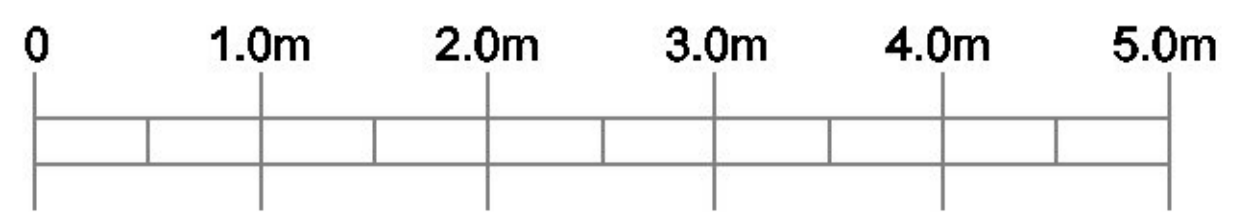

Scale bar

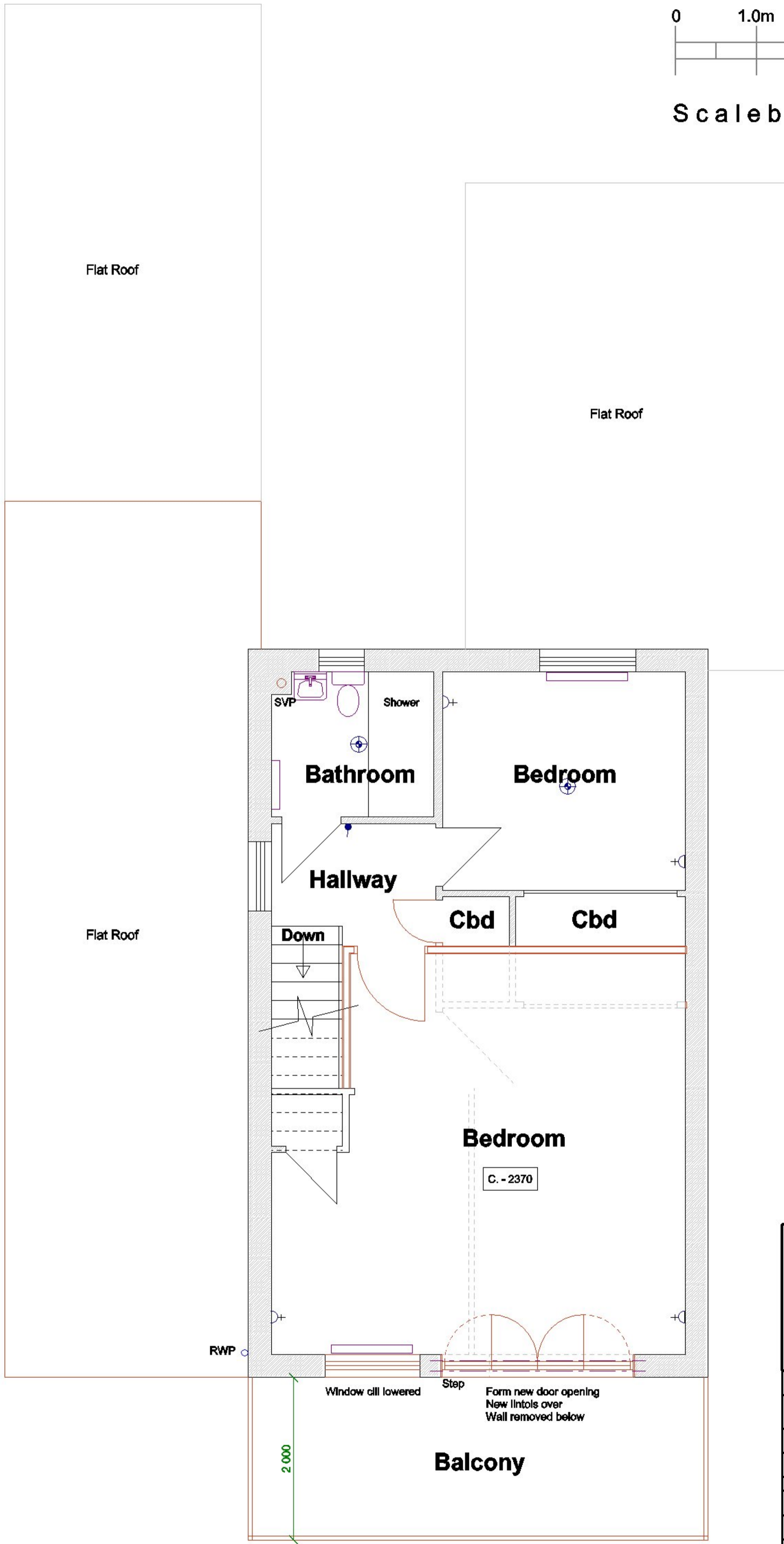

Constructive Architectural Design Ltd.			
Unit 5, Ladykirk Business Park, 9 Skye Road, Prestwick KA9 2TA			
Client	Mr McKeever		
Project	6 Lochview Place, Glasgow. G33 1QB		
Type	PLANNING		
Drawing	Upper Floor Plan as Proposed		
Date	November 2023	Scale	1:50 - A3
Drawn By	SMcCR		
Job Ref.		Drawing No.	
23/1401		- 5	