

PROPOSED GROUND FLOOR

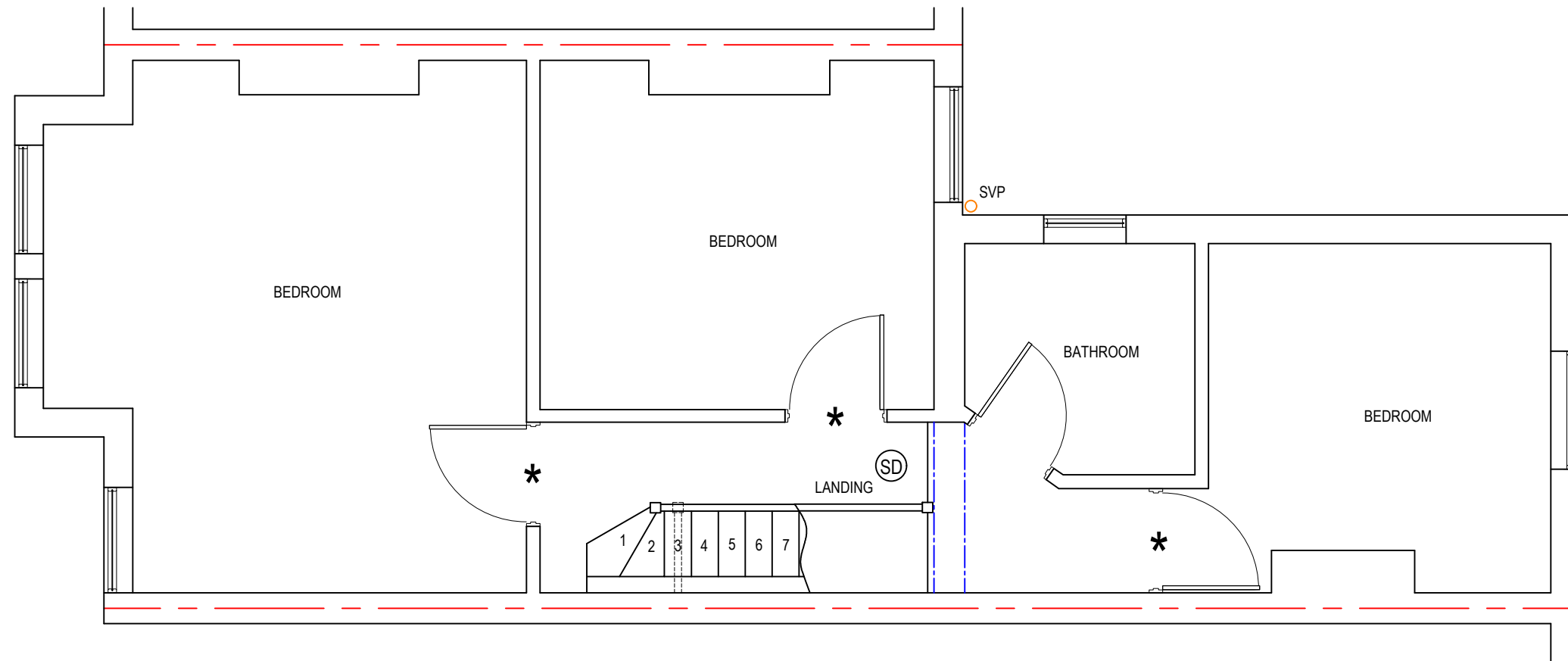

PROPOSED FIRST FLOOR

ESCAPE WINDOW TO HAVE AN UNOBSTRUCTED OPENABLE AREA THAT IS AT LEAST 450MM HIGH AND 450MM WIDE TO PROVIDE A MINIMUM OPENING OF 0.33M², THE BOTTOM OF THE OPENABLE AREA SHOULD NOT BE MORE THAN 1100MM ABOVE THE FLOOR.

EXISTING JOISTS AND TRIMMERS TO FIRST FLOOR TO BE VERIFIED ON SITE FOR ADEQUACY TO CARRY ADDITIONAL LOADS. ESCAPE ROUTE AND CIRCULATION AREAS (INCLUDING STAIRCASES) TO BE CONSTRUCTED TO AT LEAST ½ HOUR FIRE RESISTANCE. WALLS TO BE SOLID OR IF STUDWORK, 2 LAYERS OF 12.5MM PLASTERBOARD TO BE PROVIDED OR VERIFIED ON SITE. LANDING TO BE OVERLAID WITH HARDBOARD IF NECESSARY. ANY GLAZING TO BE ½ HOUR FIRE RESISTANT.

EXISTING HEATING SYSTEM TO BE EXTENDED INTO LOFT. RADIATORS TO BE FITTED WITH THERMOSTATIC RELEASE VALVES.



12 Swift Avenue, Finberry,
Ashford, Kent, TN25 7GD.
07872 995076.
theloftdesignstudio@outlook.com

Name:

Address:
22 PELHAM ROAD, BECKENHAM, BR3 4SG.

Project: LOFT CONVERSION WITH REAR DORMERS AND VELUX WINDOWS TO FRONT ELEVATION

Date:
29/12/23

Drawn By:
MB

Plan No:
1618/6

