

KEY

- Heat Detector (HD)
- Smoke Detector (SD)
- Emergency Light [EMR-L]
- Alarm Sounder (H)
- Extractor Fan ▶
- Illuminated Directional Exit Sign [EXIT] →
- Vision Panel VP
- 1/2 hr Fire Door Self Closer FD30s

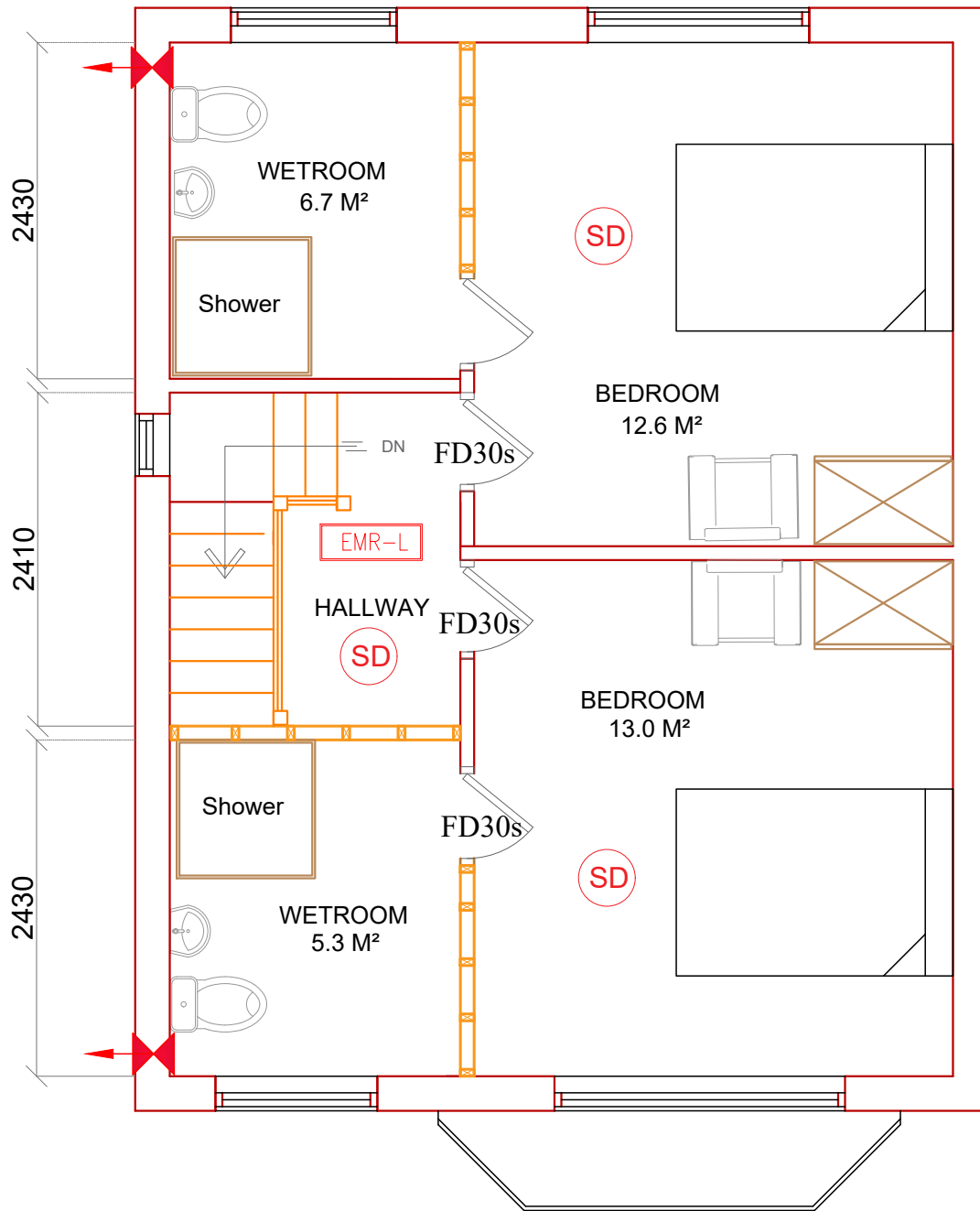

PROPOSED 1ST. FLOOR PLAN

ELECTRICAL: All electrical work require to meet the requirement of part P(Electrical Safety) must be designed, installed, inspected and tested by a person competent to do so. The test certificate should be provided(in accordance with BS 7671) to Local Authority.

Smoke detectors to ground floor and 1st. floor to be interlinked, mains operated with battery backup, to be installed to the IEE Regulations and to BS5839. Provide heat dectors to kitchen area.

Emergency lighting and exist signage to BS 5266.

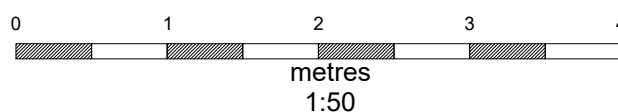

Rev	Date	By	Description
<input type="checkbox"/> FOR COMMENT <input type="checkbox"/> FOR PLANNING PERMISSION <input type="checkbox"/> FOR BUILDING REGULATIONS			<div style="text-align: center;"> <p>Malik Enterprises Architectural Service</p> <p>30 Carlton Drive, Wigston, Leicestershire UK LE18 1DF M: 07808 266330 E: tanvir@malikenterprises.co.uk</p> </div>
PROJECT: Change of use from C3 to C2 Care Home.			
LOCATION: 62 Station Road, Oadby. LE18 2DJ			
CLIENT: Mrs Shahina Vali.			
TITLE: Proposed 1st.Floor Plan			
DATE: Nov. 2023			DRAWN: MTM
DRAWING No: ME11723- 05			SCALE: 1:50