

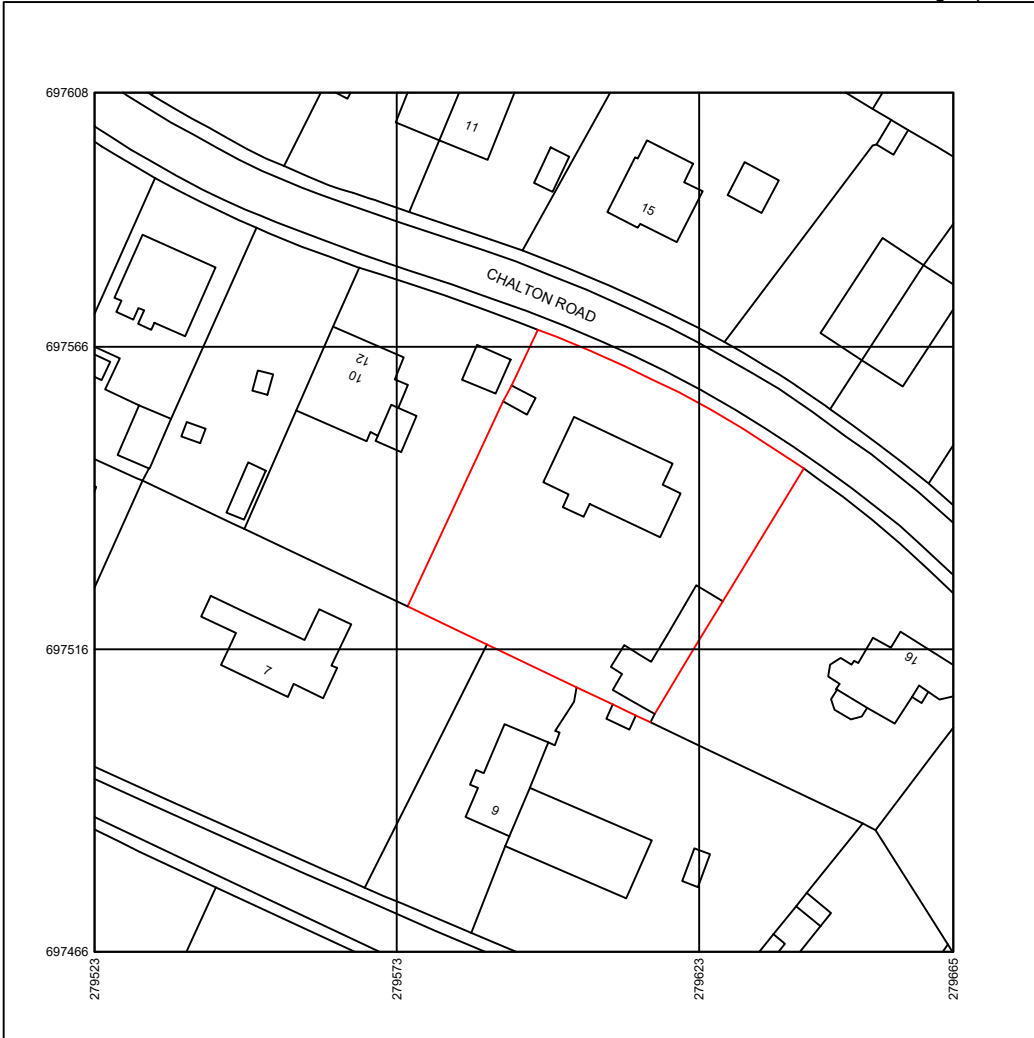

**UK
Planning
Maps**

01856 898 022
www.UKPlanningMaps.com



Produced on 07 December 2023 from the Ordnance Survey National Geographic Database and incorporating surveyed revision available at this date.
This map shows the area bounded by 279523 697466, 279665 697466, 279665 697608, 279523 697608, 279523 697466
Crown copyright and database rights 2023 OS 100054135. Supplied by copla ltd trading as UKPlanningMaps.com a licensed Ordnance Survey partner (OS 100054135).
Data licence expires 07 December 2024. Unique plan reference: v2e/1035036/1395165



MRS E PATTERSON

**PROPOSED
REPLACEMENT DOUBLE GLAZED WINDOWS
ROOFLIGHTS AND BI-FOLD DOORS,
AT 14 CHALTON ROAD,
BRIDGE OF ALLAN,
STIRLING,
LOCATION PLAN**

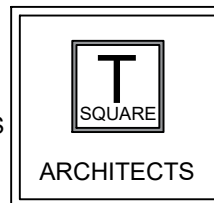

Architecture - Design - Planning

39 Allanvale Road
Bridge of Allan
Stirling
FK9 4PA

Mob: 07596906412

E-mail: daire.gibbons@tsquare-architects.co.uk Web: www.tsquare-architects.co.uk

scale 1:1250	date 10.12.23	drawn: CG	status: P
proj no. 2023-1041	Dwg no. T-101	REV -	