

DRAINAGE OUTFALL INSET - SCALE 1:1000

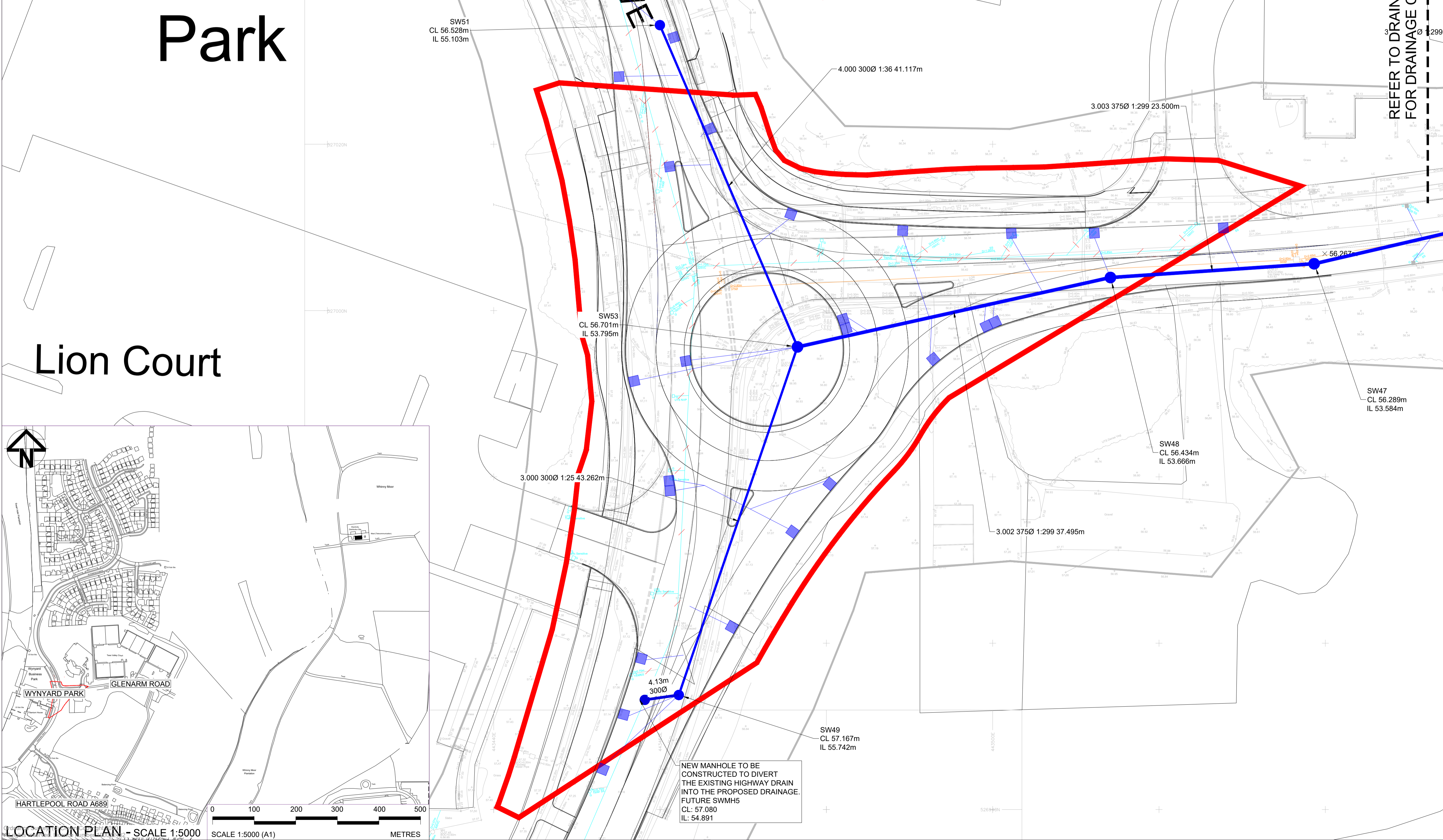

Park

Lion Court

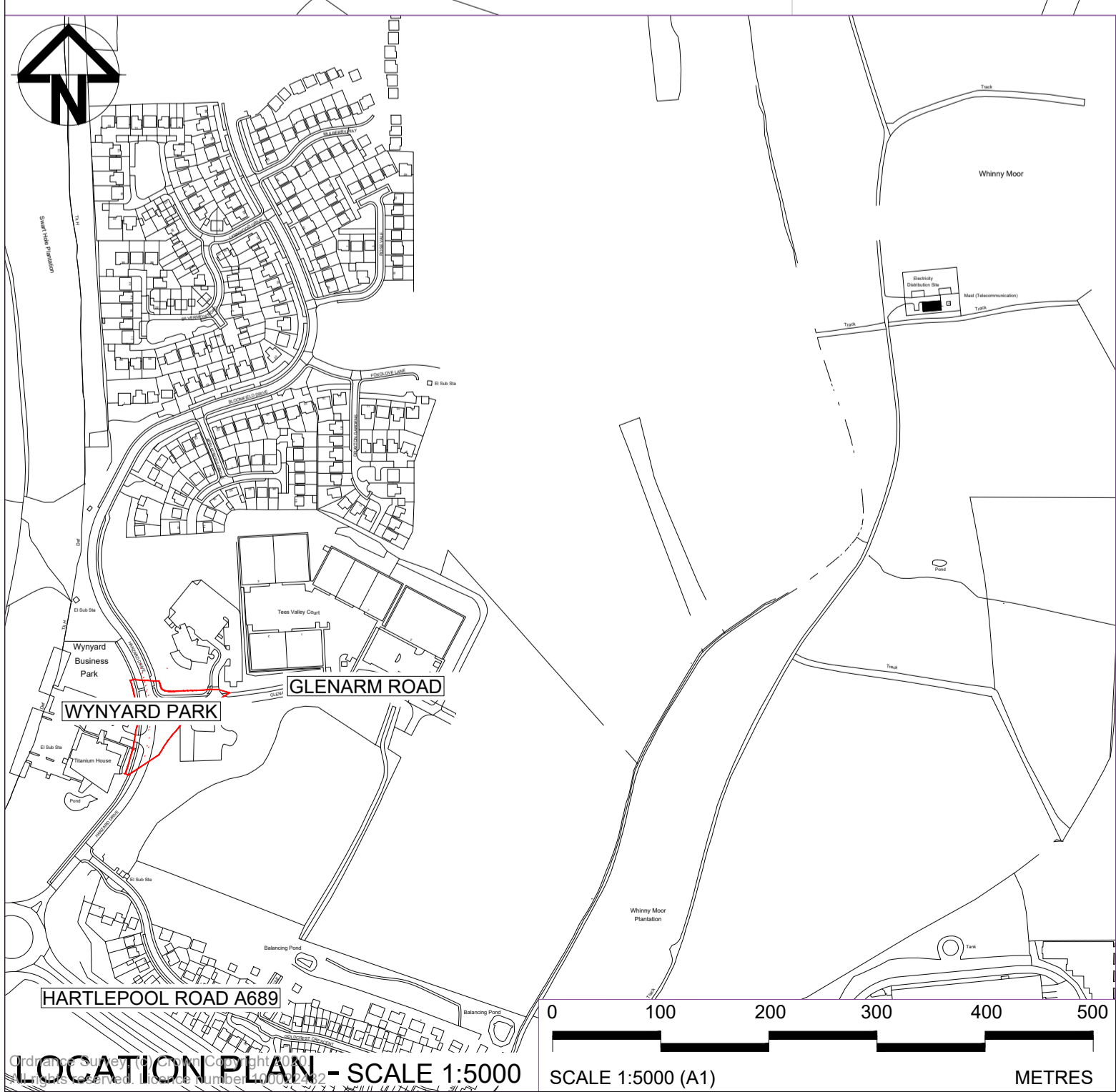

LOCATION PLAN - SCALE 1:5000

SCALE 1:5000 (A1)
100mm on Original

Print Date: 2023-12-08 11:17:03

STO-ARC-XX-XX-DR-CE-0530-01-Drainage Plan Hanzard Drive Rounabout.dwg

- NOTES:
- DO NOT SCALE FROM THIS DRAWING. USE FIGURE DIMENSIONS ONLY.
 - THIS DRAWING IS TO BE READ IN CONJUNCTION WITH ALL RELEVANT ARCHITECTS & ENGINEERS DRAWINGS AND SPECIFICATIONS.

- LEGEND:
- PLANNING BOUNDARY
 - PROPOSED SURFACE WATER MANHOLE
 - PROPOSED SURFACE WATER PIPE
 - PROPOSED GULLY
 - EXISTING SURFACE WATER DRAINAGE
 - EXISTING FOUL WATER DRAINAGE
 - - - REDUNDANT EXISTING DRAINAGE TO BE GROUDED OR REMOVED

REFER TO DRAINAGE OUTFALL INSET FOR DRAINAGE CONTINUATION

Rev	Date	Description	DD	DO	MD
01	17/11/23	FIRST ISSUE			

Client
Amazon UK
Services LTD

PROJECT:
STOCKTON

Site	Client
Chapel Lane North Stockton-on-Tees	Amazon UK Services Ltd

ARCADIS Design & Consultancy
for national and local clients

Registered office:
Arcadis House
34 York Way
London
N1 9AB

Coordinating office:
2 Glass Wharf
Temple Quay
Bristol BS2 0FR
Tel: +44 (0)11 7372 1200

www.arcadis.com

TITLE:

**DRAINAGE PLAN
HANZARD DRIVE ROUNDABOUT**

Designed	D.DOYLE	Signed	Date	22/11/2023
Drawn	D.DOYLE	Signed	Date	22/11/2023
Checked	D.OGDEN	Signed	Date	22/11/2023
Approved	M.DAVIES	Signed	Date	22/11/2023
Scale:	1:250	Datum:	ODN	
Original Size:	A1	Grid:	OS	
Suitability Code:	S2	Project Number:	10042440	

Suitability Description:
PRELIMINARY
NOT TO BE USED FOR CONSTRUCTION

Drawing Number:
STO-ARC-XX-XX-DR-CE-0530

Revision:
01