

## SITE WASTE MANAGEMENT PLAN

THE GREEN HOUSE: 16 – 22 ST THOMAS' ROAD STOPSLEY LU2 7UY



### **andrew hills**

Architect . BSc Dip Arch (Hons) RIBA

20 Trafford Close

Stevenage Herts

07905 320530

cornerstone@ntlworld.com

**PROJ: 145 / DEC 2023**

## INTRODUCTION

The Green House is run by Stopsley Baptist Church for its own activities and as a hub for various community projects, the premises altered to this use around 2000 when the church worship moved to larger, new premises further along St Thomas’ Road. The Green House is set within two buildings, the former SBC chapel, originally built in 1869, rebuilt in 1902 and the Janes Hall added in 1954, both now linked by a main entrance and circulation space constructed in 2002, which also houses a lift and staircase to serve meeting rooms and offices at first floor level in the roof of the former chapel. A third element has been developed more recently in 2019, with the provision of a Community Garden on the east side of the buildings, where church members and local residents tend a managed garden for the use of local community groups and wider residents.

Currently the Janes building is not used pending refurbishment. Previously it was used as a hall in conjunction with the churches requirements. It is now proposed to use it more fluidly with the link to the garden and the Old Chapel uses. This includes opening mornings and afternoons on weekdays and weekends to serve the community as an area for informal meeting of garden users running gardening groups and local parents with children running hobby sessions. In the weekday evenings it would offer additional space to the Old Chapel use for the Greenhouse mentoring 1 to 1 sessions and for community meetings and displays. Approximate numbers and uses are shown on the table below:

Current Use	Time	Numbers						
		M	T	W	T	F	S	S
<b>OLD CHAPEL</b>								
Greenhouse mentoring session	10:00 - 12:00	0	0	0	0	0	20	0
Greenhouse mentoring sessions	18:00 - 21:30	0	20	20	20	0	0	0
Singing - café / tent project	09:30 - 17:00	0	0	0	60	0	0	0
SBC Youth meeting	10:00 - 12:00	0	0	0	0	0	0	30
Office	09:00 - 17:00	5	5	5	5	5	0	0
<b>JANES BUILDING</b>								
Open meeting garden groups	09:00 - 17:00	0	0	0	0	0	0	0
Greenhouse mentoring 1 to 1	18:00 - 21:30	0	0	0	0	0	0	0
Community group use	18:00 - 21:30	0	0	0	0	0	0	0
<b>COMMUNITY GARDEN</b>								
Summer visitors (May - October)	10:00 - 19:00	30	30	30	30	30	30	30
Winter visitors (November - April)	10:00 - 16:00	10	10	10	10	10	10	10

Proposed Use	Time	Anticipated Numbers						
		M	T	W	T	F	S	S
<b>OLD CHAPEL</b>								
Greenhouse mentoring session	10:00 - 12:00	0	0	0	0	0	20	0
Greenhouse mentoring sessions	18:00 - 21:30	0	20	20	20	0	0	0
Singing - café / tent project	09:30 - 17:00	0	0	0	60	0	0	0
SBC Youth meeting	10:00 - 12:00	0	0	0	0	0	0	30
Office	09:00 - 17:00	5	5	5	5	5	0	0
<b>JANES BUILDING</b>								
Open meeting garden groups	09:00 - 17:00	20	20	20	20	20	20	20
Greenhouse mentoring 1 to 1	18:00 - 21:30	0	5	5	5	0	0	0
Community group use	18:00 - 21:30	20	0	0	0	20	20	20
<b>COMMUNITY GARDEN</b>								
Summer visitors (May - October)	10:00 - 19:00	30	30	30	30	30	30	30
Winter visitors (November - April)	10:00 - 16:00	10	10	10	10	10	10	10

Currently refuse collection bins serving the premises are located at the east end of the Janes Hall on a tarmacked area separating the building off from the garden. The refuse collection is arranged and maintained through Luton Borough Council.

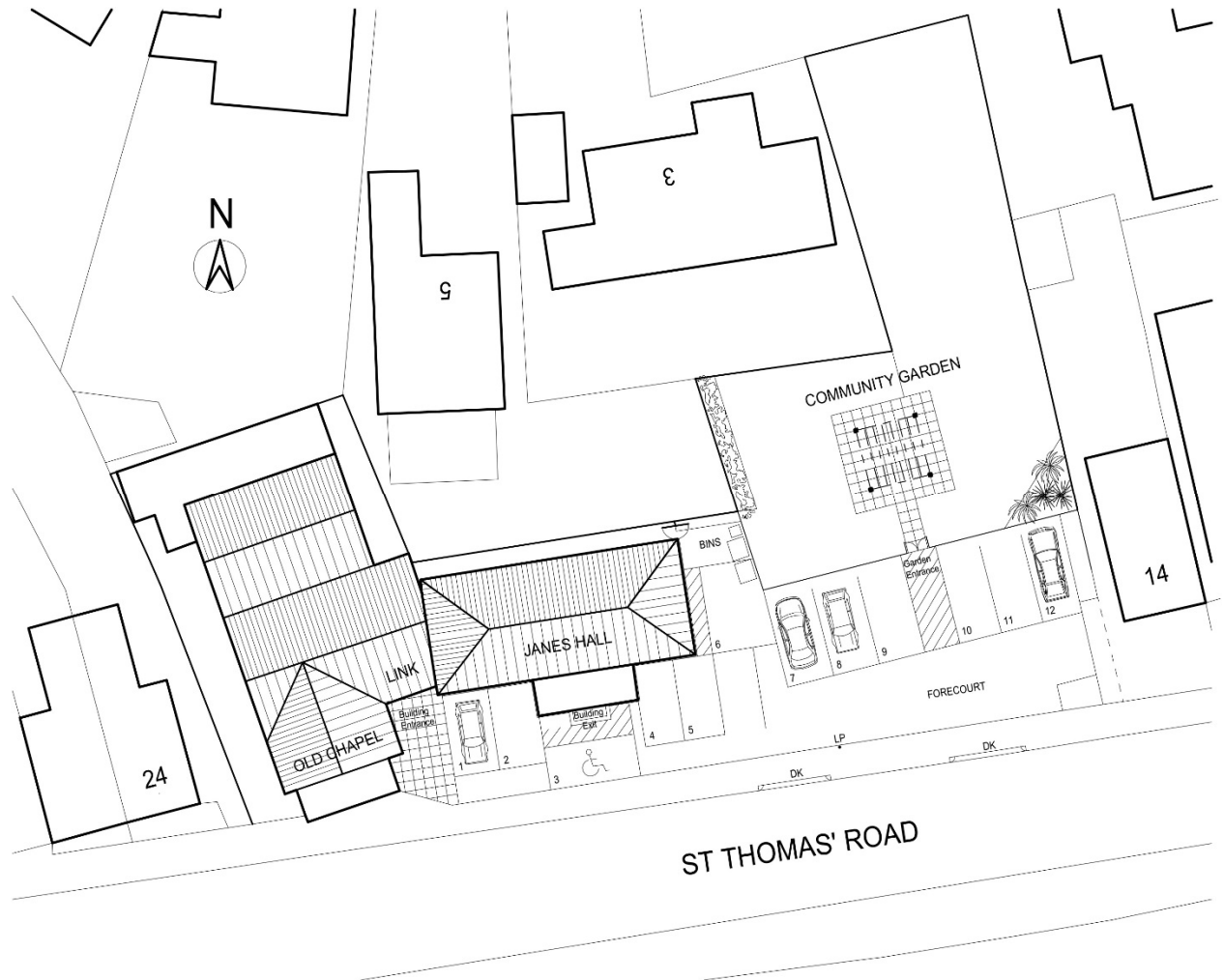

Existing bins stored between Janes Hall building and Community Garden

## PROPOSAL

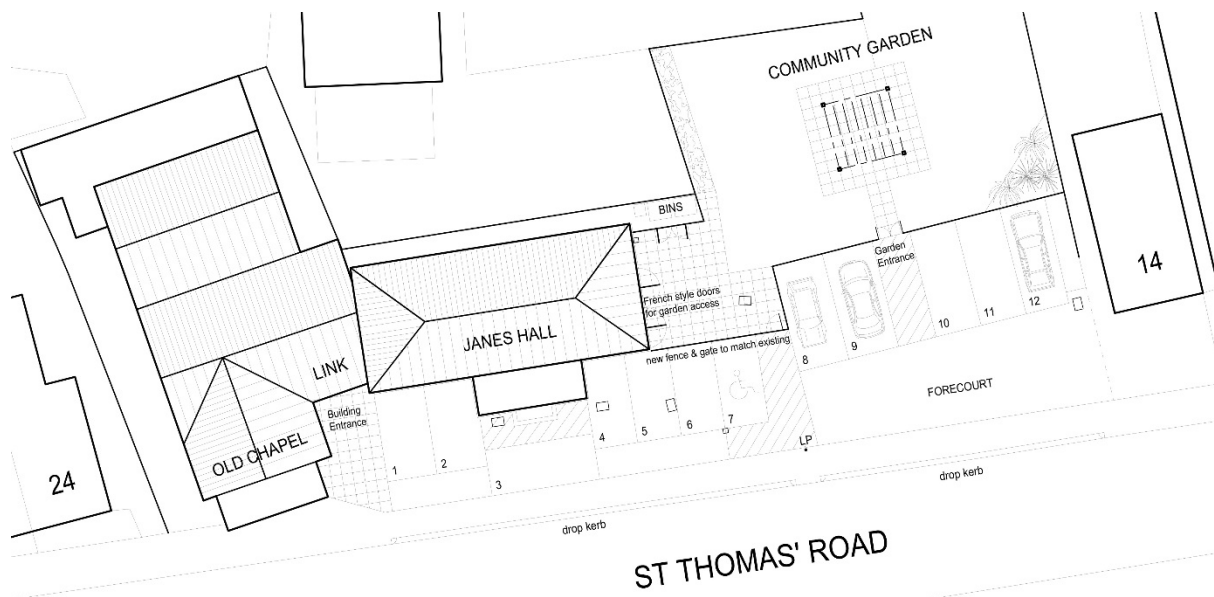

## BLOCK PLAN AS PROPOSED

With the proposal to link the Janes Hall for use with the garden, the bin storage would be relocated in the same area but within a dedicated enclosed and gated space. The new short length of garden fence frontage would be gated to allow easy access to the road side on bin collection days, being no more than 10m away from the road kerb side.

Given the existing use will not change and current bin storage being ample for current use there is not seen any need to change the existing arrangement.