



FENNING'S FARM, PIXEY GREEN, STRADBROKE, SUFFOLK

ARCHAEOLOGICAL EVALUATION



Report Number: 1361

December 2023



FENNINGS FARM, PIXEY GREEN, STRADBROKE, SUFFOLK

**ARCHAEOLOGICAL EVALUATION
REPORT**

Prepared on behalf of:

C E Davidson Ltd

By:

Rory Coduri

Britannia Archaeology Ltd
Unit 2, The Old Wool Warehouse
St Andrews Street South
Bury St Edmunds
Suffolk
IP33 3PH



www.britannia-archaeology.com
Registered in England and Wales: 7874460

Version 1.0



Site Code	WGD 071	NGR	624583/276149
Project No.	P1429	HER Invoice Number	9531063
Planning Ref.	DC/23/01425	OASIS	britanni1-515280
Approved By:		Date	December 2023



DISCLAIMER

The material contained within this report was prepared for an individual client and solely for the benefit of that client and the contents should not be relied upon by any third party. The results and interpretation of the report cannot be considered an absolute representation of the archaeological or any other remains. Britannia Archaeology Ltd will not be held liable for any error of fact resulting in loss or damage, direct, indirect or consequential, through misuse of, or actions based on the material contained within by any third party.

DRAFT



Contents	
DISCLAIMER.....	3
FIGURE LIST	5
Abstract	6
1.0 INTRODUCTION	7
2.0 SITE DESCRIPTION	8
2.1 Site Geology.....	8
3.0 PLANNING POLICIES.....	9
4.0 ARCHAEOLOGICAL BACKGROUND.....	10
4.1 Prehistoric.....	10
4.2 Roman.....	10
4.3 Medieval	10
4.4 Post Medieval/Modern	10
4.5 Undated.....	11
4.6 Archaeological Potential.....	11
5.0 PROJECT AIMS.....	12
6.0 PROJECT OBJECTIVES.....	13
7.0 FIELDWORK METHODOLOGY	14
8.0 DESCRIPTION OF RESULTS.....	15
8.1 Trench 1	15
8.2 Trench 2	15
8.3 Trench 3	15
8.4 Trench 4	15
8.5 Trench 5	15
9.0 DEPOSIT MODEL.....	17
10.0 DISCUSSION AND CONCLUSION.....	18
11.0 ARCHIVE DEPOSITION	19
12.0 ACKNOWLEDGEMENTS	20
BIBLIOGRAPHY	21
APPENDIX 1 – DEPOSIT AND FEATURE TABLES.....	23
APPENDIX 4 – Compliance (Approved Written Scheme of Investigation)	25
3.1 National Planning Policy Framework (NPPF, HMCLG September 2023) .	27
APPENDIX 2 – OASIS SHEET	46



FIGURE LIST

- | | |
|----------|---|
| Figure 1 | General Location Plan |
| Figure 2 | HER Data – Monuments & Events |
| Figure 3 | Trench Plan |
| Figure 4 | Trial Trench 5: Plans, Sections & Photographs |
| Figure 5 | Sample Sections & Photographs |
| Figure 6 | Trench Photographs |
| Figure 7 | Trench Plan over 1893 6" OS |

DRAFT



Abstract

On the 9th October 2023, Britannia Archaeology Ltd (BA) undertook a trial trenching evaluation on behalf of C E Davidson Ltd. The archaeological work was required as a condition of application DC/23/01425, for the construction of a reservoir at Fennings Farm, Pixey Green, Stradbroke, Suffolk.

The site had a low potential for features and finds from all periods.

The evaluation revealed only two features, ditch 1002 and pit 1004. From the lack of archaeological features and material culture, it is likely that the site has always been in the agricultural hinterland of the nearby settlement of Stradbroke.

Overall, the evaluation was successful in characterising the archaeology present at the site.

DRAFT



1.0 INTRODUCTION

On the 9th October 2023, Britannia Archaeology Ltd (BA) undertook a trial trenching evaluation on behalf of C E Davidson Ltd. The archaeological work was required as a condition of application DC/23/01425, for the construction of a reservoir at Fennings Farm, Pixey Green, Stradbroke, Suffolk (TM 24539 76129) (Fig.1).

A design brief issued by Suffolk County Council Archaeological Service (SCCAS) (Baker, M. 19th April 2023) required a programme of linear trial trenching to sample the area threatened by development. This was achieved by excavating 140m trenching which resulted in 4 trenches measuring 30.00m x 1.80m and a single trench measuring 20.00m x 1.80m. The trenches were excavated using a 360° tracked, mechanical excavator fitted with a toothless ditching bucket.

DRAFT



2.0 SITE DESCRIPTION

The site is located some 460m north-west of Fennings Farm, Suffolk, north of the northern-most agricultural buildings within Fennings Farm curtilage and within the south-eastern corner of an agricultural field. Fennings Farm is located some 1.4km south-west of Fressingfield, with Wingfield Hall some 750m to the west of the site. The site is bound on all sides by agricultural fields.

2.1 Site Geology

The bedrock geology is recorded as Crag Group - Sand. Sedimentary bedrock formed between 5.333 million and 11.8 thousand years ago during the Neogene and Quaternary periods, (BGS, 2023).

The superficial deposits are recorded as Lowestoft Formation - Diamicton. A sedimentary superficial deposit formed between 480 and 423 thousand years ago during the Quaternary period., (BGS, 2023).

DRAFT



3.0 PLANNING POLICIES

The archaeological investigation is to be carried out on the recommendation of the local planning authority, following guidance laid down by the National Planning and Policy Framework (NPPF, DCLD 2021). The relevant local development framework is the Mid Suffolk Local Plan (Policy HB14; 1998).

DRAFT



4.0 ARCHAEOLOGICAL BACKGROUND (Figs. 2)

The following archaeological background draws on the Suffolk Historic Environment Record (SHER) (1km search centred on the site), English Heritage PastScape (www.pastscape.org.uk), and the Archaeological Data Service (www.ads.ahds.ac.uk) (ADS) (Fig. 2). The Suffolk HER preferred reference has been provided where possible.

4.1 Prehistoric

A small amount of Neolithic struck flint was recovered during a pipeline construction some 680m to the sites south-east (SBK 020).

4.2 Roman

Some 400m to the north of the site, a Roman pottery scatter was found during unsystematic fieldwalking (SBK 031).

4.3 Medieval

Some 730m to the sites south-east is the location of a medieval green, noted on Hodkinson's Map of 1783 (SBK 064).

Archaeological monitoring during pipeline construction revealed scatters of medieval pottery dating to the 13th/14th centuries some 560m to the south of the site (WGD 016, WGD 018 & WGD 066).

4.4 Post Medieval/Modern

The possible remains of a moat are present within the bounds of Wingfield House, some 710m to the west of the site (WGD 027).



Several 19th century farmsteads are located within the search radius, mainly focused around Pixey Green some 800m to the south of the site (SBK 064, SBK 080, SBK 083 & SBK 084).

4.5 Undated

675m to the sites south-east, two scatters of burnt flint were discovered during the construction of a pipeline (SBK 019 & SBK 020).

4.6 Archaeological Potential

Although the sites topographic location may lend itself to the possibility of archaeological deposits, given the above records the site had a low potential for features and finds relating to all periods.

DRAFT



5.0 PROJECT AIMS

The SCCAS brief (Baker, M. Section 4.2) states that the evaluation should aim to:

Identify the date, approximate form and purpose of any archaeological deposit, together with its likely extent, localised depth and quality of preservation.

Evaluate the likely impact of past land uses, and the possible presence of masking colluvial/alluvial deposits.

Establish the potential for the survival of environmental evidence.

Provide sufficient information to construct an archaeological conservation strategy, dealing with preservation, the recording of archaeological deposits, working practices, timetables and orders of cost.

Both the WSI, fieldwork and resulting report/archiving will be undertaken in accordance with Requirements for Trenched Archaeological Evaluation (SCCAS, 2023), ClfA Standard and Guidance for Archaeological Field Evaluations 2014, and Standards for Field Archaeology in the East of England 2003.

DRAFT



6.0 PROJECT OBJECTIVES

Research objectives for the project are in line with those laid out in Research and Archaeology Revisited: a revised framework for the East of England, East Anglian Archaeology Occasional Paper 24 (Medlycott, 2011).

Particular study of the following should occur:

- presence/absence of palaeosols and old land surface soils/deposits,
- the character of deposits and their contents within negative features
- palaeochannels
- site formation processes generally.

An assessment of the environmental potential of the site through examination of suitable deposits must also be arranged with a suitably qualified specialist. Attention should be paid:

- to the retrieval of charred plant macrofossils and land molluscs from former dry-land palaeosols and cut features, and to soil pollen analysis;
- to the retrieval of plant macrofossils, insect, molluscs and pollen from waterlogged deposits located.
- provision for the absolute dating of critical contacts should be made: eg the basal contacts of peats over former dryland surfaces; distinct landuse or landmark change in urban contexts

The evaluation should also carefully consider the retrieval, characterisation and dating (including absolute dating) of artefact, burial or economic evidence to assist in the characterisation of the site's evidence and in the development of future mitigation strategies.



7.0 FIELDWORK METHODOLOGY

The SCCAS brief required a programme of linear trial trenching to sample the site ahead of the construction of a reservoir. This was achieved by excavating 140m trenching which resulted in 4 trenches measuring 30.00m x 1.80m and a single trench measuring 20.00m x 1.80m within the footprint of the proposed development.

A 360° mechanical excavator fitted with a toothless ditching bucket was used to machine down to the first archaeological horizon, thereafter all excavation work was undertaken by hand (Fig. 3).

The archaeology was recorded using pro-forma record sheets, drawn plans and section drawings and appropriate photographs were taken.

DRAFT



8.0 DESCRIPTION OF RESULTS (Figs. 4 - 7)

A summary of the features and layers encountered is described below. Full context descriptions can be found at Appendix 1.

A professional metal detectorist was used to scan the trench locations prior and post excavation along with the spoil heaps. Only demonstrably modern finds were recovered and therefore were not retained.

8.1 Trench 1

Trench 1 was located in the east portion of the site on a north to south orientation, measuring 30.00m x 1.80m. No archaeological features or finds were present.

8.2 Trench 2

Trench 2 was located in the north portion of the site on an east to west orientation, measuring 30.00m x 1.80m. No archaeological features or finds were present.

8.3 Trench 3

Trench 3 was located in the west portion of the site on a north to south orientation, measuring 30.00m x 1.80m. No archaeological features or finds were present.

8.4 Trench 4

Trench 4 was located in the south-west portion of the site on an east to west orientation, measuring 30.00m x 1.80m. No archaeological features or finds were present.

8.5 Trench 5

Trench 5 was located in the south portion of the site on a north to south orientation, measuring 30.00m x 1.80m. The trench contained two archaeological features, ditch 1002 and pit 1004.



Ditch 1002 (1m x 1.10m x 0.40m) was located mid-trench and was linear in plan, running on an east to west orientation. It had steep sides and a flat base. The ditch contained a single fill, 1003, which was a mid-brownish grey, firm, silty clay with moderate small poorly sorted iron pan. No finds were recovered from the feature.

Pit 1004 (0.50m x 0.50m x 0.08m) was located south end of trench and was circular in plan. It had steep near vertical sides and flat base. The pit contained a single fill, 1005, which was a mid, brownish grey, firm, silty clay. No finds were recovered from the feature.

DRAFT



9.0 DEPOSIT MODEL (Figs. 4 & 5)

The site stratigraphy was consistent across the site. Please see Appendix 1 for detailed context descriptions.

At the top of the sequence was topsoil 1000, a mid- brownish grey, loose, clayey silt. This layer represents the modern plough soil.

Beneath topsoil 1000, and at the base of the stratigraphic sequence was natural geology 1001, a light brownish-orangish yellow, compact, silty-chalky clay.

DRAFT



10.0 DISCUSSION AND CONCLUSION

The site had a low potential for features and finds relating to all periods.

Due to the lack of dating evidence on the site the exact phasing of features cannot be certain. The following discussion should be viewed in the light of these investigative limitations.

The evaluation revealed only two archaeological features, solely in trench 5: ditch 1002 and pit 1004.

Ditch 1002 likely represents a former field boundary. The ditch is not present on the 1893 OS map (Fig.7) and therefore is likely post-medieval/modern in origin.

The positioning and lack of material culture recovered from pit 1004, could suggest that it may also be the result of a more recent modern intrusion.

From the lack of archaeological features and material culture, it is likely that the site has always been in the agricultural hinterland of the nearby settlement of Stradbroke.

Overall, the evaluation was successful in characterising the archaeology at the site.



11.0 ARCHIVE DEPOSITION

The archive will be prepared in line with the standards and guidance in Archaeological Archives in Suffolk: Guidelines for Preparation and Deposition (SCCAS, 2023). Arrangements will be made for the archive to be deposited with Suffolk County Council Archaeological Archives subject to agreement with the legal landowner where finds are concerned. The digital archive will be stored with the Archaeological Data Service (ADS).

DRAFT



12.0 ACKNOWLEDGEMENTS

Britannia Archaeology would like to thank C E Davidson Ltd. for commissioning and funding the project and for their assistance throughout.

We would also like to thank Matthew Baker of Suffolk County Council Archaeological Service for his advice and assistance on the project.

Special thanks to Mr Steve Clarkson for his specialist services in metal detecting on the site.

The on-site project officer was Alice Schute and the site was excavated by Johnathan Grieves, Matthew Selfe, Alice Schute and Mihai Bica of Britannia Archaeology.

DRAFT



BIBLIOGRAPHY

Baker, M. 2023. Brief for a Trenched Archaeological Evaluation at Fennings Farm, Pixey Green, Stradbroke. Suffolk County Council Archaeological Service.

Brown, D.H. 2007. Archaeological Archives. A guide to best practice in creation, compilation, transfer and curation; Archaeological Archives Forum.

Brown, N. And Glazebrook, J. 2000. Research and Archaeology: a Framework for the Eastern Counties, 2. research agenda and strategy; East Anglian Archaeol. Occ. Paper 8.

Chartered Institute for Archaeologists. 2014. Code of Conduct.

Chartered Institute for Archaeologists. December 2014. Standard and Guidance for Archaeological Evaluation.

Chartered Institute for Archaeologists. December 2014. Standard and Guidance for the collection, documentation, conservation and research of archaeological materials.

English Heritage & the Church of England. 2005. Guidance for best practice for treatment of human remains excavated from Christian burial grounds in England'

English Heritage, 2006. Management of Research Projects in the Historic Environment (MoRPHE)

McKinley & Roberts ' Technical Paper 13: Excavation and post-excavation treatment of Cremated and Inhumed Human Remains; Institute for Archaeologists

SCCAS Conservation Team, 2023. Archaeological Archives in Suffolk: Guidelines for Preparation and Deposition.

SCCAS Conservation Team, 2023. Requirements for Trenched Archaeological Evaluation

United Kingdom Institute for Conservation, 1983. Packaging and Storage of Freshly-Excavated Artefacts from Archaeological Sites; Conservation Guidelines No. 2.



Websites:

The British Geological Survey (Natural Environment Research Council) – Geology of Britain Viewer - www.bgs.ac.uk/opengeoscience/home.html?Accordion2=1#maps

English Heritage PastScape www.pastscape.org.uk

Archaeological Data Service (ADS) www.ads.ahds.ac.uk

English Heritage National List for England

www.english-heritage.org.uk/professional/protection/process/national-heritage-list-for-england

DEFRA Magic <http://magic.defra.gov.uk/website/magic>

DRAFT



APPENDIX 1 – DEPOSIT AND FEATURE TABLES

TRENCH 1

Trench No 01	Orientation N-S	Height AOD 48.52m	Shot ID 06
Sample Section No 01	Location Mid Trench	Facing W	
Context No	Depth	Deposit Description	
1000	0.00-0.30m	Topsoil: Mid brownish grey, loose, clayey silt	
1001	0.30m+	Natural: Light brownish-orangish yellow, compact, silty-chalky clay	

TRENCH 2

Trench No 02	Orientation E-W	Height AOD 48.78m	Shot ID 08
Sample Section No 02	Location Mid trench	Facing N	
Context No	Depth	Deposit Description	
1000	0.00-0.36m	Topsoil: Mid brownish grey, loose, clayey silt	
1001	0.36m+	Natural: Light brownish-orangish yellow, compact, silty-chalky clay	

TRENCH 3

Trench No 03	Orientation N-S	Height AOD 49.27m	Shot ID 10
Sample Section No 03	Location Mid Trench	Facing W	
Context No	Depth	Deposit Description	
1000	0.00-0.31m	Topsoil: Mid brownish grey, loose, clayey silt	
1001	0.31m+	Natural: Light brownish-orangish yellow, compact, silty-chalky clay	

TRENCH 4

Trench No 04	Orientation E-W	Height AOD 49.51m	Shot ID 12
Sample Section No 04	Location Mid Trench	Facing N	
Context No	Depth	Deposit Description	
1000	0.00-0.34m	Topsoil: Mid brownish grey, loose, clayey silt	
1001	0.34m+	Natural: Light brownish-orangish yellow, compact, silty-chalky clay	



TRENCH 5

Trench No 05	Orientation N-S	Height AOD 49.22m	Shot ID 04
Sample Section No 05	Location Mid trench	Facing E	
Context No	Depth	Deposit Description	
1000	0.00-0.35m	Topsoil: Mid brownish grey, loose, clayey silt	
1001	0.35-0.40m+	Natural: Light brownish-orangish yellow, compact, silty-chalky clay	

Context Descriptions

Feature Context	Feature Type & Description (m)	Layer/Fill Context	Layer/Fill Description
1002	Ditch (1.80m x 1.10m x 0.40m) Linear in plan with steep sides and flat base	1003	Mid brownish grey, firm, silty clay with moderate small poorly sorted iron pan
1004	Pit (0.50 X 0.50m x 0.08m) Circular in plan with steep near vertical sides and flat base	1005	Mid brownish grey, firm, silty clay



APPENDIX 4 – Compliance (Approved Written Scheme of Investigation)

1.0 INTRODUCTION

This Written Scheme of Investigation (WSI) has been prepared by Britannia Archaeology Ltd (BA) on behalf of C E Davidson Ltd. The archaeological work is required as a condition of application DC/23/01425, for the construction of a reservoir at Fennings Farm, Pixey Green, Stradbroke, Suffolk (624583/276149) (Fig. 1).

This WSI presents a programme of archaeological investigation by means of an archaeological trial trench evaluation to assess the nature and potential of the site, and to determine the need for any future site investigations. A design brief issued by Suffolk County Council Archaeological Service (SCCAS) (Baker, M. 19th April 2023) requires a programme of linear trial trenching to sample the area threatened by development. This will be achieved by excavating 140m of 1.80m trenching as recommended by SCCAS (Baker, M. 19th April 2023): 4 trenches measuring 30.00m x 1.80m and a single trench measuring 20.00m x 1.80m with a contingency of trench extension should this be required. The trenches will be excavated using a 360o tracked, mechanical excavator fitted with a toothless ditching bucket.

This document represents a Written Scheme of Investigation (WSI) for the archaeological evaluation ONLY; this document alone will NOT result in the discharge of the archaeological condition.



2.0 SITE DESCRIPTION (Fig. 1)

The site is located some 460m north-west of Fennings Farm, Suffolk, north of the northern-most agricultural buildings within Fennings Farm curtilage and within the south-eastern corner of an agricultural field. Fennings Farm is located some 1.4km south-west of Fressingfield, with Wingfield Hall some 750m to the west of the site. The site is bound on all sides by agricultural fields.

2.1 Site Geology

The bedrock geology is recorded as Crag Group - Sand. Sedimentary bedrock formed between 5.333 million and 11.8 thousand years ago during the Neogene and Quaternary periods, (BGS, 2023).

The superficial deposits are recorded as Lowestoft Formation - Diamicton. A sedimentary superficial deposit formed between 480 and 423 thousand years ago during the Quaternary period., (BGS, 2023).



3.0 PLANNING POLICIES

The archaeological investigation is to be carried out on the recommendation of the local planning authority, following guidance laid down by the National Planning and Policy Framework (NPPF, HMCLG September 2023). The relevant local development framework is the Mid Suffolk Local Plan (Policy HB14; 1998).

3.1 National Planning Policy Framework (NPPF, HMCLG September 2023)

The NPPF recognises that 'heritage assets' are an irreplaceable resource and planning authorities should conserve them in a manner appropriate to their significance when considering development. It requires developers to record and advance understanding of the significance of any heritage assets to be lost (wholly or in part) in a manner proportionate to their importance and the impact, and to make this evidence (and any archive generated) publicly accessible, (NPPF, 2023 - 205).

The key areas for consideration are:

190.

- The desirability of sustaining and enhancing the significance of heritage assets, and putting them to viable uses consistent with their conservation;
- The wider social, cultural, economic and environmental benefits that conservation of the historic environment can bring;
- The desirability of new development making a positive contribution to local character and distinctiveness; and
- Opportunities to draw on the contribution made by the historic environment to the character of a place.

The NPPF asks that in determining planning applications the local planning authorities should take account of:

197.

- The desirability of sustaining and enhancing the significance of heritage assets and putting them to viable uses consistent with their conservation.



The positive contribution that conservation of heritage assets can make to sustainable communities including their economic vitality; and

The desirability of new development making a positive contribution to local character and distinctiveness.

3.2 Mid Suffolk Local Plan (Policy HB14; 1998)

Policy HB14

Where there is an overriding case for preservation, planning permission for development that would affect an archaeological site or its setting will be refused.

Having taken archaeological advice, the district planning authority may decide that development can take place subject to either satisfactory measures to preserve the archaeological remains in situ or for the site to be excavated and the findings recorded. In appropriate cases the district planning authority will expect a legally binding agreement to be concluded or will impose a planning condition requiring the developer to make appropriate and satisfactory provision for the excavation and recording of the archaeological remains.



4.0 ARCHAEOLOGICAL BACKGROUND (Fig. 2)

The following archaeological background draws on the Suffolk Historic Environment Record (SHER) (1km search centred on the site), English Heritage PastScape (www.pastscape.org.uk), and the Archaeological Data Service (www.ads.ahds.ac.uk) (ADS) (Fig. 2). The Suffolk HER preferred reference has been provided where possible.

4.1 Prehistoric

A small amount of Neolithic struck flint was recovered during a pipeline construction some 680m to the sites south-east (SBK 020).

4.2 Roman

Some 400m to the north of the site, a Roman pottery scatter was found during unsystematic fieldwalking (SBK 031).

4.3 Medieval

Some 730m to the sites south-east is the location of a medieval green, noted on Hodkinson's Map of 1783 (SBK 064).

Archaeological monitoring during pipeline construction revealed scatters of medieval pottery dating to the 13th/14th centuries some 560m to the south of the site (WGD 016, WGD 018 & WGD 066).

4.4 Post Medieval/Modern

The possible remains of a moat are present within the bounds of Wingfield House, some 710m to the west of the site (WGD 027).

Several 19th century farmsteads are located within the search radius, mainly focused around Pixey Green some 800m to the south of the site (SBK 064, SBK 080, SBK 083 & SBK 084).



4.5 Undated

675m to the sites south-east, two scatters of burnt flint were discovered during the construction of a pipeline (SBK 019 & SBK 020).

4.6 Archaeological Potential

Although the sites topographic location may lend itself to the possibility of archaeological deposits, given the above records the site has a low potential for features and finds relating to all periods.

DRAFT



5.0 PROJECT AIMS

The SCCAS brief (Baker, M. Section 4.2) states that the evaluation should aim to:

Identify the date, approximate form and purpose of any archaeological deposit, together with its likely extent, localised depth and quality of preservation.

Evaluate the likely impact of past land uses, and the possible presence of masking colluvial/alluvial deposits.

Establish the potential for the survival of environmental evidence.

Provide sufficient information to construct an archaeological conservation strategy, dealing with preservation, the recording of archaeological deposits, working practices, timetables and orders of cost.

Both the WSI, fieldwork and resulting report/archiving will be undertaken in accordance with Requirements for Trenched Archaeological Evaluation (SCCAS, 2023), CIfA Standard and Guidance for Archaeological Field Evaluations 2014, and Standards for Field Archaeology in the East of England 2003.



6.0 PROJECT OBJECTIVES

Research objectives for the project are in line with those laid out in Research and Archaeology Revisited: a revised framework for the East of England, East Anglian Archaeology Occasional Paper 24 (Medlycott, 2011).

Particular study of the following should occur:

- presence/absence of palaeosols and old land surface soils/deposits,
- the character of deposits and their contents within negative features
- palaeochannels
- site formation processes generally.

An assessment of the environmental potential of the site through examination of suitable deposits must also be arranged with a suitably qualified specialist. Attention should be paid:

- to the retrieval of charred plant macrofossils and land molluscs from former dry-land palaeosols and cut features, and to soil pollen analysis;
- to the retrieval of plant macrofossils, insect, molluscs and pollen from waterlogged deposits located.
- provision for the absolute dating of critical contacts should be made: eg the basal contacts of peats over former dryland surfaces; distinct landuse or landmark change in urban contexts

The evaluation should also carefully consider the retrieval, characterisation and dating (including absolute dating) of artefact, burial or economic evidence to assist in the characterisation of the site's evidence and in the development of future mitigation strategies.



7.0 FIELDWORK METHODOLOGY

The SCCAS brief requires a programme of linear trial trenching to sample the site ahead of the construction of a reservoir. This will be achieved by excavating 140m of 1.80m trenching as recommended by SCCAS (Baker, M. 19th April 2023): 4 trenches measuring 30.00m x 1.80m and a single trench measuring 20.00m x 1.80m within the footprint of the proposed development, with a contingency of trench extension should this be required.

A 360° mechanical excavator fitted with a toothless ditching bucket will be used to machine down to the first archaeological horizon, thereafter all excavation work will be undertaken by hand (Fig. 3).

The archaeology will be recorded using pro-forma record sheets, drawn plans and section drawings and appropriate photographs will also be taken.

In the event that important archaeological remains or complex/unexpected deposits are identified, a site meeting will be held with the client and the SCCAS planning archaeologist to discuss the significance of the remains and decide on the strategy and scope of further excavation and recording. Provision for a trenching contingency has been made, to enable further clarification of areas of archaeology defined during the evaluation if required. The client is aware of the need for contingency funding to cover additional works if necessary.

7.1 Site Plans

A site location plan based on the current Ordnance Survey 1:25000 map and indicating site north will be prepared. This will be supplemented by a site plan showing the area of investigation in relation to the proposed development.

A pre-excavation base plan accurately plotting all features will be produced using a Real Time Kinetic Global Positioning System (RTK). The final post-excavation plan will be based on this. All drawings will be tied into the Ordnance Survey National Grid.



7.2 Mechanical Excavation

The location of electricity, gas, water, sewage and telephone services in addition to the known gas pipeline will be identified from information supplied by the client or relevant authorities prior to machining. Care will be taken when operating machinery in the vicinity of overhead services. All staff are trained in the use of CAT scanners that will be employed before the bucket breaks the ground.

Overburden and any sterile subsoil layers shall be removed by mechanical excavator using a toothless ditching bucket under the supervision of a professional archaeologist. The exposed archaeological horizon will be cleaned by hand and any archaeological deposits or negative features planned.

No excavators or dumpers will be driven over the excavated surfaces.

The machine operator will have the relevant experience and appropriate documentation; will maintain the appropriate inspection register, Form F91 Part 1, Section C, either on the machine or at the depot. The operator will produce a clean, flat surface at precisely the correct level.

7.3 Hand Excavation

All archaeological features will be excavated by hand, in the appropriate way detailed below, where it is safe to do so.

7.4 Metal Detector

A professional metal detectorist (see specialist list) will scan spoil heaps, exposed surfaces and any features. The finds will be recovered and recorded in the proper way. The machined spoil heaps will also be scanned, however demonstrably modern finds will not be retained. The metal detector will not be set to discriminate against iron.



7.5 Excavation of Stratified Sequences

All archaeological remains will be excavated by phase, from the most recent to the earliest, excluding those of obvious later 20th century origin. The phasing of the features will be distinguished by their stratigraphic relationships, fills and finds.

7.6 Excavation of Buildings

Following assessment of any structural remains encountered, a strategy for recording these will be implemented, and it may be that further mitigation will be required to allow the full recording of these remains. It may also be the case that any remains may best be left in situ. Any excavated building structures and associated features (e.g. stakeholes, postholes, sill-beams, gullies, masonry walls, possible floors) will be excavated in stratigraphic sequence.

7.7 Ditches

Ditch segments will be positioned to provide a total coverage of 20% if possible and to ascertain relationship information and will be a minimum of 1.00m in length (dependant on the total length of ditch visible).

7.8 Discrete Features

All discrete features will be half-sectioned or excavated in quadrants providing for a minimum 50% sample.

7.9 Full Excavation

Industrial remains and intrinsically interesting features e.g. hearths, kilns etc. may merit full excavation in agreement with the SCCAS planning archaeologist.



7.10 Burials

Articulated human remains will usually receive minimal excavation to define the extent and quality of their preservation. However in circumstances of poor preservation or if required to meet the project objectives, human remains may require full excavation. A decision in consultation with the SCCAS planning archaeologist and the relevant specialist will be made on the extent to which human remains are excavated during the trenching. The aim will be to inform the requirements for future treatment during subsequent Phases. Disarticulated human remains will be recorded and retained for assessment.

The coroner and the Ministry of Justice will be informed. Any removal of human remains will be carried out under a licence issued by the Ministry of Justice under section 25 of the Burials Act 1857 and in accordance with Guidance for best practice for treatment of human remains excavated from Christian burial grounds in England' (English Heritage & the Church of England 2005).

7.11 Written Record

All archaeological deposits and artefacts encountered will be fully recorded on pro forma context, finds and sample forms, using a single context recording system.

7.12 Photographic Record

All features and deposits will be photographed in detail and general site and working shoots taken as part of the photographic record. This record will comprise high quality digital photographs saved in RAW/CR2 format and taken on an 11 Mega Pixel, Canon 750, DSLR. The RAW/CR2 files will be converted and stored in uncompressed .tiff at 8 bit. If for any reason acceptable digital photography cannot be undertaken, the primary record will be on 35mm black and white film. All photographs will be listed, indexed and archived.

7.13 Drawn Record

All drawings will be tied into the Ordnance Survey National Grid, plans will be initially hand drawn at a scale of 1:20 and the sections at 1:10 on drafting film (permatrace). The height AOD of all features and principal strata will be written on the appropriate plans and sections.



7.14 Finds and Environmental Remains

All finds recovered from sealed contexts will be retained. A sample of those found in the topsoil and subsoil will be taken to characterise the assemblage. Finds will be identified, by a unique site code and context number.

All finds will be processed according to BA standards and to the ClfA Standard and Guidance for the collection, documentation, conservation and research of archaeological materials, 2014. Important, rare or unusual finds will also be assigned a small finds number and sent away for specialist analysis.

Bulk samples will also be taken for retrieving artefacts and biological remains (for palaeoenvironmental and palaeoeconomic investigations) to be processed and analysed. These samples will be taken from well-stratified datable deposits and specifically targeted areas of interest (e.g. undated sealed primary ditch fills) and will be a minimum of 40 litres where appropriate. The suitability of deposits for analysis will be discussed with Dr Boreham and Dr Zoe Outram where appropriate.

Preserved wood will be sampled for potential dating via dendrochronology and Carbon 14 methods and will be assessed by Dr Roderick Bale (University of Wales Trinity St David). Prior to recovering timbers, suitability for dating will be assessed in conjunction with Dr Bale, SCCAS and Dr Outram where appropriate. The project manager must ensure that the results of palaeoenvironmental investigation, industrial residue assessments/analyses & scientific analyses are included in a full evaluation report and sent to the Historic England Science Advisor.

Each deposit retained will be identified by context and a unique sample or timber number. For a full list of specialists see Appendix 2.

7.15 Artefact Recovery

A programme of bucket sampling will be conducted, whereby 90 litres of spoil will hand sorted for each soil horizon encountered. Bucket sampling points will occur at each end of trench/investigation area: if the trenching length is greater than 30m, an additional sampling point medially within the trench will occur.



7.16 Finds classed as Treasure

It is the responsibility of the project manager for the site, after consultation with the relevant finds specialist, to submit any items falling under the provisions of the Act to the local coroner via the treasure co-ordinator (currently the Portable Antiquities Officer at the British Museum). See below for details of the act:

The Treasure Act

The Treasure Act of 1996 defines objects that qualify as Treasure and includes any metallic object other than coin that is made up of more than 10% gold or silver and is over 300 years old, any group of two or more metallic objects of prehistoric date that come from the same find, coin hoards that have been deliberately hidden, smaller groups of coins, votive or ritual deposits, any object from the same place as Treasure. Objects that are less than 300 years old made mainly of gold or silver, which have been deliberately hidden with the intention of recovery, and whose owners or heirs are unknown would also be classed as Treasure.

Treasure will be immediately reported to the Suffolk Finds Liaison Officer who will in turn inform the coroner within 14 days.

7.17 Remote Monitoring Requirements

Due to the extant Covid-19 pandemic it may be enforced to only allow essential travel and contact with others. Should this occur, SCCAS have put in place requirements to enable the remote monitoring of sites should this be required:

All features present in the trenches, including presumed natural and geological features, are to be investigated as per this WSI.

A GPS trench plan showing what is present in each trench (including context numbers) will be produced.

A written text stating what finds were found (if any) in each context, with provisional dates, will be made available.

Trench shots will be taken from each end of the trench and provided to SCCAS.

Photographs of trench sections (bulk) will also be provided.

Photographs of all features will be provided with context numbers.



A diagram indicating the direction each photograph was taken from including the photograph number will be produced.

Provision will be made for SCCAS to review the remote monitoring documents and for any queries to be resolved.

DRAFT



8.0 PRESENTATION OF RESULTS

A report will be prepared on the conclusion of the evaluation and will be completed 4 weeks after the field work ends (no further work required) or a maximum of 6 months from the end of fieldwork (further fieldwork is required). Resourcing of the post-excavation phase is dependent on findings. Where further publication is required a detailed publication programme will be provided within 4 weeks of completion of fieldwork, and a publication report will be programmed for completion within an acceptable timeframe.

The prepared client/archive report will be commensurate with the results of the fieldwork, and will be consistent with the principles of Management of Research Projects in the Historic Environment (MoRPHE) (Historic England 2015) and contain the following:

Summary. A concise summary of the work undertaken and the results;

Introduction. Introduction to the project including the reasons for work, funding, planning background;

Background. The history, layout and development of the site;

Aims and Objectives;

Methodology. Strategy and technique for site excavation;

Results. Detailed description of findings outlining the nature, location, extent, date of any archaeological material;

Deposit Model. Description of events behind the archaeological stratigraphy and geological deposition;

Specialist Reports. Description of the artefactual and ecofactual remains recovered;



Discussion and Conclusions. A synopsis interpreting the archaeological deposits and artefacts, including details of preservation, impact assessment, wider survival, condition and relative importance of the site and its component parts in local, regional and national context;

Bibliography;

Appendices. Context Descriptions, Finds Concordance, Project Archive Contents and Archive Deposition, HER/OASIS Summary Sheet;

Illustrative material including maps, plans, drawings and photographs.

One hard or digital copy of the report, clearly marked DRAFT, should be prepared and presented to SCCAS within four weeks of the completion of site works unless there are reasonable grounds for more time.

Digital and paper report copies will be supplied to the client and SCCAS (one copy and a .pdf copy). An OASIS entry will be completed and a summary included with the report. A .pdf file of the report will be uploaded to the ADS. A digital vector plan will be included with the report, which will be compatible with ESRI or MapInfo GIS software which will also be made available on request subsequent to the report being issued.

It is understood that, if substantial archaeological remains are recorded during the project, it will be necessary to undertake a full programme of analysis and publication in accordance with the guidelines of MoRPHE. The project report will contain recommendations as to whether this will be appropriate. The archaeological advisory and planning role of Suffolk County Council's Archaeological Service Team will be acknowledged in any report or publication generated by this project.

Provision has been made for a summary in the annual PSIAH roundup if positive results are drawn from the evaluation.



9.0 PROJECT ARCHIVE AND DEPOSITION

A full archive will be prepared for all work undertaken in accordance with guidance from the Selection, Retention and Dispersion of Archaeological Collections, Archaeological Society for Museum Archaeologists, 1993, and in accordance with Archaeological Archives in Suffolk: Guidelines for Preparation and Deposition (SCCAS Conservation Team, 2023).

Arrangements will be made for the archive to be deposited with the appropriate receiving body, under an appropriate accession number and subject to agreement with the legal landowner where finds are concerned.

The archive will be quantified, ordered, indexed, cross-referenced and checked for internal consistency. The material will be catalogued, labelled and packaged for transfer and storage in accordance with the guidelines set out in the United Kingdom Institute for Conservation's Conservation Guidelines No.2 and the Archaeological Archives Forum's Archaeological Archives, A guide to best practice, compilation, transfer and curation (Brown, 2007).

Arrangements for the long term storage and deposition of all artefacts will be agreed with the landowner and SCCAS during the reporting stage. Transfer of title and the transfer of the ownership of the archive to the County Archive Facility will be arranged at this time, and the arrangements indicated in the evaluation report.

Where the project comprises multiple stages, the entire archive will be collated and deposited as a whole.



10.0 HEALTH AND SAFETY

BA operates a comprehensive Health and Safety Policy in accordance with the Health and Safety Executive. This Policy is based on a Health and Safety system in line with the Federation of Archaeological Managers and Employers (FAME) Health and Safety Field Manual, which is regularly updated by supplements.

BA holds employer's liability; public liability and professional indemnity insurance arranged through Towergate Insurance (see Appendix 3).

10.1 Code of Practice, Risk Assessment and Site Induction

BA's Code of Practice covers all aspects of excavation work and ensures all risks are adequately controlled. A site visit will be undertaken and an assessment of the potential risks be highlighted including the potential for toxins and contaminants. It will be the responsibility of the client/agent to undertake a full assessment of any toxins present and services present and provide Britannia Archaeology Ltd with a report detailing the results, prior to the commencement of any fieldwork. A full site risk assessment will be produced using this information and suitable tools and PPE will be provided and used based on the results of any pre-project investigation.

The assessment of risk is an on-going process and this document can be updated if any change in risk occurs on site. A copy of the Risk Assessment is kept on site, read and countersigned by all staff and visitors during the BA site induction.

10.2 COVID-19

Britannia will closely monitor and adhere to the Standard Operational Procedure (SOP) outlined by the Construction Leadership Council and Prospect. A full Covid-19 Risk Assessment will be undertaken and will be available upon request.



11.0 RESOURCES

The archaeological works will be undertaken by a team of professional archaeologists, qualified to undertake this type of work (Appendix 1). Full CV's are available on request.

All site work will be undertaken by a Projects Officer (with a field team if required) in close communication with a Project Manager. This project officer will also be responsible for post-excavation and publication in liaison with the relevant specialists (Appendix 2).

Other specialists may be consulted and will be made known to the SCCAS planning archaeologist for approval prior to their engagement. Any changes to the specialists documented in Appendix 2 will be made known to the SCCAS planning archaeologist immediately.

DRAFT



12.0 TIMETABLE AND PROGRAMME OF WORK

The archaeological evaluation fieldwork is likely to begin in June 2023, pending approval of this Written Scheme of Investigation by SCCAS. It is anticipated that the evaluation will take two days with two members of staff on site to open and record the trenches. Provision has been made for additional contingency days should any unexpected remains be encountered.

The client is aware of the working methods and provision has been made to allow access to undertake trenching as required by the design brief.

The SCCAS Archaeologist will be responsible for monitoring progress and standards throughout the project. The SCCAS archaeologist will be kept updated with developments both on site and in the post excavation process.

Any variations to the WSI will be agreed with the SCCAS Archaeologist prior to work being carried out. The monitoring officer will be kept informed of progress throughout the project. SCCAS will be given a minimum of 10 days written notice of the commencement of work so as to make arrangements for monitoring. The trenches will not be backfilled without the approval of SCCAS. Further trenching or deposit testing may be a requirement of the site monitoring visit if unclear archaeological remains or geomorphological features present difficulties of interpretation, or to assist with the formulation of a mitigation strategy.



APPENDIX 2 – OASIS SHEET

OASIS Summary for britanni-215280

Archives	HER Identifiers	HER Event No - WGD 071
work	Person Responsible for	Dan McConnell
HER	Suffolk HER - unRev - STANDARD	
Funder	Private individual	
Keywords	Rubbish Pit - 20TH CENTURY - FISH Treasures of Monument Types Ditch - 20TH CENTURY - FISH Treasures of Monument Types	
Project Results	<p>Overall, the evaluation was successful in characterising the archaeology present at the site.</p> <p>From the lack of archaeological features and material culture, it is likely that the site has always been in the agricultural hinterland of the nearby settlement of Stradbroke.</p> <p>The evaluation revealed only two features, ditch 1002 and pit 1004.</p> <p>The site had a low potential for features and finds from all periods.</p>	
Project Methodology	<p>An archaeological evaluation comprising 4 x 30.00m x 1.40m and 1 x 20.00m x 1.80m trenches.</p> <p>Parish : Windfield</p> <p>Local Authority District : Mid Suffolk</p> <p>County/Local Authority : Suffolk</p> <p>Country : England</p>	
Administrative Areas	<p>12 EId : 824613,26145 LT : 52.3273666123669, 1.26610168812717 NGR : TM 24613 76145 Fennings Farm, Pixey Green, Stradbroke</p>	
Location	<p>Project Dates</p> <p>09-Oct-2023 - 17-Oct-2023</p> <p>Organisation Responsible for work</p> <p>Britannia Archaeology Ltd</p> <p>Investigation Reason For</p> <p>Planning: Post determination</p> <p>Planning Id</p> <p>DC2301425</p> <p>Activity type</p> <p>Evaluation</p> <p>Project Identifier(s)</p> <p>P1429</p> <p>Sitecode</p> <p>Fennings Farm, Pixey Green, Stradbroke</p> <p>Project Name</p> <p>Evaluation at Fennings Farm, Pixey Green, Stradbroke</p> <p>OASIS ID (UID)</p> <p>britanni-215280</p>	

Report generated on: 12 Jan 2024, 14:54

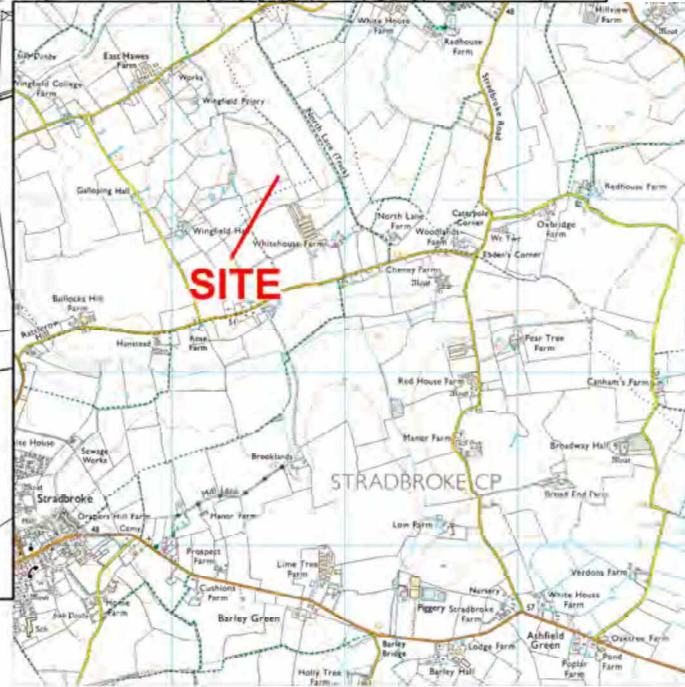
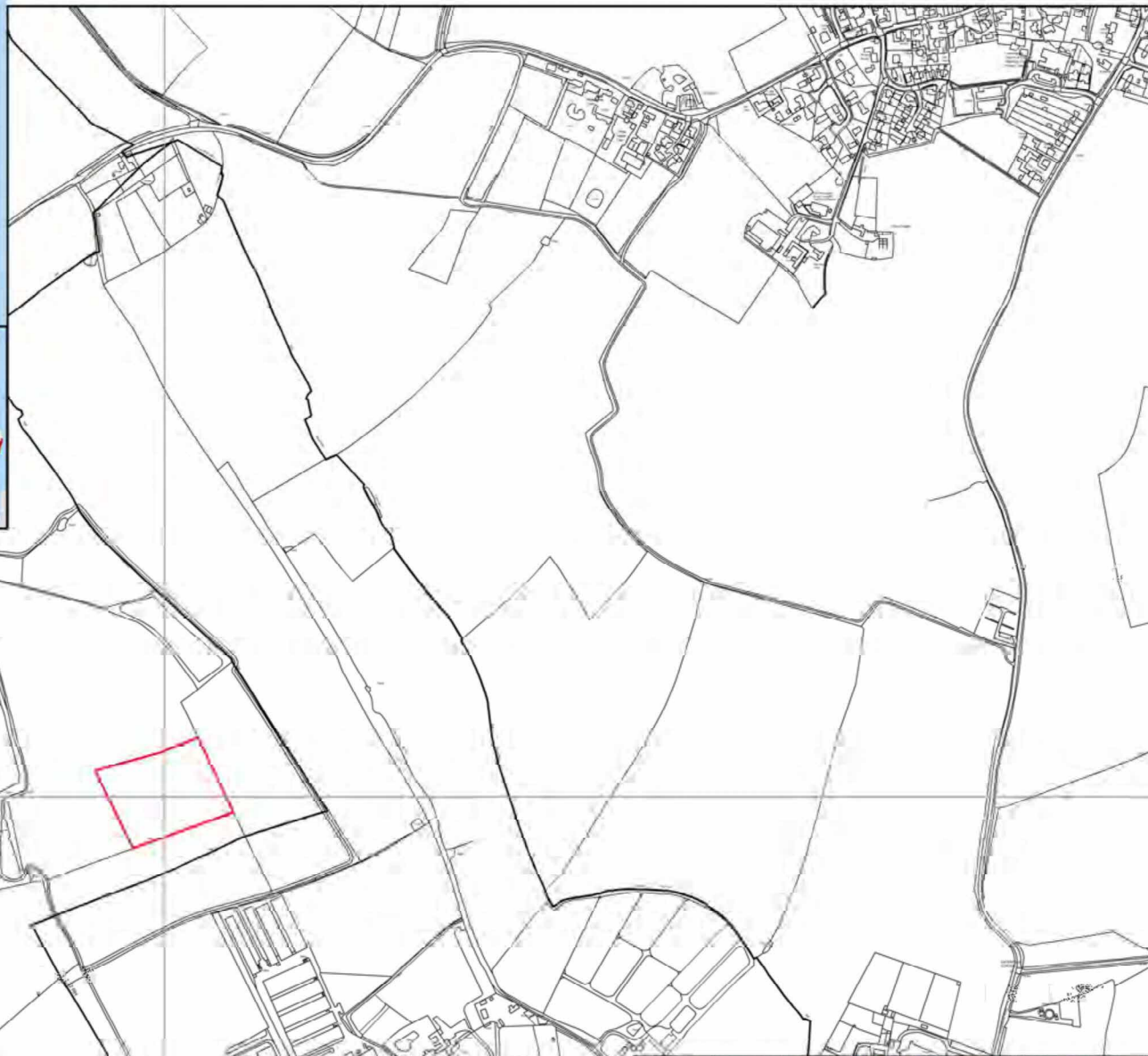

Site Boundary

200000

600000

0 1:10000 500m

Reproduced on plans supplied by Ordnance Survey with the permission of the controller of Her Majesty's Stationery Office. Licence number: 100092663.
© CROWN COPYRIGHT 2024.
Country Map: CC licensed image by Wikipedia user: CC BY-SA 4.0.

OSGR:	624583 276149	REF:	R1361
PROJECT:	FENNINGS FARM, PIXEY GREEN, STRADBROKE		
DESCRIPTION:	GENERAL LOCATION PLAN		
CLIENT:	CE DAVIDSON LTD		
BRITANNIA ARCHAEOLOGY LTD  UNIT 2 THE OLD WOOL WAREHOUSE ST ANDREWS STREET SOUTH BURY ST EDMUNDS SUFFOLK IP33 3PH W: www.britannia-archaeology.com <small>© Copyright Britannia Archaeology Ltd 2024</small>			
DATE:	JAN 2024	PLT:	A3
VERSION:	1		
APPROVED:	DPM	FIGURE:	1
APPROVED:	MB		

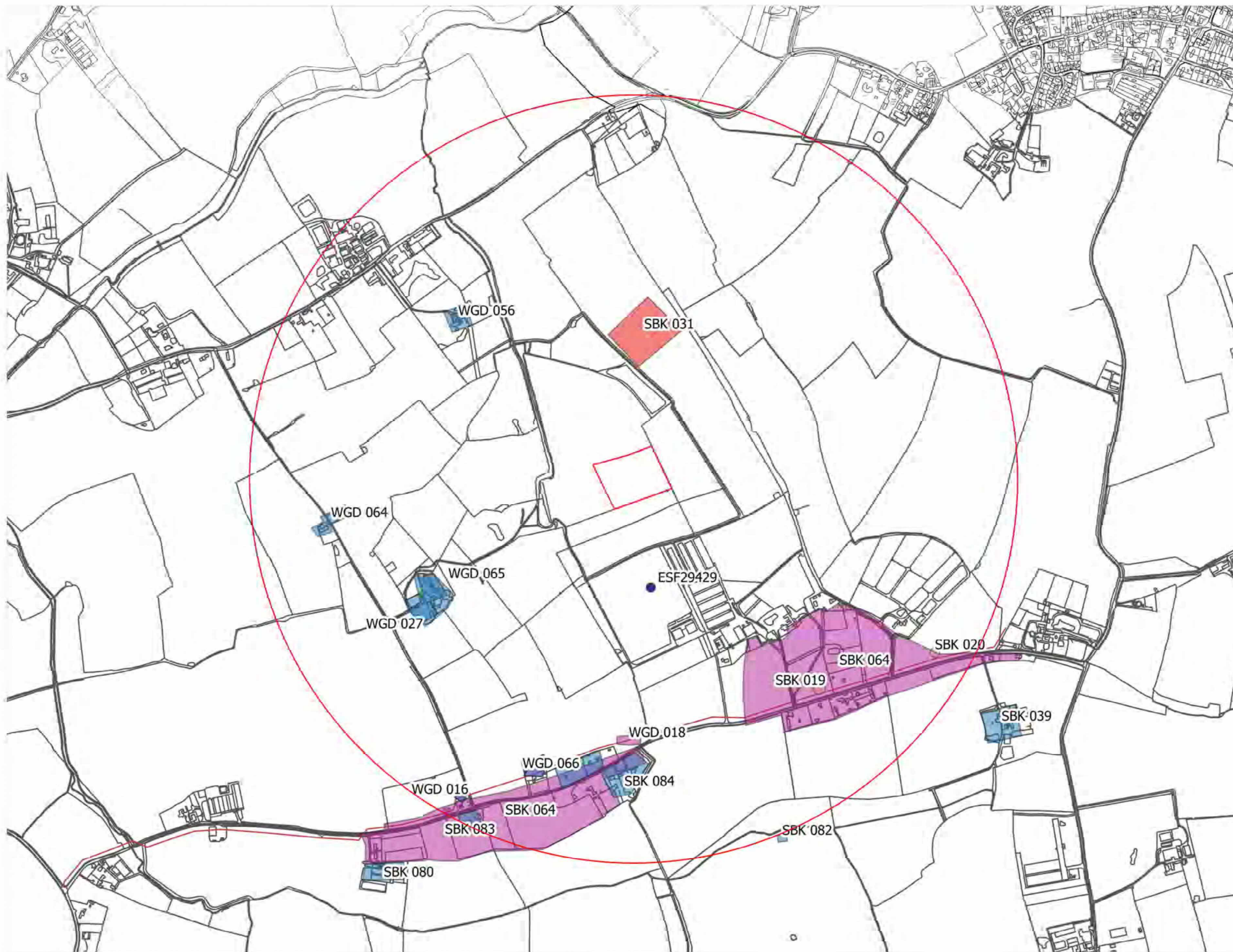

- HER Search Area
- Site Boundary
- Archaeological Event
- Scheduled Monument
- Conservation Area
- Registered Parks & Gardens
- Undated Record
- Multiperiod Record
- Modern Record
- Post-medieval Record
- Medieval Record
- Anglo Saxon Record
- Roman Record
- Iron Age Record
- Bronze Age Record
- Neolithic Record
- Mesolithic Record
- Palaeolithic Record

(OR): 624583 276149	(REF): 81361
PROJECT: FENNINGS FARM, PIXEY GREEN, STRADBROKE	
DESCRIPTION: HER DATA - EVENTS & MONUMENTS	
CLIENT: CE DAVIDSON LTD	
BRITANNIA ARCHAEOLOGY LTD	
 UNIT 2 THE OLD WOOL WAREHOUSE ST ANDREWS STREET SOUTH BURY ST EDMUNDS SUFFOLK IP33 2JH	
W: www.britannia-archaeology.com <small>or enquiries@britannia-archaeology.com</small>	
DATE: JAN 2024	PLAT: A7
RECORD: DPM	VERSION: 1
APPROVED: MB	2

Reproduced on plans supplied by Ordnance Survey with the permission of the controller of Her Majesty's Stationery Office. License number: 100021262.
© Crown Copyright 2004.

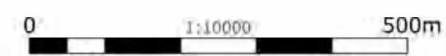

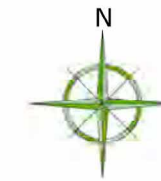

-  Trench
-  Site Boundary
-  Archaeological Features
-  Sample Section

NO:	624583 276149	REF:	R1361
PROJECT:	FENNINGS FARM, PIXEY GREEN, STRADBROWE		
DESCRIPTION:	TRENCH PLAN		
CLIENT:	JF DAVIDSON LTD		
BRITANNIA ARCHAEOLOGY LTD			
		UNIT 6 THE OLD WOOL WAREHOUSE ST ANDREWS STREET SOUTH BURY ST EDMUNDS SUFFOLK IP33 2P4	
W: www.britannia-archaeology.com or Copyright Britannia Archaeology Ltd 2016			
DATE:	JAN 2024	PLT:	A2
VERSION:	1		
REVISION:	DPM		
APPROVED:	MB		
			3

Reproduced on plans supplied by Ordnance Survey with the permission of the Controller of Her Majesty's Stationery Office. Licence number: 10002262.
© CROWN COPYRIGHT 2004.

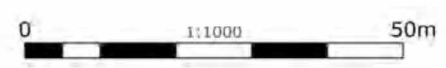

TRIAL TRENCH 5

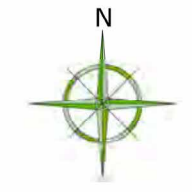
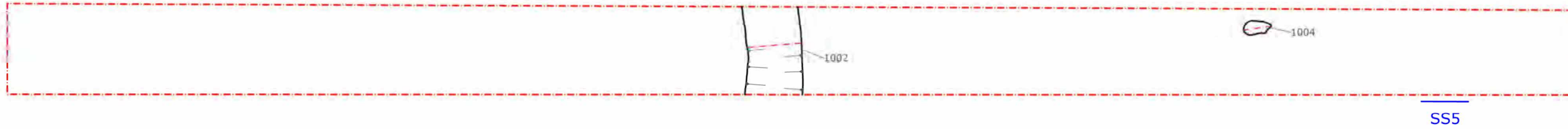

- Trench
- Archaeological Features
- Sample Section

SAMPLE SECTION 5

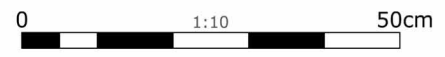
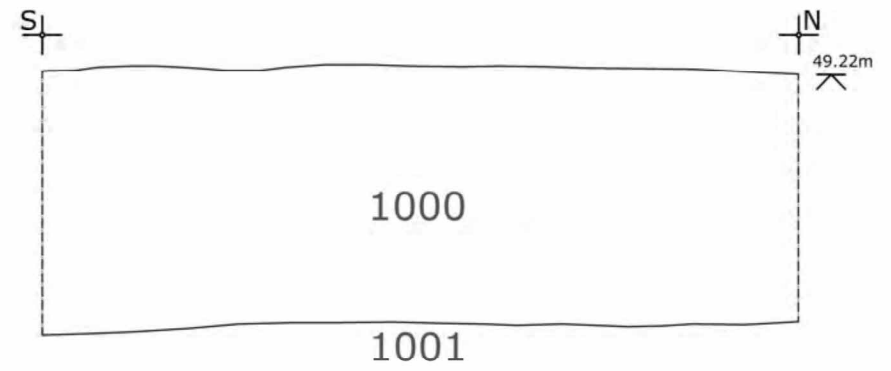

DP4 - SS5 - VIEW SW

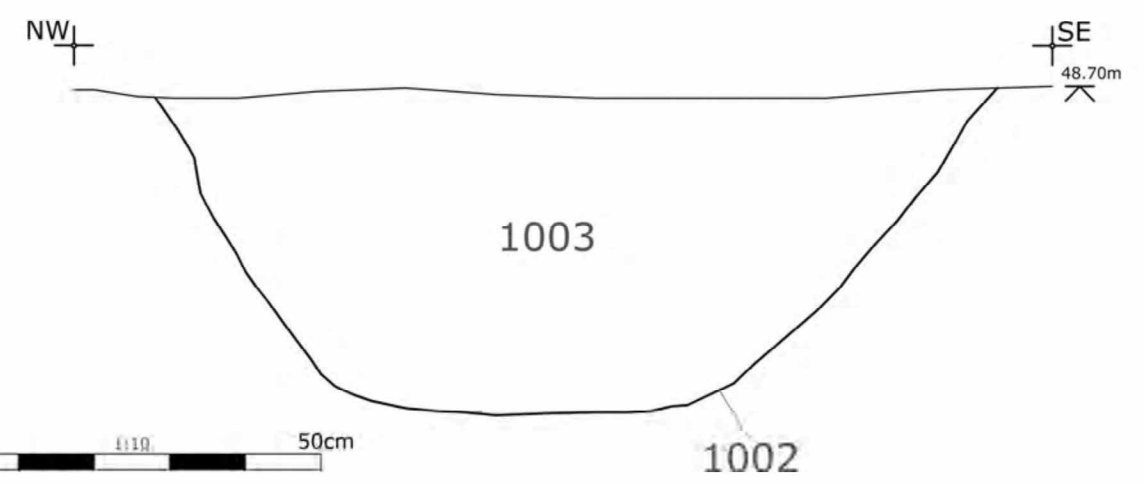

DP2 - DITCH 1002 - VIEW NE

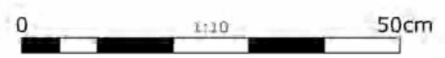

DP1 - PIT 1004 - VIEW NE

WGR:	624583 276149	REF:	R1361
PROJECT:	FENNINGS FARM, PIXEY GREEN, STRADBROKE		
DESCRIPTION:	TRENCH 5: PLANS, SECTIONS & PHOTOGRAPHS		
CLIENT:	CE DAVIDSON LTD		
BRITANNIA ARCHAEOLOGY LTD			
		UNIT 2 THE OLD WOOL WAREHOUSE ST ANDREWS STREET SOUTH BURY ST EDMUNDS SUFFOLK IP33 3PH	
W: www.britannia-archaeology.com © Copyright Britannia Archaeology Ltd 2024			
DATE:	JAN 2024	PLOT:	A3
VERSION:	1		
AUTHOR:	DPM		
APPROVER:	MTB		
FIGURE:	4		

SAMPLE SECTION 1

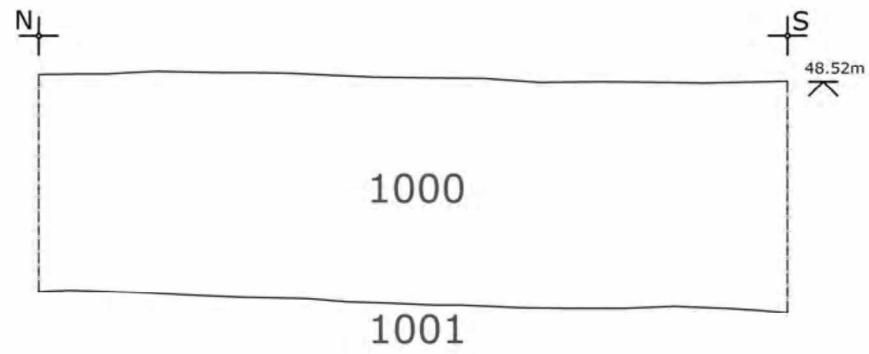

0 1:10 50cm



DP6 - SS1 - VIEW W

SAMPLE SECTION 2

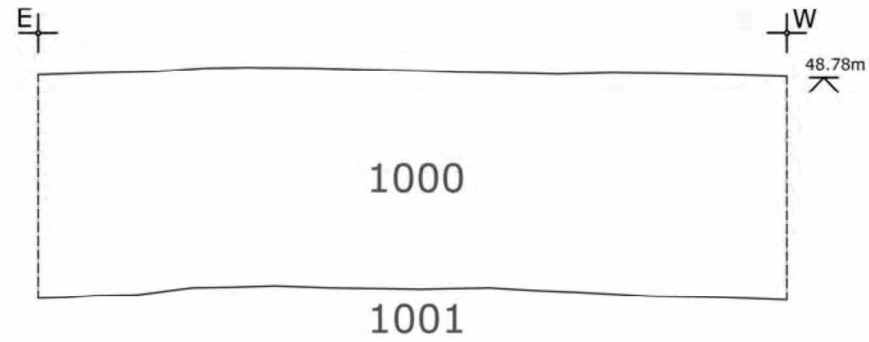

0 1:10 50cm



DP8 - SS2 - VIEW S

SAMPLE SECTION 3

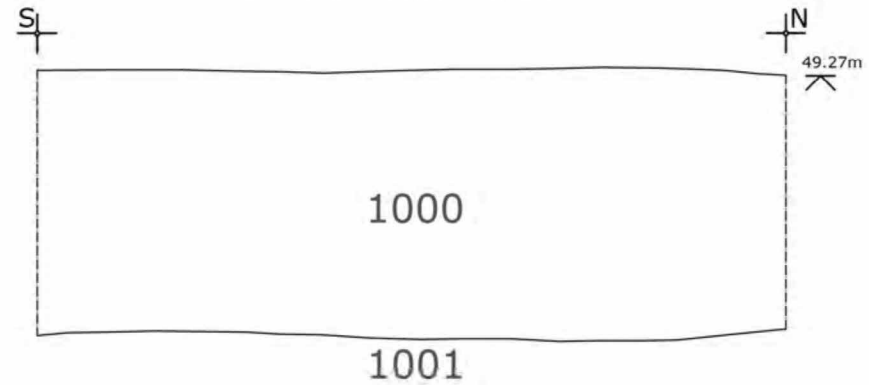

0 1:10 50cm



DP10 - SS3 - VIEW W

SAMPLE SECTION 4

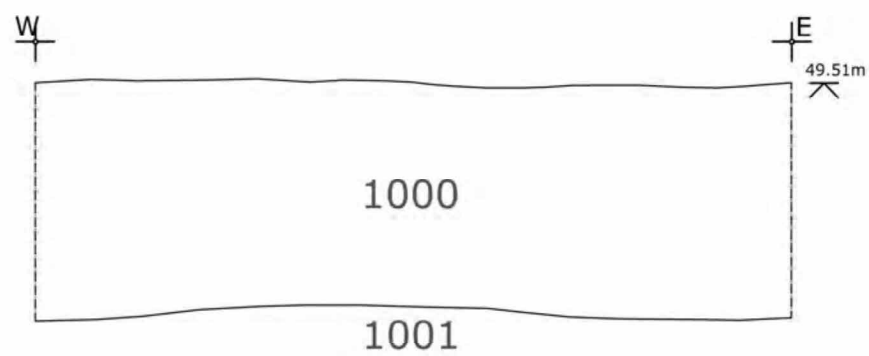

0 1:10 50cm



DP12 - SS4 - VIEW N

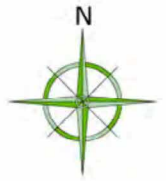

(NGR): 624583 276149 (REF): R1361

PROJECT: PENNING'S FARM, PIXEY GREEN, STRADBOROUGH

DESCRIPTION: SAMPLE SECTIONS & PHOTOGRAPHS

CLIENT: CE DAVIDSON LTD

BRITANNIA ARCHAEOLOGY LTD



UNIT 2
THE OLD WOOL WAREHOUSE
ST ANDREWS STREET SOUTH
BURY ST EDMUNDS
SUFFOLK
IP33 3PH

W: www.britannia-archaeology.com

© Copyright Britannia Archaeology Ltd 2024

DATE: JAN 2024 PLOT: A3 VERSION: 1

APPROVED: DPM

APPROVED: MTB



DP5 - TT1 - VIEW N



DP7 - TT2 - VIEW W



DP9 - TT3 - VIEW N



DP11 - TT4 - VIEW W



DP3 - TT5 - VIEW N



WGR:	624583 276149	REF:	R1361
PROJECT:	FENNINGS FARM, PIXEY GREEN, STRADBROKE		
DESCRIPTION:	TRENCH PHOTOGRAPHS		
CLIENT:	CE DAVIDSON LTD		
BRITANNIA ARCHAEOLOGY LTD			
	UNIT 2 THE OLD WOOL WAREHOUSE ST ANDREWS STREET SOUTH BURY ST EDMUNDS SUFFOLK IP33 3PH		
W: www.britannia-archaeology.com			
© Copyright Britannia Archaeology Ltd 2024			
DATE:	JAN 2024	PLOT:	A3
VERSION:	1		
APPROVED:	DPM	FIGURE:	6
APPROVED:	MB		

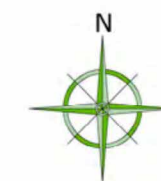
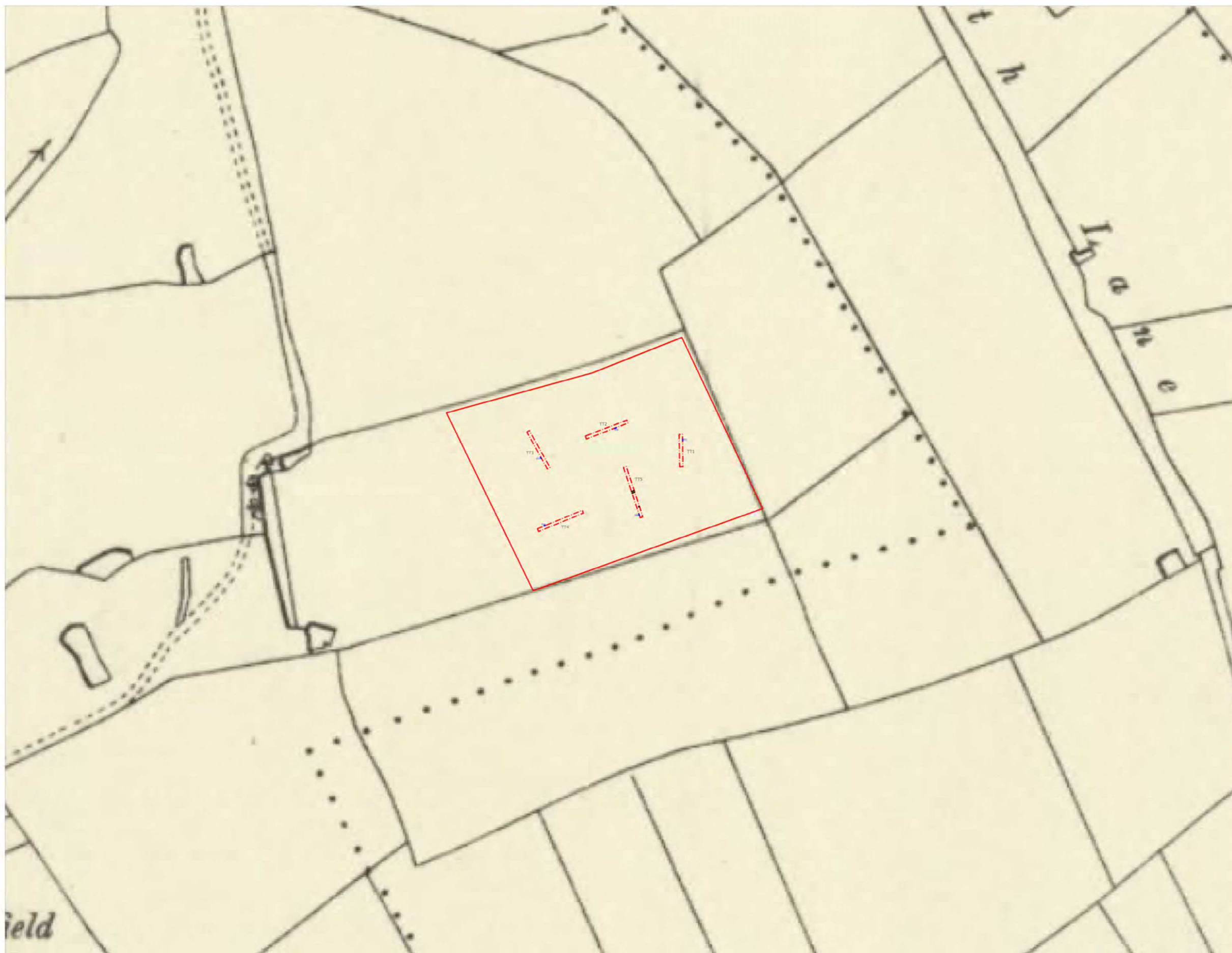

-  Trench
-  Site Boundary
-  Archaeological Features

WGR:	624583 276149	REF:	R1361
PROJECT:	FENNINGS FARM, PIXEY GREEN, STRADBROKE		
DESCRIPTION:	TRENCH PLAN OVER 1893 6" OS MAP		
CLIENT:	CE DAVIDSON LTD		
BRITANNIA ARCHAEOLOGY LTD			
	UNIT 2 THE OLD WOOL WAREHOUSE ST ANDREWS STREET SOUTH BURY ST EDMUNDS SUFFOLK IP33 3PH		
W: www.britannia-archaeology.com <small>© Copyright Britannia Archaeology Ltd 2024</small>			
DATE:	JAN 2024	PLDT:	A7
VERSION:	1		
REVISION:	DPM	PROJECT:	7
APPROVED:	MB		

Reproduced on plans supplied by Ordnance Survey with the permission of the Controller of Her Majesty's Stationery Office. Licence number: 100052862. © CROWN COPYRIGHT 2004.

