

© COPYRIGHT  
 The copyright in this drawing is vested in Mongillo Construction Workshop (MCW) and no license or assignment of any kind has been, or is, granted to any third party whether by provision of copies or originals or otherwise unless agreed in writing.  
 DO NOT SCALE FROM THIS DRAWING  
 The contractor shall check and verify all dimensions on site and report any discrepancies in writing to Mongillo Construction Workshop (MCW) before proceeding work.  
 FOR ELECTRONIC DATA ISSUE  
 Electronic Data / drawings are issued as "read only" and should not be interrogated for measurement. All dimensions and levels should read, only from those values stated in text, on the drawing.

AREA MEASUREMENT  
 The areas are approximate and can only be verified by a detailed dimensional survey of the completed building. Any decisions to be made on the basis of these predictions, whether as to project viability, pre-letting, lease agreements or the like, should include due allowance for the increases and decreases inherent in the design development and building processes. Figures relate to the likely areas of the building at the current state of the design and using the Gross External Area (GEA) / Gross Internal Area (GIA) / Net Internal Area (NIA) method of measurement from the Code of Measuring Practice, 6th Edition (RICS Code of Practice). All areas are subject to Town Planning and Conservation Area Consent, and detailed Rights to Light analysis.



**1** Proposed West Elevation  
 20253 1 : 50

REV.	DATE	AMENDMENT
P01	08/09/2023	Design Review
P02	18/09/2023	Stage 2
P03	05/01/2024	Planning Application

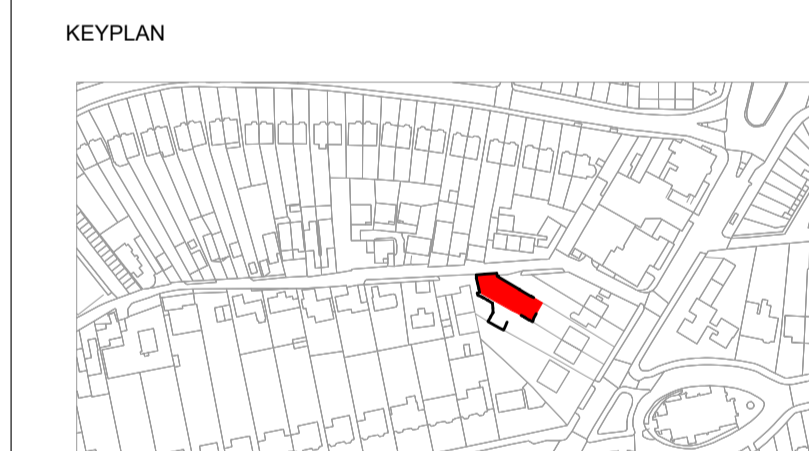

CLIENT  
**Michael Lancaster**



Blackheath, London SE3 7AN  
 T: +44 7951 935801 E: contact@mongillo.com

PROJECT  
**32 Heathway**

SCALE@A1	DATE	ORIGINATOR	CHECKED	AUTHORISED
1 : 50	17/08/2023	CM	SM	SM

**Proposed West Elevation**

Stage 1		
STATUS	PURPOSE FOR ISSUE	SR NO.
<b>S0</b>	<b>Planning</b>	<b>P16</b>
DRAWING NO.		REV.
<b>32H - MCW - XX - XX - DR - A - 20253</b>		<b>P03</b>