

THIS DRAWING IS NOT TO BE USED FOR CONSTRUCTION PURPOSES.

DRAINAGE DETAILS SUBJECT TO DETAIL DESIGN & SITE INVESTIGATION.

RED LINE DENOTES APPLICATION BOUNDARY, SITE OWNERSHIP SUBJECT TO CONFIRMATION BY OTHERS

EXISTING INFORMATION PROVIDED FROM TOPOGRAPHICAL SURVEY BY FOSSE SURVEYING LTD. DATED 13.06.2023. JOB REF NO. 2208

DRAINAGE KEY:

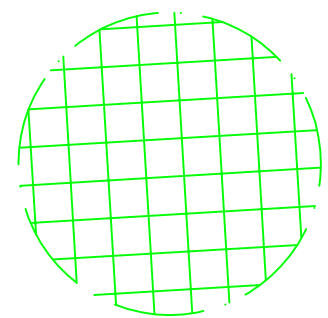

Proposed soakaway to be installed to discharge surface water on site - SUBJECT TO SITE PERCOLATION TESTS to demonstrate ground stability

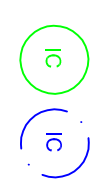

NEW INSPECTION CHAMBER



NEW LARGESTER



PROPOSED FOUL WATER DRAINAGE



PROPOSED SURFACE WATER DRAINAGE

LEVELS KEY:



EXISTING SITE LEVEL TO BE MAINTAINED



PROPOSED SITE LEVEL

ALL SITE LEVELS ARE SUBJECT TO DETAILED DESIGN DEVELOPMENT

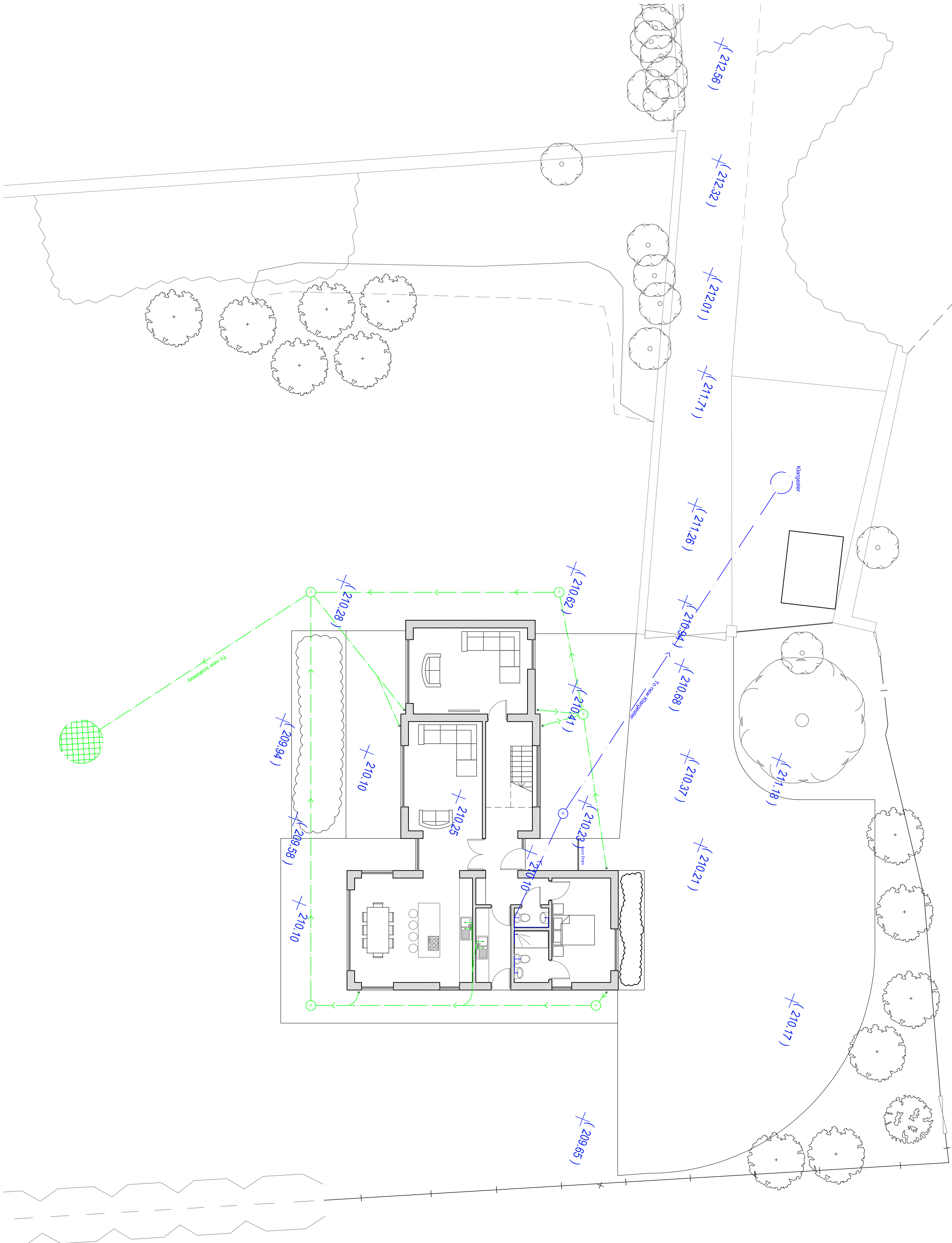

Proposed Site Plan  
Scale 1:100

brigtman clark architects

32 Causeway Head Road, Sheffield, S17 3DT  
Tel, Sheffield: 0114 236 1366  
email: info@brichtmanclark.co.uk  
© Copyright. This drawing is the property of brigtman clark architects and shall not be loaned, copied or distanced to any third party without prior written consent of brigtman clark architects

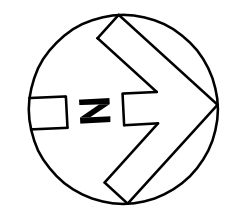

Client: Mr. J. Scollern  
Project: 27 Skew Hill, Grenoside  
Sheffield

Drawing No: 23-018-008  
Drawing Title: Proposed Levels & Drainage  
Scale @ A1: As Noted

Rev: -  
Rev Details:  
Initial Issue

Rev Date: 11.10.2023  
Drawn By: AR

PLANNING DRAWING