

01
5020

FT6 - Coat of Arms indicative detail - NBS Q50 340 - For condition submission
1:20

TOP VIEW

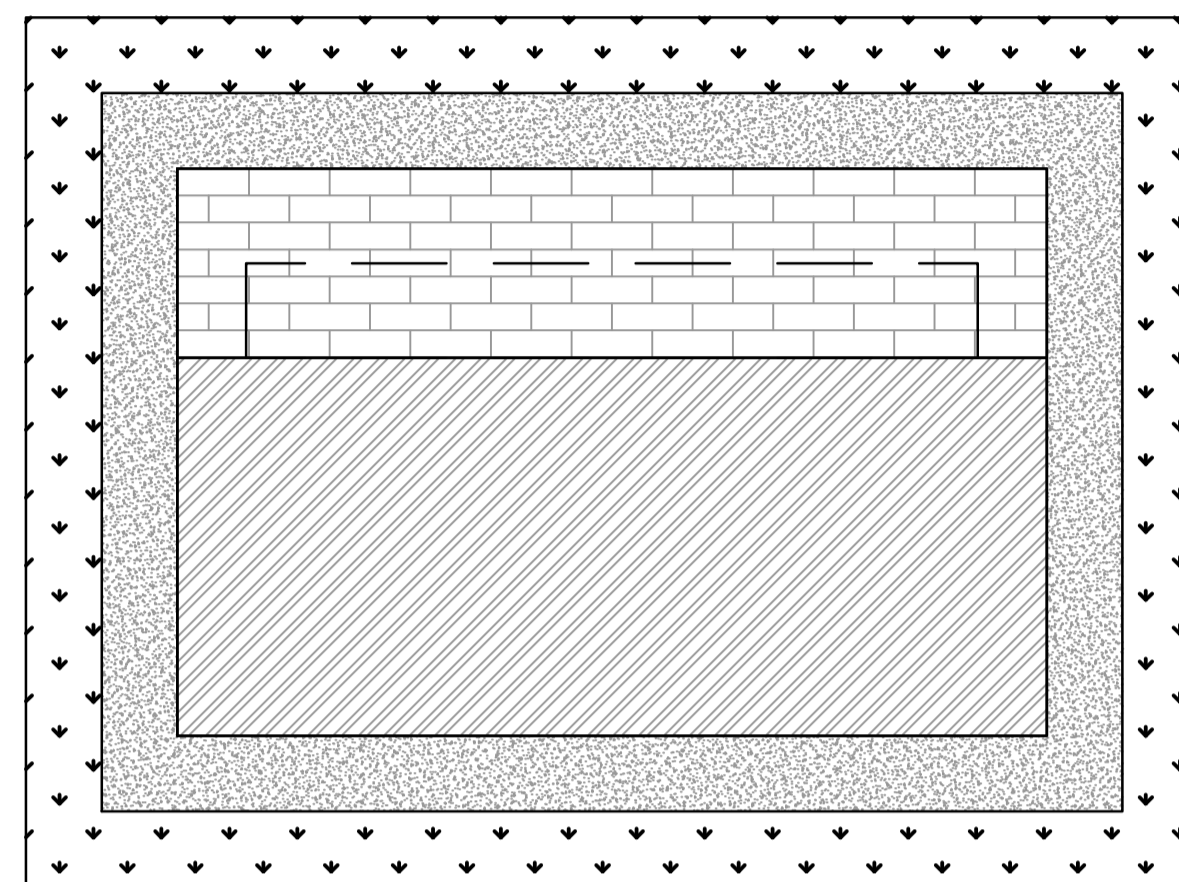

02
5020

Overview plan of FT6 - Coat of Arms
1:100

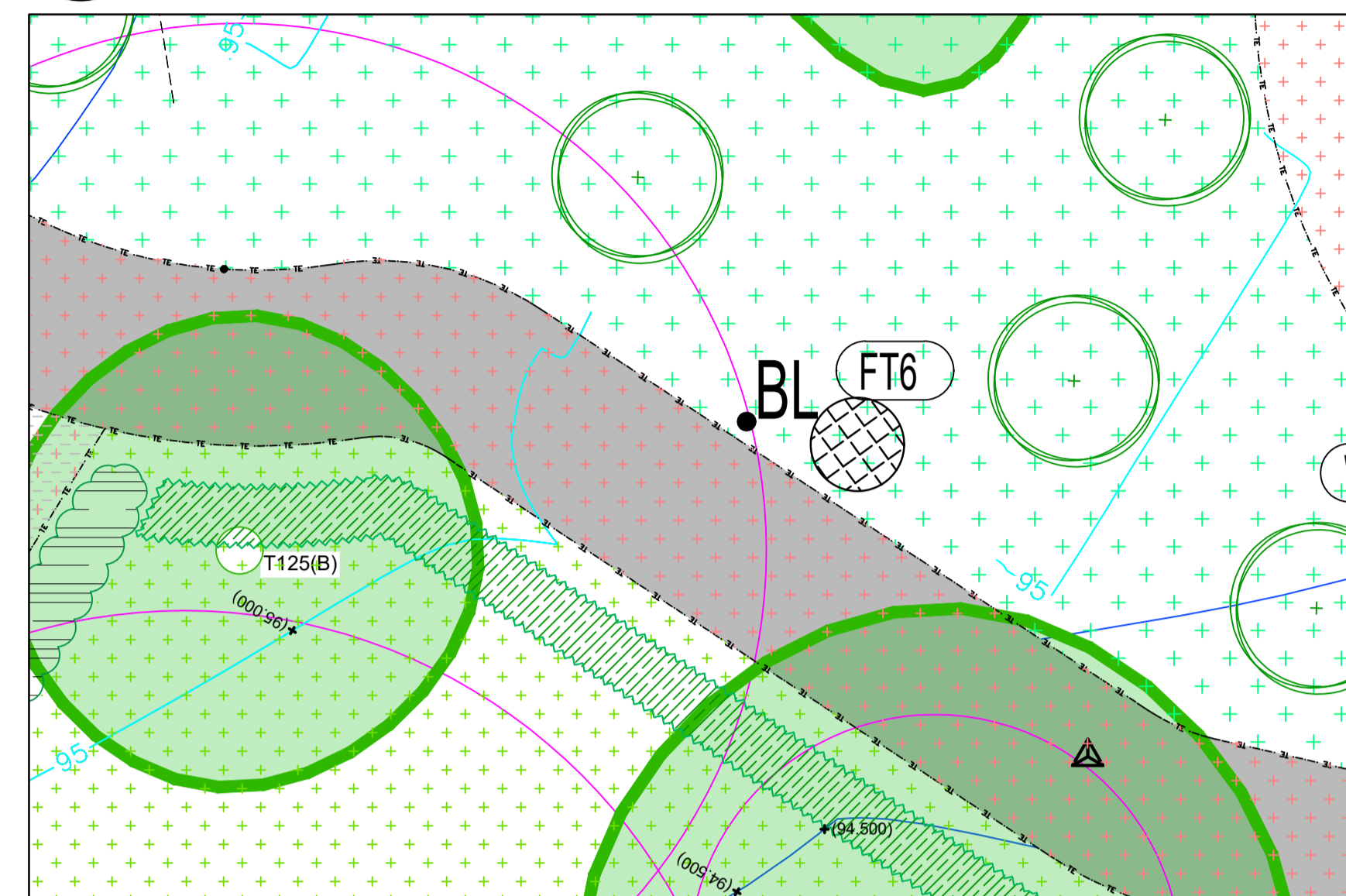

REAR ELEVATION

FRONT ELEVATION

SIDE ELEVATION

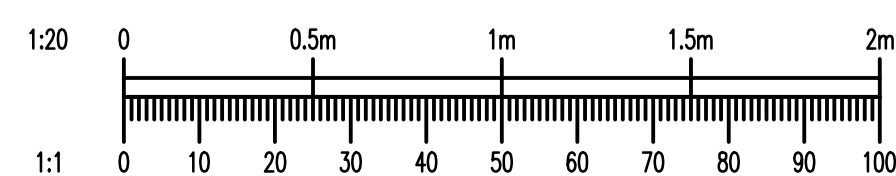
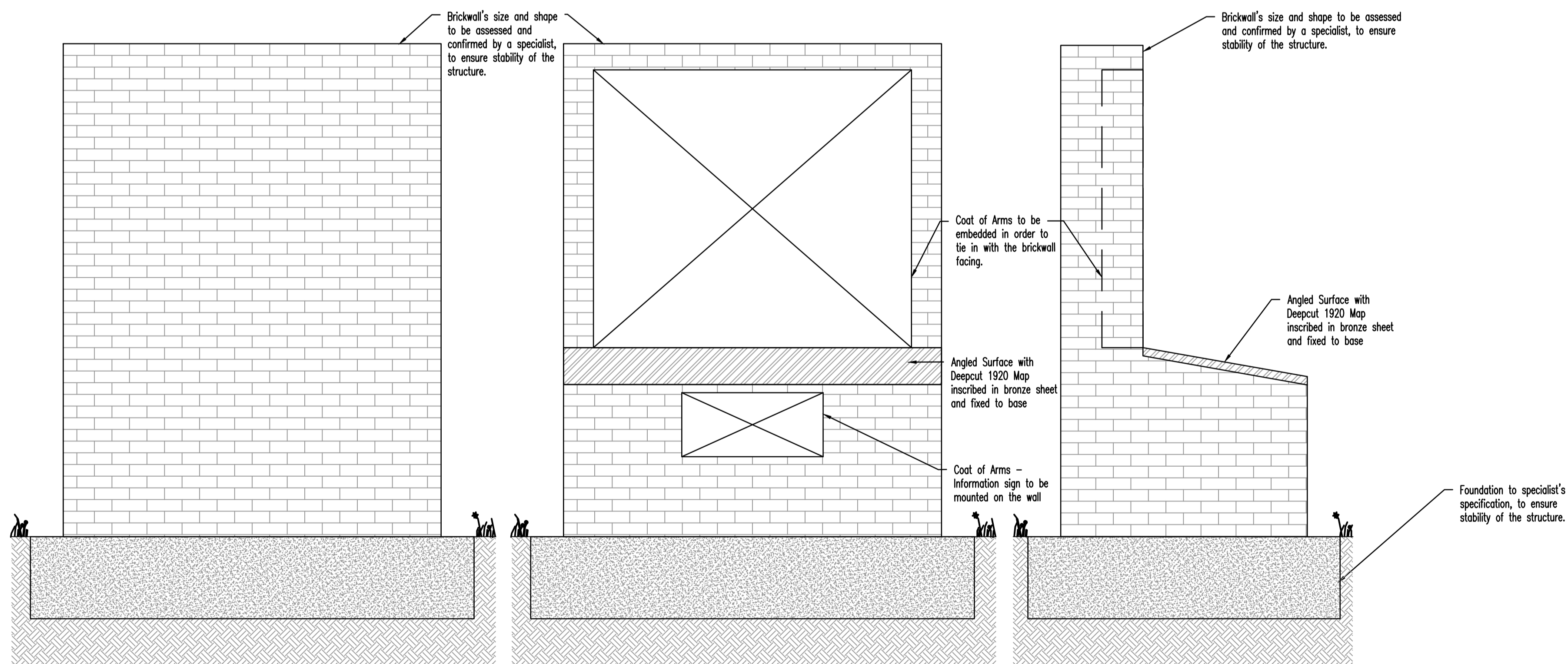

Rev	Date	Description	By
C02	13.12.23	ISSUED FOR CONSTRUCTION	KK
C01	02.11.23	ISSUED FOR CONSTRUCTION	KK

Project		Princess Royal Barracks	
Title		Formal Park & Church Hall Typical Details Sheet 21 FT6 - COAT OF ARMS DETAIL	
Client		SKANSKA	



Merchants House Wapping Road Bristol BS1 4RW
1 0117 937 8200
mail@watermangroup.com www.watermangroup.com

ISSUED FOR CONSTRUCTION			
Designed By	Checked By	Waterman Ref	
KK	TH	WIE14198	
Drawn By	Date	Scales @ A1	
KK	NOV 2023	-	
DRAWING NUMBER		Revision	
DC2-WTM-LX-217-114-XX-DR-04-5020		C02	