

Junction Visibility Splays

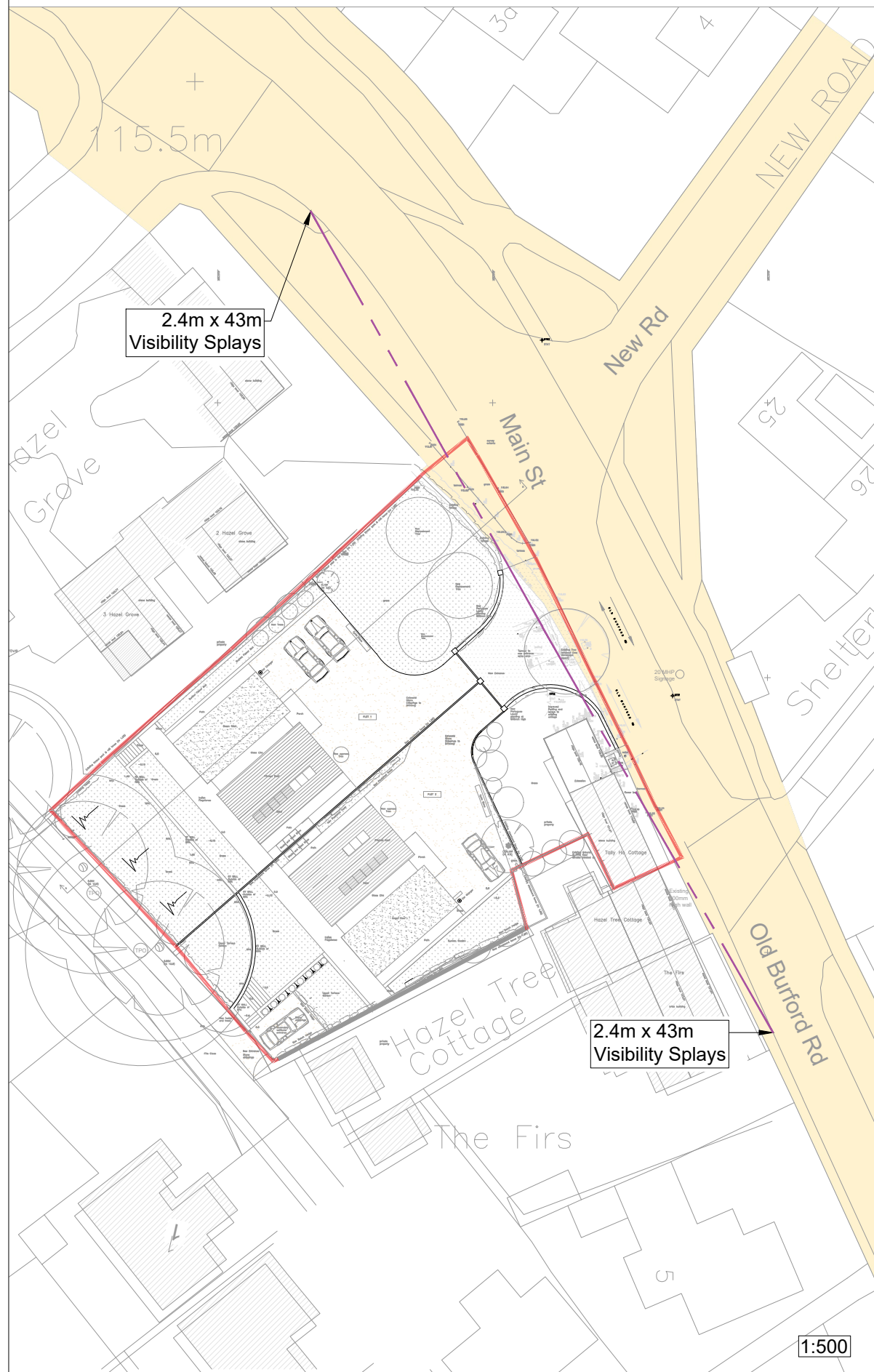

Geometric Plan

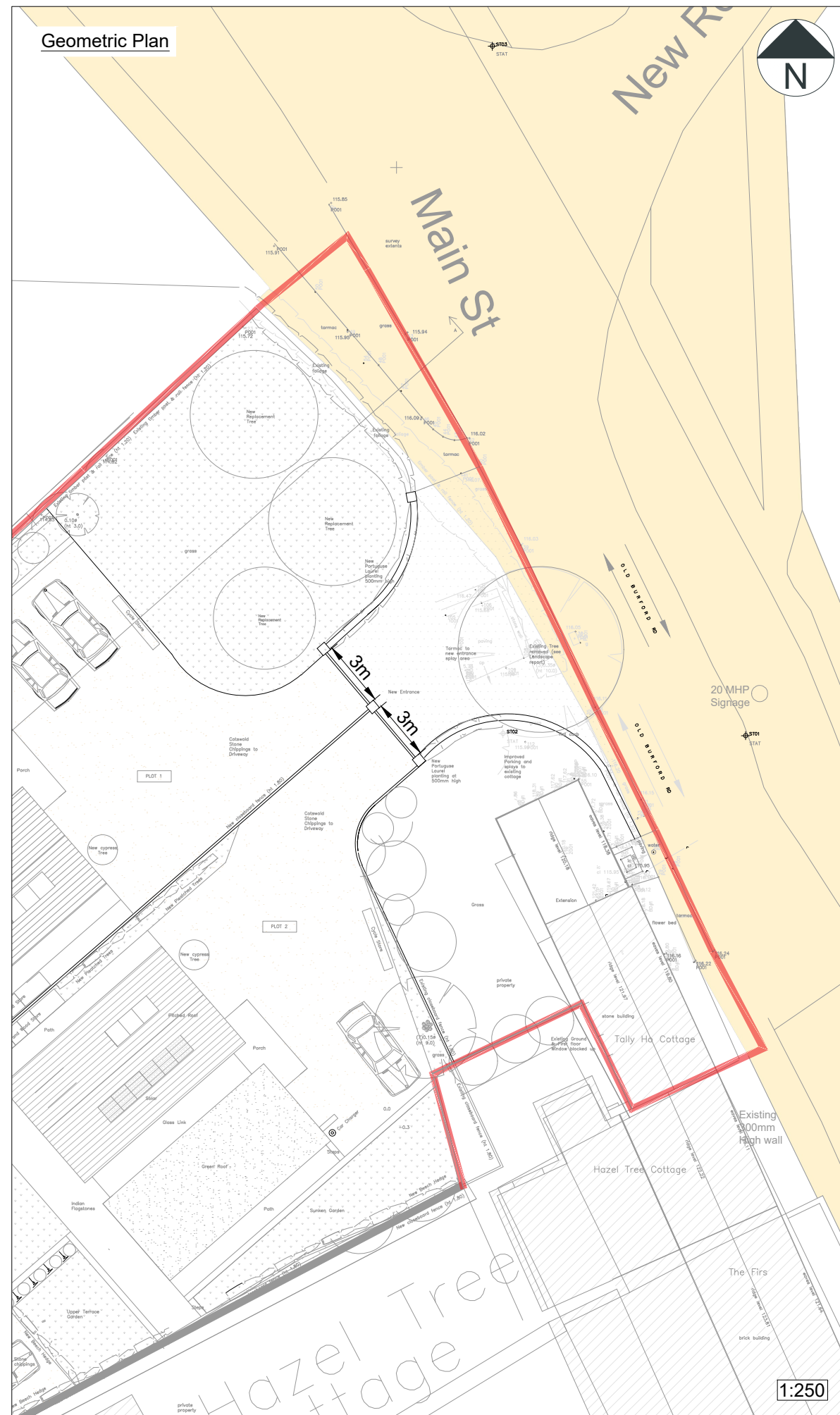

Notes:

1. Do not scale from this drawing. All dimensions are in metres, unless stated otherwise.
2. This topographical drawing was received from Midlands Survey Ltd, drawing number 97826, & dated June 2023.
3. Highway boundary information has been provided by Gloucestershire County Council (25/07/2023) and has been overlaid by Rappor onto the Topographical Survey & Ordnance Survey on a best fit basis.
4. Ordnance Survey, (c) Crown Copyright 2020. All rights reserved. Licence number 100022432.
5. This drawing is based on the Architect's layout by DMD-group and drawing date 06.12.2023.

Key:

- Site Boundary
- Adopted Highway Boundary
- 2.4m x 43m Visibility Splay (30mph)

Rev	Date	Details	By	Chkd
P04	07.12.23	Updated Layout	FA	JS
P03	02.10.23	Minor text amendment	BF	JS
P02	21.09.23	Updated Layout & VIS	FA	JS
P01	16.08.23	Updated Red Line Boundary	FA	JS

rappor



CLIENT: **Tomland Ltd**

PROJECT: **Bledington**

TITLE: **Proposed Access Arrangement & Visibility Assessment**

SCALE @ A3:	DATE:	DRAWN:	CHECKED:	APPROVED:
As Stated	01.08.23	FA	JS	JS

STATUS: **PLANNING**

DRAWING NO:	REVISION:
230454-RAP-XX-XX-DR-TP-3200	P04