

KEY:

- SITE BOUNDARY
- DENOTES LOCATION OF PROPOSED EXTENSION

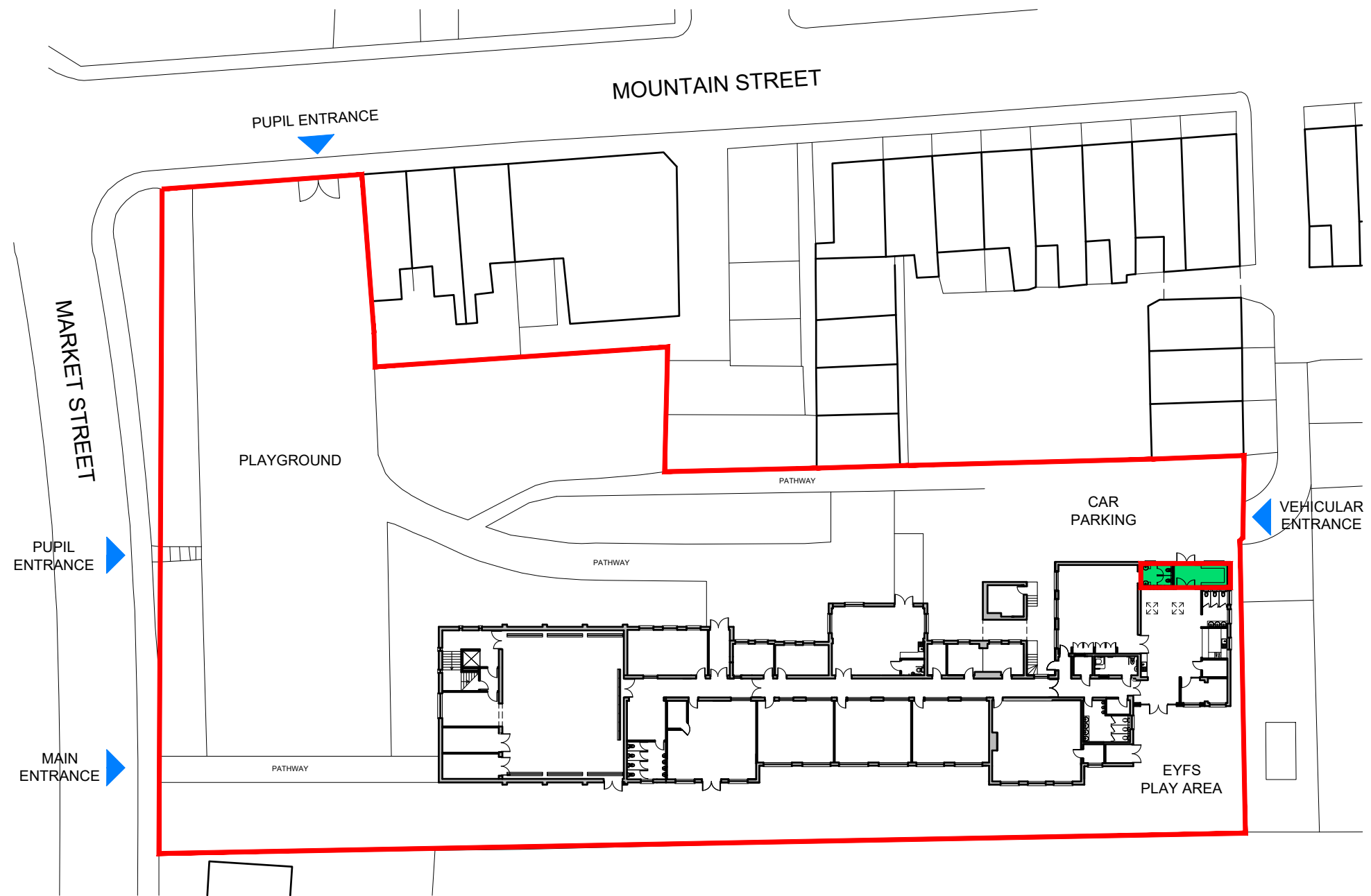

**PROPOSED SITE PLAN
SCALE 1:500@A3**



NOTES

| Rev | Date | Comments | By |
|-----|------|----------|----|
| | | | |
| | | | |
| | | | |

STATUS
PLANNING ISSUE

Client
**The Board of Governors
St Joseph's RC Primary
School, Mossley**

Project Title
**Extension & Alterations to
EYFS**

Drawing Title
Proposed Site Plan

| | | |
|--------------------|--------------------|-----------------------|
| Scale 1:500@A3 | Drawn by MAB | Date December 2023 |
| Job no. 2301/68 | Drawing no. P03 | Revision no. N/A |

LMM
Lancaster Maloney Martin

Registered Office:
Equitas House Unit 6 Station View Rhino Court Stockport SK7 5ER
Tel: 0161 477 3500
E-mail: administration@lmm-ltd.co.uk | Website: www.lmm-ltd.co.uk
Registered in England No 4846621