



WEST

SOUTH ELEVATION Scale 1 : 50

EAST

Red brickwork Flemish bond using second hand matching bricks salvaged on site from previous demolition of outbuildings laid in lime mortar
 White windows and doors in upvc with timber grain finish

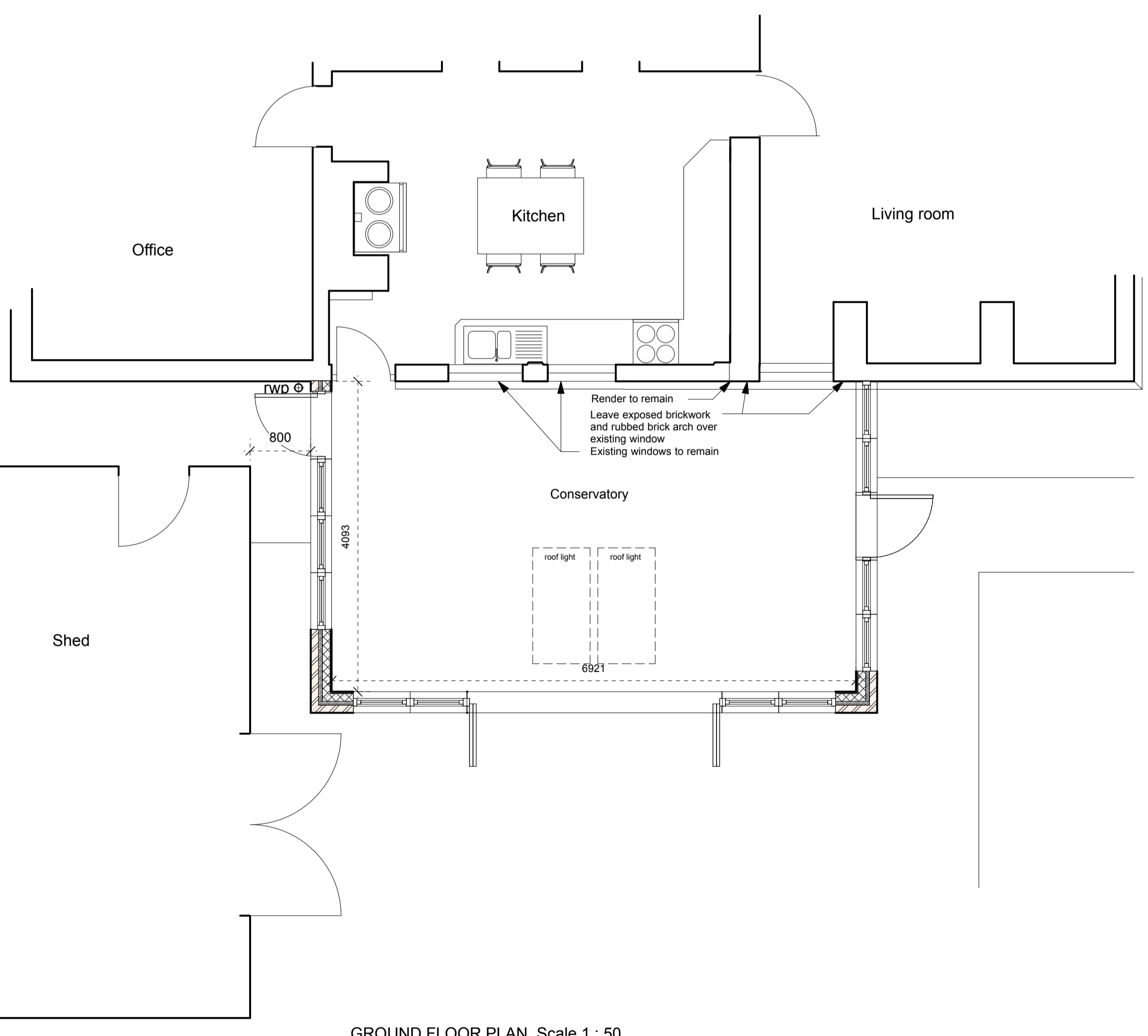

GROUND FLOOR PLAN Scale 1 : 50

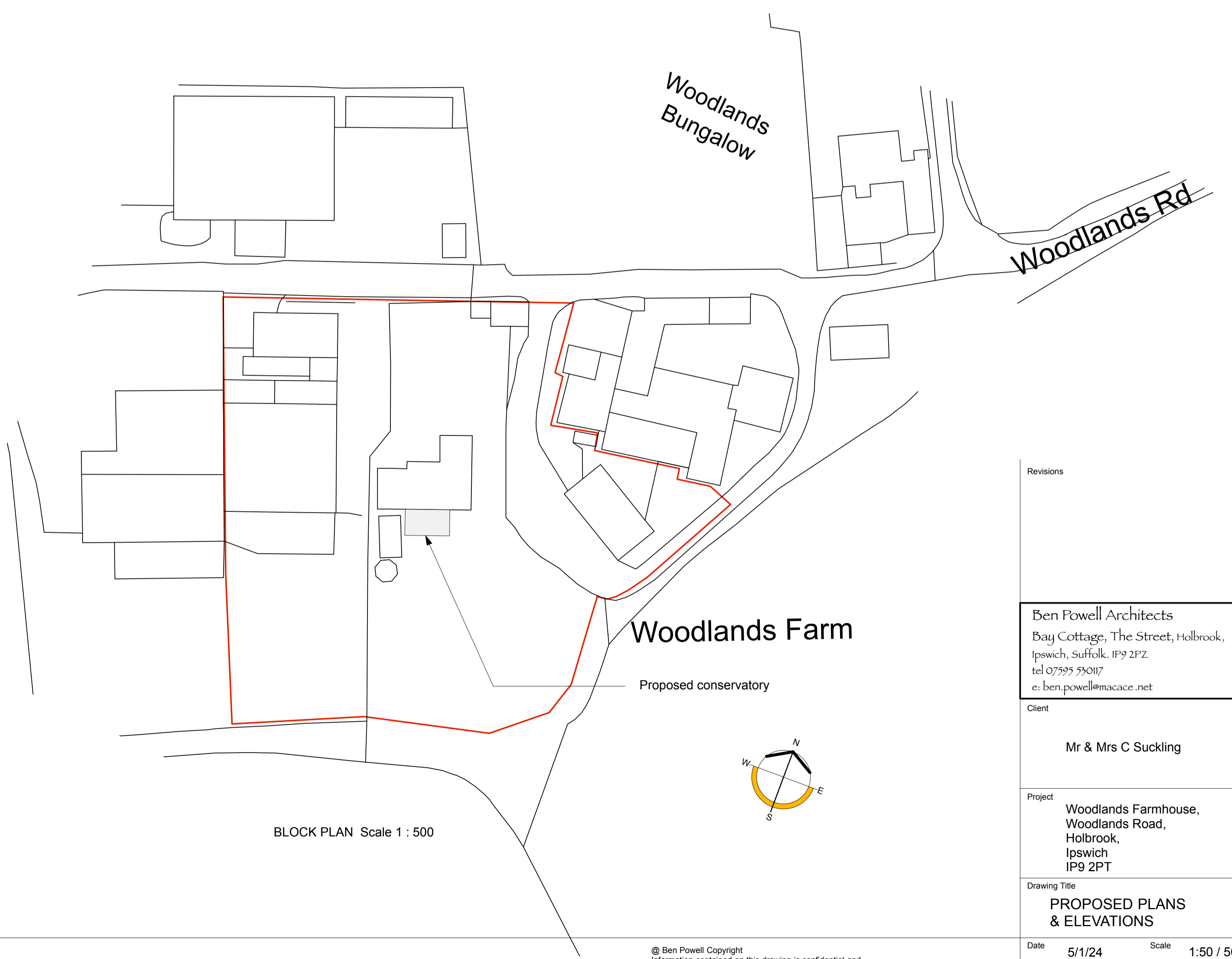

BLOCK PLAN Scale 1 : 500

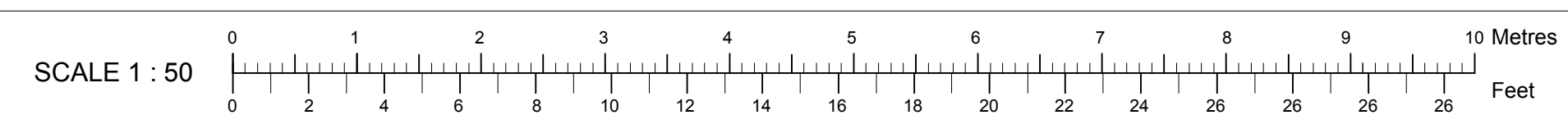

© Ben Powell Copyright
 Information contained on this drawing is confidential and may not be used for any purpose other than for which the drawing is supplied without prior written authority. All rights reserved

Revisions	
Ben Powell Architects Bay Cottage, The Street, Holbrook, Ipswich, Suffolk, IP9 2PZ tel 07595 55017 e: ben.powell@macace.net	
Client Mr & Mrs C Suckling	
Project Woodlands Farmhouse, Woodlands Road, Holbrook, Ipswich IP9 2PT	
Drawing Title PROPOSED PLANS & ELEVATIONS	
Date	5/1/24
Scale	1:50 / 500
Drawing number	35001/2
Revision number	