

| | |
|------|--|
| KEY: | ASPHALT WITH SURFACING COURSE TO HIGHWAYS |
| P8 | STANDARD - STANDARD BLACK ASPHALT AC10 CLOSE GRADED SURFACE COURSE |

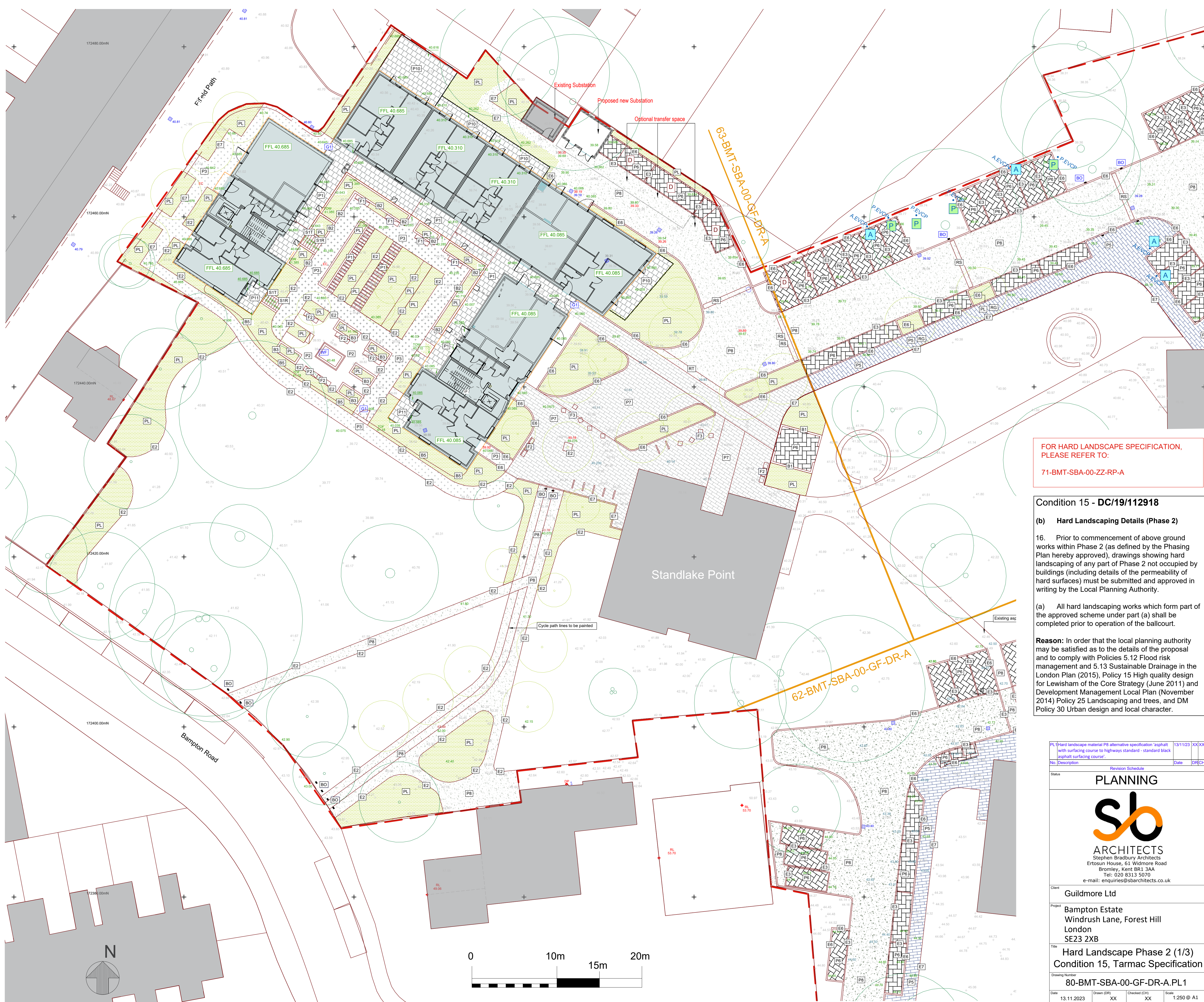

FOR HARD LANDSCAPE SPECIFICATION,
PLEASE REFER TO:
71-BMT-SBA-00-ZZ-RP-A

Condition 15 - DC/19/112918

(b) Hard Landscaping Details (Phase 2)

16. Prior to commencement of above ground works within Phase 2 (as defined by the Phasing Plan hereby approved), drawings showing hard landscaping of any part of Phase 2 not occupied by buildings (including details of the permeability of hard surfaces) must be submitted and approved in writing by the Local Planning Authority.

(a) All hard landscaping works which form part of the approved scheme under part (a) shall be completed prior to operation of the balcourt.

Reason: In order that the local planning authority may be satisfied as to the details of the proposal and to comply with Policies 5.12 Flood risk management and 5.13 Sustainable Drainage in the London Plan (2015), Policy 15 High quality design for Lewisham of the Core Strategy (June 2011) and Development Management Local Plan (November 2014) Policy 25 Landscaping and trees, and DM Policy 30 Urban design and local character.

| | | | |
|-----|---|----------|-------|
| PL | Hard landscape material P8 alternative specification 'asphalt with surfacing course to highways standard - standard black asphalt surfacing course' | 13/11/23 | XX/XX |
| No. | Description | Date | DR/CH |

| | |
|---|--|
| Revision Schedule | |
| PLANNING | |
|  ARCHITECTS Stephen Bradbury Architects Ertosun House, 51 Widmore Road Bromley, Kent BR1 3AA Tel: 020 8313 5070 e-mail: enquires@sbarchitects.co.uk | |
| Client: | Guilmore Ltd |
| Project: | Bampton Estate Windrush Lane, Forest Hill London SE23 2XB |
| Title: | Hard Landscape Phase 2 (1/3) Condition 15, Tarmac Specification |
| Drawing Number: | 80-BMT-SBA-00-GF-DR-A.PL1 |
| Date: | 13.11.2023 |
| Drawn (DR): | XX |
| Checked (CH): | XX |
| Scale: | 1:250 @ A1 |